

Manic

Instruction Manual v.1.0



Schumacher Racing
79 Tenter Road
Moulton Park
Northampton
NN3 6AX
ENGLAND



Schumacher USA Inc
6302 Benjamin Road
Suite 404
Tampa
Florida 33634
U.S.A

ADDITIONAL ITEMS REQUIRED

AA Batteries size for Falco Gear



G715
AA Batteries (pk 4)

Long Reach Glow Starter



(Twin Engined Manic
Requires 2 x Glowstarts.)

CR046
CORE RC - Long Glow Starter Purple Alloy + Meter

Polo Start Electric Starter



G851
Polo Electric Starter

Battery for Polo Start



CR040
CORE RC - 3000 NiMH 7.2v Stick Pack

Charger for Polo Start Battery



G834
Charger 240v UK

Manic

Nitro Starter Set



Nitro Starter Set Includes:
Fuel Bottle (additional one req.)
2 x Wrench
2 x Screw Drivers

Optional Starter (Replaces Polo Start)



Cordless Drill (recommendations)
12v Minimum
1000 R.P.M Minimum
(The more powerfull the easier to start)

OR

Fuel

Nitro Fuel (Schumacher recommend)
Model Technics Dynaglow
Magnum
O'Donnell
Tornado
Blue Thunder
Byron



SHOCK ABSORBER

Manic

A

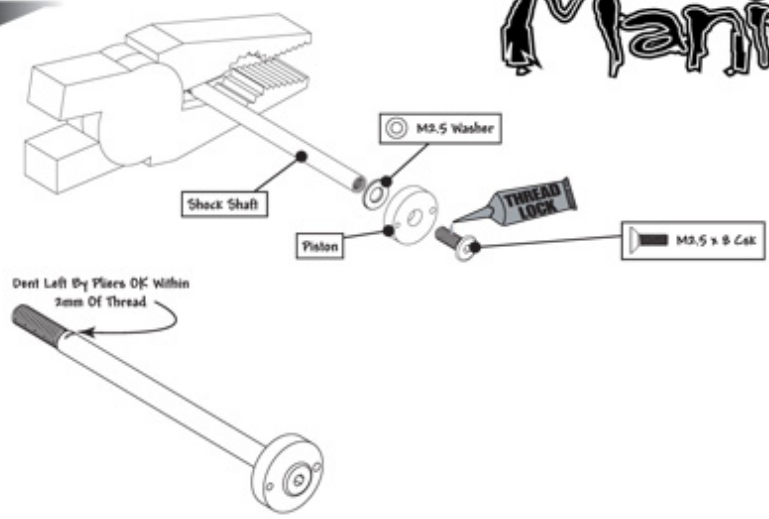

B

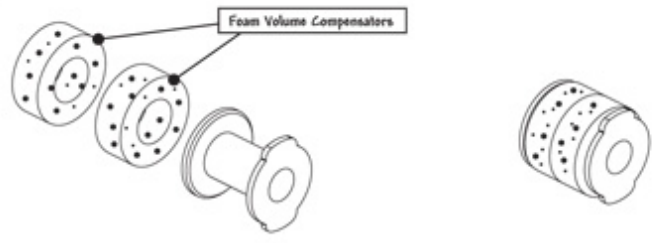

C

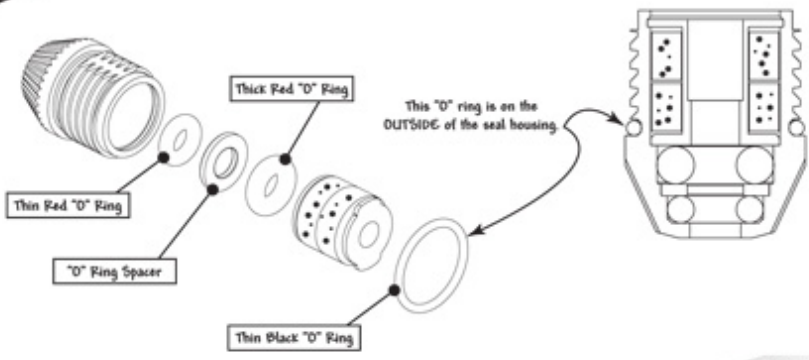

SHOCK ABSORBER

Manic

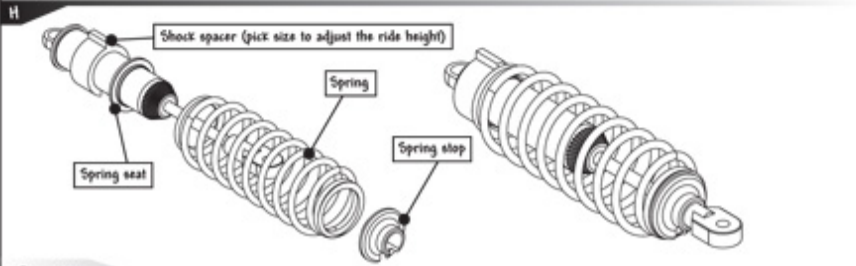
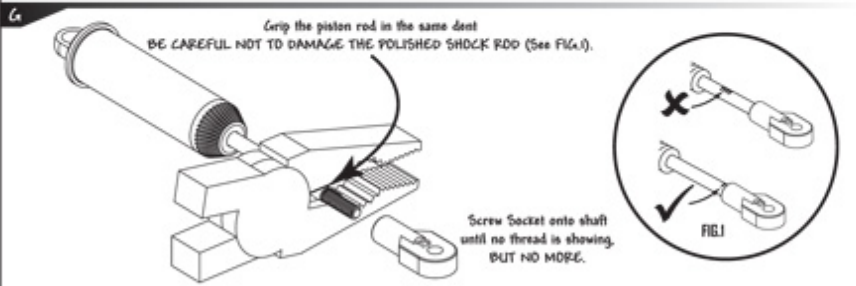
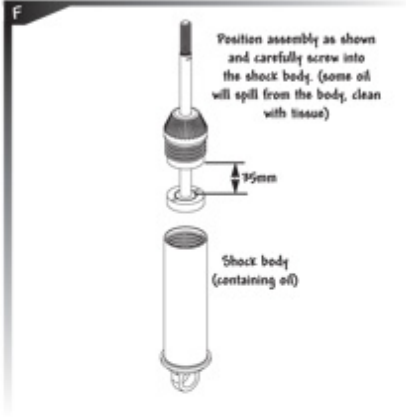

DIFFERENTIAL

Manic

A

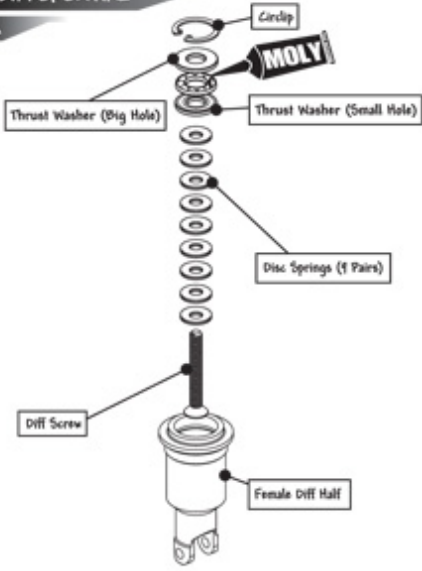

NOTE:
ONLY USE Schumacher
MOLY AXLE GREASE
Re-order # U1951

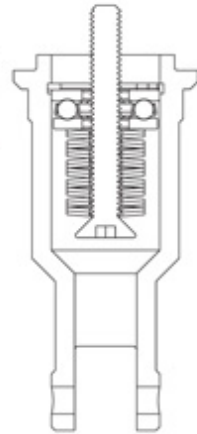

B

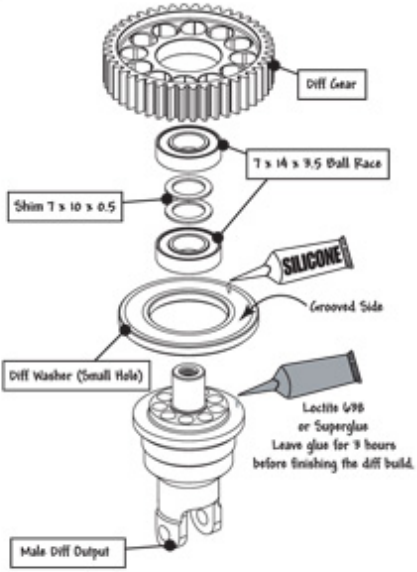

NOTE:
ONLY USE Schumacher
SILICONE DIFF LUBE
Re-order # U1951

C

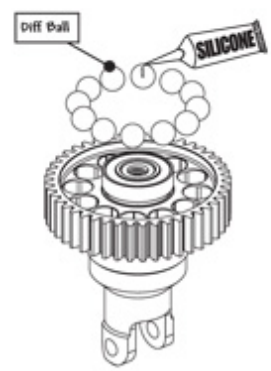

DIFFERENTIAL

Manic

D

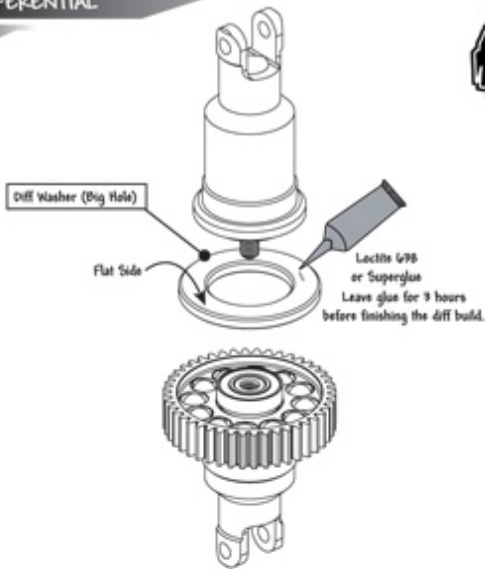

E

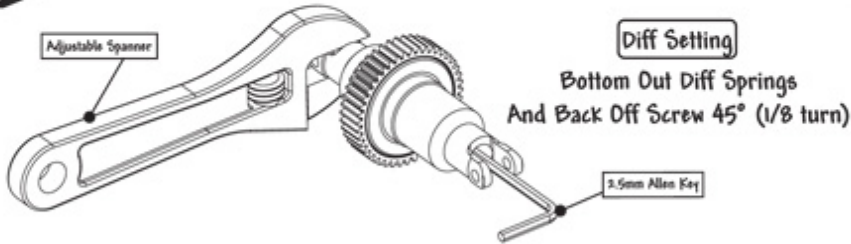

F

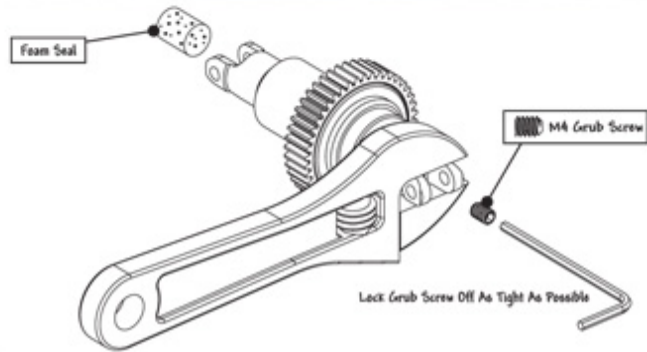

ENGINE TIMING

A

THIS MUST BE DONE AFTER ANY DISSASSEMBLY WORK ON THE ENGINE

BEFORE YOU BEGIN THIS PROCESS YOU WILL NEED TO PURCHASE U9544 TIMING JIGS.

Manic

REMOVE THE PTO/START, BACKPLATE, STARTER SHAFT AND DRIVE PIN FROM THE REAR ENGINE AND THE COVER PLATE FROM THE FRONT ENGINE.

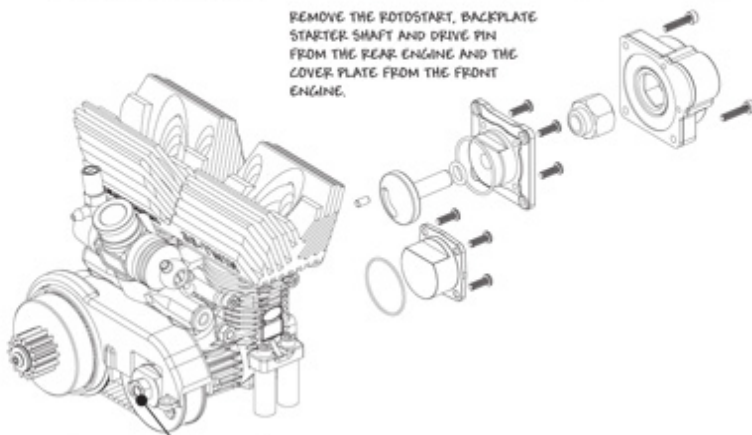

THIS NUT TO BE LEFT LOOSE

B

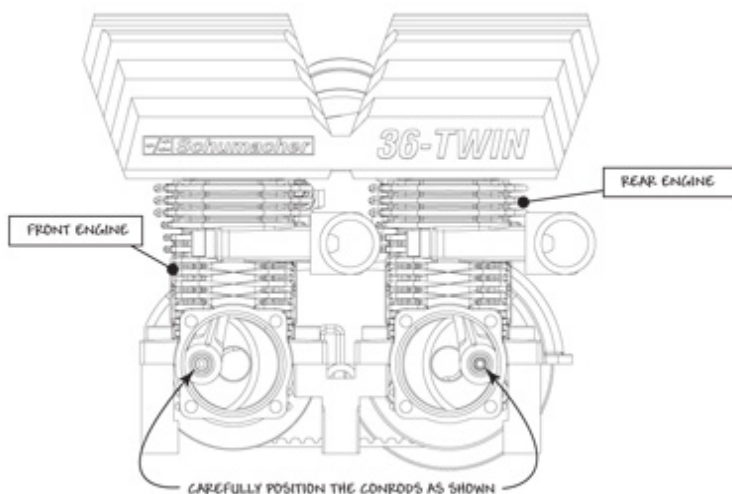

A

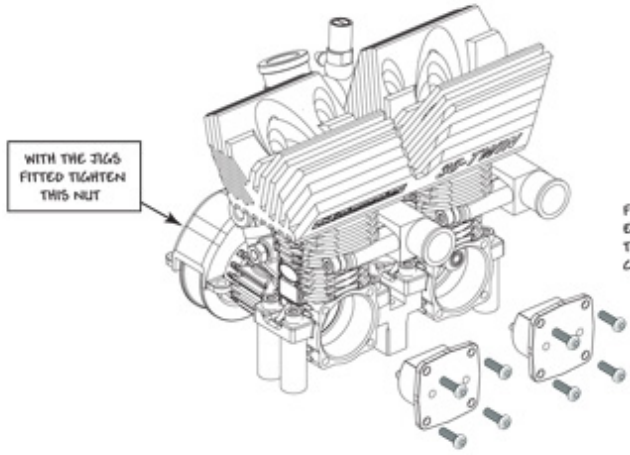

FIT THE TIMING JIGS TO THE ENGINES ENSURING THAT THE TIMING PINS LOCATE IN THE CRANKSHAFTS.

B

NOW REMOVE THE TIMING JIGS AND RE-ASSEMBLE THE ROTOSTART AND COVER PLATE.

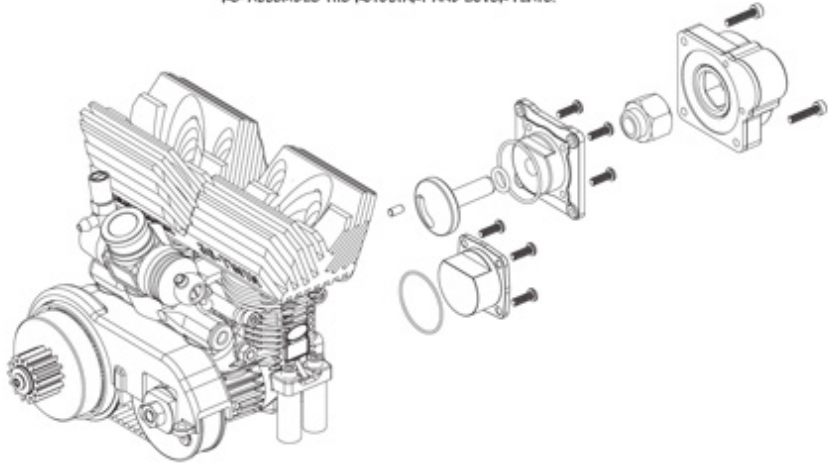

Manic

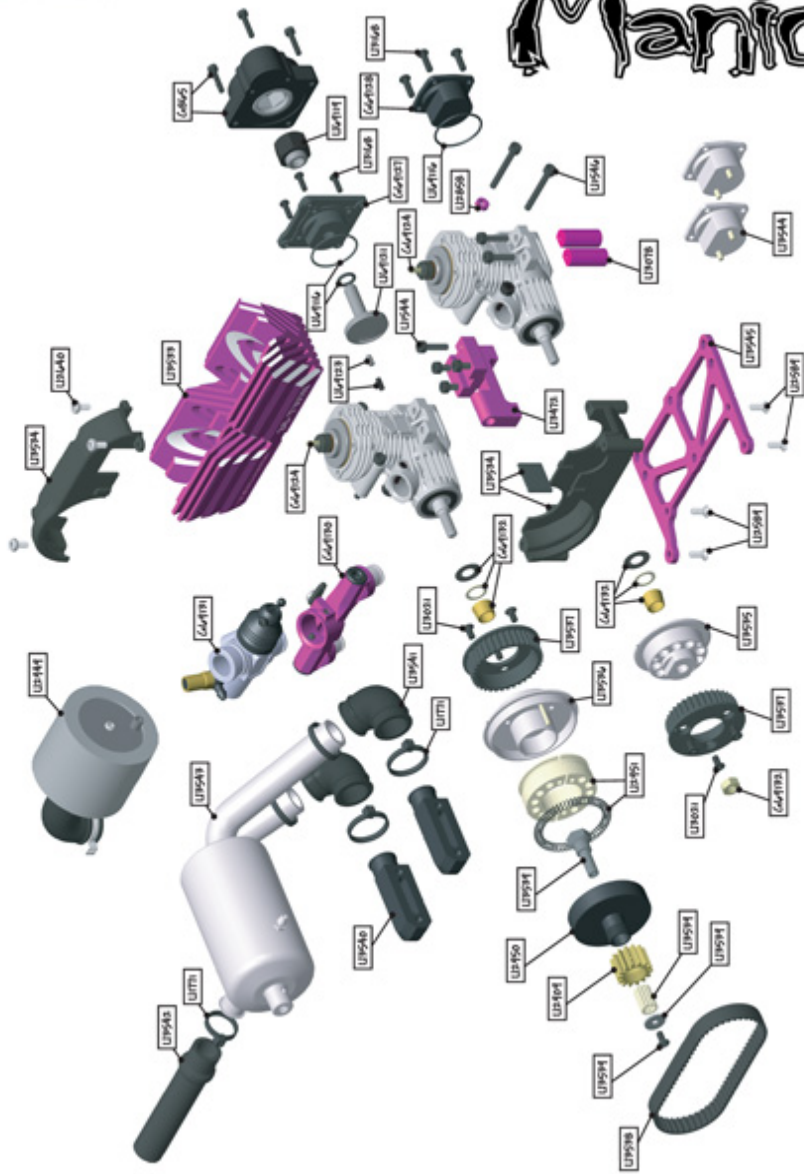

Power Unit

Manic

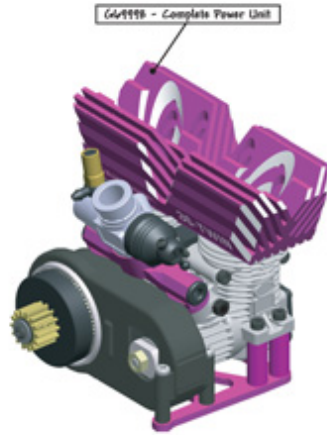
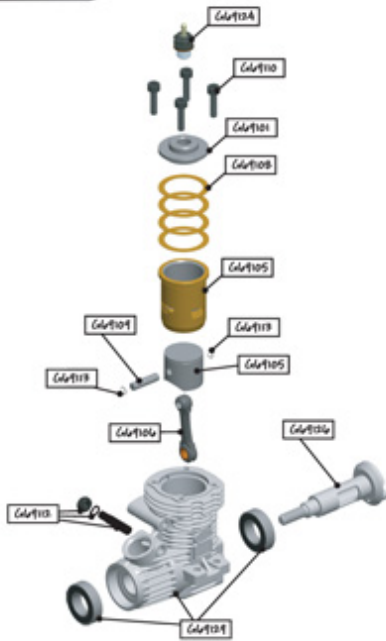

Options

 <p>Purple Alloy Dual Stage Filter L2894</p>	 <p>Air Filter Oil H1097</p>	 <p>Micro Temp Gun & Stopwatch G897</p>	 <p>Purple Alloy Fuel Filter L2895 With "Sintered Brass Filter.</p>
 <p>Waterproof Dual Stage Filter L2814</p>	 <p>Air Filter Cleaner H1098</p>	 <p>Glow Plug x 1 G41104</p>	 <p>5 Way Glow Plug Spanner H1018 8mm, 9mm, 10mm, 12mm and 15mm.</p>

Manic



Purple Alloy Wishbones (Pr)
U2966



Chrome Steel
Whisker Bar Set
U2464

SILICONE SHOCK OIL

G010 - 10 weight (thin)
 G015 - 15 weight
 G020 - 20 weight
 G025 - 25 weight
 G030 - 30 weight
 G035 - 35 weight
 G040 - 40 weight
 G045 - 45 weight
 G050 - 50 weight
 G055 - 55 weight
 G060 - 60 weight
 G070 - 70 weight
 G080 - 80 weight
 G100 - 100 weight
 G120 - 120 weight (thick)



1500 kv RX Pack Flat
CR041



1500 kv RX Pack Hump
CR042



GT85 Lube and
Clean 400ml
H1055



Silicone Diff Lube
U1901
The best lube for ball diffs!



Moly Pole Grease
U1951
The ultimate thrust race grease!



Purple Alloy Shock Seal
Housings (Pr)
U1816



Bearing Blaster
H1091



Zxi Extralube
G000
The Ultimate Friction
Eliminator.



Whia "Pro" T20 Torx Driver
H1001



Whia "Pro" T10 Torx Driver
H1008



Nitro Cleaner
H1090

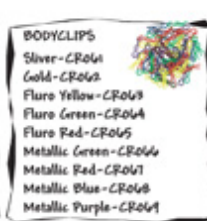

BODYCLIPS
 Silver - CR061
 Gold - CR062
 Fluro Yellow - CR063
 Fluro Green - CR064
 Fluro Red - CR065
 Metallic Green - CR066
 Metallic Red - CR067
 Metallic Blue - CR068
 Metallic Purple - CR069



250cc Fuel Bottle
H1016
Blue Alloy pipe
with stopper!



500cc Fuel Bottle
H1017
Blue Alloy pipe
with stopper!

TOOLS REQUIRED

Engine Tools



ED10002
Driver-Glowplug - Clutchnut - 10mm Long

Manic

TRIX TOOLS

Proven and professional equipment for tomorrow's racing

Tors Drivers



HW004
Wiha Tors Driver - T20



HW008
Wiha Tors Driver - T10

EDS Tools



ED10040
Flat Screwdriver 4.0 x 120mm

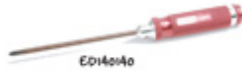

ED10040
Phillips Screwdriver 4.0 x 120mm



ED10050
Hex Driver 5.0 x 120mm

Trix Tools



Hex Driver - 1.5mm
U3794



Hex Driver - 2.0mm
U3710



Hex Driver - 2.5mm
U3711

Nut Drivers



M4 Nut Driver
U3716



M8 Nut Driver
U3715



ED10005
Wheel Nuts Driver 17mm

Misc Tools



ED10001
Turnbuckle Wrench 5.5mm



5.5mm Combination Wrench



Long Nose Pliers

GUARANTEE

All parts are guaranteed against defects in manufacture. Conditions of use of this product are out of our control and therefore we cannot guarantee parts against failure in use. This is an ultra high performance car and if used without due respect failure could occur

If you have any problems with this product your first point of contact should be the Store where you purchased it from.

SAFETY

This product is not suitable for children under 14 years of age unless supervised by an adult



Select an area for assembly that is away from the reach of small children. The parts are small and can be swallowed by children causing choking and possible internal injuries

Shock fluids, grease and adhesives should be kept out of childrens reach. They may be toxic and were not intended for human consumption.

Exercise care when using hand tools, sharp instruments or power tools during assembly.

Read the instructions fully and read all manufacturers warnings and cautions for any additional items that may be used for assembly purposes.

Nitro fuel is **EXTREMELY HAZARDOUS** read all the manufacturers warnings before opening the container.

Always drive your car safely, away from public roads, and be aware of any people or animals near you.
MODEL CARS CAN BE DANGEROUS

WARNINGS

Use good quality fuel with synthetic oil, we recommend Model technics Dynaglow, Byron, Magnum, O'Donnel, Blue Thunder or Tornado, with a 10%-25% nitro content. We do not recommend the use of castor oil based fuels, it leaves a sticky residue which can cause the rotostart one way bearing to slip. A higher Nitro content fuel will give more power but will make the engine run hotter.

Nitro fuels, particularly racing fuels with a high nitro content and low oil content, are very corrosive, and can cause the engine to rust if left inside it. We recommend running the car completely out of fuel if it is to be left unused for a few days. This can be done by allowing the fuel tank to empty or by squeezing the fuel line until the engine stops. After run oil such as Ultimate Racing UR0903 also helps to reduce corrosion. Remove the glow plugs and put a few drops of after run oil into each engine, then turn the engines over to circulate the oil around the moving parts. We cannot warranty a rusty engine.

NEVER run the engine without the air filter fitted.

NEVER run the car at full throttle with the wheels off the ground, the engines may blow up in a matter of seconds.

Always ensure the transmitter and receiver batteries are fully charged before use.

Always ensure that all the nuts and screws are tight and that the gear mesh is correct.

Always run in a new engine by using a rich fuel mixture, to ensure plenty of lubrication, and use no more than half throttle for the first 2 or 3 tank fulls of fuel.

Do not run tyres with a larger diameter than those supplied with the kit as this will over gear the car, this will cause excessive loads and thus un-due wear and tear.

This product is not a toy. It is a hobby product capable of high performance, but will require regular maintenance. Learn to drive slowly at first, away from solid objects. The Manic is capable of small jumps and stunts but heavy impacts can cause damage.

BATTERY INSTALLATION

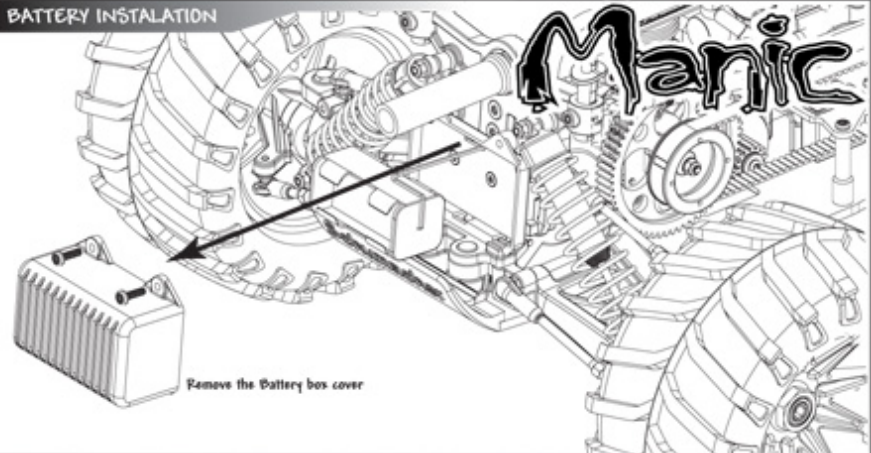

Remove the Battery box cover

BATTERY INSTALLATION

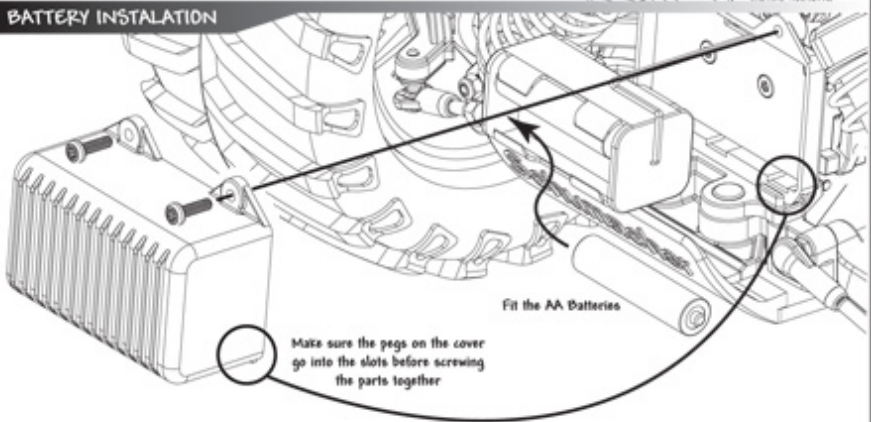

Fit the AA Batteries

Make sure the pegs on the cover go into the slots before screwing the parts together

BATTERY INSTALLATION

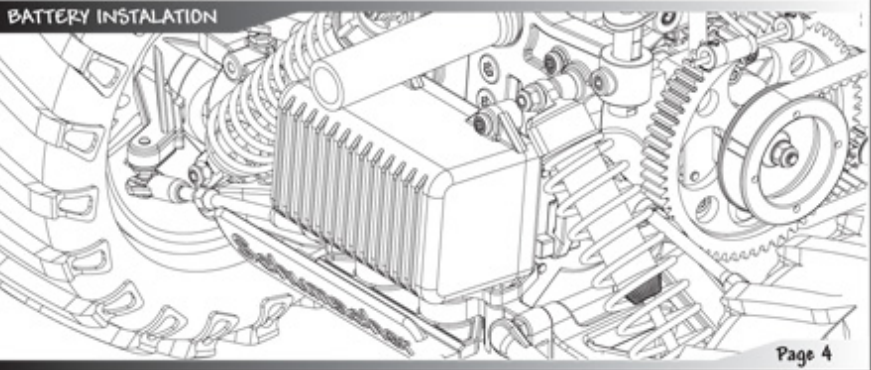

LINKAGES SETUP

Manic

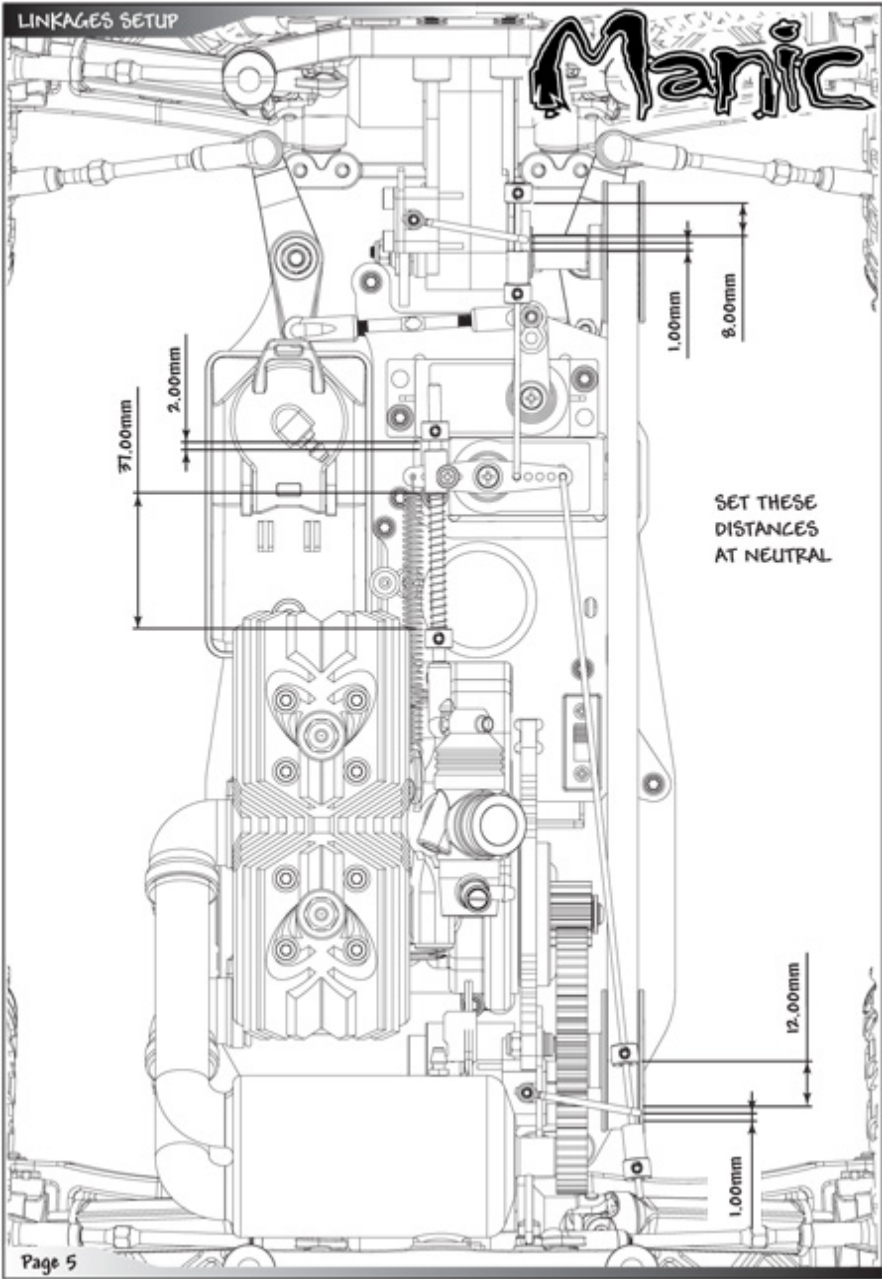

STARTING THE ENGINE

Set Up Drill or Rotastart

After charging your Drill or Rotastart, insert the electric start adaptor (ball end out) and tighten the chuck. ENSURE THE DRILL ROTATES ANTI-CLOCKWISE

Set the torque setting (if you have one) to the lowest possible setting that will turn the engine over.

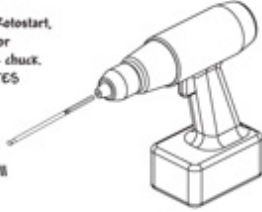

Manic

Fill Fuel Tank

SEE PAGE 3 FOR FUEL RECOMMENDATIONS

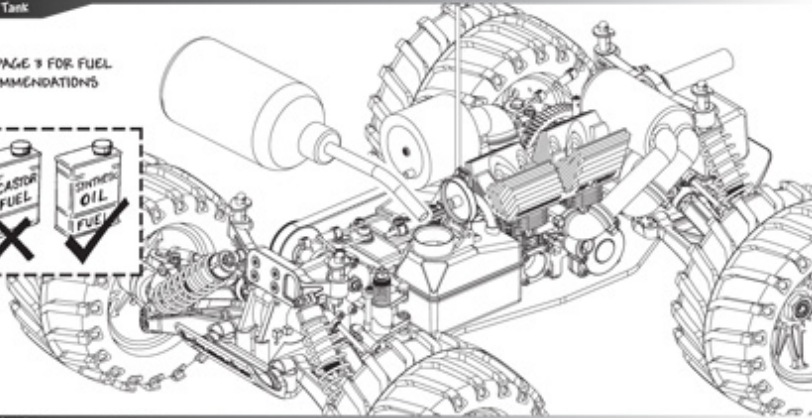
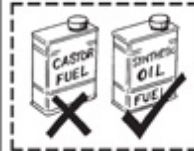

Priming the Engine

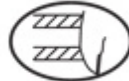
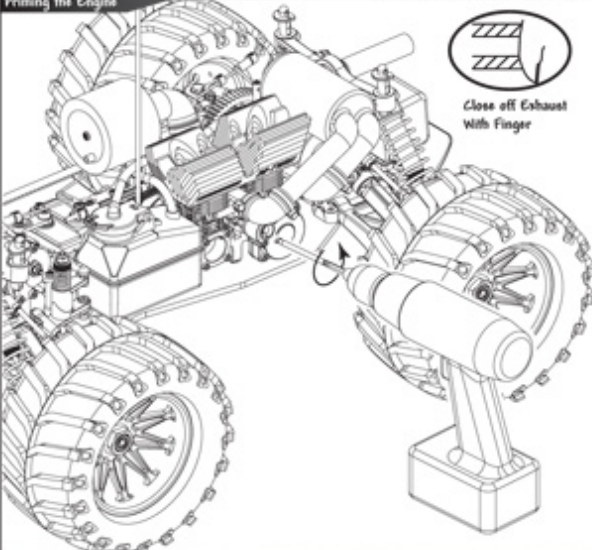

Close off Exhaust With Finger



Turn on Transmitter and Receiver
Check the linkages (page 5)
and make sure that they are correct

With the Drill **STATIONARY**
Insert the ball end into the electric start.
Close off exhaust with your finger.
Turn on the Drill and watch for the fuel to enter the carburettor.
Once the fuel has entered the carb continue turning the engine over for 5 more seconds.
The engine should now be primed.

STARTING THE ENGINE

Starting Engine

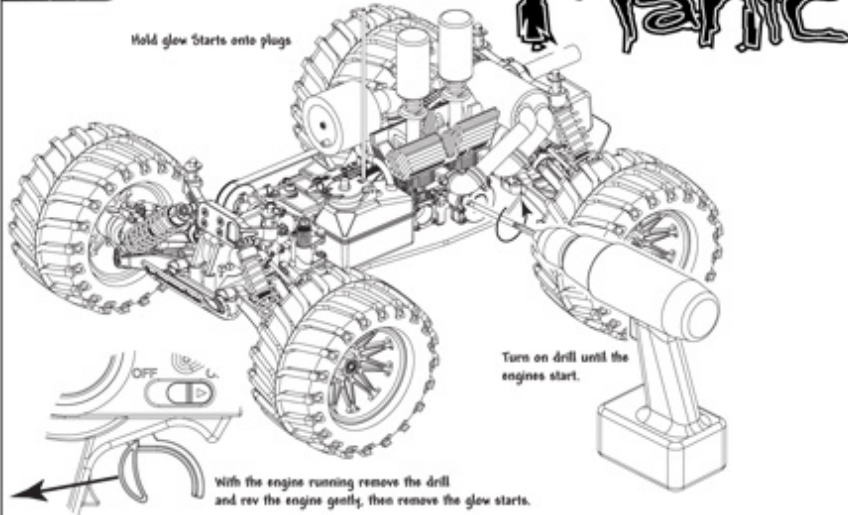

Stopping Engine



Ensure the engine is at idle before stopping.

Block the rubber exhaust pipe to stop the engine.

WARNING: THE ENGINE AND EXHAUST SYSTEM WILL BE VERY HOT DO NOT TOUCH

Running in engine from new

To ensure that your engine has a long life it needs to be "run in" before being "raced". This is done by running the car for 2 or 3 tanks full of fuel, with a rich carb setting (see page 8) and only using a maximum of half throttle.

After the running in Period

After you have finished running in your new engines you may have to re-adjust the carb setting for optimal running see page 8 for details on how to adjust the settings also the needle rollers in the clutch bell will need to be oiled after every hours use, apply 2 small drops of oil as shown below.

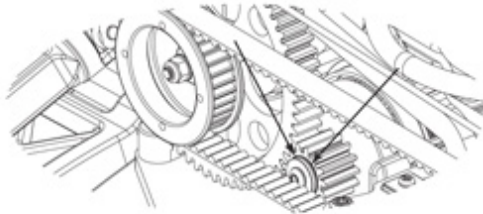

CARB SETTINGS

Manic

Idle Speed Setting



TRANSMITTER ZERO/NEUTRAL



IDLE SCREW



SET IDLE SPEED AS HIGH AS POSSIBLE WITHOUT THE CAR EDGING FORWARDS

Low Speed Mixture Screw



TRANSMITTER - 60-STOP (MAX ACCELERATION)



1.5MM BELOW SURFACE

LOW SPEED MIXTURE SCREW



High Speed Mixture Screw

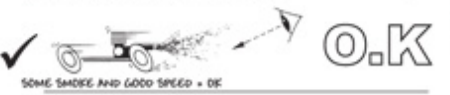

TRANSMITTER MAX FULL SPEED



IF THE CAR BEGINS TO LOSE PERFORMANCE AFTER A FEW MINUTES IT IS PROBABLY OVERHEATING (TOO LEAN). YOU MUST STOP AND UNSCREW THE HIGH SPEED MIXTURE SCREW 3 TURNS ANTI-CLOCKWISE



SETTINGS GIVEN ARE FOR A STARTING POINT ONLY SMALL ADJUSTMENTS MAY BE REQUIRED DEPENDING ON THE CONDITIONS

TROUBLE SHOOTING

If you experience any of the following problems with your manic please try these remedies before you contact the shop where you purchased it from.



ENGINES WILL NOT START

FUEL TANK EMPTY	FILL TANK WITH CORRECT FUEL
ENGINE NOT PRIMED	REPRIME ENGINE (SEE PAGE 6)
CLOGGED AIR FILTER	CLEAN OR REPLACE AIR FILTER
OVER PRIMED (FLOODED ENGINE)	REMOVE GLOW PLUGS THEN TURN ENGINE OVER TO DISCHARGE THE EXCESS FUEL.
INCORRECT CARBURETTOR ADJUSTMENT	CHECK SETTING (SEE PAGE 8)
INCORRECT LINKAGE ADJUSTMENT	READJUST LINKAGES (SEE PAGE 5)
WORN OUT ENGINE	REPLACE PISTONS AND LINERS
BLOWN PLUGS	REPLACE GLOW PLUGS

ENGINE STALLS

FUEL TANK EMPTY	FILL TANK
CLOGGED AIR FILTER	CLEAN OR REPLACE AIR FILTER
INCORRECT CARBURETTOR ADJUSTMENT	CHECK SETTING (SEE PAGE 8)
ENGINE OVERHEATING	ALLOW THE ENGINE TO COOL, THEN UNDO THE HIGH SPEED MIXTURE SCREW 1/8 TURN
CLUTCH DRAG	OIL PINION (SEE PAGE 7)

POOR ENGINE RESPONSE

INCORRECT CARBURETTOR ADJUSTMENT	CHECK SETTING (SEE PAGE 8)
FUEL TANK PRESSURE PIPE LOOSE, DETACHED, DAMAGED OR BLOCKED	REPLACE OR REFIT PRESSURE PIPE
WORN ENGINE	REPLACE PISTONS AND LINERS

POOR CAR CONTROL

WEAK OR FLAT BATTERIES IN TRANSMITTER	RECHARGE OR REPLACE BATTERIES
WEAK OR FLAT BATTERIES IN RECEIVER	RECHARGE OR REPLACE BATTERIES
TRANSMITTER AERIAL NOT EXTENDED	EXTEND AERIAL
POOR ADJUSTMENT OF LINKAGES	RE-ADJUST LINKS (SEE PAGE 5)
CAR TRACKING INCORRECT	RESET THE TRIMS ON THE TRANSMITTER
LOOSE METAL TO METAL JOINTS	CHECK ALL SCREWS ARE TIGHT
RADIO COMPONENTS BROKEN	ISOLATE AND REPLACE BROKEN PARTS

MANIC SPARES



- K095 Manic 3/4 Twin RTR - Blue
- K096 Manic 3/4 Twin RTR - Yellow

CHASSIS PARTS

- U1042 Aerial Mount - Universal
- U1111 Aerial Tube - Pack 4
- U2331 Servo Horns
- U2556 Chassis Buffers & Engine Mount Screws
- U2866 Rear Bumper
- U2191 Ball Gripper Sockets - (pk 6)
- U2048 Chassis Post - Fascal (pr)
- U2101 Grommet - 25mm (pk3)
- U2106 Body Post Set, Heavy Duty (pk4)
- U2456 Chassis, CNC Alloy 6082-T6 - Manic
- U2458 Top Deck - Manic
- U2463 Bumper & Battery Box Supports - Manic
- U2464 Battery Box & Lid - Manic
- U2465 Front Bumper - Manic
- U2477 Instl Manual - Manic
- U2474 Fuel Tank 125cc - Manic
- U2476 Radio Box - Manic
- U2477 Chassis Braces - Manic

BODYSHELLS & DECALS

- U2101 Body & Decal, Clear - Manic
- U2102 Bodyshell & Decal, Blue/Red - Manic
- U2103 Bodyshell & Decal, Yellow/Red - Manic

SUSPENSION

- U2461 Servo Saver Spring - Soft & Hard 2 pcs
- U2874 Pivotal Pin, grooved 3mm x 1/8 (pr)
- U2875 Front Hub Carrier - Havoc (pr)
- U2877 Front Yoke - Havoc (pr)
- U2878 Large Ball Gripper Joints - (pk4)
- U2879 Pivotal Pin, Plain 6mm x 4mm (pr)
- U2881 Red End Joint, Heavy Duty (pk4)
- U2882 Turnbuckle Adjuster - 60mm x 4mm (pr)
- U2886 Washbore - Havoc (pr)
- U2887 Yoke Pivotal Pin - Havoc (pr)
- U2932 Turnbuckle Adjuster, Gold - 45mm (pr)
- U2934 Turnbuckle Adjuster, Gold - 60mm (pr)
- U2452 Radius Arm & Post, Left - Manic
- U2453 Radius Arm, Right - Manic
- U2454 Turnbuckle Adjuster - 6mm x 4mm (pr)
- U2462 Shock Mount, Rear - Manic
- U2463 Shock Mount, Front - Manic
- U2467 Straps, Fr & Rr - Manic
- U2445 Ball Studs, Ultra Short - pk 4
- U2446 Ball Studs, Short - pk 4
- U2447 Ball Studs, Long - pk 4
- U2546 Steering Post, Tube & Nut - 3/4 Twin
- U2547 Servo Saver Mouldings - 3/4 Twin

SHOCK ABSORBERS

- U2190 Shock Mouldings-Vari Click Piston (pr)
- U2143 One Piece Shock Pistons - 4 sets of 3
- U2460 Alloy Shock Body, Long Purple (pr)
- U2892 Alloy Shock Body, Ultra Long Purple (pr)
- U2893 Shock Shafts, Front - Havoc (pr)
- U2894 Shock Shafts, Rear - Havoc (pr)
- U219 Spring Stop & Spacer Mouldings (pr)
- U295 Vari Shock Seal Pack (pr)

SHOCK OIL

- G090 Pure Silicone Shock Oil - 30w
- G095 Pure Silicone Shock Oil - 35w
- G040 Pure Silicone Shock Oil - 40w
- G045 Pure Silicone Shock Oil - 45w
- G050 Pure Silicone Shock Oil - 50w
- G055 Pure Silicone Shock Oil - 55w
- G060 Pure Silicone Shock Oil - 60w
- G070 Pure Silicone Shock Oil - 70w
- G080 Pure Silicone Shock Oil - 80w
- G100 Pure Silicone Shock Oil - 100w
- G120 Pure Silicone Shock Oil - 120w

SPRINGS

- U2895 Shock Springs, Front HiOF Yellow (pr)
- U2896 Shock Springs, Rear HiOF Yellow (pr)
- U2897 Shock Springs, Front HiOF Black Dot (pr)
- U2898 Shock Springs, Rear HiOF Black Dot (pr)

TRANSMISSION

- U2393 Universal Joints Bag (pr)
- U2891 W/T Main Gear 24dp - Hi Speed
- U2100 W/T Main Gear 24dp - Standard
- U2103 Diff Gear 44T Hard Steel - Havoc
- U2109 Diff Half, female - Havoc
- U2104 Diff Half, male - Havoc
- U2105 Diff Repair Kit - Havoc
- U2107 Idler Gear 28T Hard Steel - Havoc
- U2108 Pinion 14 Tooth 24 DP - Standard
- U2110 Pinion 17 Tooth 24 DP - Hi Speed
- U2111 Transmission Housings - Havoc (pr)
- U2392 Alloy Rear Aole - Fascal & Piel (pr)
- U2441 Layshaft, Rear - Manic
- U2448 Layshaft & Spacer, Front - Manic
- U2450 Disc Brake Repair Set, Fr & Rr - Manic
- U2461 Wheel Hex - Manic
- U2467 Bolt, 15T x 8mm - Manic
- U2466 Pulley & Fence, 3/4T - Manic
- U2468 Wheel Hex Retainer - Manic (pk4)
- U2469 Driveshaft, Alloy Male - Manic pr
- U2470 Driveshaft, Plastic Female - Manic pr
- U2475 Wheel Nut, U8 Purple Alloy pr

BEARINGS & BALLS

- U2901 Silicons Diff Lube - Pot
- U2951 Moly Aole Grease - Pot
- U2478 Ball Bearing - 5 x 10 x 4 Sealed (pr)
- U2912 Ball Bearing 10x19x5mm 2FS (pr)
- U2913 Ball Bearing 20x27x4mm 2FS (pr)
- U2915 Ball Bearing 7mm x 14mm 2FS (pr)

SPEED PACKS

- U2544 SPEED PACK - Short MF, Cap Hd
- U2545 SPEED PACK - M3 Cap Hd 14,20mm
- U2546 SPEED PACK - M3 Cap Hd 25,30,35,45mm
- U2547 SPEED PACK - M3 Nuts
- U2548 SPEED PACK - M3 Washers
- U2549 SPEED PACK - M4 Nuts & Washers
- U2550 SPEED PACK - Socket Wrenches (pk3)
- U2551 SPEED PACK - C Clips 2x8pcs
- U2552 SPEED PACK - R Clips
- U2545 SPEED PACK - Small Self Tap, PanHd
- U2473 SPEED PACK - Small Pins (pk)
- U2700 SPEED PACK-M4x12 Ck Hi Tensile (4)
- U2711 SPEED PACK - Twraps (pk25)
- U2960 SPEED PACK - O Rings, Various
- U2328 SPEED PACK - Grub-Set Screws M3 M4
- U2581 SPEED PACK - Torx M3 x 8 Ck
- U2591 SPEED PACK - Torx M3 x 12 Ck
- U2691 SPEED PACK - Torx M3x20mm Ck Hd
- U2640 SPEED PACK - Torx M3x6mm Pan Hd
- U2642 SPEED PACK - Torx M3x10mm Pan Hd
- U2643 SPEED PACK - Torx M3x12mm Pan Hd
- U2644 SPEED PACK - Torx M3x16mm Pan Hd
- U2700 SPEED PACK - M3 Button Hd, 4 to 20
- U2897 SPEED PACK - Small Cable Ties (pk25)
- U2898 Alloy M3x6 Spacer Sets 0.5,1,2,3mm - 8pcs
- U2141 SPEED PACK - Torx M4x12 Ck
- U2142 SPEED PACK - Torx M4x16 Ck
- U2143 SPEED PACK - Torx M4x20 Ck
- U2144 SPEED PACK - Torx M4x24 Ck
- U2145 SPEED PACK - Hi Tensile M4x30 Ck
- U2021 SPEED PACK - M3x6 Ck Allen Hi-T
- U2022 SPEED PACK - M3x12 Ck Allen Hi-T
- U2131 Alloy Spacers M3x1mm 0.5,1,2mm (pk18)
- U2146 SPEED PACK - M3.5 Screws pk 10
- U2455 SPEED PACK - M4x25 & M4x30 Ck pk8

MANIC SPARES



NITRO ACCESSORIES

CR040 CORE RC - Long Glow Starter; Purple Alloy - Meter
CR041 CORE RC - Long Glow Start; Blue Alloy-Meter
CR50 Nitro Starter Set - UK 240v
CR51 Nitro Starter Set - USA 110v
CR55 Glow Starter; 1800mAh - USA 110v
CR57 Nitro Starter Bag - requires D Cell
CR60 Reto Starter Shaft - Sch X18 X18 R18
CR65 Reto Start Assembly - 3/4 Twin
U111F Fuel Pipe - 1/3 metre
U1284 Air Filter; waterproof - 21 - 28 engines
U1289F Air Filter; Purple Alloy - 21 - 28 engines
U12850 Air Filter Foams only - U1289F/U1284
U12851 Fuel Filter; Purple Alloy-Sintered Filter
U12441 Air Filter - 21/28
U12450 Clutch Bell; threaded - Havoc
U12451 Clutch Shoe & Spring Set - Havoc
U1307B Engine Mount Post - Fascal (x4)
U13451 Throttle & Brake Link Set - Manic
U13472 Engine Mount; CNC Alloy - Manic
U13534 Dirt Covers; Syncro Bell - 3/4 Twin
U13535 Flywheel; front engine - 3/4 Twin
U13536 Flywheel; rear engine - 3/4 Twin
U13537 Pulleys; syncro pair - 3/4 Twin
U13538 Belt; syncro drive - 3/4 Twin
U13539 Pinion Service Kit - 3/4 Twin
U13540 Exhaust Manifold - 3/4 Twin
U13541 Exhaust Silicone Elbow - 3/4 Twin
U13542 Tail Pipe & Wire Mount - 3/4 Twin
U13543 Silencer; polished alloy - 3/4 Twin
U13544 Syncro Assy Jigs - 3/4 Twin pr
U13545 Engine Plate; alloy - 3/4 Twin
U13548 Rubber Mounts; fuel tank pr

NITRO MOTORS & PARTS

CR101 Burn Room - Sch R18
CR105 Cylinder Sleeve/Piston - Sch R18
CR106 Connecting Rod - Sch R18
CR108 Head Shim Washer spec - Sch R18
CR109 Wrist Pin - Sch R18
CR110 Cylinder Head Bolt Apes - Sch R18
CR112 Carb Pinch Bolt - Sch R18
CR113 Circlips; Wrist Pin - Sch R18
CR114 D Ring Set; Carb & Back Plate - Sch R18
CR119 One Way Bearing Set - Sch R18
CR121 Starting Shaft - Sch R18
CR123 Rear Cover Bolts M3.6x6 - Sch R18
CR123 Pin & Spring; Pull Start - Sch R18
CR124 Glow Plug - Sch R18
CR126 Crankshaft - 3/4 Twin
CR127 Back Plate; Reto Start - 3/4 Twin
CR128 Back Plate; front engine - 3/4 Twin
CR129 Crankcase & Bearings - Sch R18
CR130 Inlet Manifold Assy - 3/4 Twin
CR131 Carb; complete - 3/4 Twin
CR132 Cone , Nut, Washer & Shim - 3/4 Twin
CR133 Power Unit - 3/4 Twin
U13533 Cool Head - 3/4 Twin

ELECTRONICS

CR051 CORE HD Servo; 1Kg Metal Gear 2xSD 0.12sec
CR10 Alloy Servo Arm; Futaba Purple
CR11 Alloy Servo Arm; ECU/Sansa Purple
CR12 Alloy Servo Arm; Futaba Blue
CR13 Alloy Servo Arm; ECU/Sansa Blue
CR17 Alloy Servo Arm; Futaba Black
CR18 Alloy Servo Arm; ECU/Sansa Black
CR32 Battery Box & Switch; 4 x AA
CR33 Servo - 3.0 Kg Cm 0.14 sec/60deg
CR35 Transmitter 27MHz FM - Wheel
CR36 Receiver - 27MHz FM
CR37 Mini Temp Gun - 420F 230C
CR43 Crystal pair - 27MHz FM - CH3
CR44 Crystal pair - 27MHz FM - CH6
H1033 Micro Fallsafe; waterproof
U1471 Radio Switch & Battery Holder - Manic

SPEED SECRET - OPTION PARTS

U1246 Purple Alloy Wishbones (pr) - Havoc
U1247 Wheels Bar; Chrome Steel - Havoc

TEAM CLOTHING

CR15 Pit Towel
CR21L Ski Jacket; Red/Black Embroidered-Lg
CR21M Ski Jacket; Red/Black Embroidered-Med
CR21XL Ski Jacket; Red/Black Embroidered-XL
CR31L T Blue - Large
CR31M T Blue - Medium
CR31S T Blue - Small Man
CR31XL T Blue - X-Large
CR31XXL T Blue - XX-Large
CR33L Polo - Large
CR33M Polo - Medium
CR33S Polo - Small Man
CR33XL Polo X Large
CR33XXL Polo - XX-Large
CR33XXX Polo - XX-Large
CR34 Cap - Black; Medium 58cm
CR35 Cap - Black; Large 62cm
CR36L Sweat - Large
CR36M Sweat - Medium
CR36S Sweat - Small
CR36XL Sweat - X-Large
CR36XXL Sweat - XX-Large

CHARGERS

CR41 Charger 240v UK; 6 x AA or AAA
H1096 Adapter Lead - Rs Pack to Tamija

BATTERIES

CR041 CORE RC - 1500 NiMH 6.0v Rs Flat Pack
CR043 CORE RC - 1500 NiMH 6.0v Rs Hump Pack
GT18 GP Alkaline AA Pencil; Card 4
GT21 AA Pencil 2700NiMH - Card 4

TOOLS

H106 Fuel Bottle - 250cc
H107 Fuel Bottle - 500cc
H108 5 Way Glow Plug Wrench
H1095 4 Way Glow Plug Wrench
H1090 Nitro Cleaner Aerosol 500ml
H1091 Pipercross Air Filter Oil - Aerosol
H1098 Pipercross Air Filter Cleaner - Aerosol
H1095 GT85 Lube & Clean Aerosol 400ml
H1008 Wilha Torx Driver - T10
H1009 Wilha Torx Driver - T20
H1010 Circlip Pliers; Internal
PT5042 Alloy Grip Long Mixture Driver
U1291 Schumacher Hex Driver - 1.5mm
U1290 Schumacher Hex Driver - 2.0mm
U1291 Schumacher Hex Driver - 2.5mm
U1292 Schumacher Hex Driver - 3.0mm
U1294 Schumacher Driver - Tip TORX
U1295 Schumacher M3 Nut Driver
U1296 Schumacher M4 Nut Driver
U1315 Schumacher Hex Driver - 1.5mm Tip only
U1316 Schumacher Hex Driver - 2.0mm Tip only
U1317 Schumacher Hex Driver - 2.5mm Tip only

MONSTER TRUCK WHEELS & TYRES

U1460 Wheel; Chrome 10 spoke - Manic pr
U1795 Chevron pre-Glue - Manic

SCHUMACHER TEAM CLOTHING



Team Polo Shirt
 G9995 - Small Man
 G999M - Medium
 G999L - Large
 G999XL - Extra Large
 G999XXL - XX Large



Team Schumacher Banner
 S600B - 9ft x 6ft



Team "T" Shirt Blue

G9995 - Blue Small Man
 G999M - Blue Medium
 G999L - Blue Large
 G999XL - Blue Extra Large
 G999XXL - Blue XX Large



Team Cap "Flexi-Fit"
 G9994 - Medium - 58cm
 G9995 - Large - 62cm

Team Hooded Sweat Shirt
 G99205 - Small
 G9920M - Medium
 G9920L - Large
 G9920X - Extra Large
 G9920Z - Double Extra Large



Team Race Jacket
 G9991M - Medium
 G9991L - Large
 G9991XL - Extra Large

