

Congratulations on buying the Mi3.5



This car is factory assembled to save you time, and ensure that all the parts fit together correctly. However please refer to the setup sheets at the back of the manual, as small adjustments may be required to setup the car for your individual driving style, and the type of track you race on.

This manual covers the Pro spec and the Race spec versions of the Mi3.5. The box end label will tell you which version you have.

Because this car is assembled, most of the manual will only be required for maintenance, Page 28 onwards deals with finishing the car assembly.

Additional items required.

2 Channel radio Control. Transmitter, Receiver and Steering servo.

Electronic Speed Controller.

Battery Pack. 7.2v NiMH, 6.0v NiMH or 7.4v Lipo.

Battery charger.

Motor and pinion.

Bodyshell and paint.

Wheels and tyres.

AA Batteries for transmitter.

Tools.

See back page of manual for some available option parts.

Safety Notes

- This product is not suitable for children under 14 years of age unless supervised by an adult.
- Select an area for assembly that is away from the reach of small children. The parts are small and can be swallowed by children causing choking and possible internal injuries.
- Shock fluids, grease and adhesives should be kept out of childrens reach. They may be toxic and were not intended for human consumption.
- Exercise care when using hand tools, sharp instruments or power tools during assembly.
- Read the instructions fully and read all manufacturers warnings and cautions for any additional items that may be used for assembly purposes.
- Always drive your car safely and away from public roads, and be aware of any people or animals near you. MODEL CARS CAN BE DANGEROUS.
- Learn to use your power with respect, very few surfaces can cope with full power. If you use full power everywhere you WILL break things.
- Always ensure that the transmitter batteries are fully charged.
- Always ensure that all nuts and screws are tight and the gear mesh is correct.
- Superglue the tyres to the wheels as they may come off at high speeds.
- This product is not a toy, it is a hobby product capable of high performance, but it will require regular maintenance. Learn to drive the car slowly at first, away from solid objects.
- The carbon fibre chassis conducts electricity, beware of short circuiting the batteries.

IMPORTANT

Please read the entire manual before starting the assembly of your new MI-3.5
Before you start Building your car checkout the setup Sheets at the end of the manual or online at www.racing-cars.com to ensure the car is built to suit your driving style and track conditions



Rear Diff Assembly

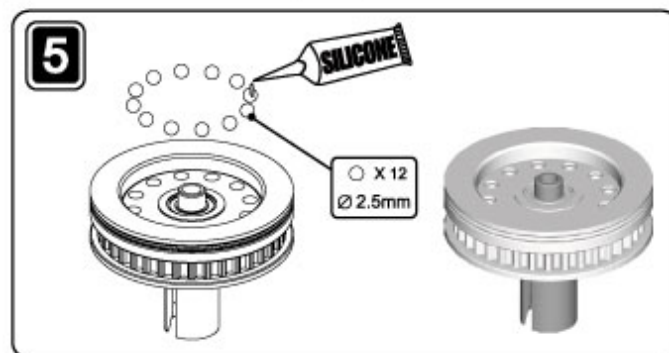
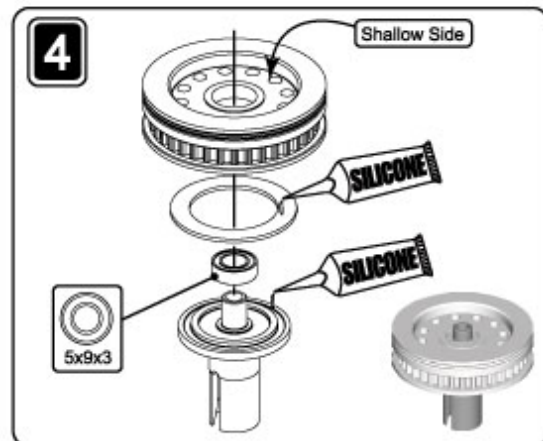
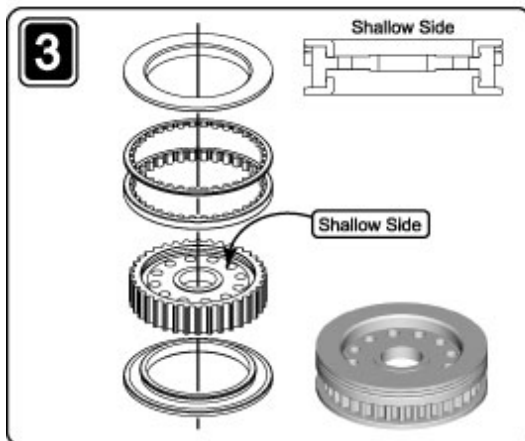
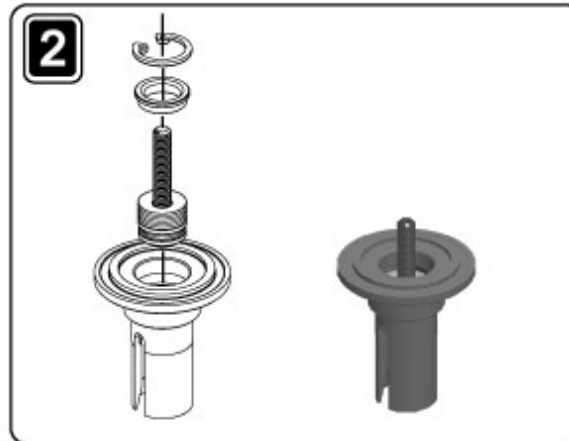
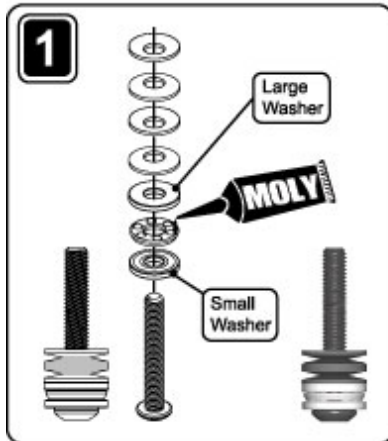

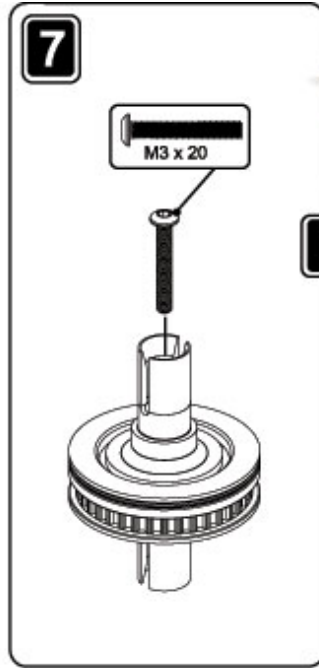
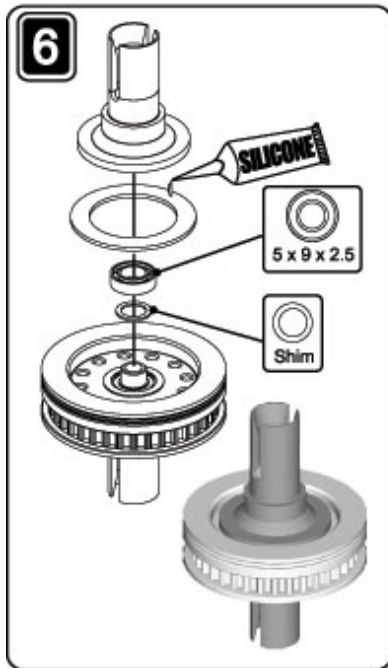

Diff Assembly cont..

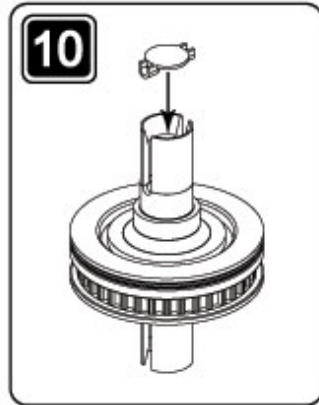
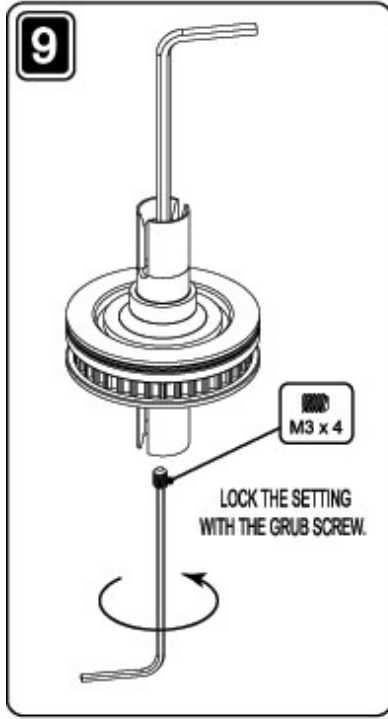
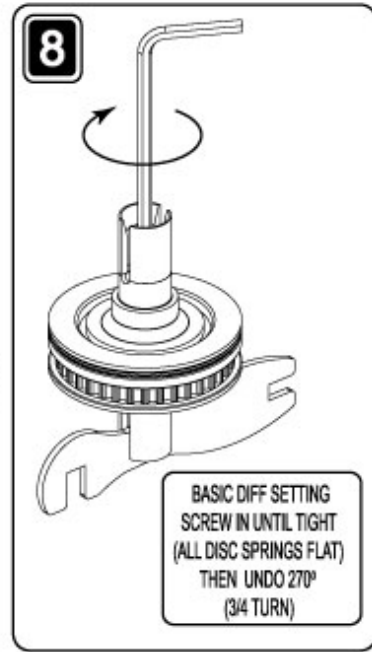

Final Assembly



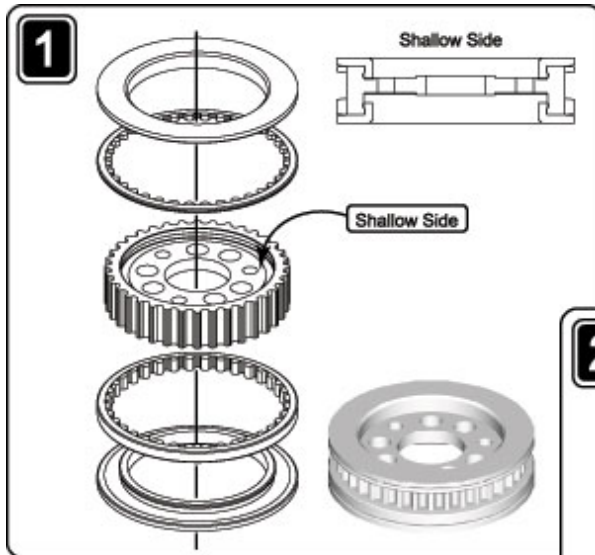

Spool Assembly

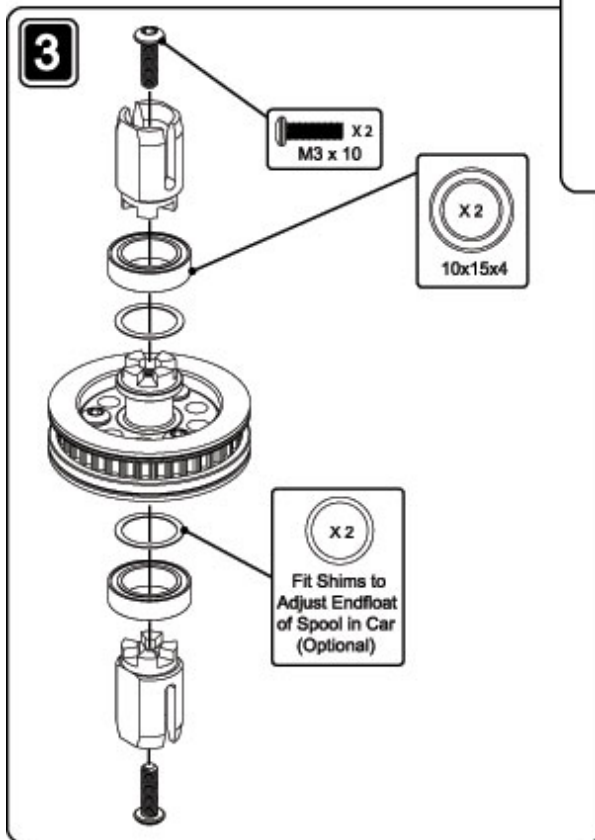
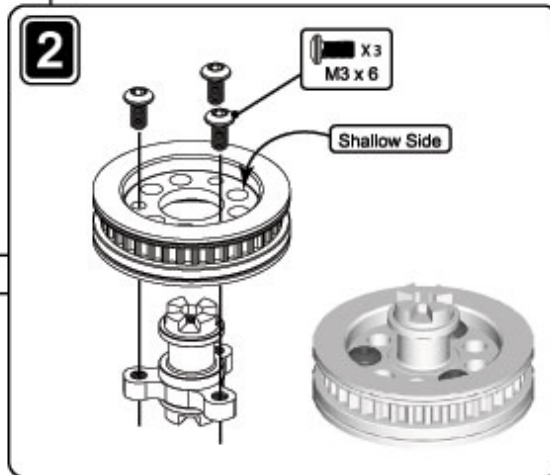

Final Assembly

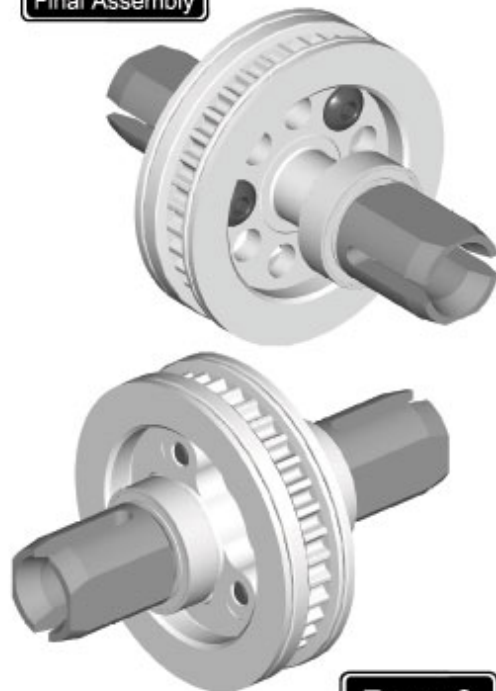

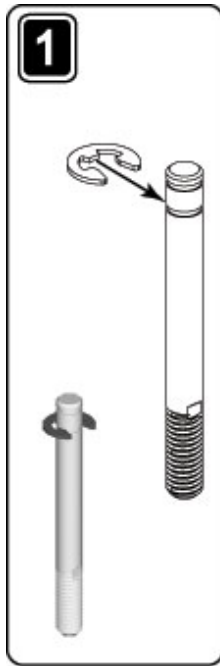

**Shock Assembly
Pro-Spec**

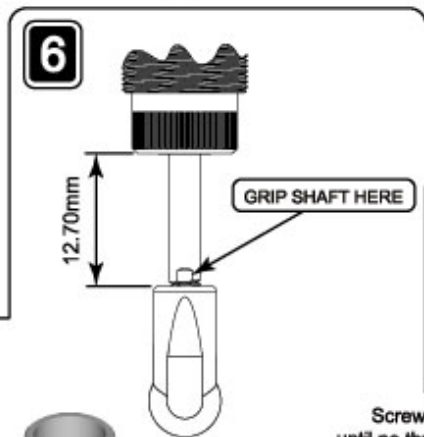
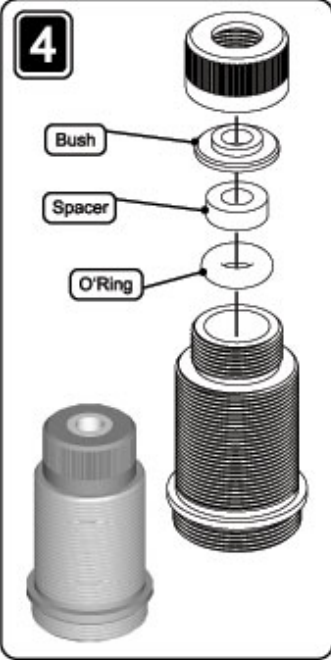

Grip the piston rod very close to the thread.
**BE CAREFUL NOT TO DAMAGE
THE POLISHED SHOCK ROD.**



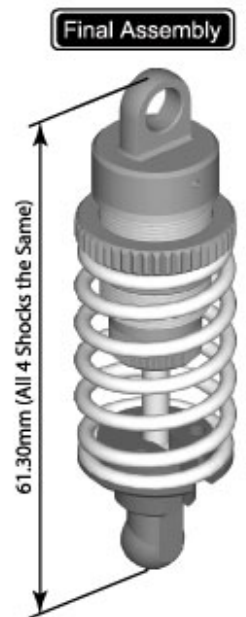
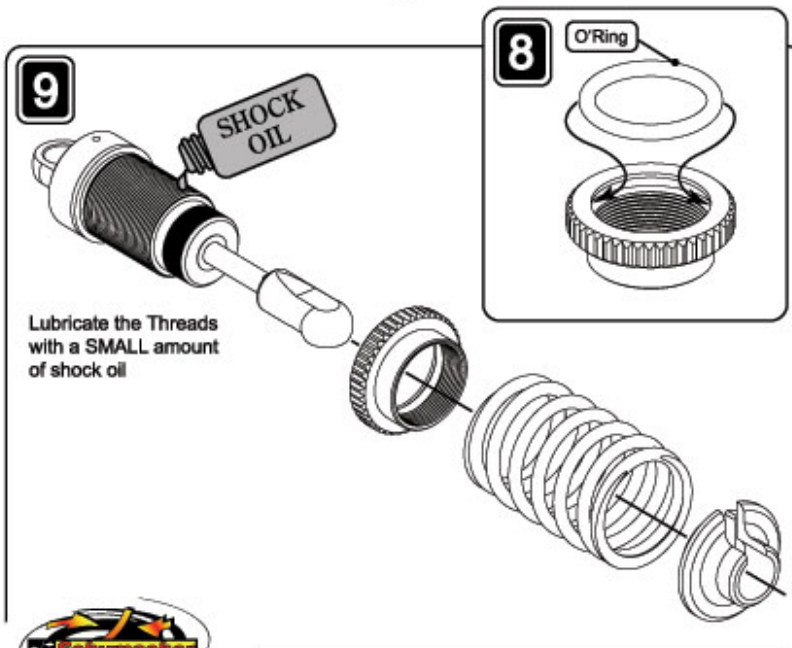
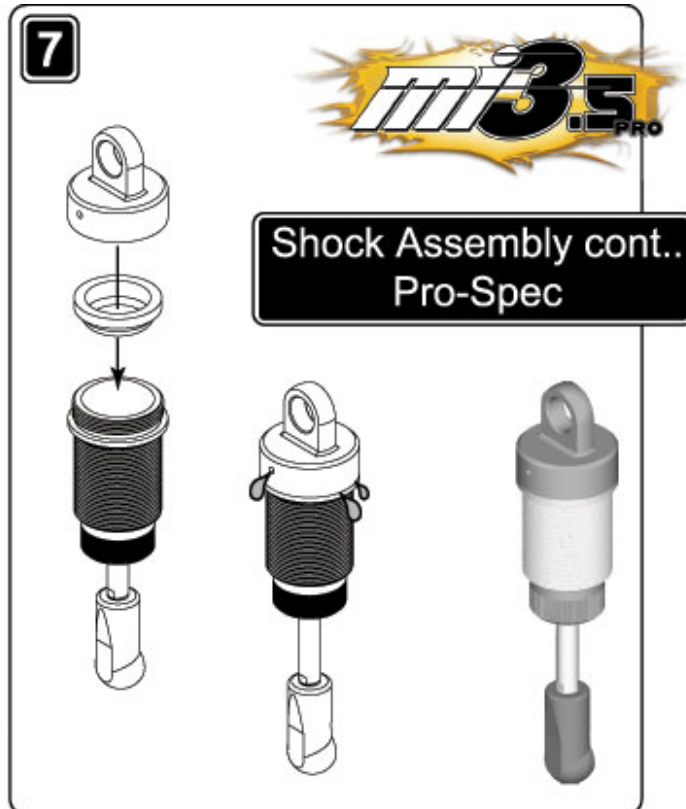
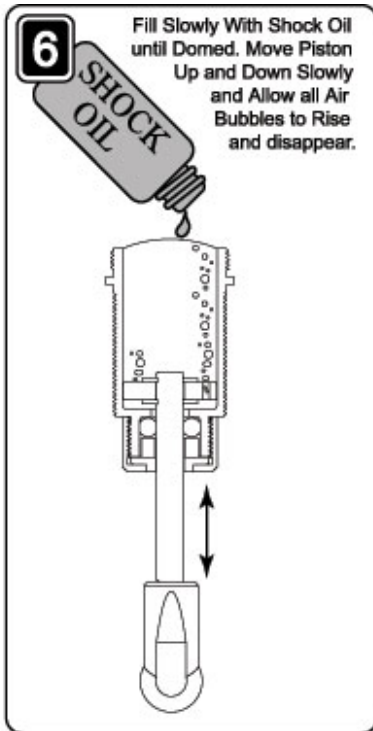

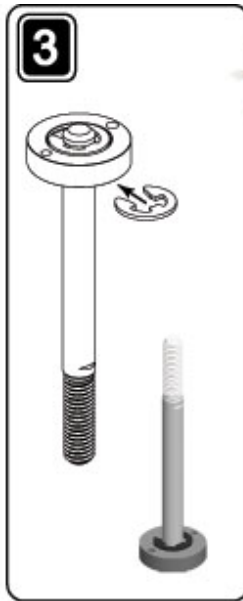

**Shock Assembly
Race-Spec**

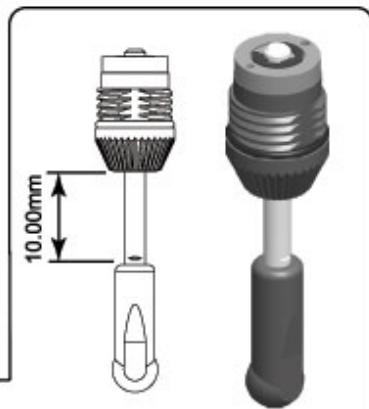
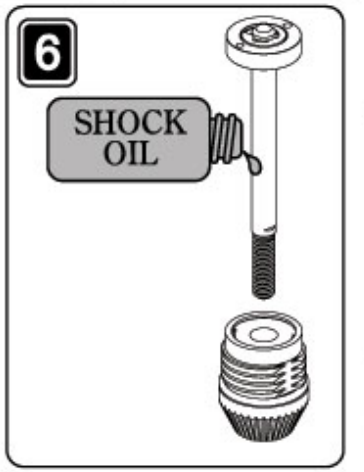
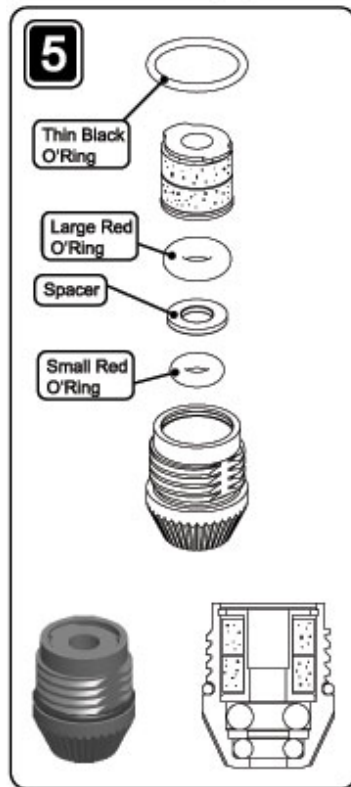

6 Fill Slowly With Shock Oil to the bottom of the thread.

Shock Assembly cont.. Race-Spec

7.00mm

Position assembly as shown and carefully screw into the shock body. (some oil will spill from the body, clean with tissue)

Shock Body (containing oil)

9

64.40mm (All 4 Shocks the Same)

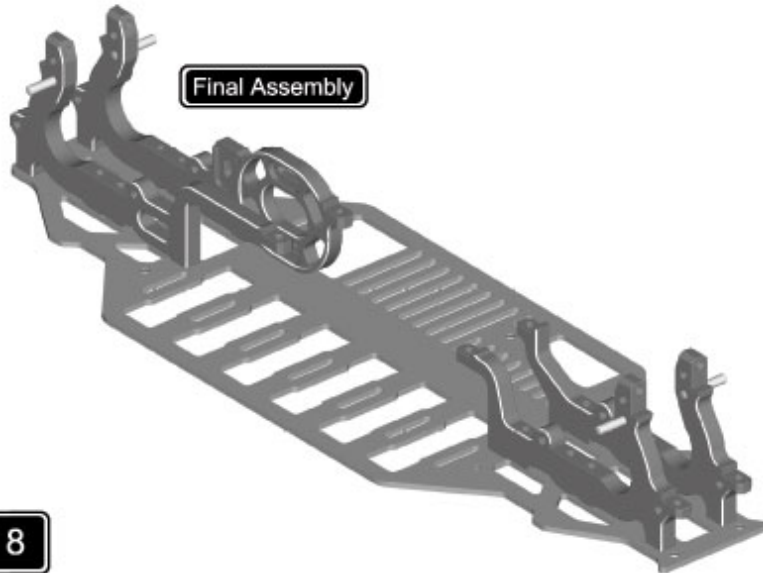
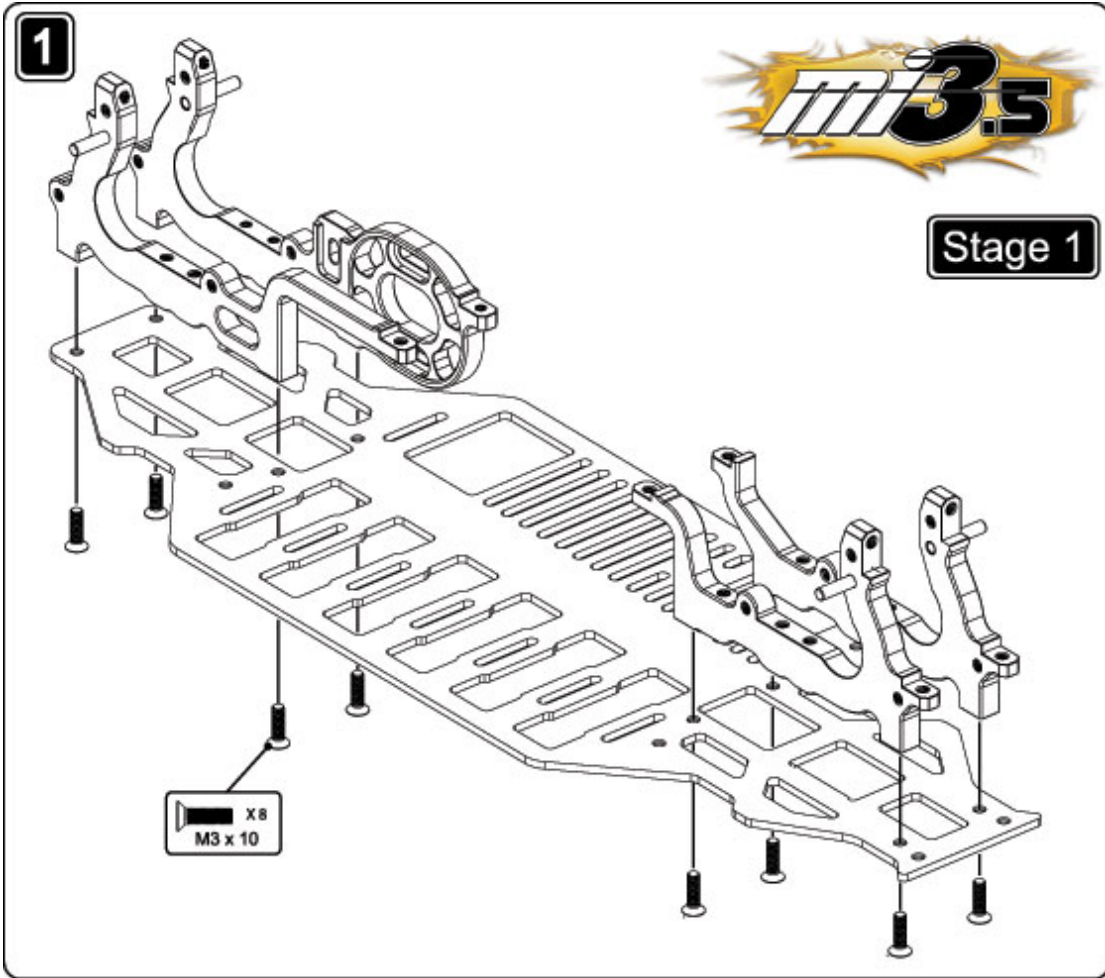

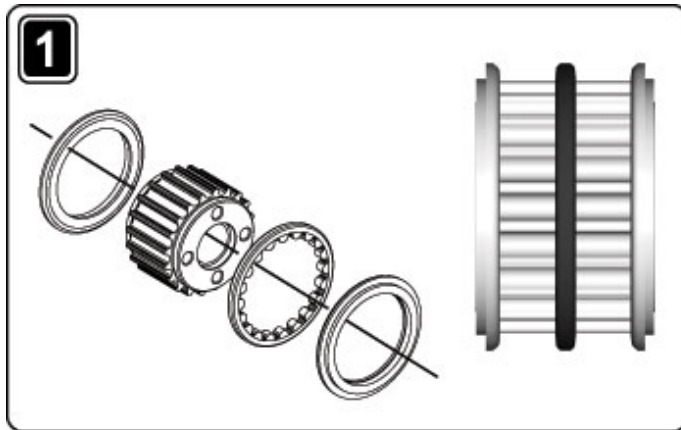

Stage 2

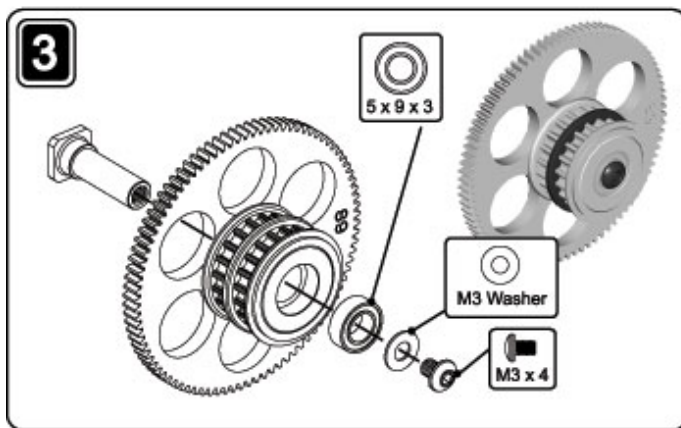
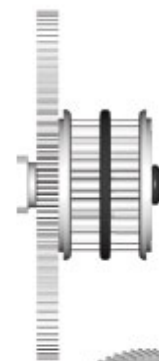
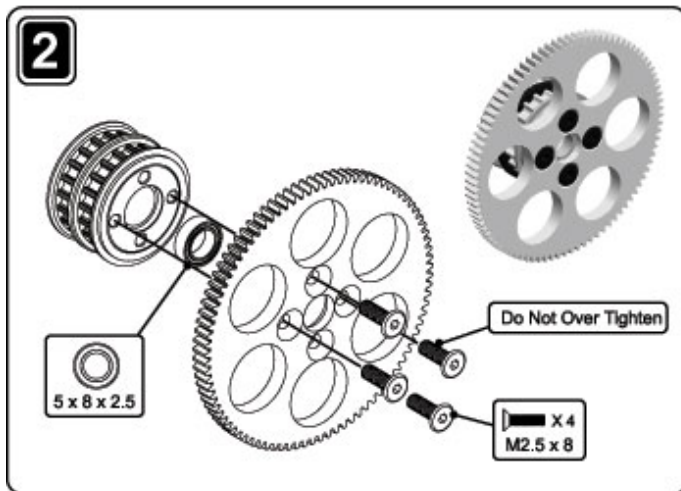

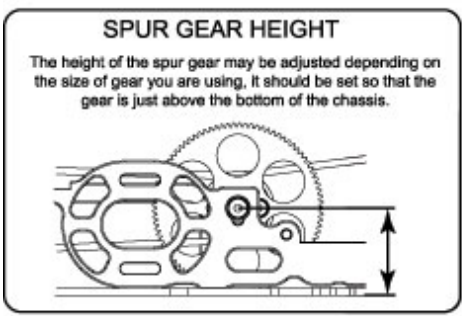
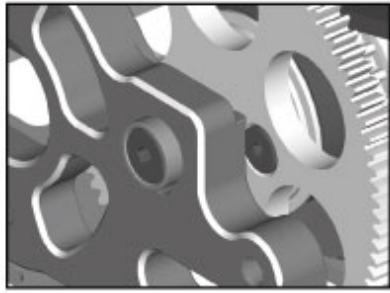
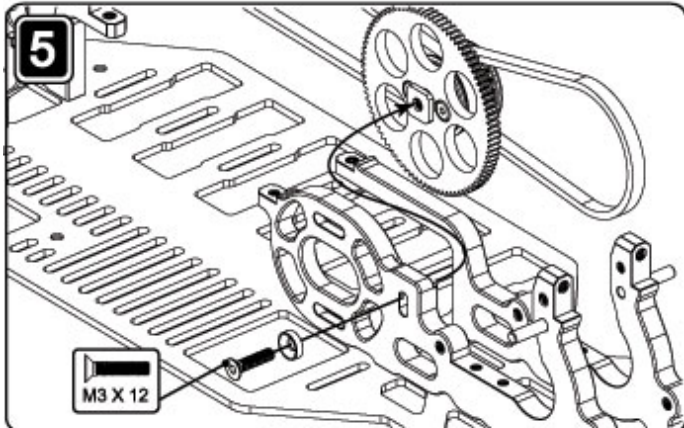
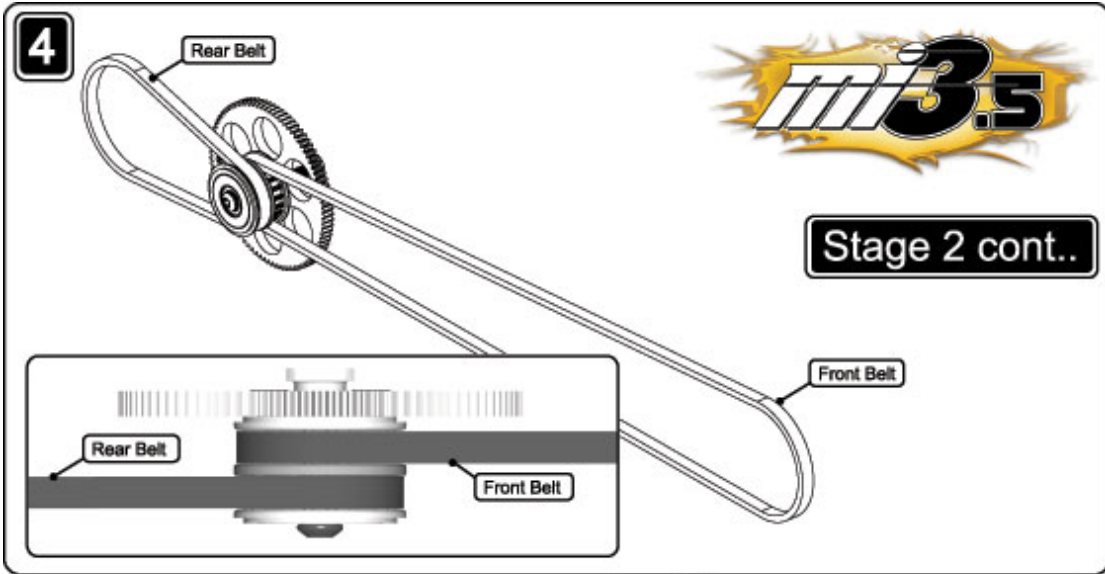

Final Assembly

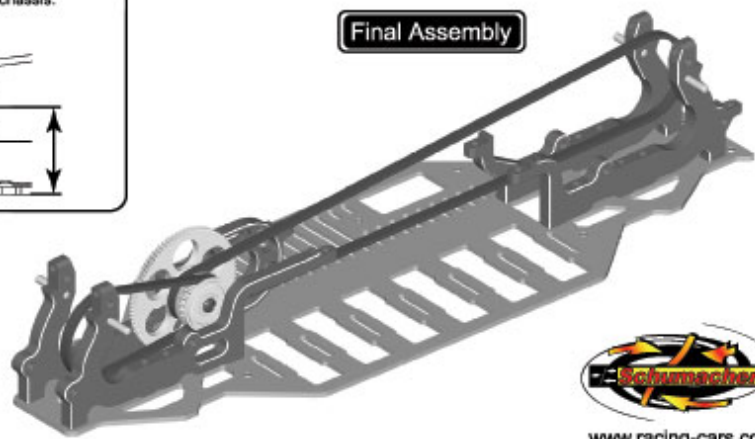



1 Fit Shims to Adjust Endfloat of Diff in Car (Optional) X2

10 x 15 x 4 X2

The Indents Must Face Outwards

High Low

Set the Spool and Diff the Same

2 Stage 3

5.50 mm

5.50mm

Nitrile X4 Damper

3 Nitrile Damper Optional

4 M3 x 20 X2

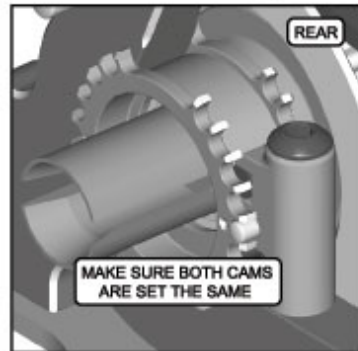

5 The Indents Must Face Outwards

M3 x 20 X2

6

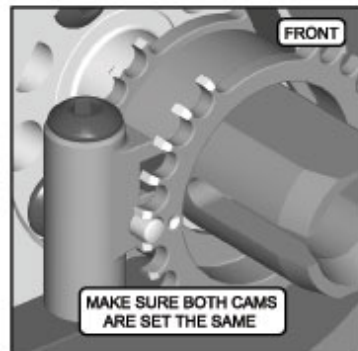

Final Assembly



www.racing-cars.com

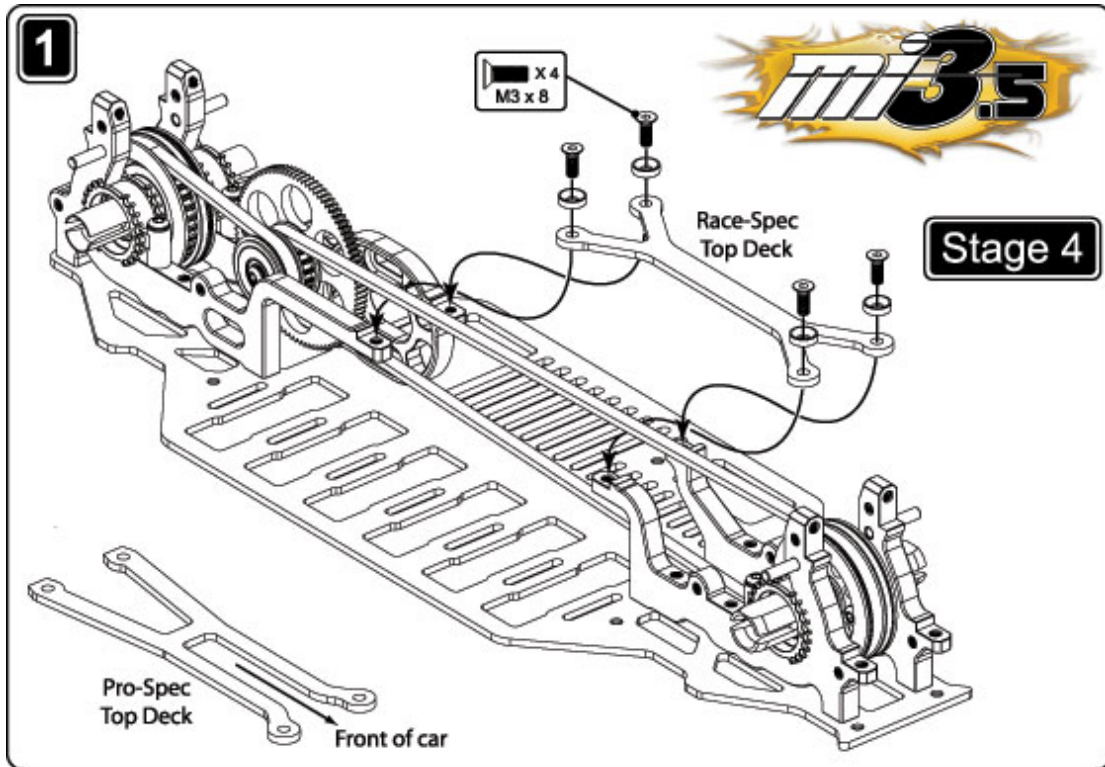

BELT TENSION

BELT TENSION

Rotating the Diff Cam towards the layshaft will decrease the belt tension, and rotating it away will increase the tension.

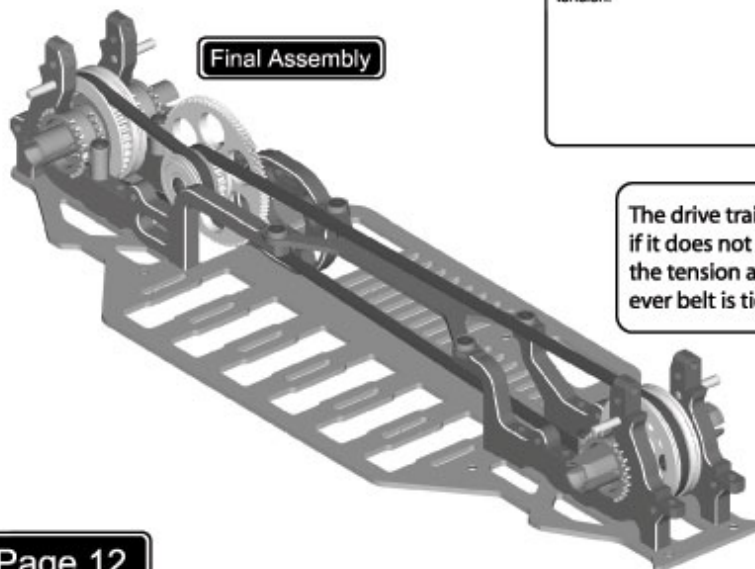
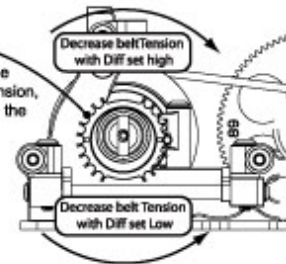

The drive train should now spin freely, if it does not spin freely then decrease the tension as shown above on which ever belt is tight.

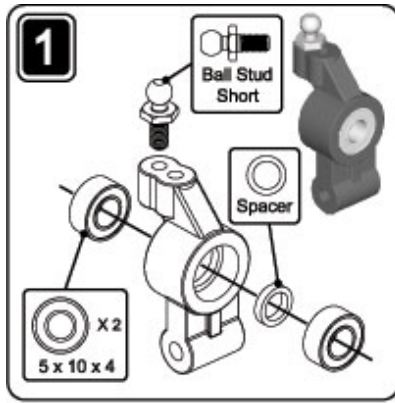

**Rear Suspension
Right hand Side**

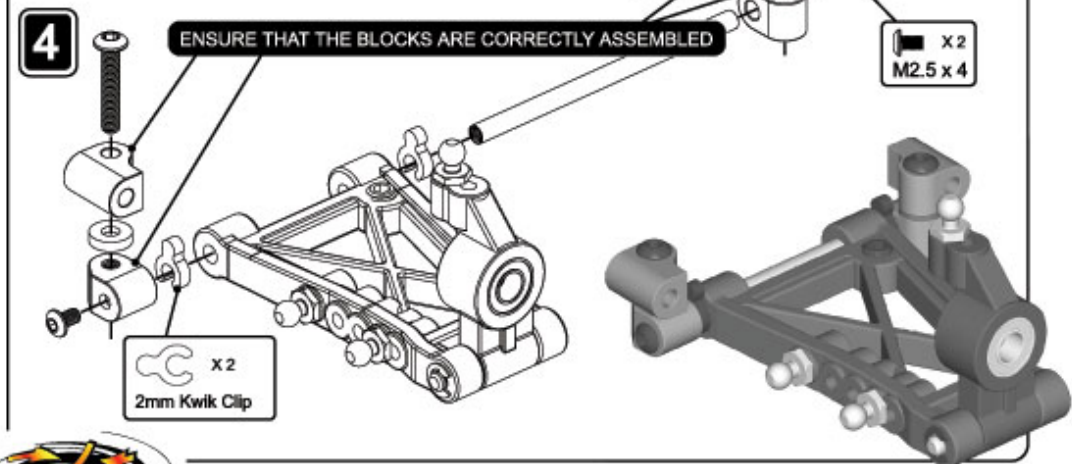
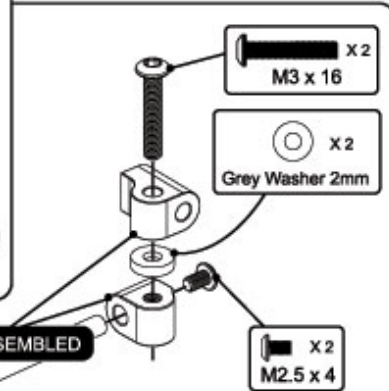
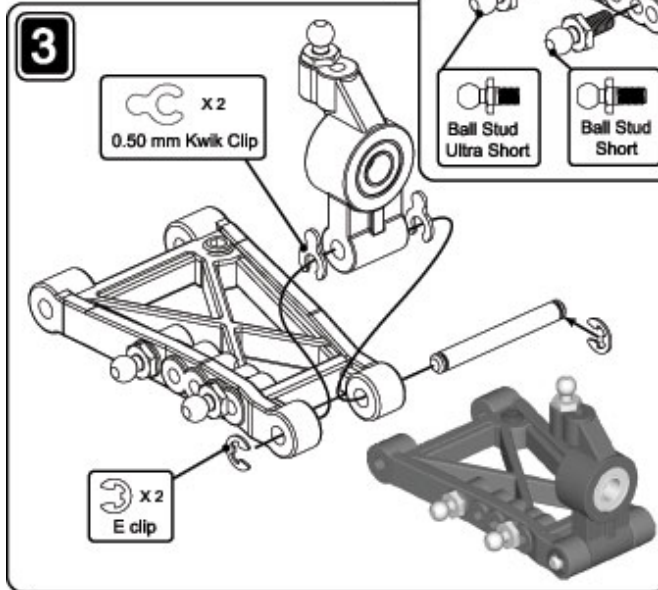
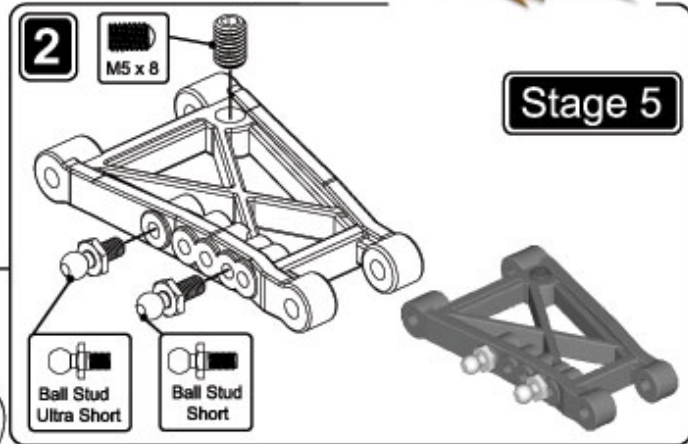



Stage 5 cont..

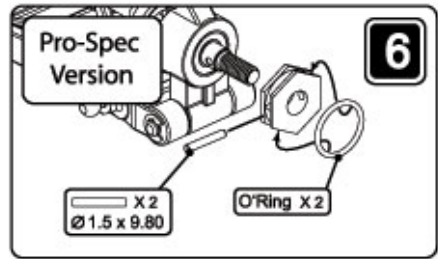
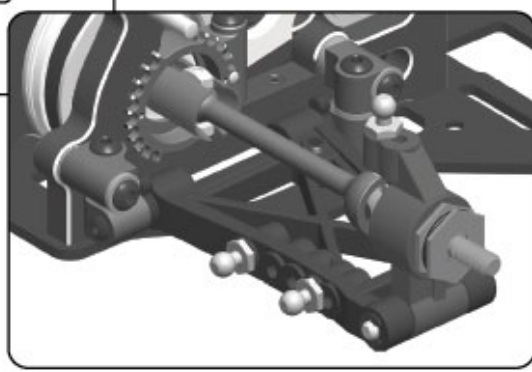
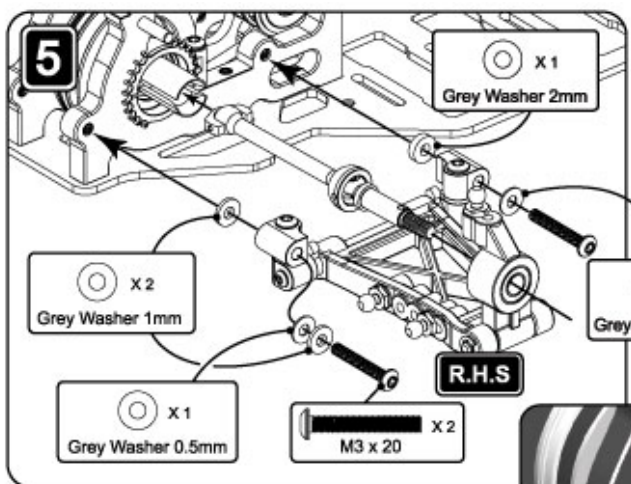

Rear Suspension Left hand Side

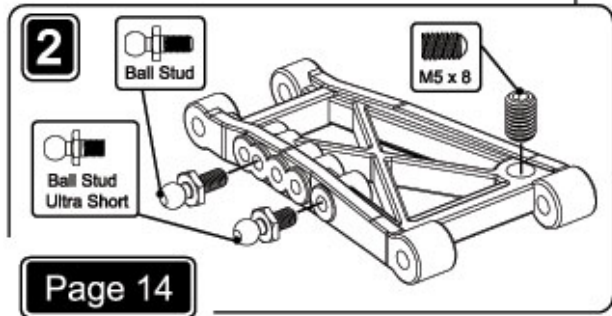
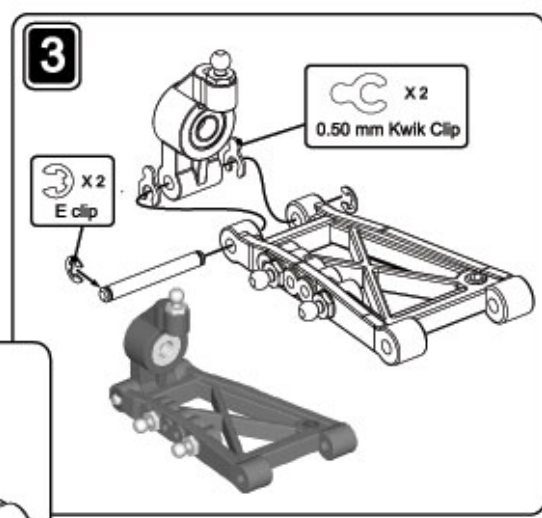
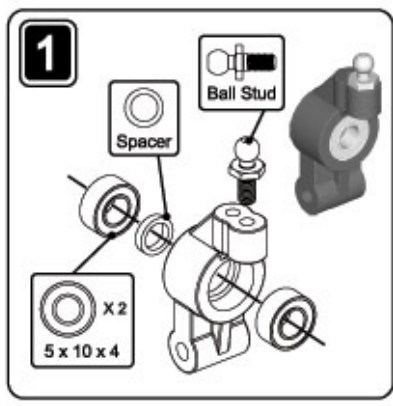

4

ENSURE THAT THE BLOCKS ARE CORRECTLY ASSEMBLED

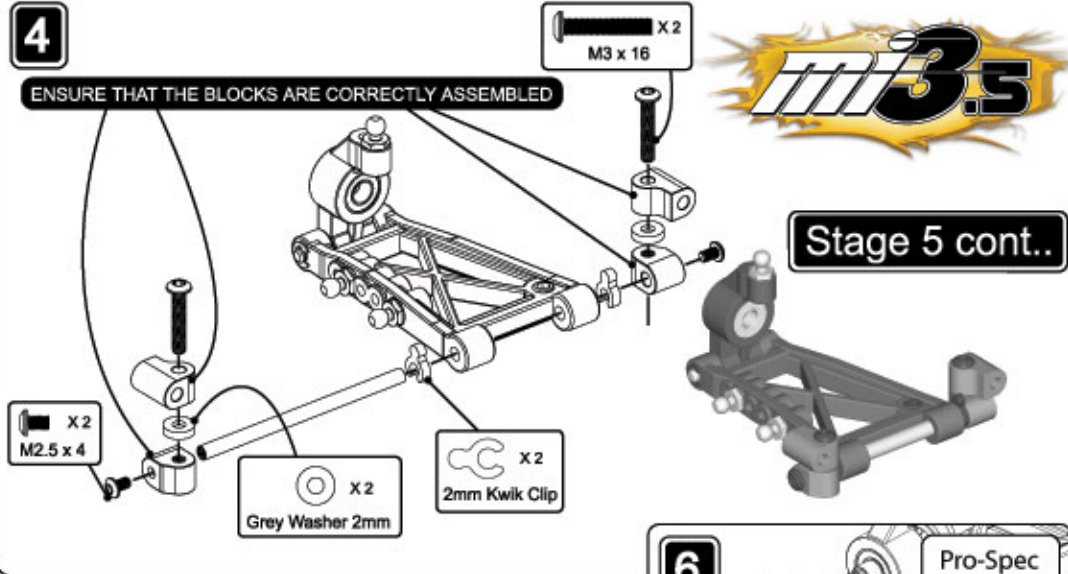

5

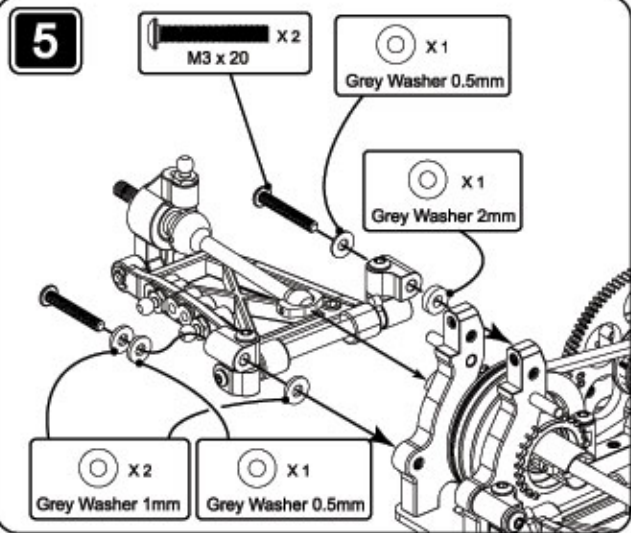

6

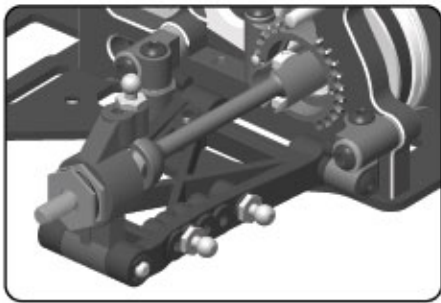
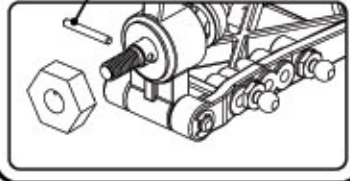
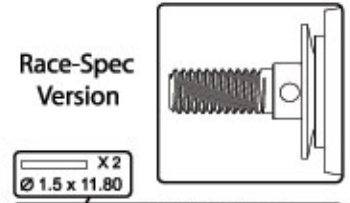
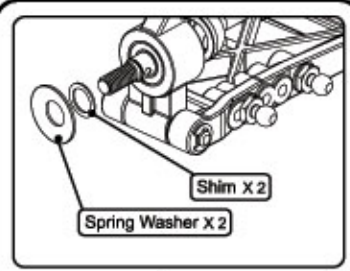
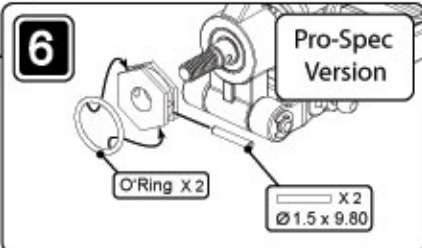

1 Front Suspension Right hand Side

Stage 6

Carefully Pre-tap the Hub Carrier using a Nut Runner and the M4 Pivot, this will ensure easier assembly with the yoke with better alignment.

Ensure Free Movement of the Hub in the Yoke

Adjust the kingpins for minimum gap with free movement

M4 Pivot Ball

Ball Stud

Spacer

M3 Nyloc

5 x 10 x 4

M4 Pivot

Left

Right

Minimum Gap

Minimum Gap

2

Pro-Spec Version

Race-Spec Version

O'Ring

Ø 1.5 x 9.80

Spring Washer

Shim

Ø 1.5 x 11.80

3

Hub Must Lean Backwards

M5 x 8

Ball Stud Ultra Short

Ball Stud

E clip

x 2

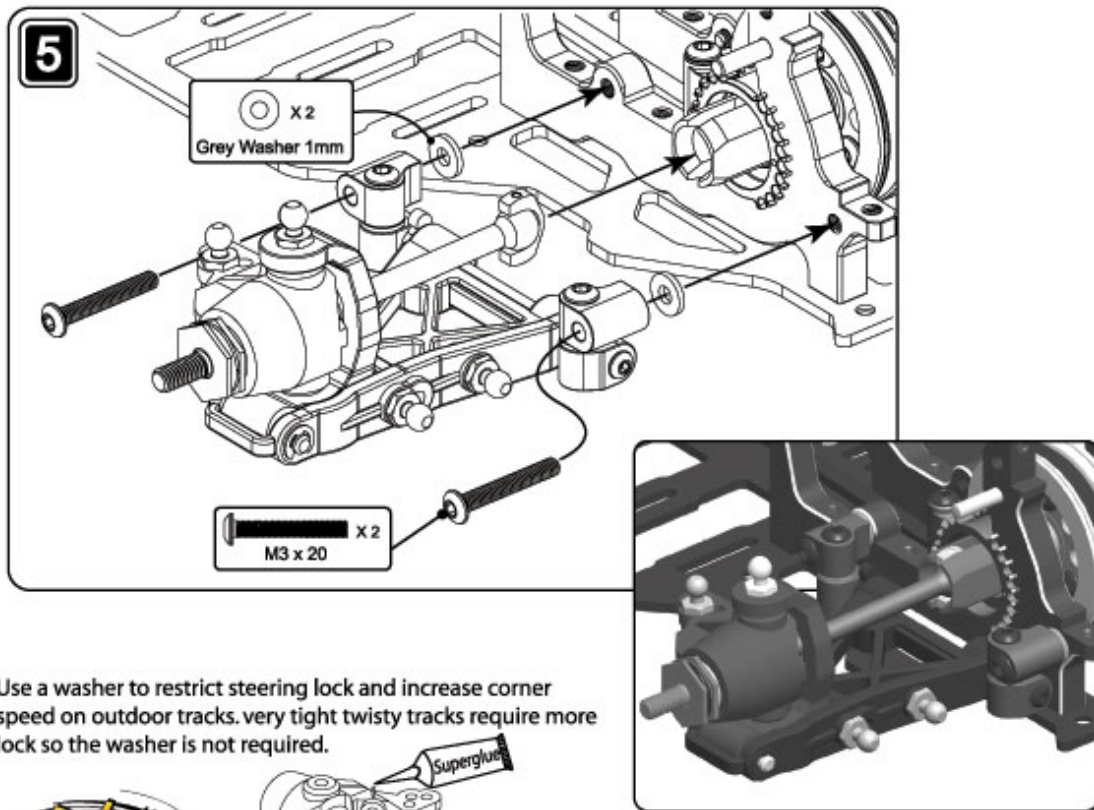
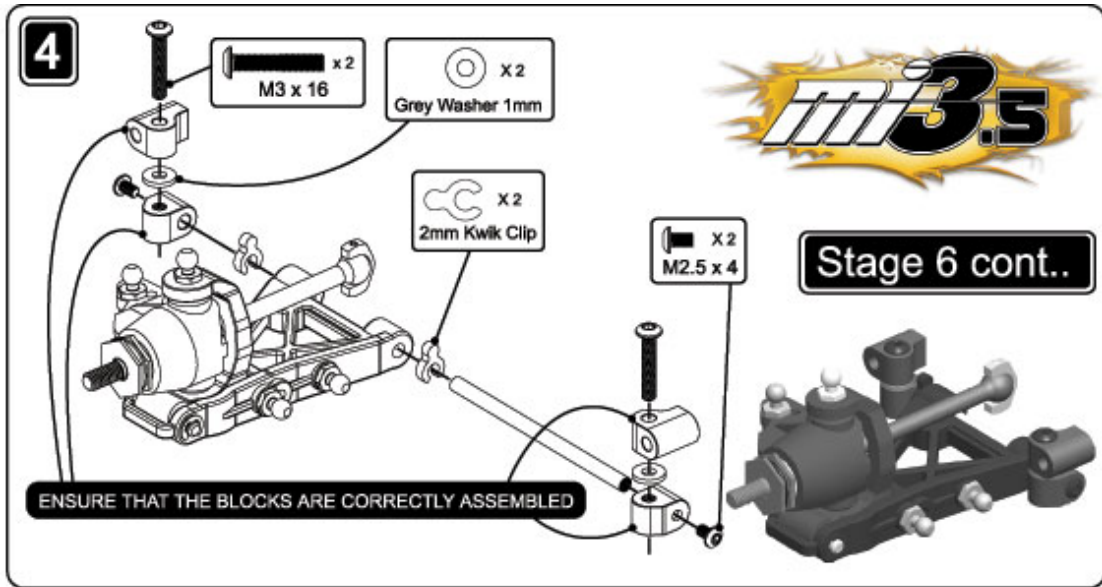

Use a washer to restrict steering lock and increase corner speed on outdoor tracks. very tight twisty tracks require more lock so the washer is not required.



1 Front Suspension Left hand Side

Ensure Free Movement of the Hub in the Yoke

Carefully Pre-tap the Hub Carrier using a Nut Runner and the M4 Pivot, this will ensure easier assembly with the yoke with better alignment.

M4 Pivot Ball

Ball Stud

Left Right

Spacer

M3 Nyloc

M4 Pivot

5 x 10 x 4

mi3.5

Stage 6 cont...

Minimum Gap

Minimum Gap

Adjust the kingpins for minimum gap with free movement

2

Pro-Spec Version

Race-Spec Version

Shim

Spring Washer

Ø1.5 x 11.80

Ø1.5 x 9.80

O'Ring

3

M5 x 8

Ball Stud Ultra Short

Ball Stud

X2 E clip

Hub Must Lean Backwards

4

X2 Grey Washer 1mm

X2 M3 x 16

X2 M2.5 x 4

X2 2mm Kwik Clip

mi3.5

Stage 6 cont...

ENSURE THAT THE BLOCKS ARE CORRECTLY ASSEMBLED

5

X2 Grey Washer 1mm

L.H.S

X2 M3 x 20

Final Assembly

Ensure All the Suspension Components Pivot Freely

Schmieder

www.racing-cars.com

Page 19

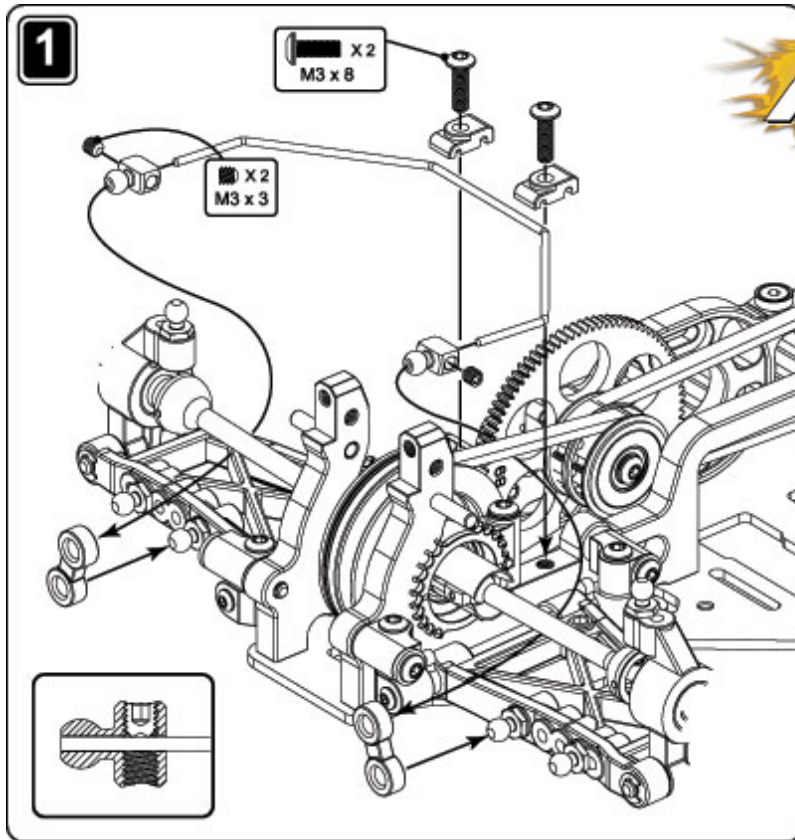

Stage 7
Pro-Spec



Rear Roll Bar
Full Size

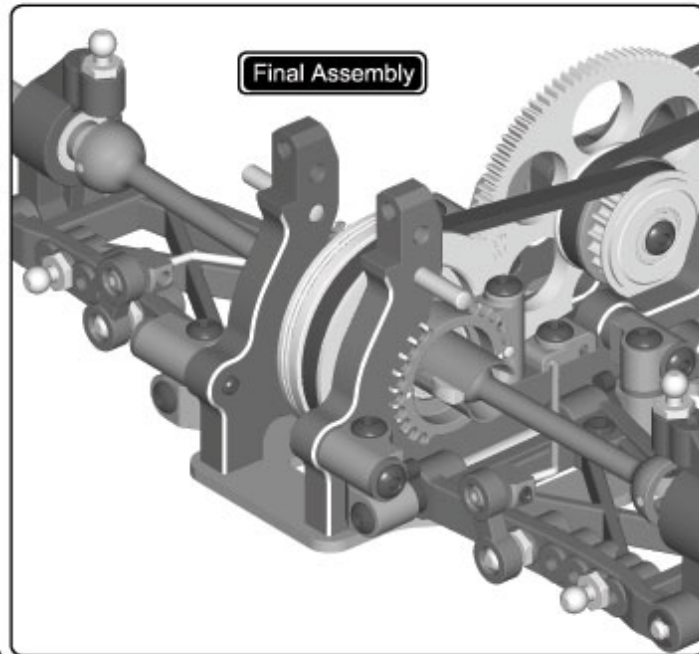

Final Assembly



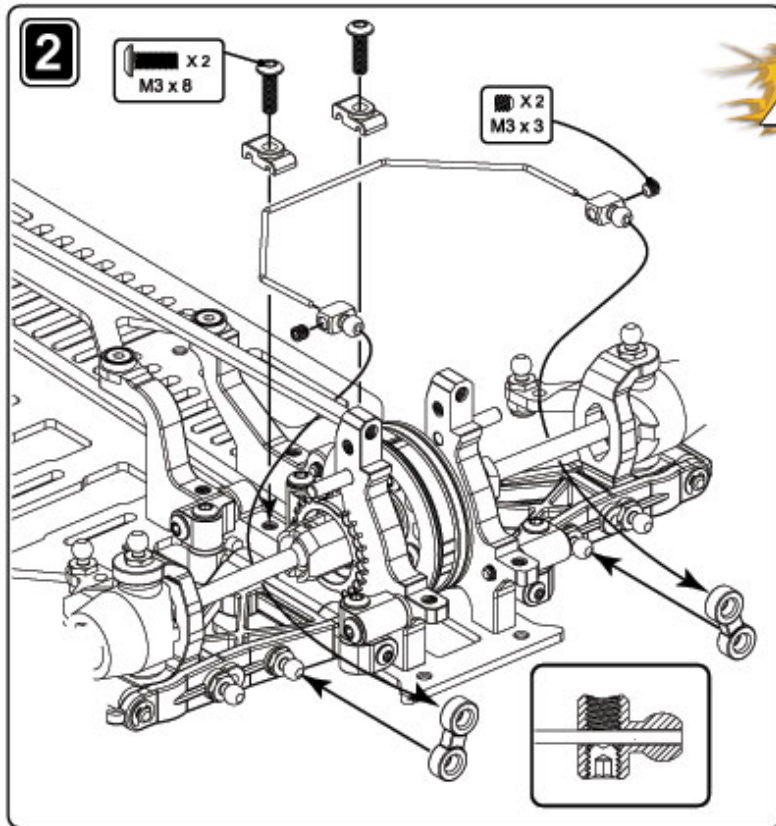

Stage 7 cont..
Pro-Spec

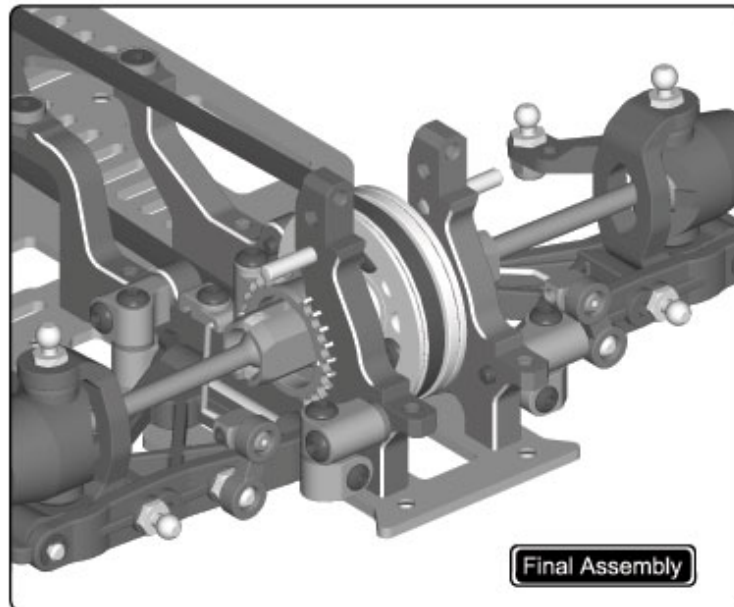
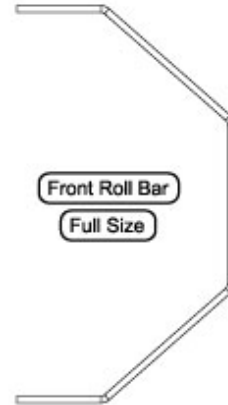

Final Assembly



www.racing-cars.com

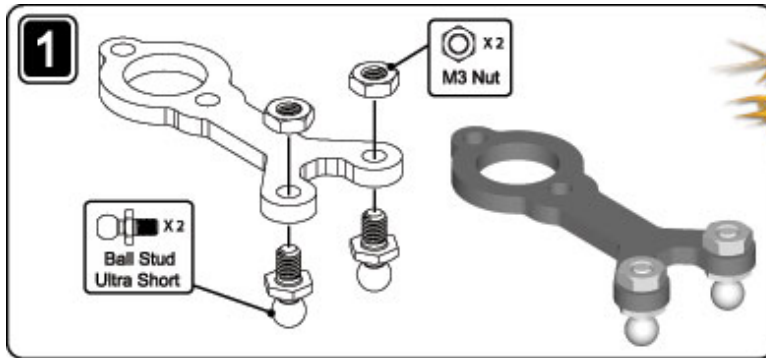

Stage 8

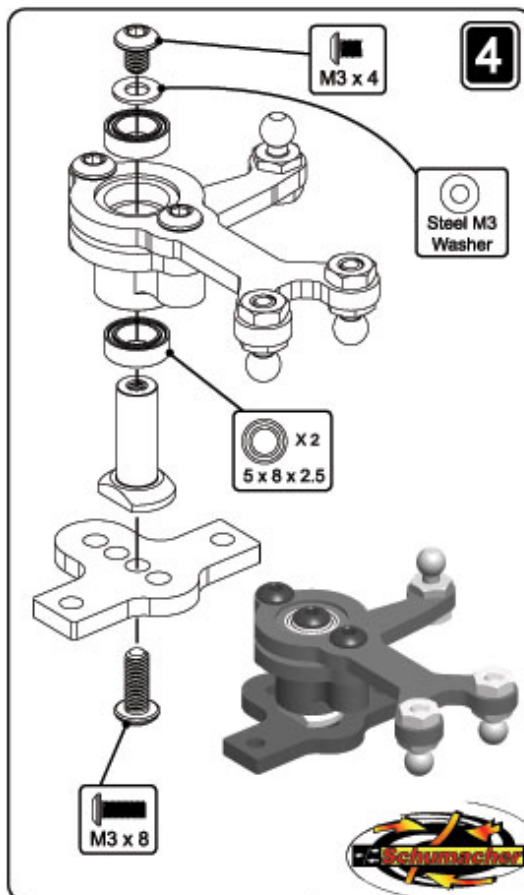
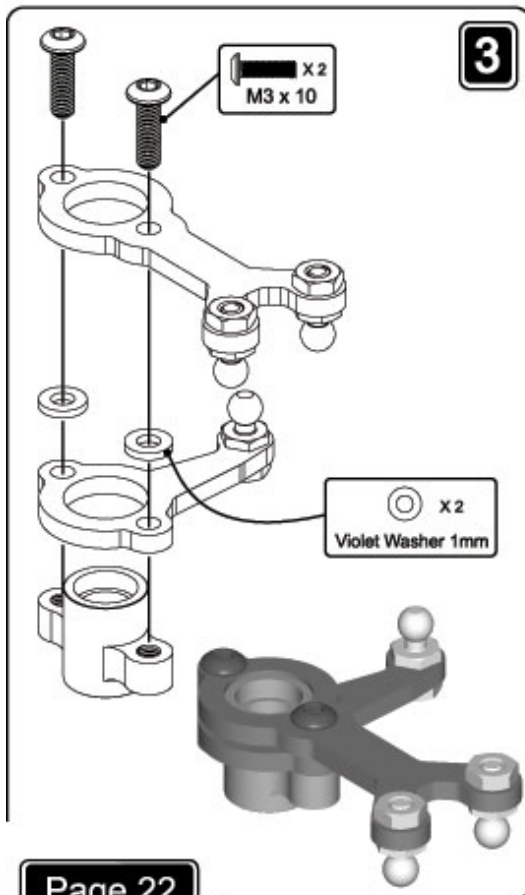
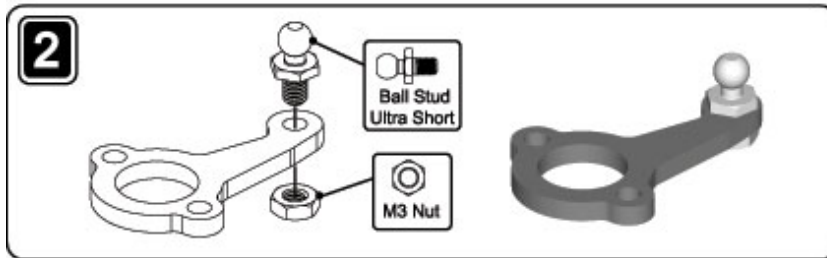

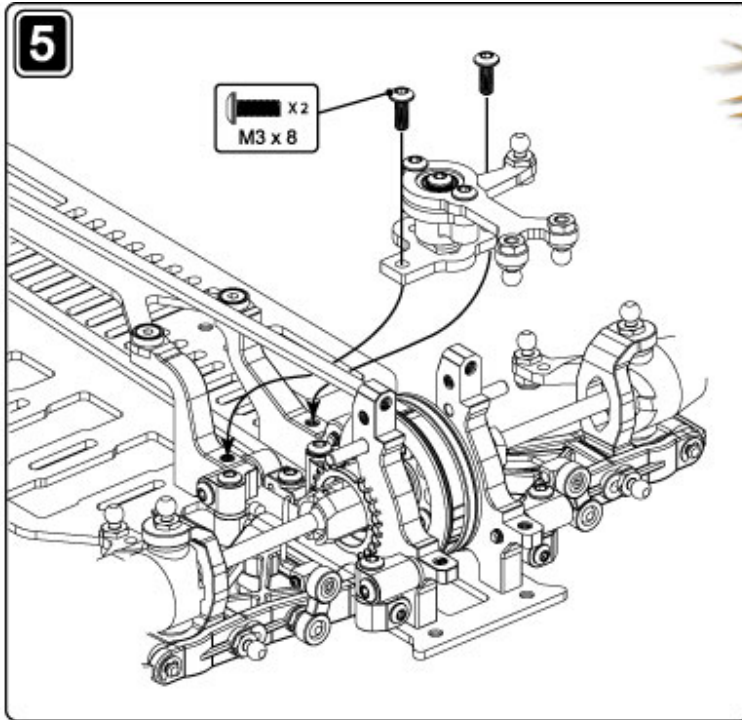

Stage 8 cont...

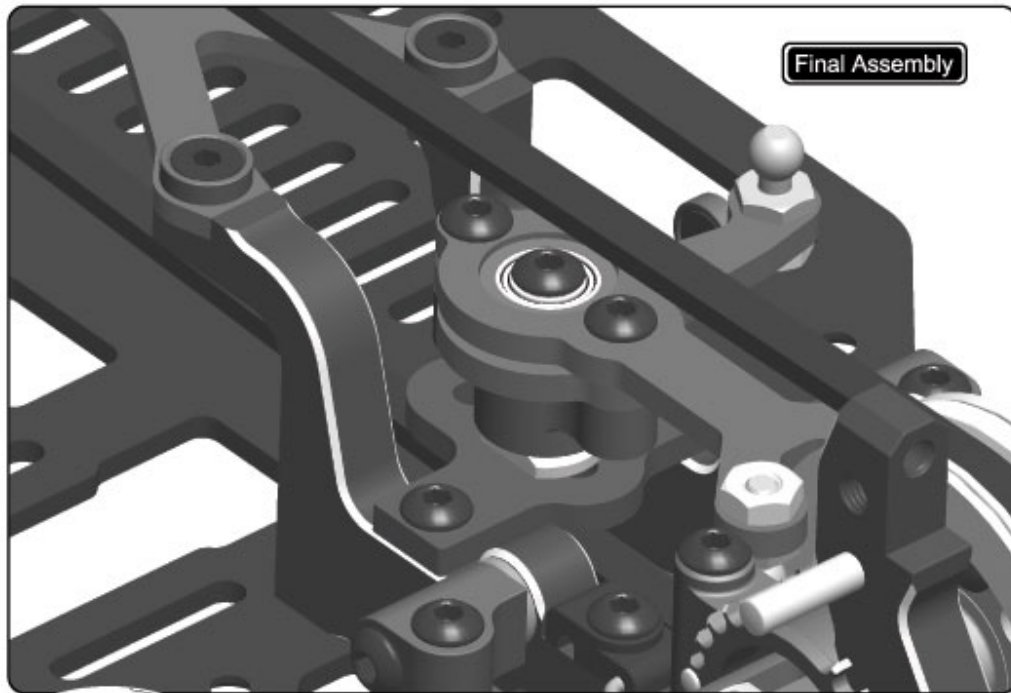

www.racing-cars.com

Page 23

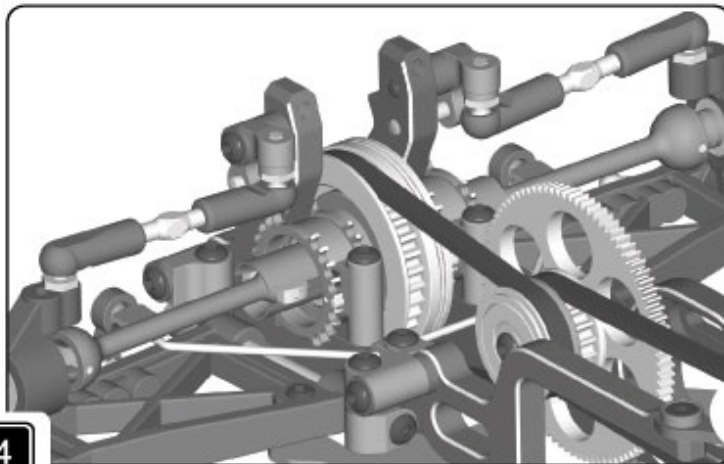
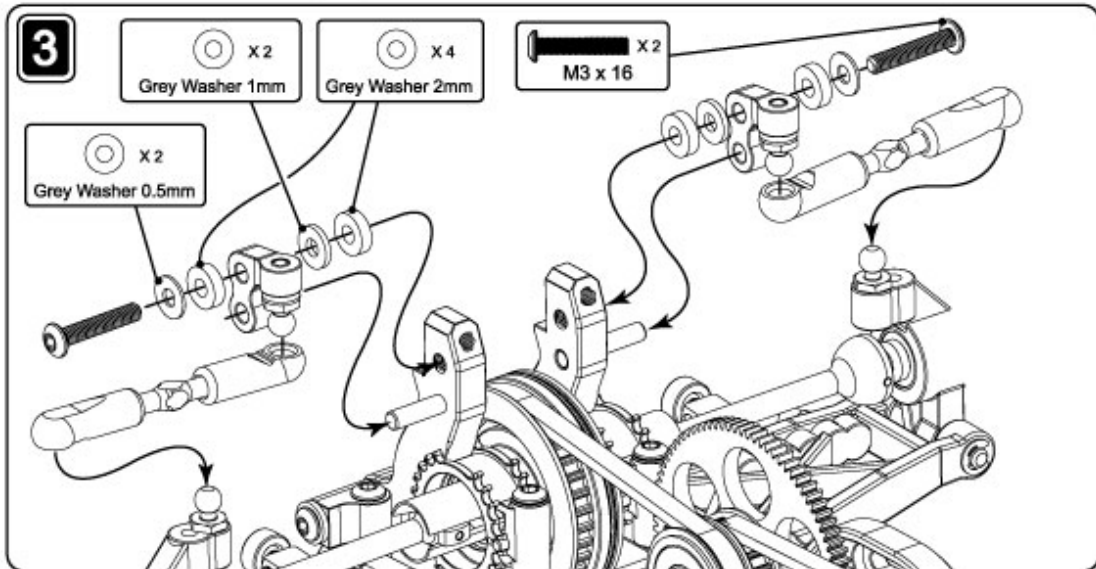
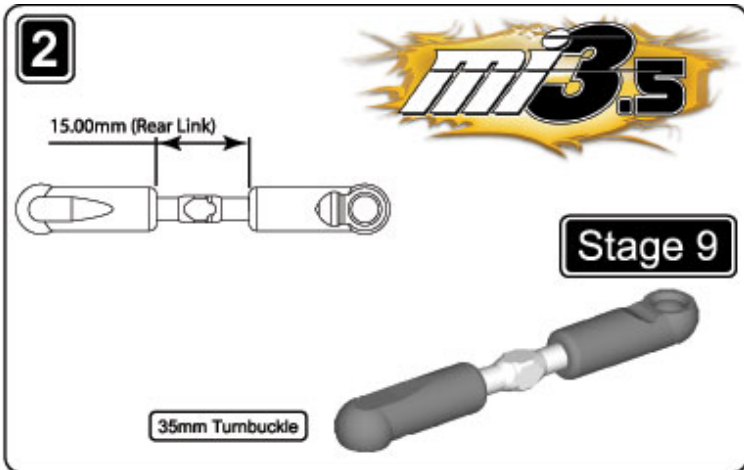
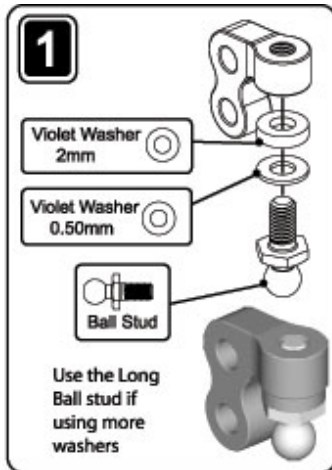

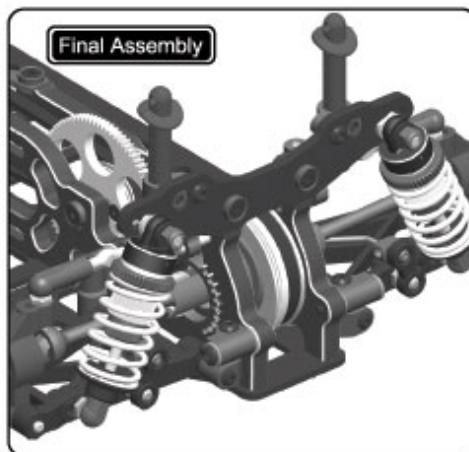
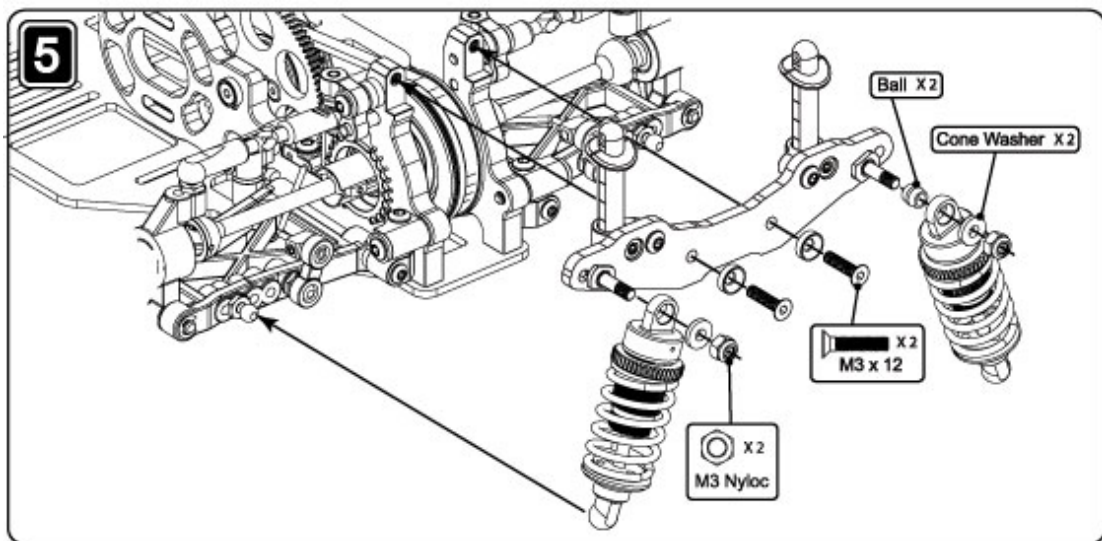
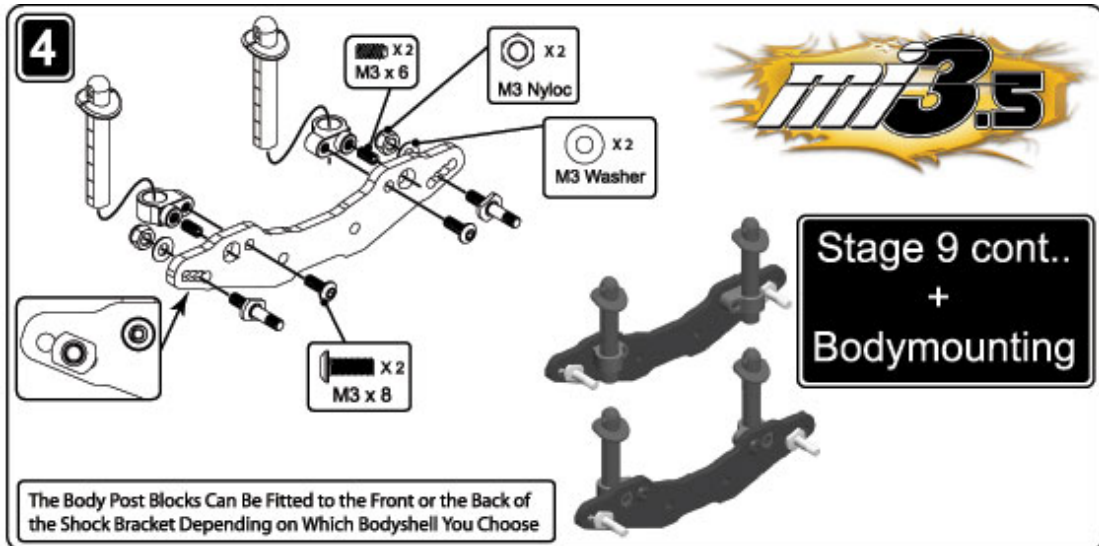

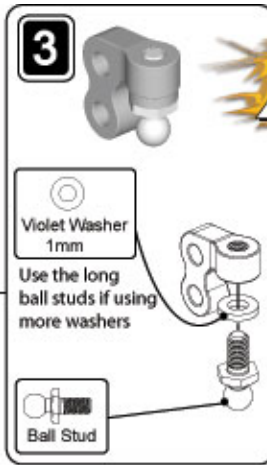
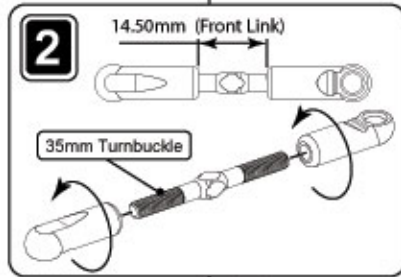
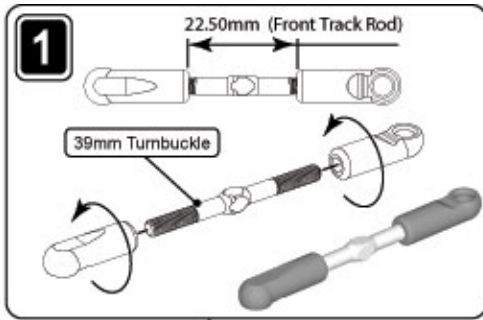

Stage 10

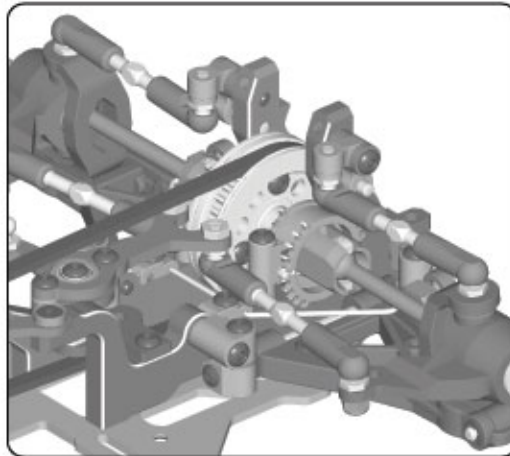
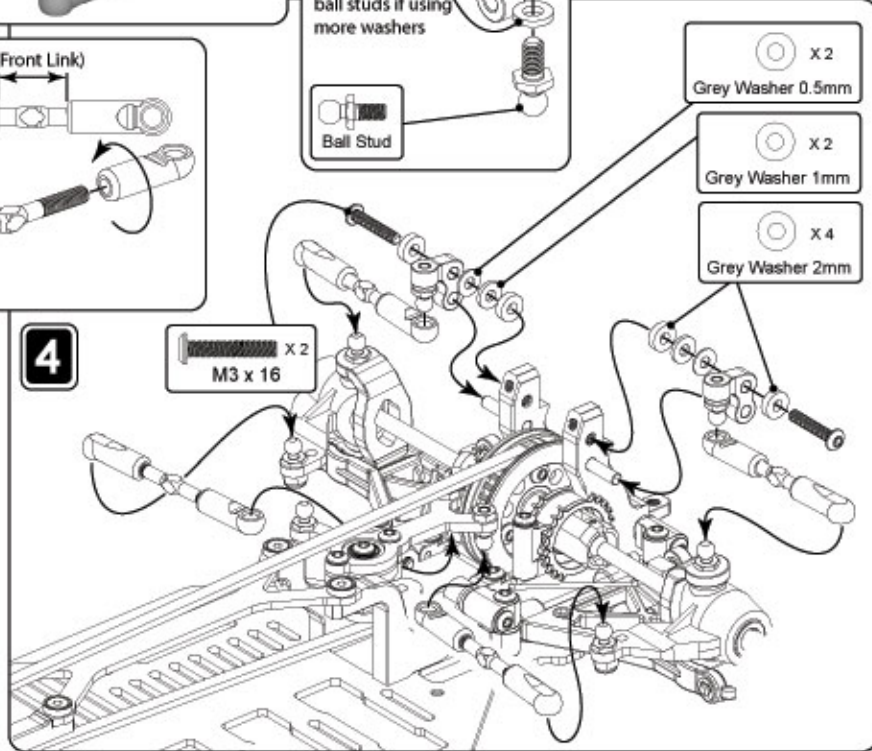

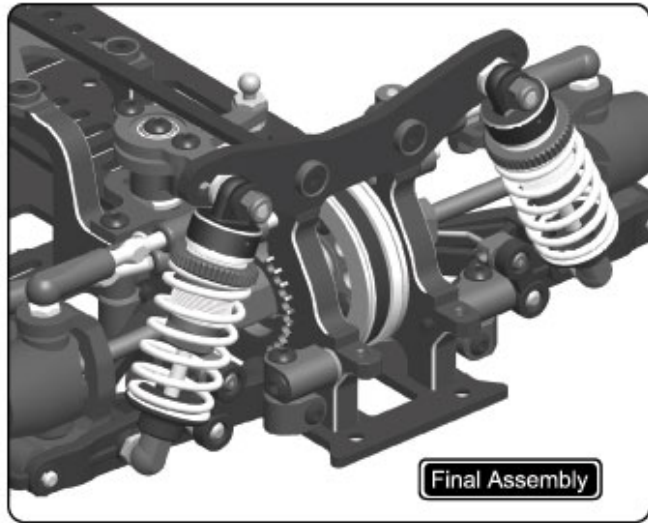
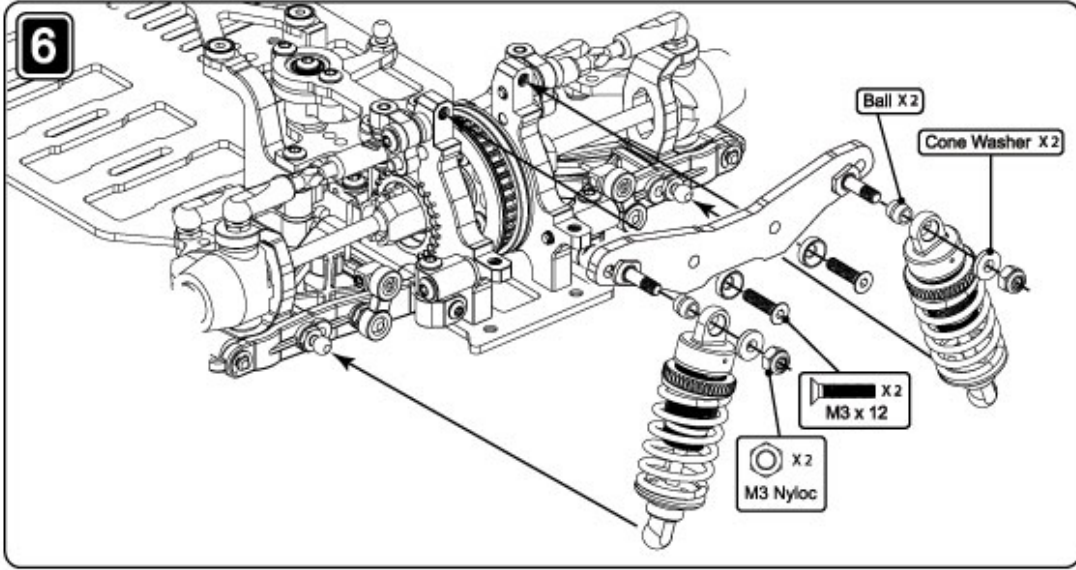
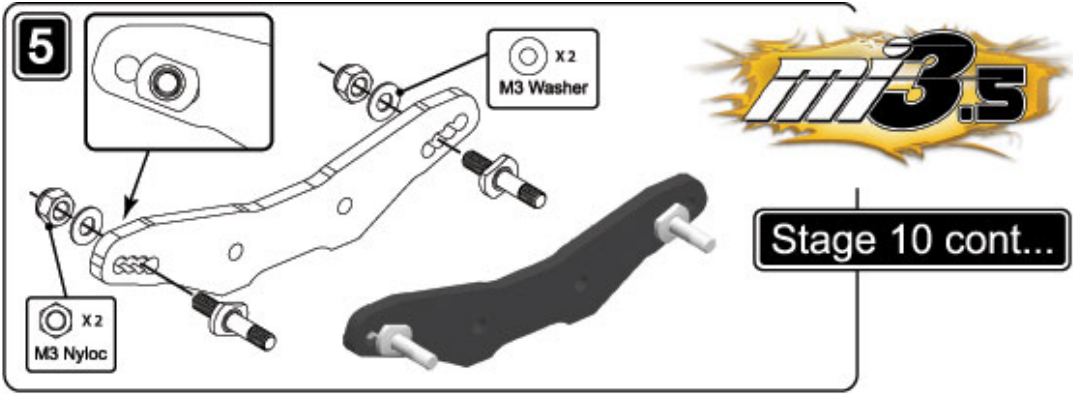

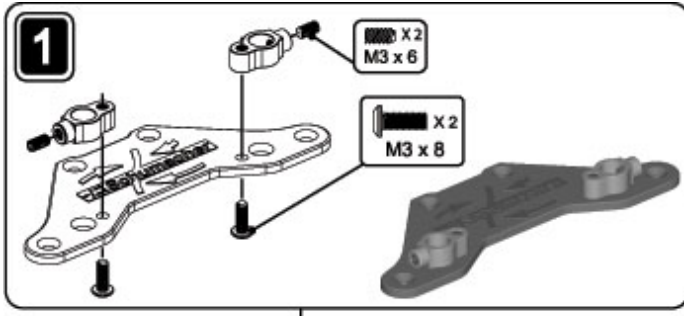

Front Body Mounts and Bumper

2

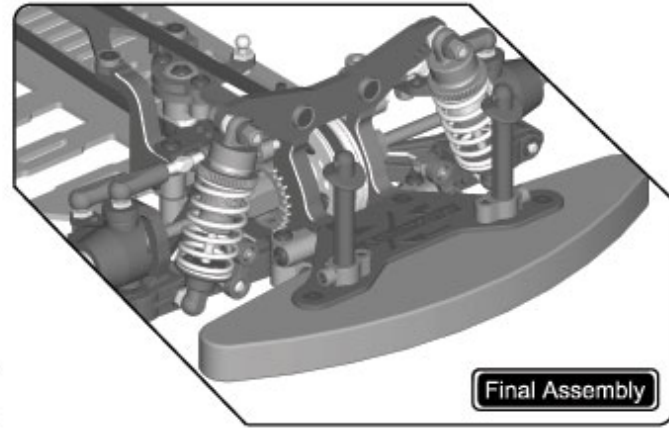
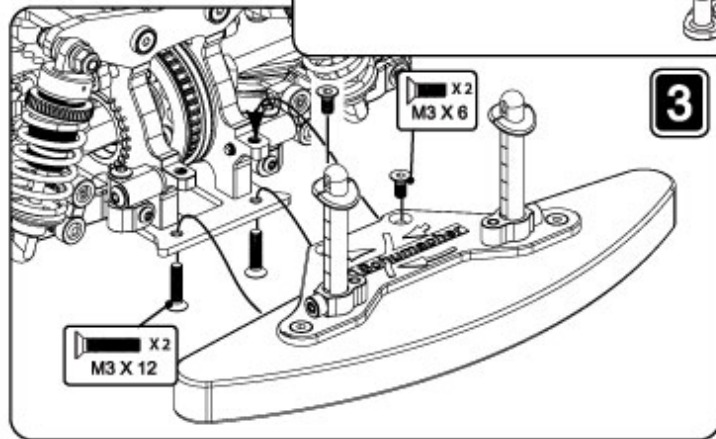
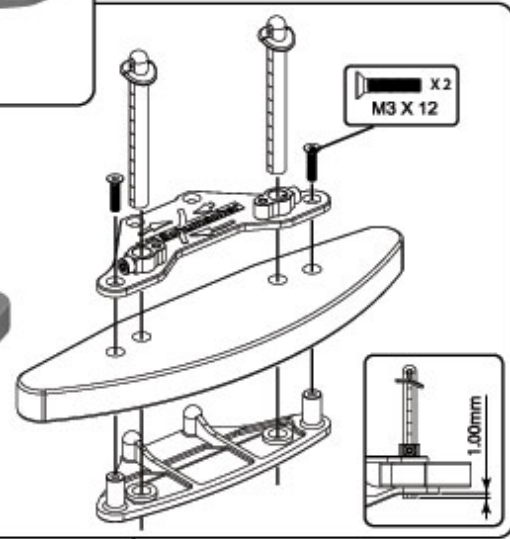

1

SERVO SAVER OPTION

CHOOSE THE CORRECT HORN FOR YOUR SERVO.
SA = SANWA/AIRTRONICS
FU = FUTABA
SH = SCHUMACHER/HITEC

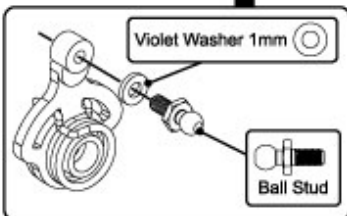
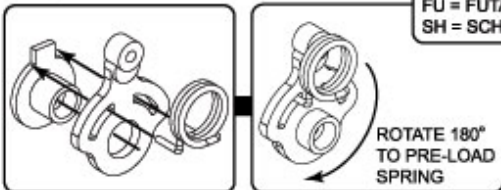

2

The Servo is NOT Included

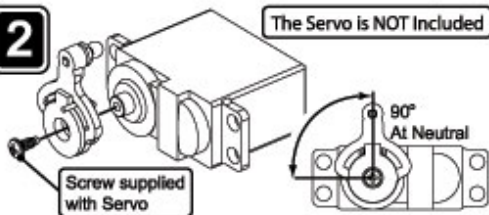

3

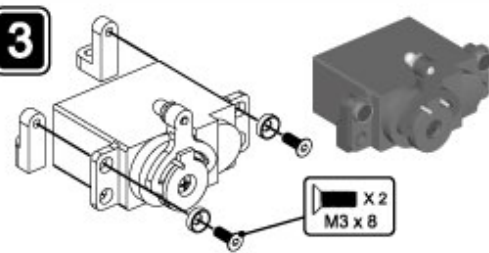

1

NON SERVO SAVER OPTION



2

The Servo is NOT Included

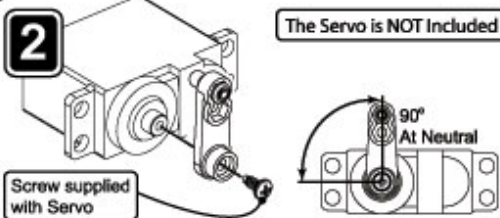

3

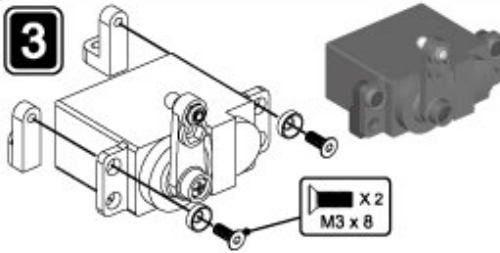

Radio Installation

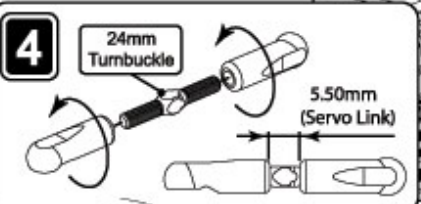

www.racing-cars.com

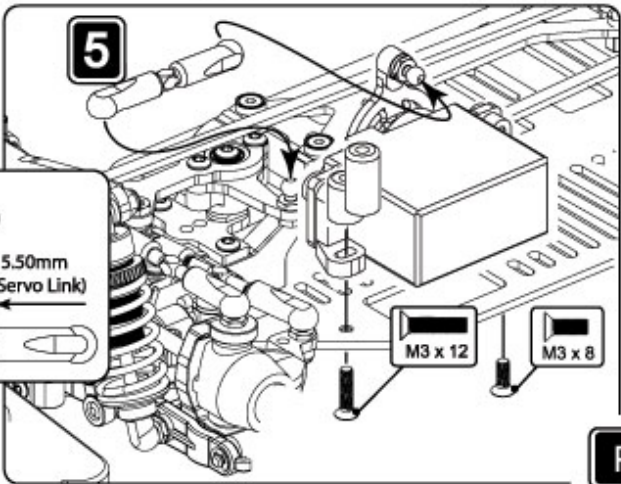

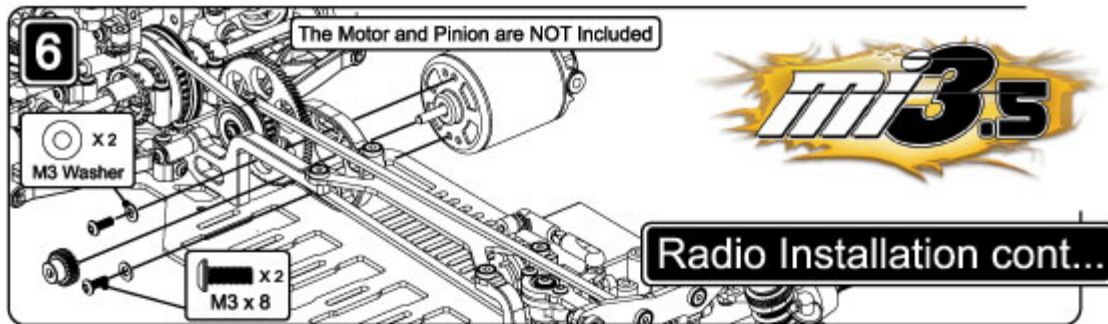

Radio Installation cont...

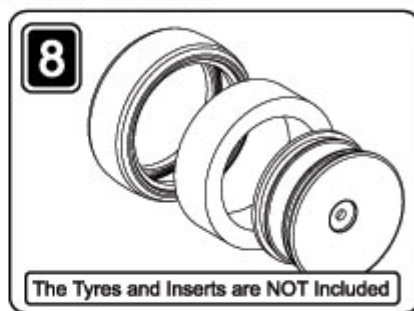
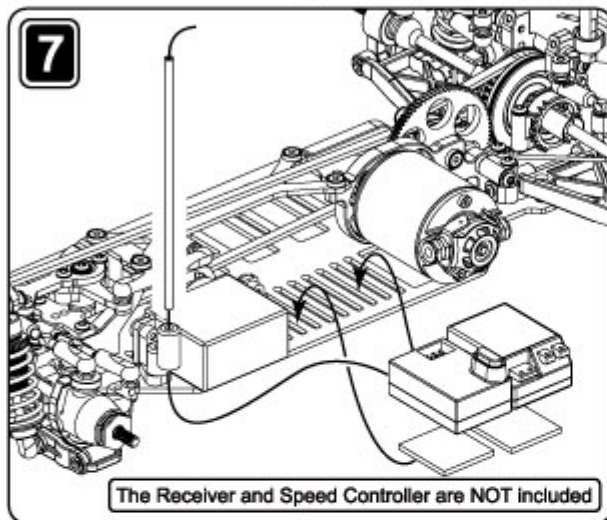

When using the 5 Cell Chassis fit the Receiver behind the Cells.

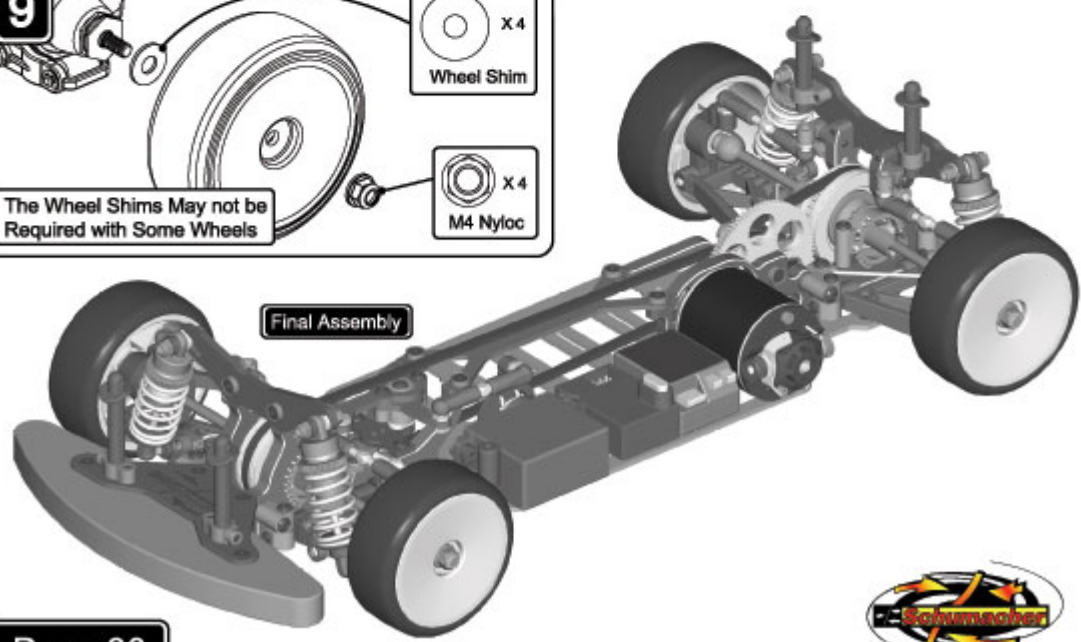

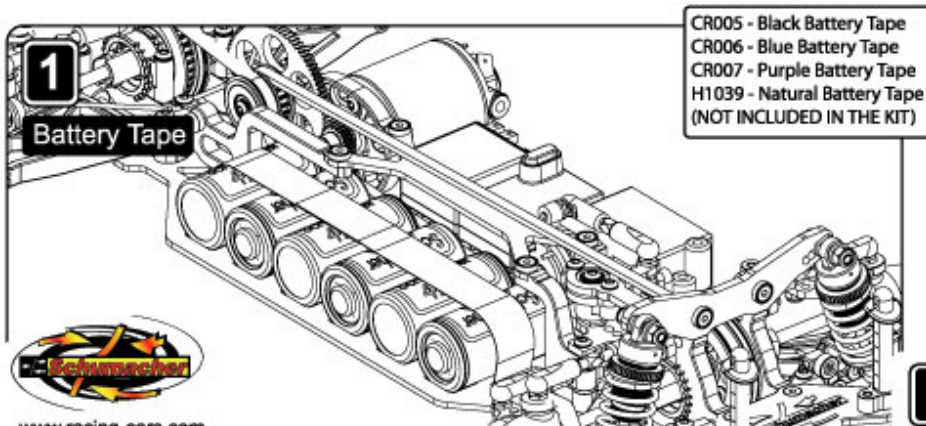
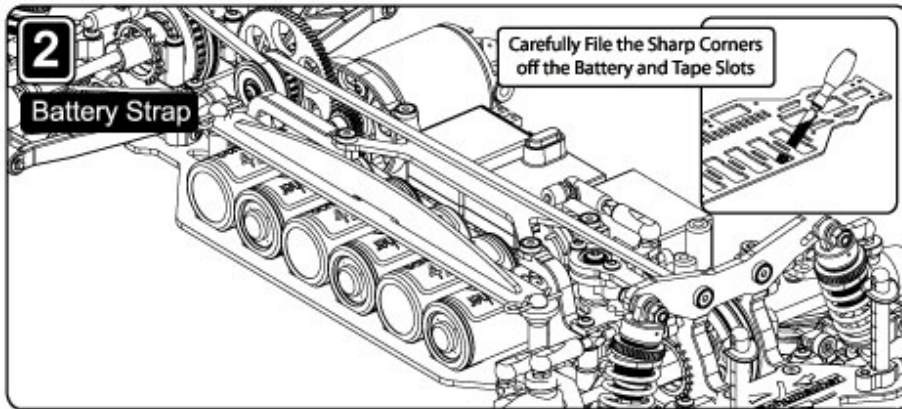
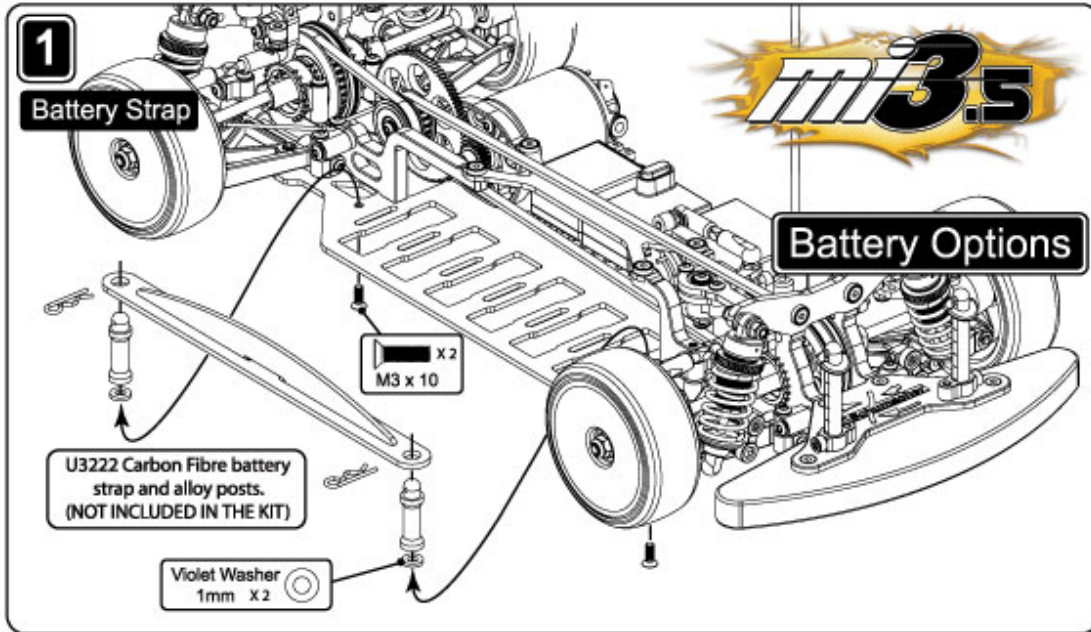

SPRINGS

The spring rate controls the suspension stiffness. Spring adjusters only change the ride height. They DO NOT alter the suspension stiffness. On slippery or bumpy tracks use soft to medium rate springs, on flat or high grip tracks run medium to hard rate springs.

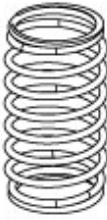

STEERING

With the Ball centres Closer together you will get a more aggressive steering response, and further apart will give a less aggressive steering response. The options are available when you purchase, U3135 Steering Set



Track Settings

FRONT CASTOR

The front castor can be altered by changing the yoke. The car comes with 4° castor as standard. Less castor will give a quicker steering response, but could lead to power on understeer. More castor will give the opposite, slightly slower turn in, but more power on steering.

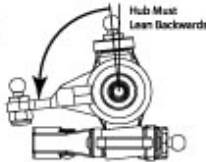

SHOCK BRACKETS (Shock Mounting)

Vertical shock absorbers make the car react sharply to driver inputs.

A laydown shock offers a softer feel to the driver.

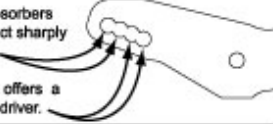

RIDE HEIGHT

In general always run the car as low as possible, without the chassis grounding out, as it rolls into corners.

A good starting point with rubber tyres is 5.5mm at the front and 6.0mm at the rear.

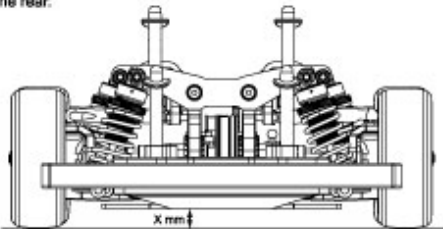

FRONT & REAR CAMBER

With maximum negative camber the car will have high levels of grip, but there may be the possibility of sudden breakaway in corners. Reducing the camber gives a more progressive slide, but may give less grip.

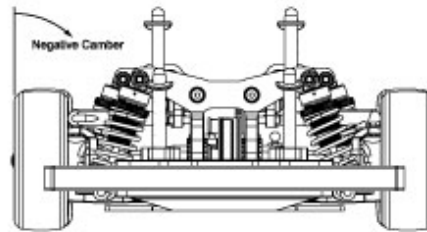

FRONT TOE-IN (Out-board)

The front toe-in is set by adjusting the steering trackrod turnbuckles.

Toe-In = A less than B
Toe-Out = A greater than B

Toe-in will give a more stable car, but will give less sharp turn in. Toe-out will give the opposite, less stability with sharper turn in to the corners.

We recommend to start at about 0° or 1° toe-out.

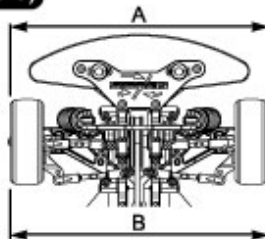

FRONT AND REAR TRACK WIDTH

TRACK WIDTH ADJUSTMENT (In-board)

The track width of the car may be altered by adding or removing equal thickness grey suspension washers between the Screw blocks and the transmission housings.

When changing the track width ensure the driveshafts are fully engaged in the Diff outputs.

And the width does not exceed 190mm

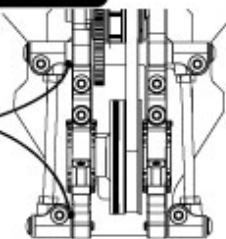

FRONT AND REAR WHEELBASE

WHEELBASE ADJUSTMENT (In-board)

The wheelbase may be adjusted by moving the Qwik clips to either the front or the back of the wishbones. This alters the front to rear weight Balance of the car.

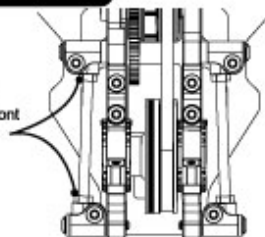

FRONT AND REAR INBOARD TOE-IN

TOE IN (In-board)

The toe-in is set by adding or removing the grey suspension washers between the Screw blocks and the transmission housings, at the front or rear of the wishbones.

Each 0.50mm washer will change the Toe in by Approx 0.60°

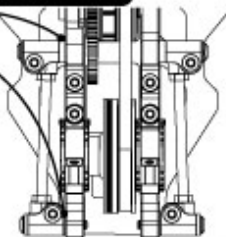

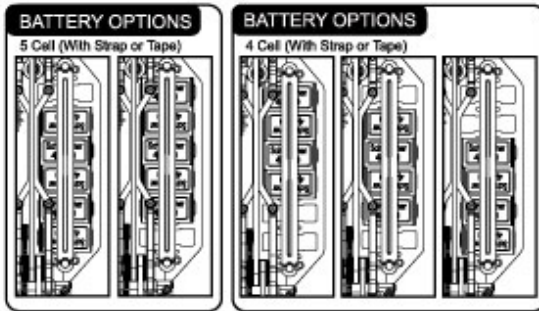

Track Settings

GEAR CHART 48Dp

Maximum Tooth Sum = 121.....Minimum Tooth Sum = 91.....Internal Ratio = 1.8:1

	14	15	16	17	18	19	20	21	22	23	24	25	26	27	28	29	30	31	32	33	34	35	36	37	38	
89	11.44	10.68	10.01	9.42	8.90	8.43	8.01	7.63	7.28	6.97	6.68	6.41	6.16	5.93	5.72	5.52	5.34	5.17	5.01							
87	11.18	10.44	9.79	9.21	8.70	8.24	7.83	7.46	7.12	6.81	6.53	6.26	6.02	5.80	5.59	5.40	5.22	5.05	4.89	4.75	4.61					
85	10.92	10.20	9.56	9.00	8.50	8.05	7.65	7.29	6.95	6.65	6.38	6.12	5.88	5.67	5.46	5.28	5.10	4.94	4.78	4.64	4.50	4.37	4.25			
70								6.00	5.73	5.48	5.25	5.04	4.85	4.67	4.50	4.34	4.20	4.08	3.94	3.82	3.71	3.60	3.50	3.41	3.32	
66													4.75	4.57	4.40	4.24	4.10	3.96	3.83	3.71	3.60	3.49	3.39	3.30	3.21	3.13

GEAR CHART 64Dp

Maximum Tooth Sum = 161.....Minimum Tooth Sum = 121.....Internal Ratio = 1.8:1

	19	20	21	22	23	24	25	26	27	28	29	30	31	32	33	34	35	36	37	38	39	40	41	42	43	44	45	46	47	48	49	50
118	11.18	10.62	10.11	9.65	9.23	8.85	8.50	8.17	7.87	7.58	7.32	7.08	6.85	6.64	6.44	6.25	6.07	5.90	5.74	5.58	5.44	5.31	5.18	5.05	4.93							
116	10.99	10.44	9.94	9.49	9.08	8.70	8.35	8.03	7.73	7.46	7.20	6.96	6.74	6.53	6.33	6.14	5.97	5.80	5.64	5.49	5.35	5.22	5.09	4.97	4.85	4.75	4.64					
114	10.80	10.26	9.77	9.33	8.92	8.55	8.21	7.89	7.60	7.33	7.08	6.84	6.62	6.41	6.22	6.04	5.88	5.70	5.54	5.40	5.26	5.13	5.00	4.88	4.77	4.66	4.56	4.46	4.37			
106	10.04	9.54	9.08	8.67	8.30	7.95	7.63	7.34	7.07	6.81	6.58	6.36	6.15	5.96	5.78	5.61	5.45	5.30	5.16	5.02	4.89	4.77	4.65	4.54	4.44	4.34	4.24	4.15	4.06	3.96	3.89	3.82
96						6.91	6.65	6.40	6.17	5.96	5.76	5.57	5.40	5.24	5.08	4.94	4.80	4.67	4.55	4.43	4.32	4.21	4.11	4.02	3.93	3.84	3.76	3.68	3.60	3.53	3.46	
90												5.23	5.06	4.91	4.76	4.63	4.50	4.38	4.26	4.15	4.06	3.96	3.86	3.77	3.68	3.60	3.52	3.45	3.38	3.31	3.24	

FRONT INBOARD PIN OPTIONS

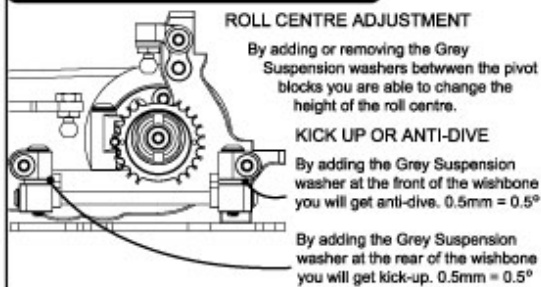

REAR INBOARD PIN OPTIONS



DIFF HEIGHT (HIGH OR LOW)

DIFF HEIGHT

Diff height adjustment is provided so that the car may run level drivshafts at ride height with different diameter tyres.



www.racing-cars.com

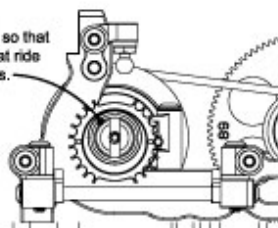

FRONT AND REAR SUSPENSION LINK

(Roll Centre)

HEIGHT ADJUSTMENT

The height of the inboard suspension link can be altered by adding or removing the violet spacer washers, between the link mount and the ball stud.

WIDTH ADJUSTMENT

The width of the inboard suspension link can be altered by adding or removing the Grey suspension washers, between the link mount and the Transmission housings.

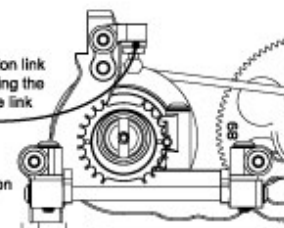

ELECTRIC - TOURING CARS

K080	Mi-3.5 Pro-CF - 1-10 4WD Trg 6 cell
K081	Mi-3.5 Pro-CF - 1-10 4WD Trg 5 Cell
K082	Mi-3.5 Race-S1 - 1-10 4WD Touring Car

CHASSIS PARTS

U1042	Aerial Mount - Universal
U119	Aerial Tube - Pack 4
U2244	Servo Mounts (pr)
U2280	SpeedFlex Rr Belt6mm - C3K
U2889	Ball Grippa Sockets - 1pk 8l
U3145	CF Chassis - 2.0mm Kit - Mi-3
U3150	CF Shock Bkt; Front - Mi-3 Kit
U3151	CF Shock Bkt; Rear - Mi-3 Kit
U3154	Foam Bumper - Mi-3
U3155	Front Bumper Mouldings - Mi-3
U3158	Alloy Body Post Block; Horizontal Mount - Mi-3 (pr)
U3159	Alloy Body Post Block; Vertical Mount - Mi-3 (pr)
U3271	CF LiPo Battery Locator (pr)
U3272	CF 2008 Euro Chassis - 5 cell - Mi-3
U3273	CF 2008 Euro Top Deck - Mi-3
U3274	CF 2008 Flex Top Deck - Mi-3
U3278	Chassis; S1 6 cell - Mi-3.5
U3279	Top deck; S1 - Mi-3.5
U3280	Shock Bracket; Front S1 - Mi-3.5
U3281	Shock Bracket; Rear S1 - Mi-3.5
U3282	Steering Post Set - Mi-3.5 S1
U3283	Instr Manual - Mi-3.5

BODYSHELLS & DECALS

EC16283121	East Coast - Body; 1:250 190mm
EC16283122	East Coast - Body; Euro-R 190mm
EC16283123	East Coast - Body; 320s 190mm
EC16283126	East Coast - Body; Speed 6 190mm
EC16283129	East Coast - Body; Evo9x 190mm
EC16283212	East Coast - Body; Euro-R 200mm
EC16283206	East Coast - Body; 350Z 190mm
EC16283208	East Coast - Body; RK7 190mm
EC16283209	East Coast - Body; S15 190mm
EC38826B	East Coast - Half Paint; Blue; Speed 6 190mm
EC38826R	East Coast - Half Paint; Red; Speed 6 190mm
U3167	Decal Sheet - Mi-3 (pk3)

SUSPENSION

U1430	Tumbuckle Adjuster - 39mm (pr)
U1440	Pro Pin; grooved 1/8x25mm (pr)
U2664	Steering Yoke Pivot Set - 2 pairs
U2718	Pro Pin; Grooved 1/8x18mm (pr)
U2722	Ball Grippa Joints - U/SH Stud 4prs
U2736	Steering Yoke; 2 degree - Mi-2 pr
U2737	Steering Yoke; Kit Std 4 degree - Mi-2 pr
U2738	Steering Yoke; 6 degree - Mi-2 pr
U2750	Droop Screw; M5x8mm pk4
U2882	Servo Saver Set; Light & Heavy Springs
U2990	Front Hub Carrier - Mi-2 E.C.
U2991	Purple Alloy Wheel Hex; Slim (pr)
U2992	Rear Hub Carrier - Mi-2 E.C./Mi-3
U3127	Wishbones; Graphite Front - Mi-3
U3128	Wishbones; Graphite Rear - Mi-3
U3129	Alloy Block; Screw - Mi-3 (pr)
U3130	Alloy Block; Pivot - Mi-3 (pr)
U3133	Alloy Top Link Mount - Mi-3 (pr)
U3134	Steering Post Set - Mi-3 CF
U3135	Centre Track Rods; Set 7 - Mi-3
U3137	Shock Mounting Post - Mi-3 (pr)
U3142	Pro Pivot Pin - 55mm - Mi-3 (pr)
U3249	Wishbones; Med Flex Front - Mi-3
U3250	Wishbones; Medium Flex Rear - Mi-3
U3251	Wishbones; Extra Flex Front - Mi-3
U3252	Wishbones; Extra Flex Rear - Mi-3
U750	Ball Grippa Joints - Short Stud 8prs
U796	Tumbuckle Adjuster - 24mm (pr)
U797	Tumbuckle Adjuster - 35mm (pr)
U851	Ball Grippa Joints - Long Stud 8prs

TRANSMISSION

U1895	M3x6mm Button Screws & Washers pk4
U1918	Spare Blades
U2573	Pro-Diff Screw Set
U2721	Rear Belt; Black Narrow - Mi-2
U2733	Diff Pulley Fences - Mi-2 & 3
U2746	CNC Diff Pulley - 4mm
U2761	Diff Shims; 10 x 12
U2797	CNC Spool Assy; Lightweight - Mi-2
U2798	CNC Spool Pulley - Mi-2
U3011	Front Belt; 1711 x 3.6mm
U3012	Front Belt; Grey Stock 1711 x 3.6mm
U3013	Rear Belt; Grey Stock - Mi-2 E.C.
U3026	Pivot; Pin & Screw; Alloy CV D/Shaft
U3123	Alloy Eccentric - Mi-3 (pr)
U3124	Diff Retaining Post - Mi-3 (pr)
U3125	Layshaft Post - Mi-3
U3126	CNC Pulley & Fences; 20T - Mi-3
U3138	Alloy Diff Output; Male - Mi-3
U3139	Alloy Diff Output; Female - Mi-3
U3140	Diff Washer; ProSpec - Mi-3 (pr)
U3141	HD Spool Output - Mi-3
U3160	85T 48DP CNC Spur Gear - Mi-3
U3161	87T 48DP CNC Spur Gear - Mi-3
U3162	89T 48DP CNC Spur Gear - Mi-3
U3163	114T 64DP CNC Spur Gear - Mi-3
U3164	116T 64dp CNC Spur Gear - Mi-3
U3165	118T 64dp CNC Spur Gear - Mi-3
U3170	Pins & Shims; Axle - Mi-3 4pr
U3223	Diff; Fully Assembled Ceramic - Mi-3
U3225	CNC Spool Assembly HD - Mi-3
U3234	Axle; Alloy CV Driveshaft 1pc
U3247	70T 48DP CNC Spur Gear - Mi-3
U3248	96T 64dp CNC Spur Gear - Mi-3
U3256	Alloy 7075 T6 Diff Mount; Front Left - Mi-3
U3257	Alloy 7075 T6 Diff Mount; Front Right - Mi-3
U3258	Alloy 7075 T6 Diff Mount; Rear Right - Mi-3
U3259	Alloy 7075 T6 Diff & Motor Mount - Mi-3
U3260	Ti Shock Post - Mi-3 pr
U3261	Ti Droop Screw - Mi-3 pk4
U3262	Ti Lay Post - Mi-3
U3267	Driveshafts; Heavy Duty - Mi-3 (pr)
U3269	90T 64DP CNC Spur Gear - Mi-3
U3270	106T 64DP CNC Spur Gear - Mi-3
U3275	Bone; 7075 Alloy Driveshaft - Mi-3 1pc
U3276	Axle; HD Steel - Mi-3 1pc
U3400	66T 48DP CNC Spur Gear - Mi-3

SHOCK ABSORBERS

U2993	Race Shock Body; Nickel Teflon (pr)
U2994	Race Shock Collar; threaded adjuster (pr)
U2995	Race Shock Piston - Trg 2 Hole (pr)
U2996	Race Shock Piston - Trg 3 Hole (kit std) pr
U2997	Race Shock Rod; Ti-Nitride - 30mm (pr)
U2998	Race Shock Seal Housing; On Road (pr)
U2999	Race Shock Seal Rebuild Pack (pr)
U3001	Race Shocks; fully assembled pair
U3284	Race Shock Top Cap (pr) - Black Unvented
U613	Spring Stop & Spacer Mouldings (pr)

SHOCK OIL

G030	Pure Silicone Shock Oil - 30w
G035	Pure Silicone Shock Oil - 35w
G040	Pure Silicone Shock Oil - 40w
G045	Pure Silicone Shock Oil - 45w
G050	Pure Silicone Shock Oil - 50w
G055	Pure Silicone Shock Oil - 55w
G060	Pure Silicone Shock Oil - 60w
G070	Pure Silicone Shock Oil - 70w
G080	Pure Silicone Shock Oil - 80w
G100	Pure Silicone Shock Oil - 100w

SPRINGS

U2822	Spring Tuning Set - Pro-Touring (6 prs)
U2823	Pro-Touring Springs - White 14lbs
U2824	Pro-Touring Springs - Blue 16lbs
U2825	Pro-Touring Springs - Green 18lbs
U2826	Pro-Touring Springs - Red 20lbs
U2827	Pro-Touring Springs - Yellow 23 lbs
U2828	Pro-Touring Springs - Violet 27 lbs



BEARINGS & BALLS

G200	ZX1 - MicroLube
H1031	Bearing Blaster Aerosol 500ml
U1301	Silicone Diff Lube - Pot
U1439	Ball Bearing - 5 x 9 x 3 Non Fl. (pr)
U1954	Pro - Thrust Bearing
U1957	Moly Axle Grease - Pot
U2148	Ball Bearing - 5 x 10 x 4 Shielded (pr)
U2189	Wheel Bearings 8pcs 10x5x4 Shim Set
U2459	Diff Balls; T/C 2.5mm pk12
U2574	Ball Bearing - 5 x 9 x 2.5 (pr)
U2862	Ceramic Bearing - 5x10x4 Shielded (pr)
U3016	Ball Bearing - 10x15x4 (pr)
U3017	Ceramic Bearing - 10x15x4 (pr)
U3019	Ceramic Nitride Diff Balls 2.5mm (pk12)
U3136	Ball Bearing - 5 x 8 x 2.5 (pr)
U3171	Ceramic Bearing set - Mi-3

SPEED PACKS

CR035	CORE RC - Serrated Alloy M4 Nuts; Blue pk 4
CR036	CORE RC - Serrated Alloy M4 Nuts; Purple pk 4
H1010	Body Clips - Fluorescent Yellow (pk10)
H1011	Body Clips - Fluorescent Green (pk10)
H1012	Body Clips - Fluorescent Red (pk10)
H1013	Body Clips - Metallic Red (pk10)
H1014	Body Clips - Metallic Blue (pk10)
H1015	Body Clips - Metallic Purple (pk10)
U1547	SPEED PACK - M3 Nuts
U1548	SPEED PACK - M3 Washers
U1549	SPEED PACK - M4 Nuts & Washers
U1550	SPEED PACK - Socket Wrenches (pk3)
U1551	SPEED PACK - 6 Clips 2x8pcs
U1552	SPEED PACK - R Clips
U1606	SPEED PACK - Servo Tape
U1633	SPEED PACK - Small Pins (pk)
U1960	SPEED PACK - O Rings; Various
U2128	SPEED PACK - Grub-Set Screws M3 M4
U2631	SPEED PACK - Circlips Various 12 pcs
U2760	SPEED PACK - M3 Button Hd; 4 to 20
U2858	Alloy M3x6 Spacer Set; 0.5, 1, 2, 3mm - 16pcs
U2988	M3 Csk Washers - Purple Alloy (pk10)
U3002	Wheel Spacer Washers (pk10)
U3021	SPEED PACK - M3x6 Csk Allen Hi-T
U3022	SPEED PACK - M3x6 Csk Allen Hi-T
U3023	SPEED PACK - M3x10 Csk Allen Hi-T
U3024	SPEED PACK - M3x12 Csk Allen Hi-T
U3131	Alloy Spacers M3x7mm 0.5, 1, 2mm (pk18)
U3168	SPEED PACK - M2.5 Screws pk 10

TOOLS

AT1142	ATS Set Up Gauges - 1/10th Touring
H1009	Lexan Scissors; curved
H1032	Alloy Camber Gauge - 1/10th
SPCF-MP001	Carbon Fibre Pit Mat; Black 58x75cm
SPCF-SB001	C/F Set Up Board; Silver 33x43cm
U2789	Schumacher Hex Driver - 1.5mm
U2790	Schumacher Hex Driver - 2.0mm
U2791	Schumacher Hex Driver - 2.5mm
U2792	Schumacher Hex Driver - 3.0mm
U2795	Schumacher M3 Nut Driver
U2796	Schumacher M4 Nut Driver
U2818	Schumacher Body Reamer

ELECTRONICS

G837	Mimi Temp Gun - 420F 230C
G848	Tyre Warmers 1/10 Trg 7.2-12v

SPEEDCONTROLS

SPEXT98801	Speed Passion - BL ESC; GT 2.5T
SPEXT98801LPF	Speed Passion - BLESC; LFP 5.5T



www.racing-cars.com

SPEED SECRET - OPTION PARTS

CR010 CORE Ti Screws - M3 Set 67 pcs
 CR011 CORE Ti Screws - M3x8 Button Head pk4
 CR012 CORE Ti Screws - M3x10 Button Head pk4
 CR013 CORE Ti Screws - M3x16 Button Head pk4
 CR014 CORE Ti Screws - M3x20 Button Head pk4
 CR015 CORE Ti Screws - M3x8 Csk Head pk4
 CR016 CORE Ti Screws - M3x10 Csk Head pk4
 CR017 CORE Ti Screws - M3x12 Csk Head pk4
 CR018 CORE Ti Ball Studs - Ultra Short pk4
 CR019 CORE Ti Ball Studs - Short pk4
 CR020 CORE Ti Ball Studs - Long pk4
 CR021 CORE Ti Ball Stud Set - M3 24pcs
 CR043 CORE RC; X-Weights 8x10 & 8x5gms
 H1024 Alloy 6 Fin Motor Heatsink; purple
 H1026 Ride Height Gauge; Purple Alloy; 0-10mm
 H1027 Droop Gauge Set; Purple Alloy - Touring
 U1572 Titanium Turnbuckle; purple - 39mm (pr)
 U1576 Titanium Pivot Pin; purple - 25mm (pr)
 U1905 Titanium Turnbuckle; purple - 35mm (pr)
 U2053 Titanium Turnbuckle; purple - 25mm (pr)
 U2075 Camber & Ride Height Gauges - C/C
 U2096 Aerial Mount; Purple Chrome - Universal
 U2100 Set Up Wheels; Camber & Toe In-SS
 U2135 M4 Nylon Wheel Nut - Purple Alloy (pk4)
 U2187 M3 Nylon Nut - Purple Alloy (pk8)
 U2251 Kwik Clip; 1/8x1.0 & 2.0mm
 U2298 Schumacher Pit Duce Car Stand
 U2719 Titanium Pivot Pin; purple - 18mm pr
 U2741 Alloy Rear Hub Carriers; purple - Mi-2 EC & Mi-3
 U2753 Heavy Duty Front One Way Assy - Mi-2
 U2756 One Way Pulley Assembly - Mi-2
 U2810 M4 Nylon Wheel Nut - Red Alloy (pk4)
 U2811 M4 Nylon Wheel Nut - Blue Alloy (pk4)
 U2812 M4 Nylon Wheel Nut - Black Alloy (pk4)
 U2813 M4 Nylon Wheel Nut - Gold Alloy (pk4)
 U2844 Hub & One Ways; Heavy Duty - Mi-2
 U2845 Output; Heavy Duty One Way - Mi-2 1pc
 U3132 Kwik Clips 0.25 & 0.5mm (pk8)
 U3143 Titanium Pivot Pin Set - Mi-3 (8pcs)
 U3144 Titanium Turnbuckle Set - Mi-3 (7pcs)
 U3146 CF Chassis - 2.5mm Stiff - Mi-3
 U3148 CF Top Deck - Stiff - Mi-3
 U3149 CF Top Deck - Flex - Mi-3
 U3152 CF Shock Bkt; Front - Low - Mi-3
 U3153 CF Shock Bkt; Rear - Low - Mi-3
 U3156 Roll Bar Set; Front 1.2-1.4-1.6 - Mi-3
 U3157 Roll Bar Set; Rear 1.2-1.4-1.6 - Mi-3
 U3221 Purple Alloy Wheel Hex; Grooveless (pr)
 U3222 CF Battery Strap & Alloy Posts - Mi-3
 U3224 CF Chassis - 5 cell 2.0mm - Mi-3
 U3246 CF Top Deck - 2.5mm - Mi-3

TEAM CLOTHING

G331L T Blue - Large
 G331M T Blue - Medium
 G331S T Blue - Small Man
 G331XL T Blue - X-Large
 G331XXL T Blue - XX-Large
 G332L T White - Large
 G332M T White - Medium
 G332S T White - Small Man
 G332XL T White - X-Large
 G332XXL T White - XX-Large
 G333L Polo - Large
 G333M Polo - Medium
 G333S Polo - Small Man
 G333XL Polo X Large
 G333XXL Polo - XX-Large
 G334 Cap - Black; Medium 58cm
 G335 Cap - Black; Large 62cm
 G336L Sweat - Large
 G336M Sweat - Medium
 G336S Sweat - Small
 G336XL Sweat - X-Large
 G336XXL Sweat - XX-Large

CHARGERS

CR025 UDC10 Universal Charger - NiMH + LiPo
 CR026 UDC20 Universal Balance Charger - NiMH+LiPo
 CR027 Power Supply; 6A UK Plug
 CR028 Power Supply Cable; USA
 CR029 Power Supply Cable; Europe
 CR031 UDC Charger Connector Set

ELECTRIC MOTORS

SP13825 Speed Passion CV2.0 Comp BL Motor; 2.5T
 SP13835 Speed Passion CV2.0 Comp BL Motor; 3.5T
 SP13835ER1 Rotor 3.5T; Euro R Hi Power 12.5mm
 SP13835ER2 Rotor 3.5T; Euro S Hi Speed & Runtime 12mm
 SP13840 Speed Passion CV2.0 Comp BL Motor; 4.0T
 SP13845 Speed Passion CV2.0 Comp BL Motor; 4.5T
 SP13845ER1 Rotor 4.5T; Euro RS Power Band 13mm
 SP162801 SP - Sensor Cable 180mm
 SP162802 SP - Sensor Cable 90mm
 SP162810 SP - HiPower Connector; 3pcs set
 SPMSSC1.5M SP - Super Capacitor 1.5 Farads 7.4 Volt rated
 SPCBB138328 SP - Ceramic Motor Bearing
 SPF105 SP Ultra Stock BL Motor 10.5T BRCA ROAR
 SPF135 SP Ultra Stock BL Motor 13.5T BRCA ROAR
 SPF175 SP Ultra Stock BL Motor 17.5T ROAR
 SPR13835 Rotor 3.5T; Standard 13.5mm
 SPR13845 Rotor 4.5T; Standard 12.5mm
 SPRB13835 Rotor 3.5T; H RPM 13mm
 SPRB13845 Rotor 4.5T; H RPM 12mm

BATTERIES

CR004 CORE RC - 5000mAh 7.4v LiPo
 CR005 CORE RC Battery Tape - Black
 CR006 CORE RC Battery Tape - Blue
 CR007 CORE RC Silicone Wire 12g - Red/Black 2x50cm
 CR008 CORE RC RED Connector with 2x4mm Tubes
 CR009 CORE RC RED Connector with 2x4mm Males
 CR033 CORE RC - Safe Charge Pouch
 CR034 CORE RC - 3250mAh 7.4v LiPo
 CR037 CORE RC Battery Tape - Purple
 G756 East Power 4200mAh - XVS Sport x6
 G757 Orion SHO 4200 - XVS Team x6
 G758 Orion SHO 4200 - XVS Team x5
 G759 Orion SHO 4200 - XVS Team x4
 G760 Orion SHO 4200 - XVS Sport x6
 G761 East Power 4600 - 2008 XVS Team x6
 G762 East Power 4600 - 2008 XVS Team x5
 G763 East Power 4600 - 2008 XVS Team x4
 G764 East Power 4600 - 2008 XVS Sport x6
 G793 Silicone Wire - 2x50cm Red/Black
 G794 Battery Bars - pk5
 G795 Female Connector Tubes (pk 10)
 G796 Male Connector Plugs (pk 2)
 H1039 Battery Tape - Natural 50m x 17mm
 H1046 T Connector; Red 2 Way - Male & Female
 H1047 T Connector; Black 2 Way - Male & Female
 H1048 T Connector; Red Sockets - pk4
 H1049 T Connector; Black Sockets - pk4
 H1054 Polarised Plug+Socket; 3.5mm - Pair

ACCESSORIES

CR001 CORE RC Motor & Battery Case
 CR022 CORE RC - Digital Pocket Scale 500gram
 CR023 CORE RC - Digital Caliper 0-100mm
 CR024 CORE RC - Serrated M4 Steel Wheel Nut pk4
 MC3 Mega Cargo Carrier; 1/10 Touring

1/10 TOURING WHEELS

U1932 Wheel; 5 spoke 25mm - White (Pk4)
 U1933 Wheel; 5 spoke 25mm - Black (Pk4)
 U1934 Wheel; 5 spoke 25mm - Satin (Pk4)
 U1935 Wheel; 5 spoke 25mm - Chrome (Pk4)
 U2170 Wheel; 12 spoke 25mm - White (Pk4)
 U2171 Wheel; 12 spoke 20mm - White (Pk4)
 U2172 Wheel; 12 spoke 25mm - Purple Chrome (Pk4)
 U2173 Wheel; 5 spoke 25mm - Purple Chrome (Pk4)
 U2296 Wheel; Dish 25mm - White (Pk4)
 U2300 Wheel; 5 sp 25mm - Gold (pr) (Pk4)
 U2366 Wheel; 12 spoke 24mm - White (Pk4)
 U2399 Wheel; 12 spoke 24mm - Black (Pk4)
 U2500 Rev-Line; 24mm - White (Pk4)
 U2501 Rev-Line; 24mm InchUp - White (Pk4)
 U2777 Rev-Line; Flex 24mm - White (Pk4)
 U2799 Rev-Line Stiff; 24mm - White (Pk4)



1/10 TOURING TYRES & INSERTS

U6623 SST Mini Pins 24/25 - Blue (pr)
 U6624 SST Mini Pins 24/25 - Yellow (pr)
 U6626 SST Foam Tyre Insert - 24/25 Soft (pr)
 U6627 SST Foam Tyre Insert - 24/25 Hard (pr)
 U6628 SST Foam Tyre Insert - 24/25 Comp (pr)
 U6629 SST Rally 24/25 - Yellow (pr)
 U6630 SST Rally 24/25 - White (pr)
 U6634 SST Foam Tyre Insert - 20 Soft (pr)
 U6635 SST Foam Tyre Insert - 20 Hard (pr)
 U6670 SST Mini Pins 20 - Blue (pr)
 U6671 SST Mini Pins 20 - Yellow (pr)
 U6672 SST Bebed Slick 25 - White (pr)
 U6690 SST Carpet Dragon 24/25mm (pr)
 U6695 Moulded LP Insert Orange X-Soft (pr)
 U6696 SST Moulded LP Insert Green Med (pr)
 U6699 SST LP24 Foam Insert Med Blk (pr)
 U6700 SST LP24 Foam Insert Soft Gy (pr)
 U6714 Moulded CP Insert Aqua - Soft (pr)
 U6716 SST Mini Pins 24/25 - Green (pr)
 U6717 SST Mini Pins 20 - Green (pr)

PINIONS

U3414 Pinion; Hard Alloy 48dp - 14T
 U3415 Pinion; Hard Alloy 48dp - 15T
 U3416 Pinion; Hard Alloy 48dp - 16T
 U3417 Pinion; Hard Alloy 48dp - 17T
 U3418 Pinion; Hard Alloy 48dp - 18T
 U3419 Pinion; Hard Alloy 48dp - 19T
 U3420 Pinion; Hard Alloy 48dp - 20T
 U3421 Pinion; Hard Alloy 48dp - 21T
 U3422 Pinion; Hard Alloy 48dp - 22T
 U3423 Pinion; Hard Alloy 48dp - 23T
 U3424 Pinion; Hard Alloy 48dp - 24T
 U3425 Pinion; Hard Alloy 48dp - 25T
 U3426 Pinion; Hard Alloy 48dp - 26T
 U3427 Pinion; Hard Alloy 48dp - 27T
 U3428 Pinion; Hard Alloy 48dp - 28T
 U3429 Pinion; Hard Alloy 48dp - 29T
 U3430 Pinion; Hard Alloy 48dp - 30T
 U3431 Pinion; Hard Alloy 48dp - 31T
 U3432 Pinion; Hard Alloy 48dp - 32T
 U3433 Pinion; Hard Alloy 48dp - 33T
 U3434 Pinion; Hard Alloy 48dp - 34T
 U3435 Pinion; Hard Alloy 48dp - 35T
 U3436 Pinion; Hard Alloy 48dp - 36T
 U3437 Pinion; Hard Alloy 48dp - 37T
 U3438 Pinion; Hard Alloy 48dp - 38T
 U3619 Pinion; Hard Alloy 64dp - 19T
 U3620 Pinion; Hard Alloy 64dp - 20T
 U3621 Pinion; Hard Alloy 64dp - 21T
 U3622 Pinion; Hard Alloy 64dp - 22T
 U3623 Pinion; Hard Alloy 64dp - 23T
 U3624 Pinion; Hard Alloy 64dp - 24T
 U3625 Pinion; Hard Alloy 64dp - 25T
 U3626 Pinion; Hard Alloy 64dp - 26T
 U3627 Pinion; Hard Alloy 64dp - 27T
 U3628 Pinion; Hard Alloy 64dp - 28T
 U3629 Pinion; Hard Alloy 64dp - 29T
 U3630 Pinion; Hard Alloy 64dp - 30T
 U3631 Pinion; Hard Alloy 64dp - 31T
 U3632 Pinion; Hard Alloy 64dp - 32T
 U3633 Pinion; Hard Alloy 64dp - 33T
 U3634 Pinion; Hard Alloy 64dp - 34T
 U3635 Pinion; Hard Alloy 64dp - 35T
 U3636 Pinion; Hard Alloy 64dp - 36T
 U3637 Pinion; Hard Alloy 64dp - 37T
 U3638 Pinion; Hard Alloy 64dp - 38T
 U3639 Pinion; Hard Alloy 64dp - 39T
 U3640 Pinion; Hard Alloy 64dp - 40T
 U3641 Pinion; Hard Alloy 64dp - 41T
 U3642 Pinion; Hard Alloy 64dp - 42T
 U3644 Pinion; Hard Alloy 64dp - 44T
 U3646 Pinion; Hard Alloy 64dp - 46T
 U3648 Pinion; Hard Alloy 64dp - 48T
 U3650 Pinion; Hard Alloy 64dp - 50T

U3273 CF 2008 Euro Top Deck - Mi3
 U3274 CF 2008 Flex Top Deck - Mi3
 U3271 CF LiPo Battery Locator (pr)

Euro Top Deck is standard on the Mi3 PRO.
 Flex Top Deck is more flexible for lower traction conditions.

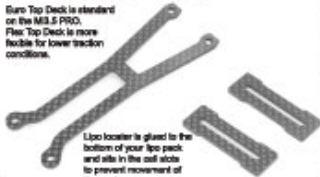

LiPo locator is glued to the bottom of your lipo pack and sits in the well which to prevent movement of the pack.

Silicone shock oil

G020 - 20 weight (thin)
 G025 - 25 weight
 G030 - 30 weight
 G035 - 35 weight
 G040 - 40 weight
 G045 - 45 weight
 G050 - 50 weight
 G055 - 55 weight
 G060 - 60 weight
 G070 - 70 weight
 G080 - 80 weight
 G100 - 100 weight
 G120 - 120 weight (thick)



U2822 Spring Tuning Set - Pro-Touring (6 prs)
 U3156 Roll Bar Set; Front 1.2-1.4-1.6 - Mi3
 U3157 Roll Bar Set; Rear 1.2-1.4-1.6 - Mi3

U3127 Wishbones; Graphite Front - Mi3
 U3128 Wishbones; Graphite Rear - Mi3
 U3249 Wishbones; Med Flex Front - Mi3 (kit)
 U3250 Wishbones; Med Flex Rear - Mi3 (kit)
 U3251 Wishbones; Extra Flex Front - Mi3
 U3252 Wishbones; Extra Flex Rear - Mi3



More flex = more traction but less response.



HW010 Wiha Precision Circlip Pliers for diff maintenance.

Curved Body Scissors H1009
 Designed for cutting out polycarbonate bodies.

U3146 CF Chassis - 2.5mm Stiff - Mi3
 U3153 CF Shock Bkt; Rear - Low - Mi3
 U3152 CF Shock Bkt; Front - Low - Mi3
 U3246 CF Top Deck - 2.5mm - Mi3

2.5mm thicker chassis, top deck and low shock towers are designed for carpet racing on firm tyes. Increased rigidity for higher traction conditions.



SP13825 Speed Passion CV2.0 Comp BL Motor; 2.5T
 SP13835 Speed Passion CV2.0 Comp BL Motor; 3.5T
 SP13840 Speed Passion CV2.0 Comp BL Motor; 4.0T
 SP13845 Speed Passion CV2.0 Comp BL Motor; 4.5T
 SPF105 Speed Passion Ultra Stock BL Motor; 10.5T
 SPF135 Speed Passion Ultra Stock BL Motor; 13.5T
 SPF175 Speed Passion Ultra Stock BL Motor; 17.5T
 SPF215 Speed Passion Ultra Stock BL Motor; 21.5T



U2789 Hex Driver - 1.5mm

U2790 Hex Driver - 2.00mm

U2791 Hex Driver - 2.5mm

U2795 M3 Nut Driver

U2796 M4 Nut Driver

U2818 Body Reamer

U2753 Heavy Duty Front One Way Assy - Mi3
 U3223 Diff - Fully Assembled Ceramic - Mi3

A one way allows sharper turn in but more unstable braking. Popular on large tracks where traction is high.



A front diff is recommended for firm tyes on carpet.



G761 - East Power 4600-2008 XVS Team x 6
 G762 - East Power 4600-2008 XVS Team x 5
 G764 - East Power 4600-2008 XVS Sport x 6



C4450
 20g CS Cyno (Super Glue)
 Thin, ideal for tyres.

U3171 Ceramic Bearing set - Mi-3

Super high efficiency and long life.



H1032 Alloy Camber Gauge - 1-10th



H1026 Ride Height Gauge - Purple Alloy
 H1027 Droop Gauge Set - Purple Alloy



For brushed or brushless motors.

SPEXT68801LPF Speed Passion - BL ESC; LPF 5.5T
 SPEXT98801 Speed Passion - BL ESC; GT 2.5T