

## Instruction Manual v.1.0

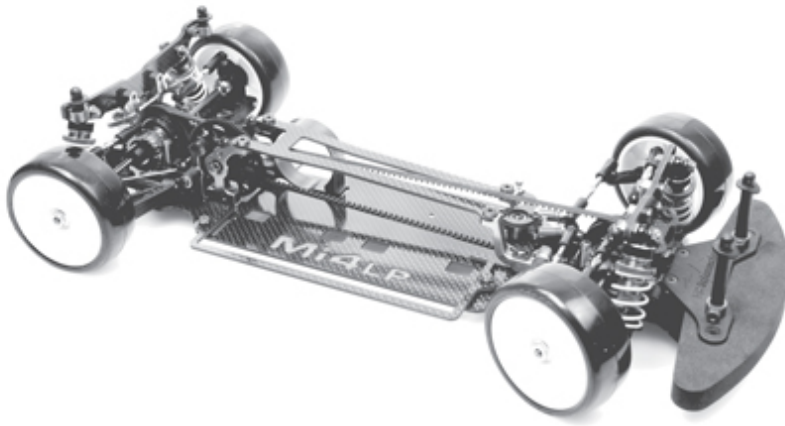

Schumacher Racing  
73 Tenter Road  
Moulton Park  
Northampton  
NN3 6AX  
ENGLAND



Schumacher USA Inc  
6902 Benjamin Road  
Suite 404  
Tampa  
Florida 33634  
U.S.A

**Additional Items Required**

**Transmitter, receiver and servo**  
(Including AA batteries for it)



**Electronic Speed Control**



**Battery Pack**



**Battery Tape**

**Motor**



**Pinion Gear**



**Battery Charger**



**Bodyshell & Paint**



**Wheels & Tyres**



**Tools**

Wingo Wingo Precision  
Crimp Pliers



CB44 Curved Body Scissors



ED18105 Hex Driver 1.5 x 100mm  
ED18104 Hex Driver 2.0 x 100mm  
ED18105 Hex Driver 2.5 x 100mm



ED18105 Nut Driver 5.5 x 100mm  
ED18104 Nut Driver 7.0 x 100mm



Torxwrench Wrench 4mm ED18104



UW01 - Solder



Schumacher Racing stocks and distributes the following manufacturers products and full product listings are available on our website at [www.racing-cars.com](http://www.racing-cars.com).

PLEASE NOTE THAT SOME OF THE PRODUCT RANGES BELOW ARE ONLY AVAILABLE IN THE UNITED KINGDOM.

**CORE-RC**  
COM

**NI-SRAM**

**Speed Passion**  
All Technology Revolution

**GM**

**Wingo**

**East Coast BodiesTune**

**SUREX**

**EDS**  
Specialist RC Tools

**IMPORTANT SAFETY NOTES**

- This product is not suitable for children under the age of 14, without the direct supervision of an adult.
- Select an area for assembly that is away from the reach of small children. The parts in this kit are small and can be swallowed by children causing choking and possible internal injuries.
- Exercise care when using hand tools and sharp instruments during assembly.
- Carefully read all manufacturers warnings and cautions for any additional parts used in the construction.
- In line with our policy of continuous development the exact details of the kit may vary.

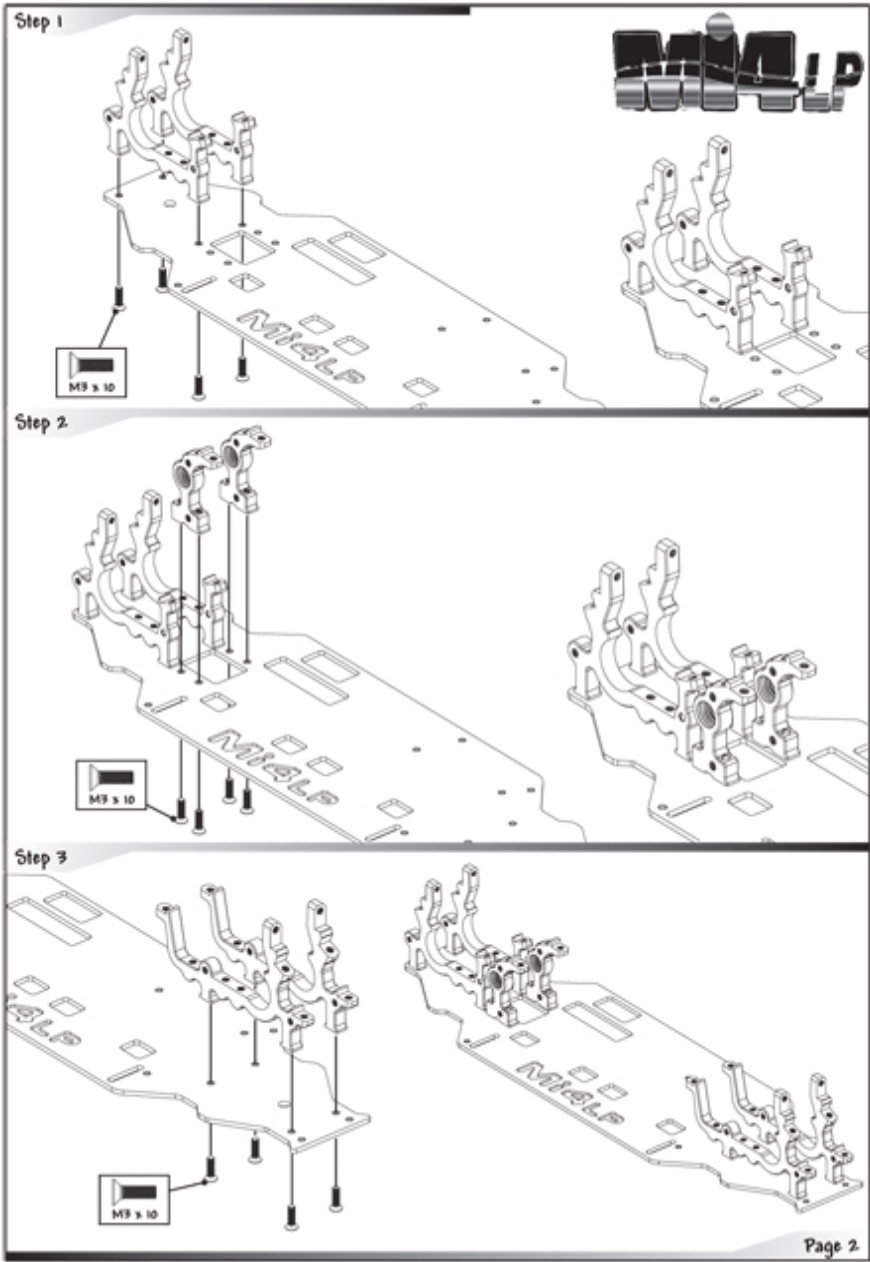

Step 4



Step 5

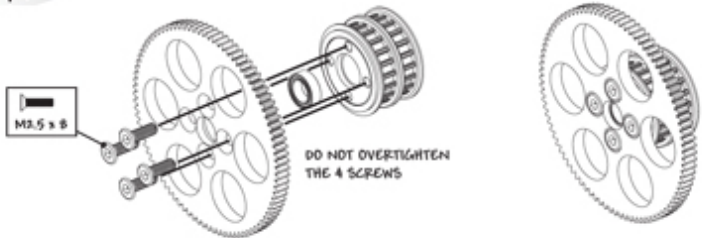

IMPORTANT TRANSMISSION OPTIONS

The Schumacher MHL P has the ability to flip the transmission to alter the left to right weight balance. Depending on what weight limit you run to, this is a vital tool to balance the car. If you use a lightweight Servo, ESC and FX use Option 2 transmission layout. If you have heavier equipment use Option 1 and move the radio gear as close as possible to the centre of the car. The motor position also aids in left to right balance. The UJ9500 Schumacher Precision Pivot Balance Set is an ideal system to balance your MHL P.

Step 6

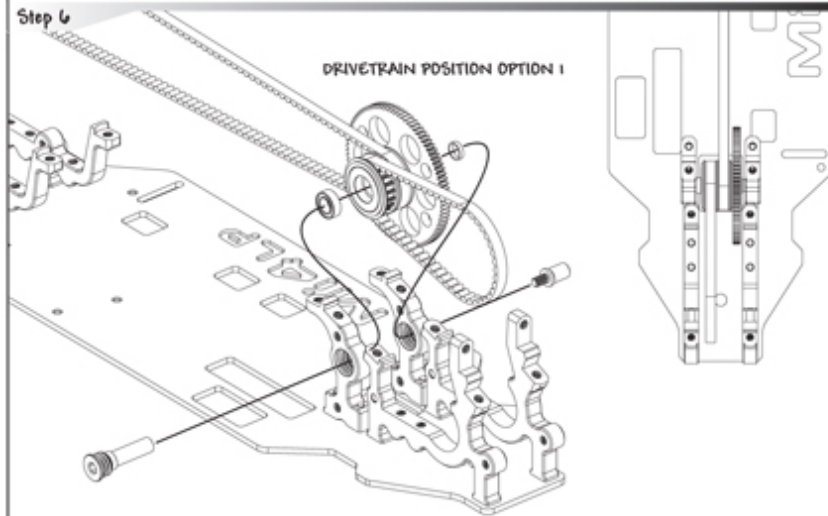

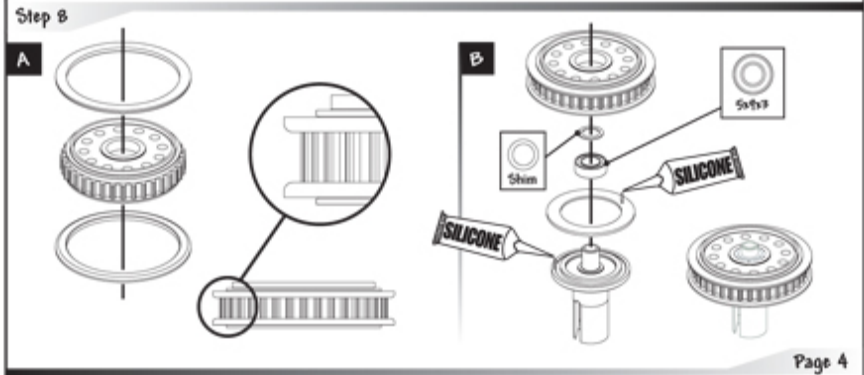
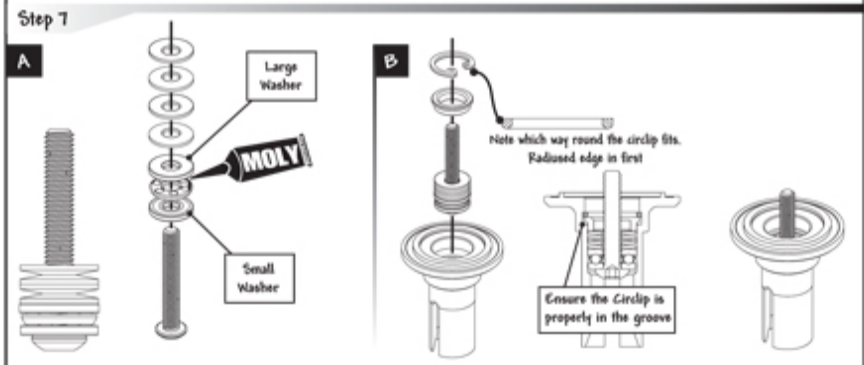
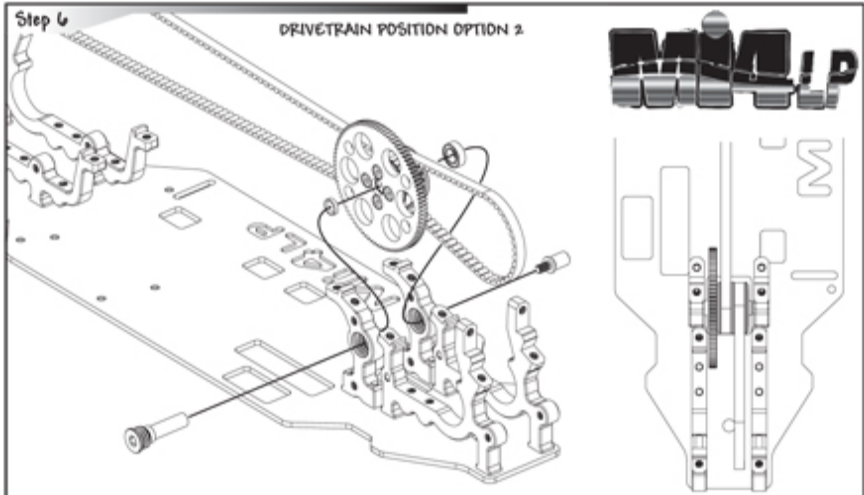

Step 9

A

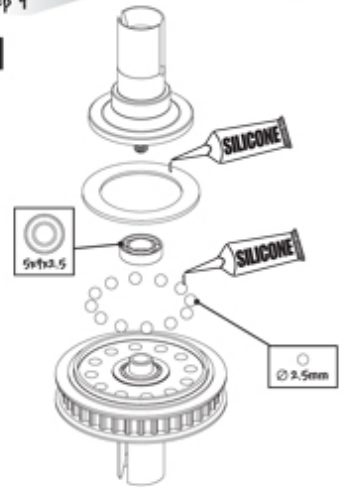

B

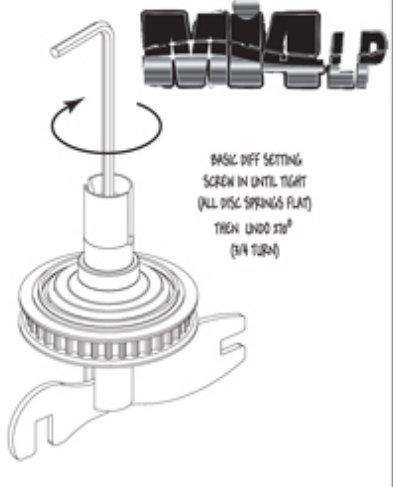

Step 9

C

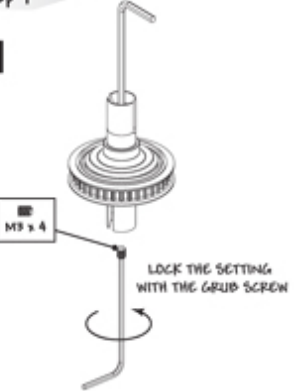

D

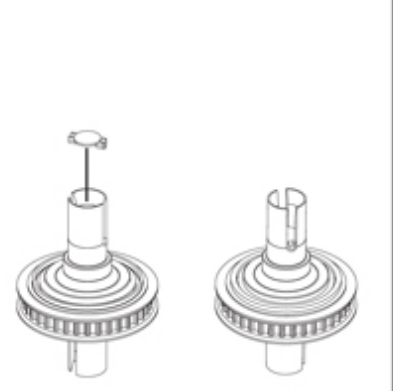

Step 10

A

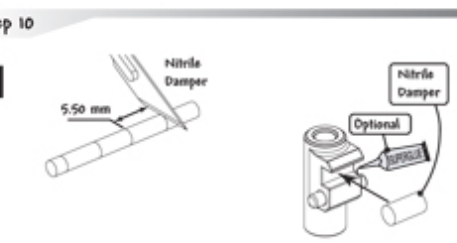

**Step 10**

**B**

$10 \times 15 \times 4$

The Indents Must Face Outwards

Fit Shims to Adjust Endfloat of Diff in Car (Optional)

**FIT THE DIFF IN THE CAR ACCORDING TO WHICH OPTION YOU CHOSE FOR THE DRIVETRAIN (FRONT BELT NEAREST GEAR)**

**Step 10**

**C**

$M3 \times 20$

Retating the Diff Cam towards the layshaft will decrease the belt tension, and retating it away will increase the tension.

**BELT TENSION**

Decrease belt tension with Diff set high

Decrease belt Tension with Diff set Low

**MAKE SURE BOTH CAMS ARE SET THE SAME AND THE BELT TENSION IS GOOD**

High

Low

**Step 11**

Page 6

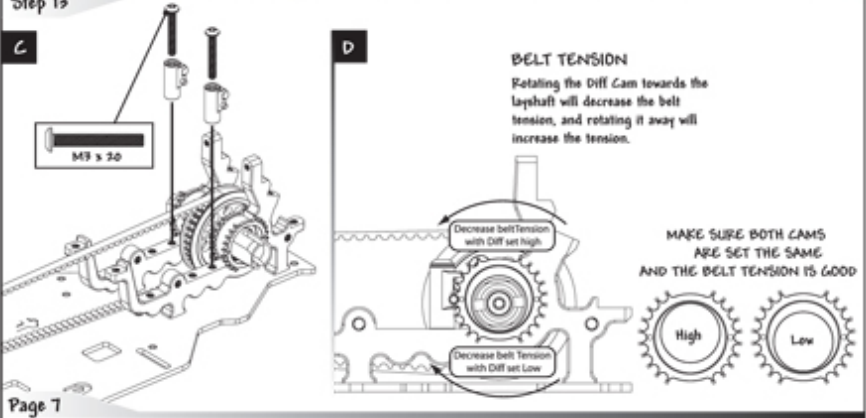
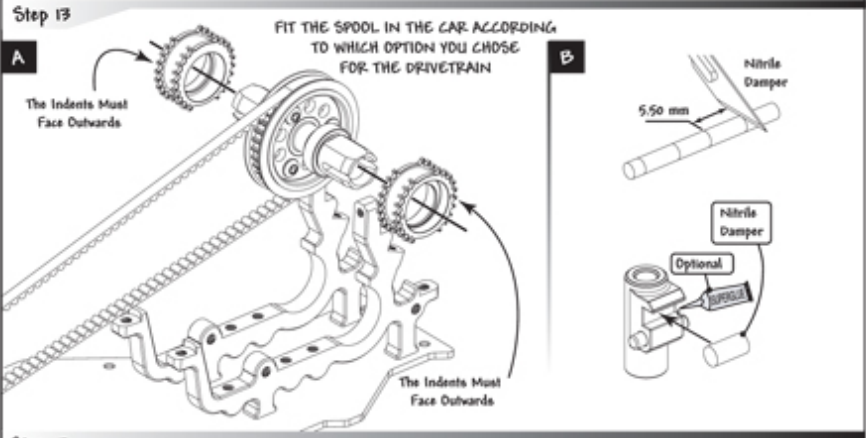
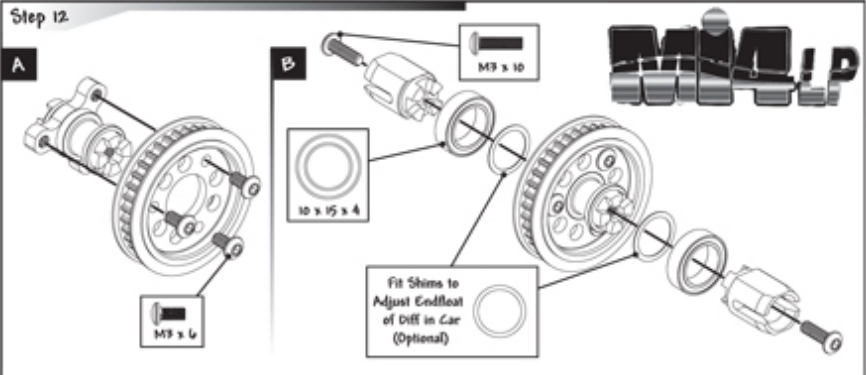



Step 14

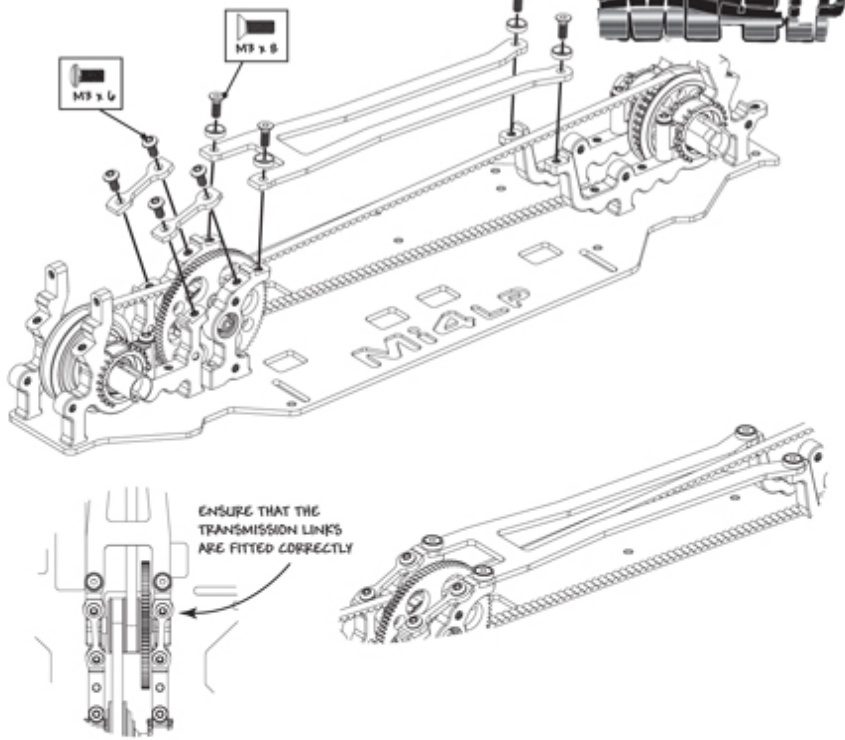

Step 15

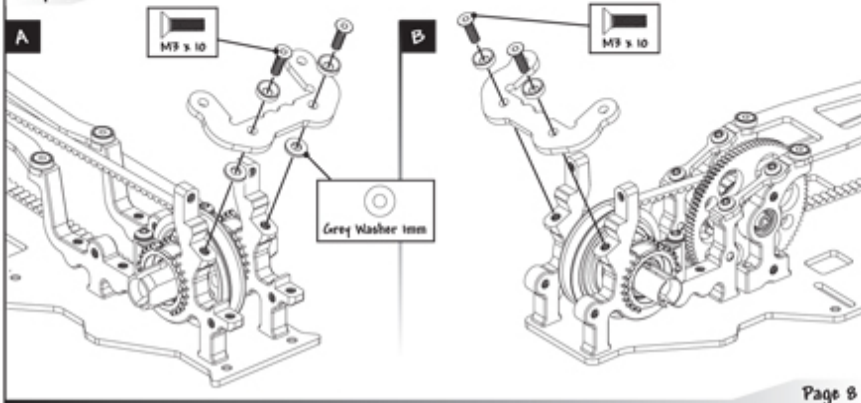

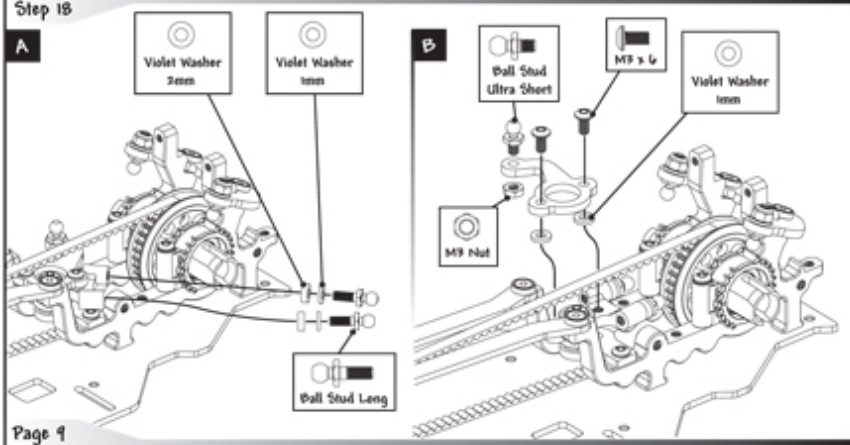
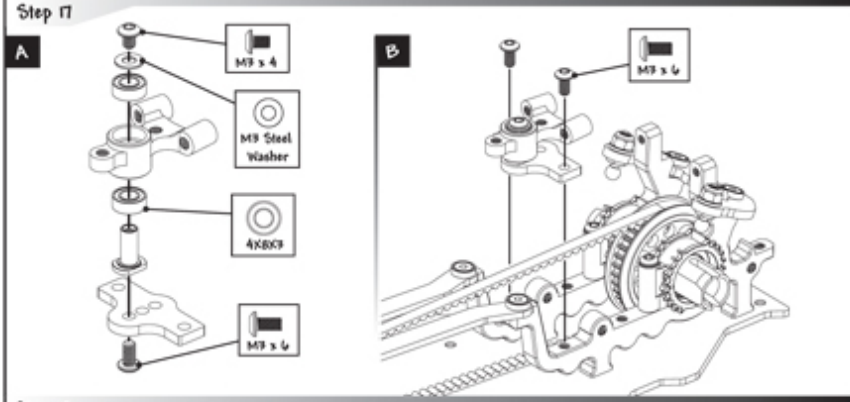
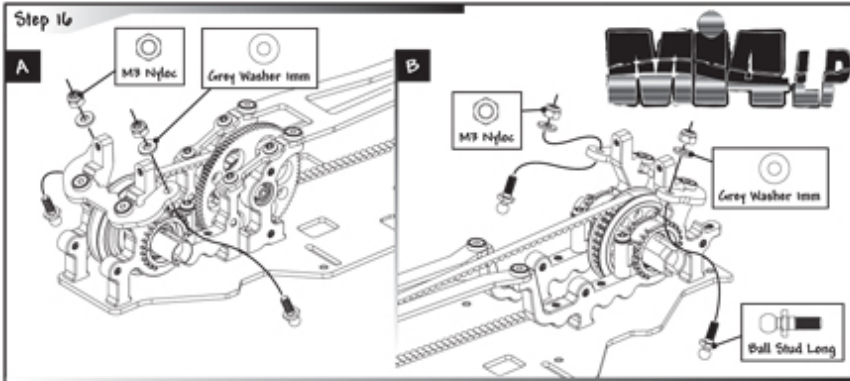

Step 19

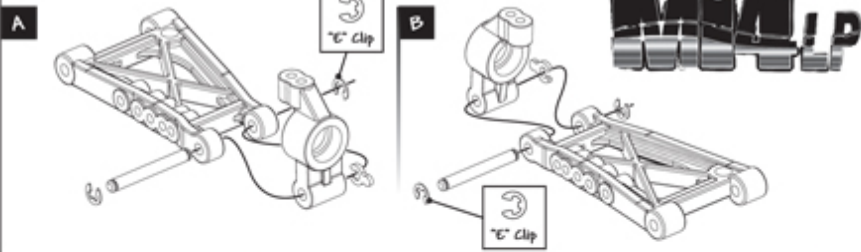

Step 20 PRO

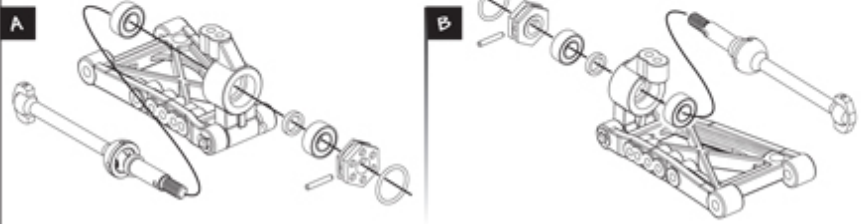

Step 20 RACE

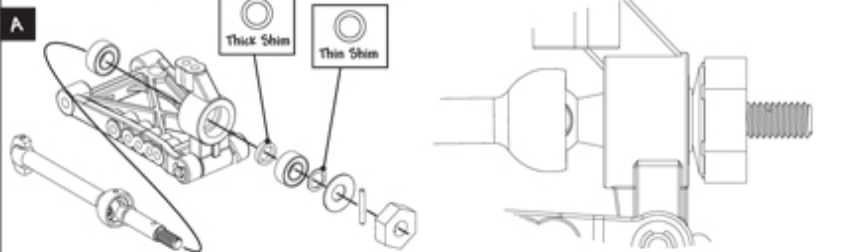

Step 20 RACE

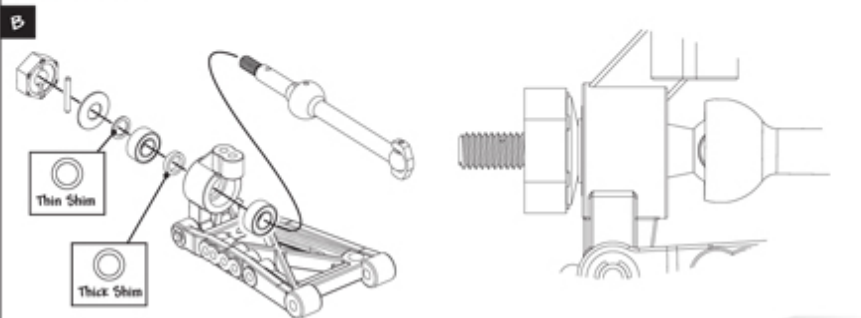

Step 21

A

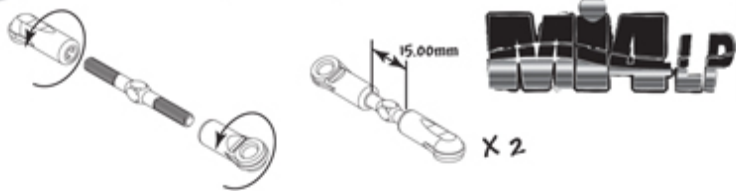

Step 21

B

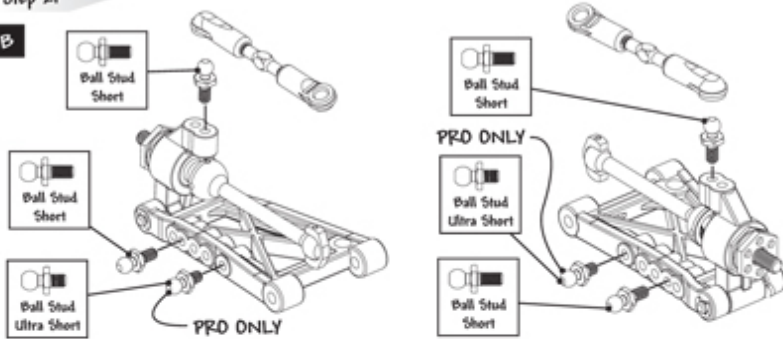

Step 22

A

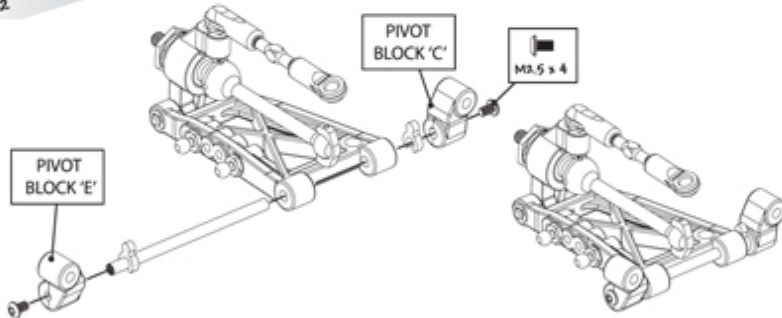

Step 22

B

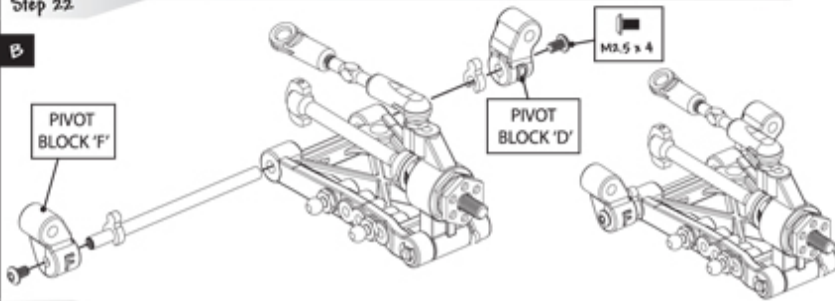

Step 23

A

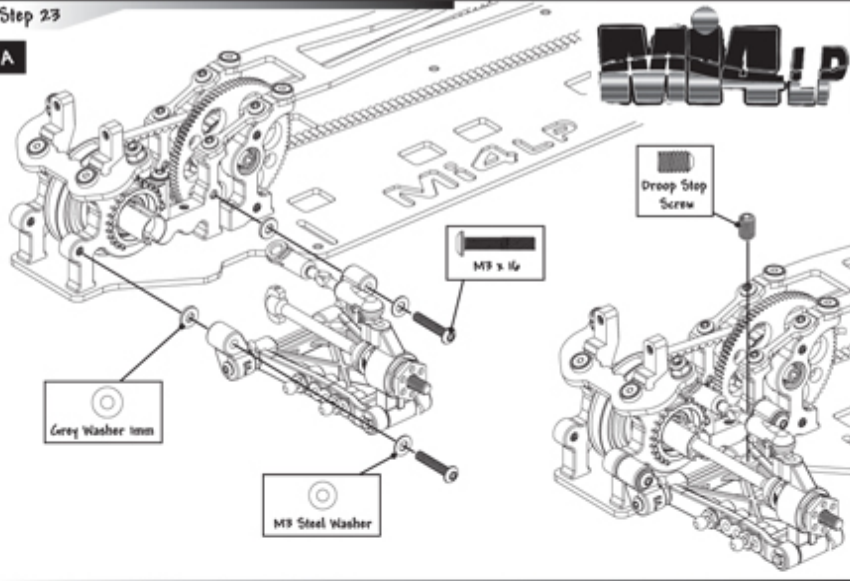

Step 23

B

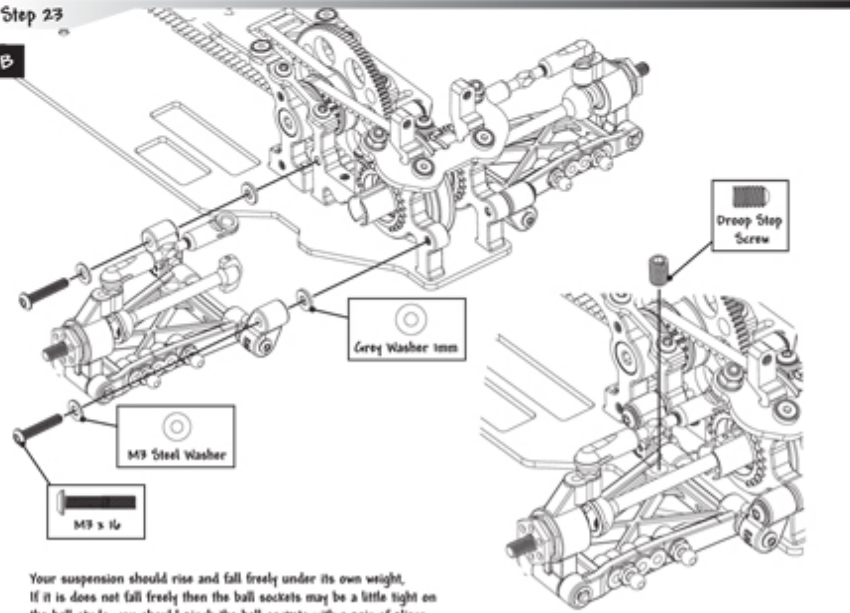

Your suspension should rise and fall freely under its own weight. If it does not fall freely then the ball sockets may be a little tight on the ball studs, you should pinch the ball sockets with a pair of pliers, this will loosen the socket off slightly, and allow you to fine tune the fit.

Step 24

A

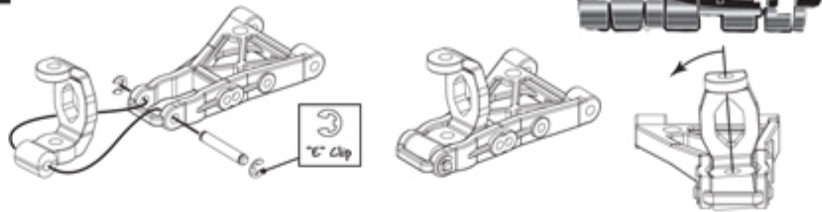

Step 24

B

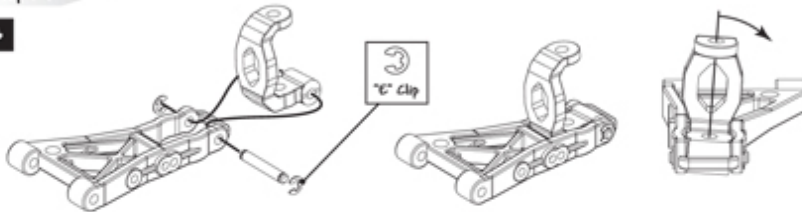

Step 25 PRO

A

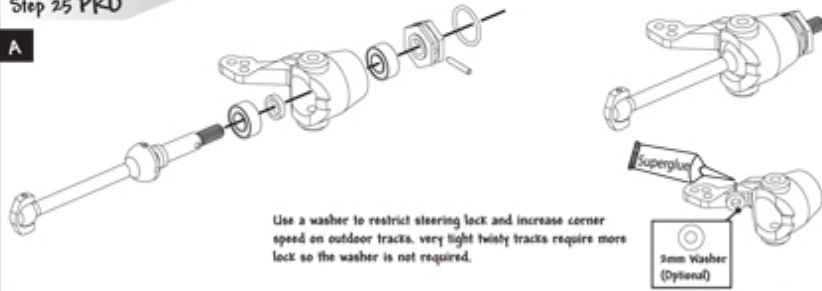

Use a washer to restrict steering lock and increase corner speed on outdoor tracks. very light twisty tracks require more lock so the washer is not required.

Step 25 RACE

A

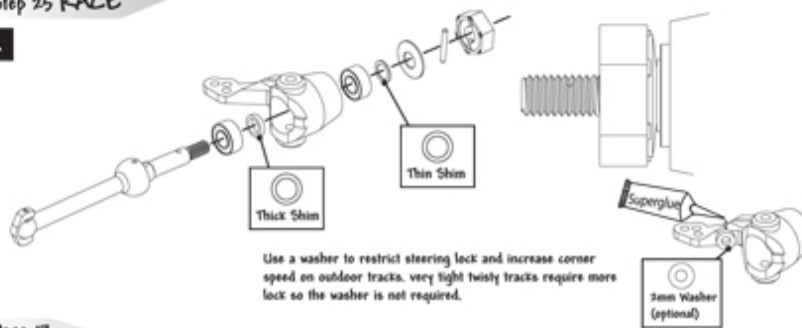

Use a washer to restrict steering lock and increase corner speed on outdoor tracks. very tight twisty tracks require more lock so the washer is not required.

**Step 25**

**B**

Carefully Pre-tap the Hub Carrier using a Hot Runner and the M4 Pivot, this will ensure easier assembly with the yoke with better alignment.

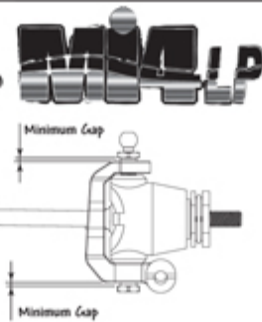
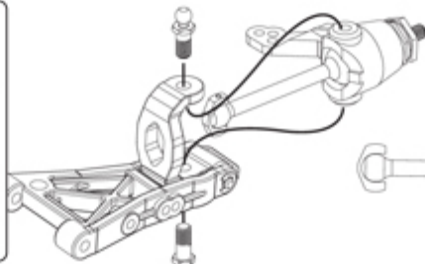

**Step 26 PRD**

**A**



Use a washer to restrict steering lock and increase corner speed on outdoor tracks, very tight twisty tracks require more lock so the washer is not required.



**Step 26 RACE**

**A**

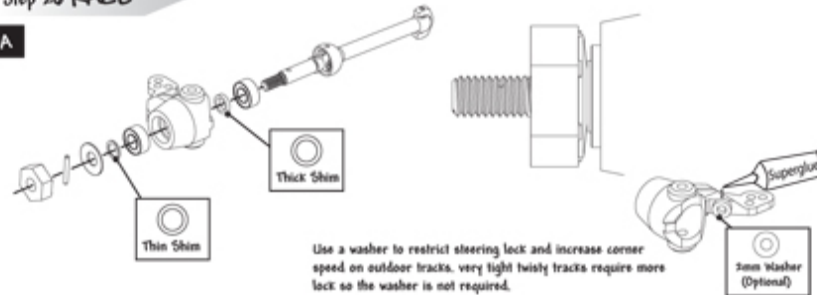

Use a washer to restrict steering lock and increase corner speed on outdoor tracks, very tight twisty tracks require more lock so the washer is not required.



**Step 26**

**B**

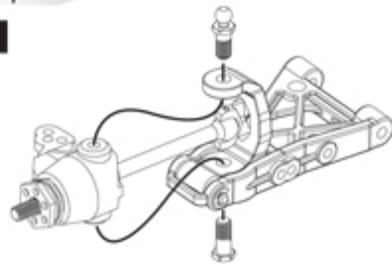

Carefully Pre-tap the Hub Carrier using a Hot Runner and the M4 Pivot, this will ensure easier assembly with the yoke with better alignment.

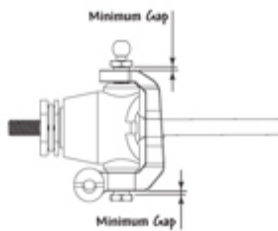

Step 27

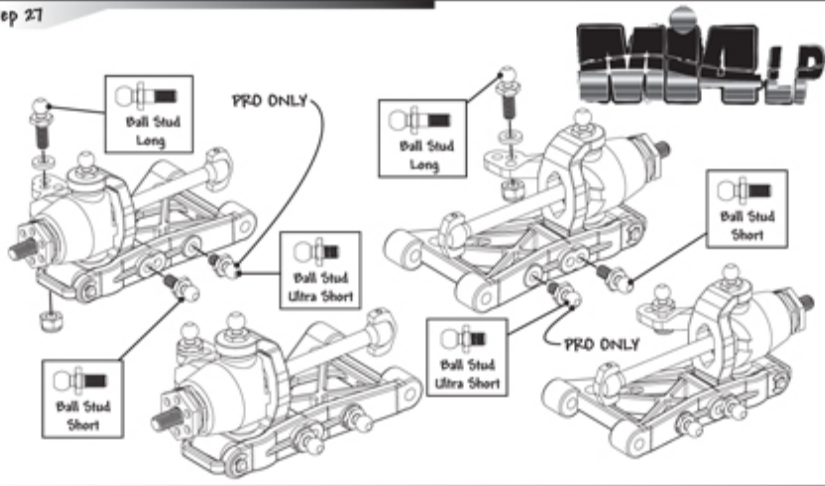

Step 28

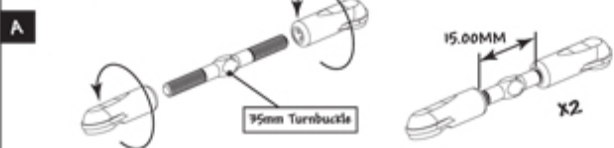

Step 28

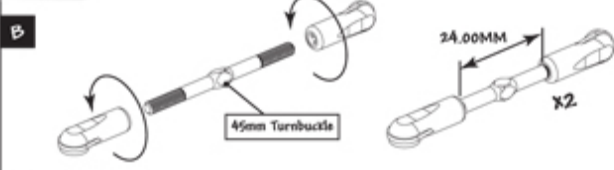

Step 28

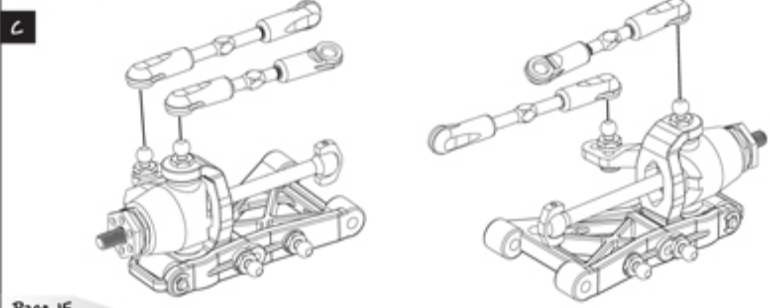



Step 29

A

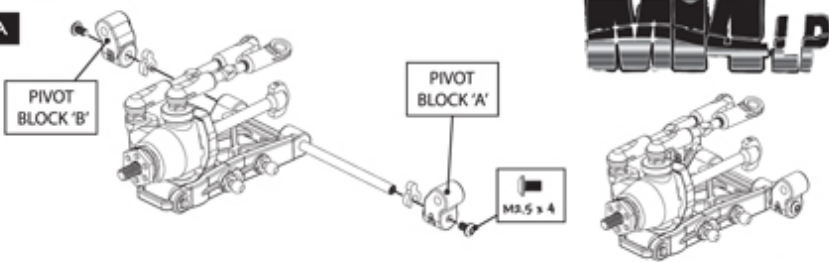

Step 29

B

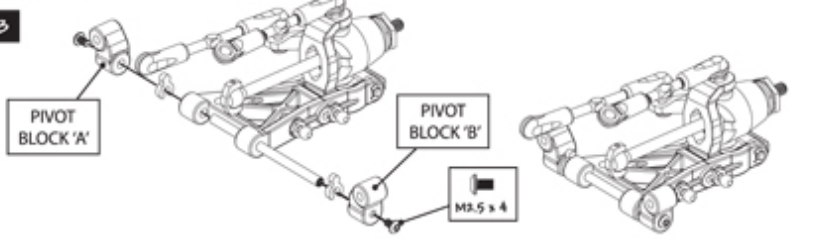

Step 30 PRO

A

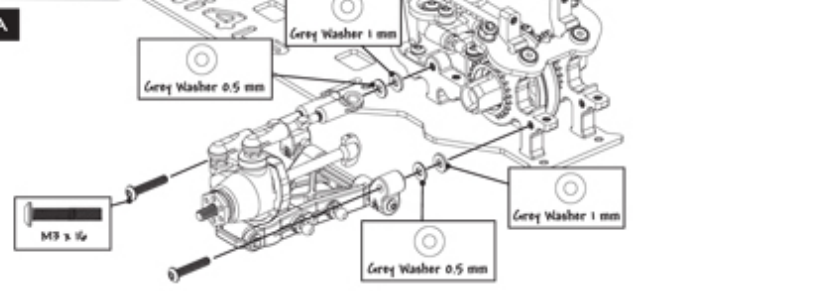

Step 30 RACE

A

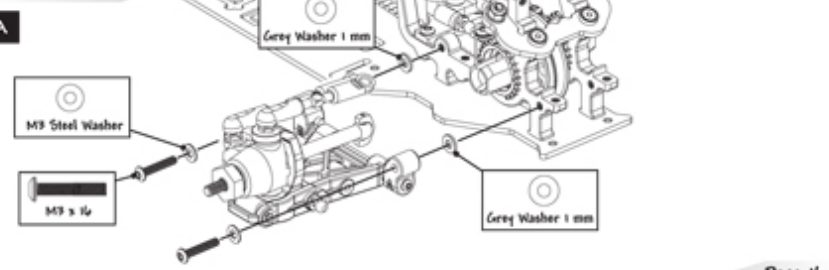

Step 30

B

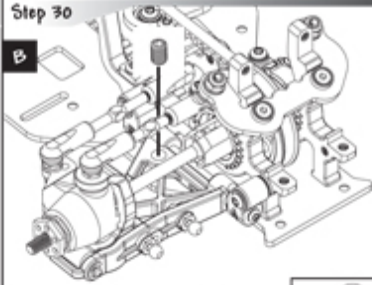

Your suspension should rise and fall freely under its own weight. If it does not fall freely then the ball sockets may be a little tight on the ball studs, you should pinch the ball sockets with a pair of pliers, this will loosen the socket off slightly, and allow you to fine tune the fit.

Step 30 PRO

C

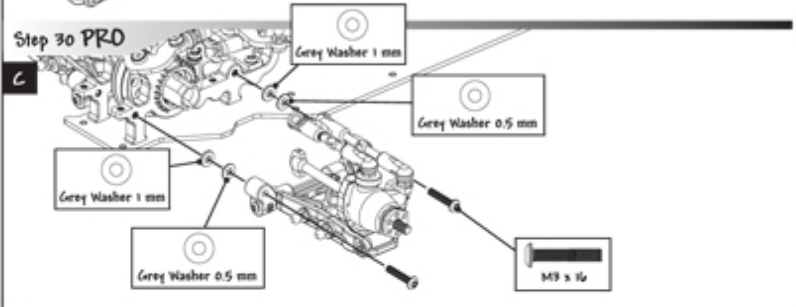

Step 30 RACE

C

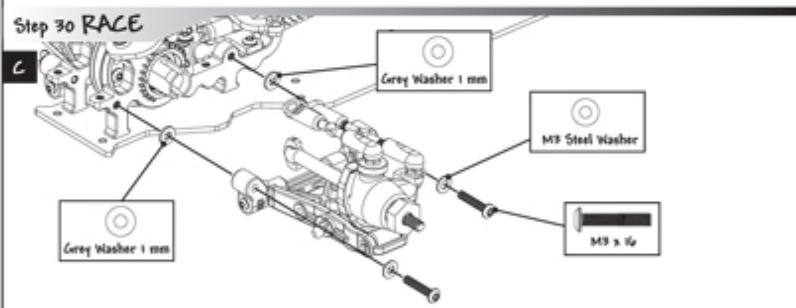

Step 30

D

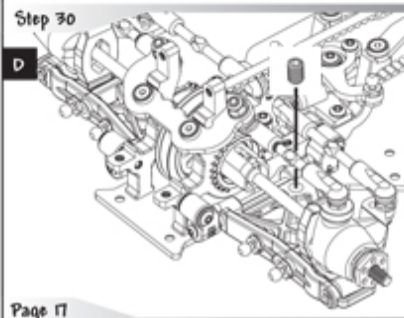

Your suspension should rise and fall freely under its own weight. If it does not fall freely then the ball sockets may be a little tight on the ball studs, you should pinch the ball sockets with a pair of pliers, this will loosen the socket off slightly, and allow you to fine tune the fit.

Step 31 PRO

A

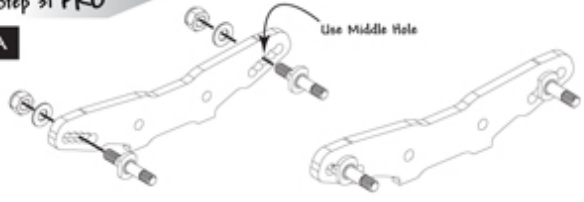

Step 31 RACE

A

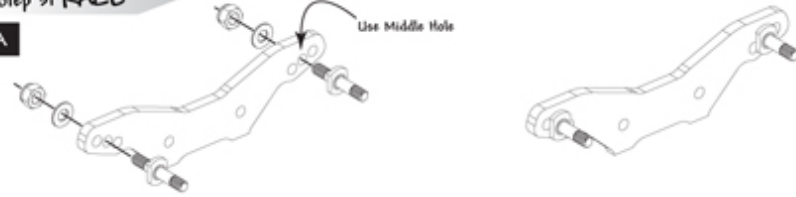

Step 31

B

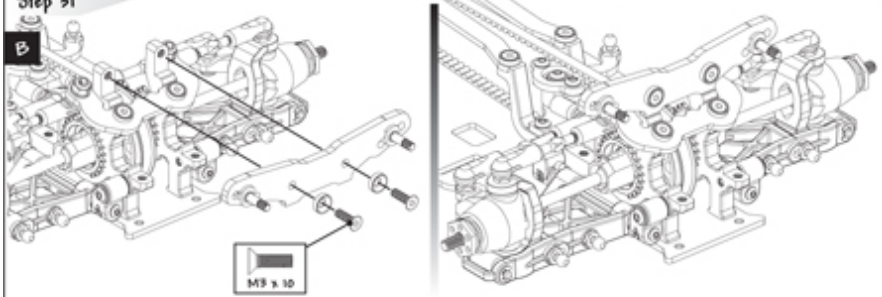

Step 32 PRO

A

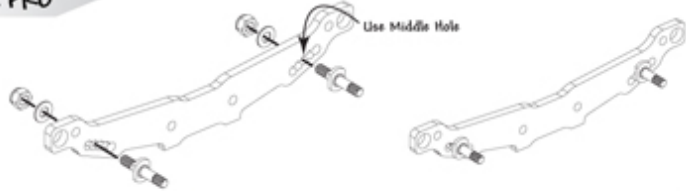

Step 32 RACE

A

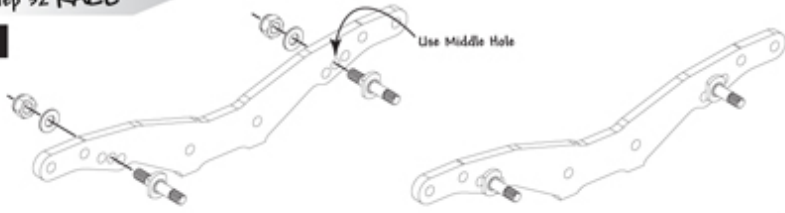

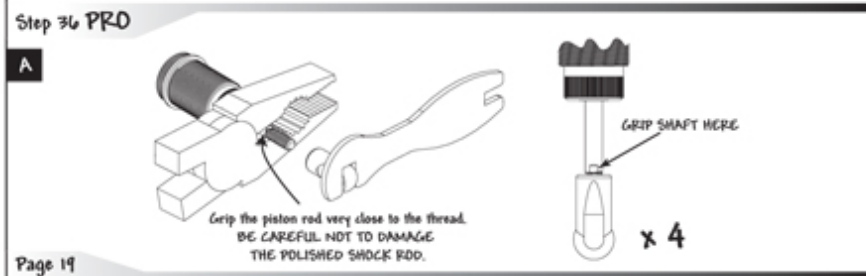
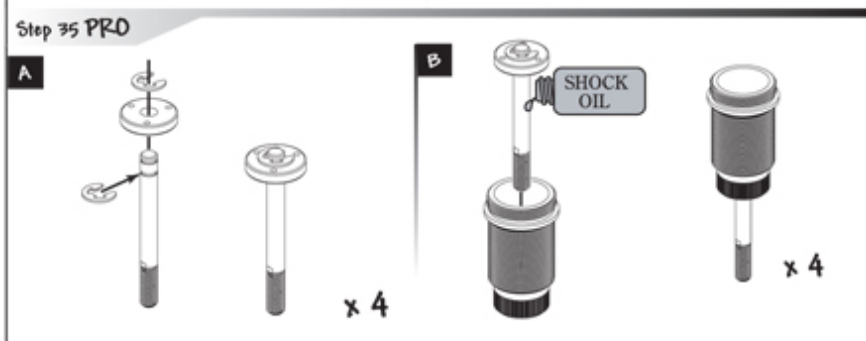
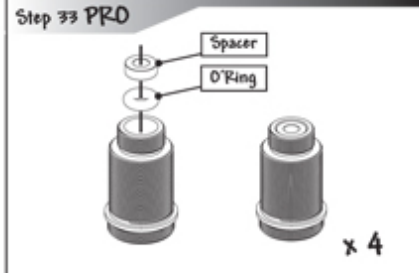
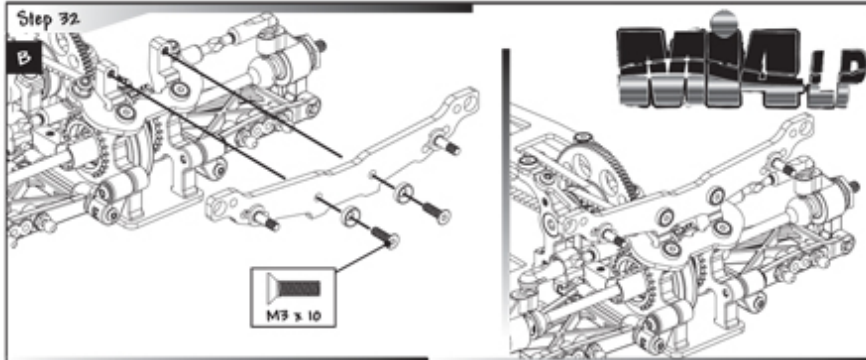

**Step 36 PRO**

**B**

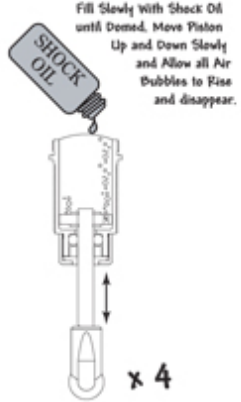

x 4

**C**



Adjust this distance (X) to suit the amount of rebound you want  
Bigger Distance = More Rebound



**D**



x 4

**Step 37 PRO**

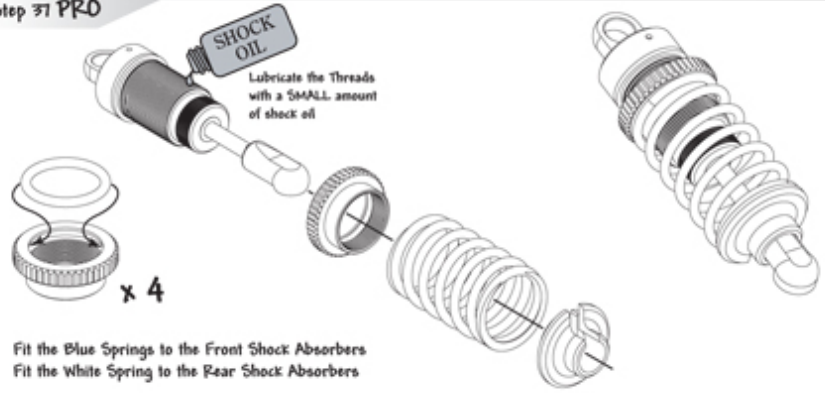

x 4

Fit the Blue Springs to the Front Shock Absorbers  
Fit the White Spring to the Rear Shock Absorbers

**Step 33 RACE**

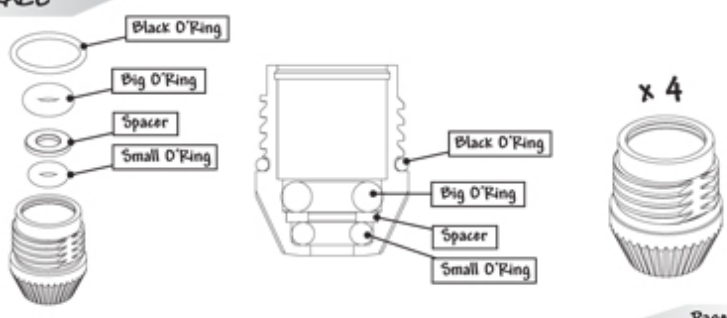

x 4

Step 34 RACE



Step 35 RACE



Step 36 RACE

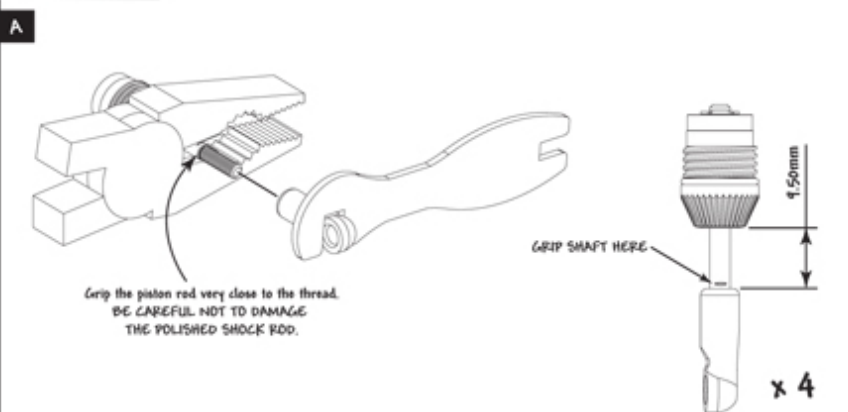

Step 36 RACE

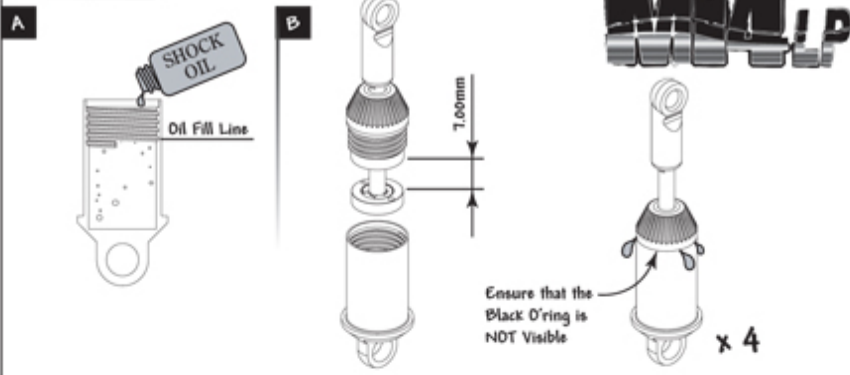

Step 37 RACE

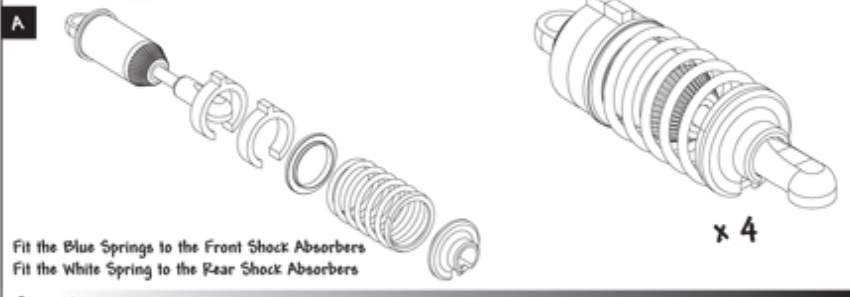

Step 38

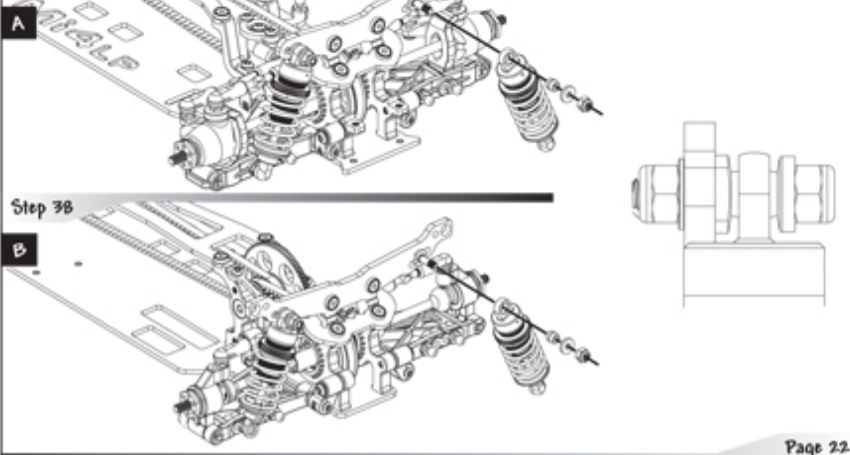

Step 39 PRO

A

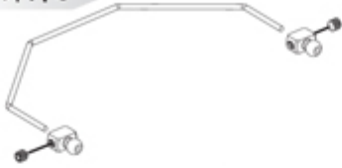

Step 39 PRO

B

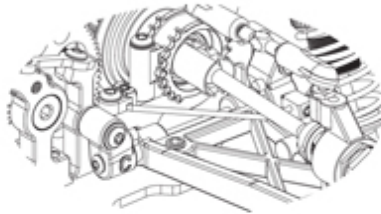
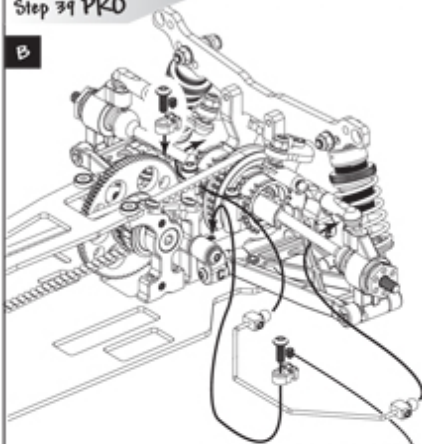

Carefully Adjust the grub screw to eliminate roll bar play

Step 39 PRO

C

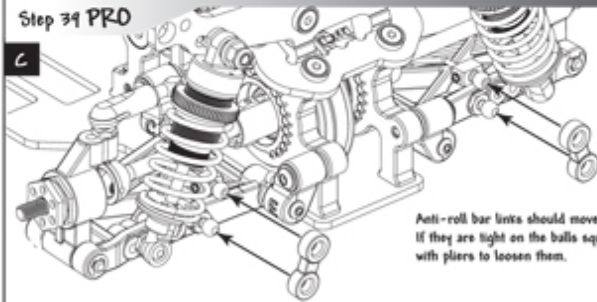

Anti-roll bar links should move freely. If they are tight on the balls squeeze them with pliers to loosen them.

Step 40 PRO

A

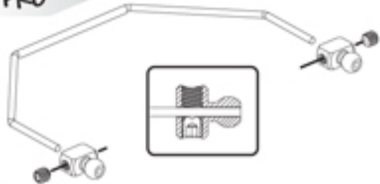



**Step 40 PRO**

**B**

Carefully Adjust the grub screw to eliminate roll bar play

**Step 40 PRO**

**C**

Anti-roll bar links should move freely. If they are tight on the balls squeeze them with pliers to loosen them.

**Step 41**

**Step 42**

M3 x 6

Leave Grub Screws loose for now

M3 x 8

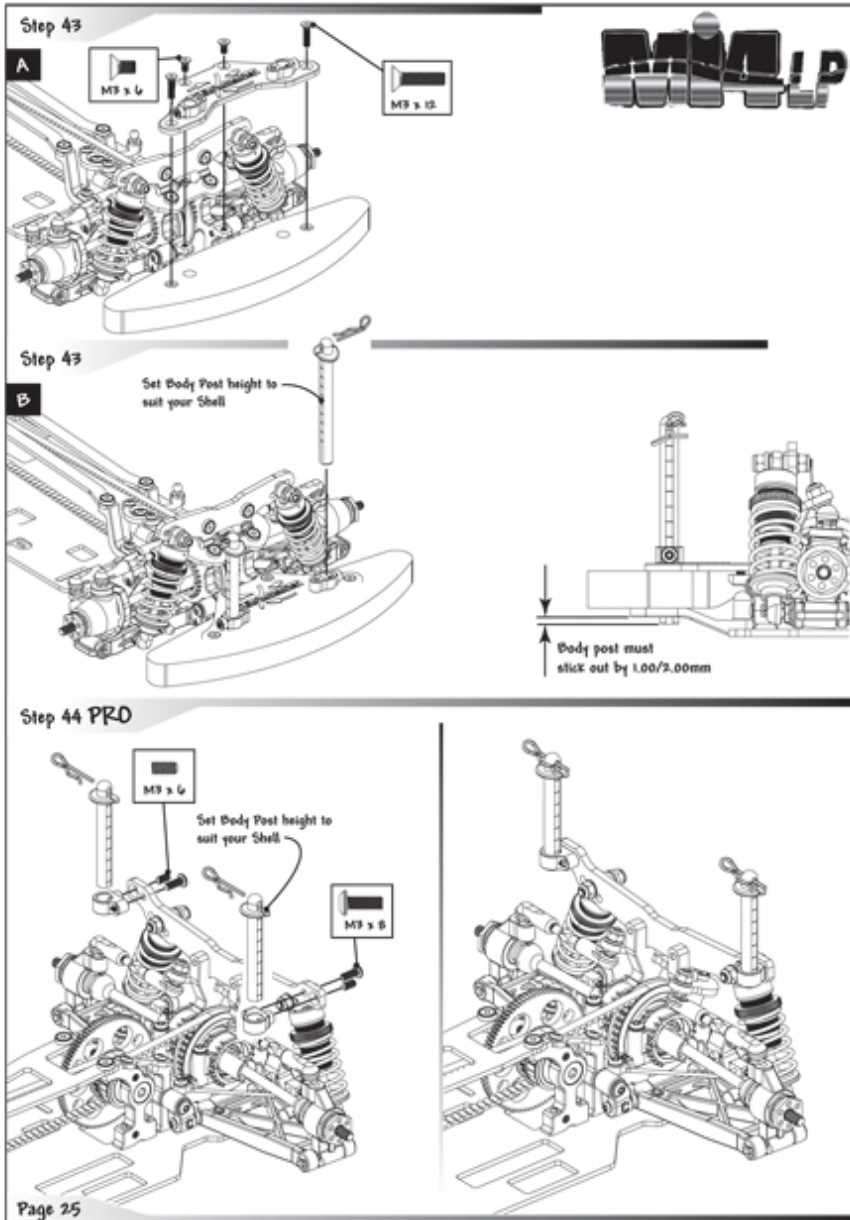

Step 44 SPORT

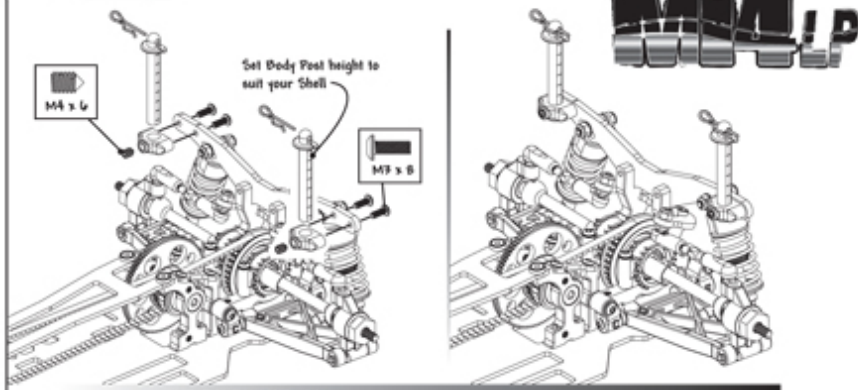

Step 45

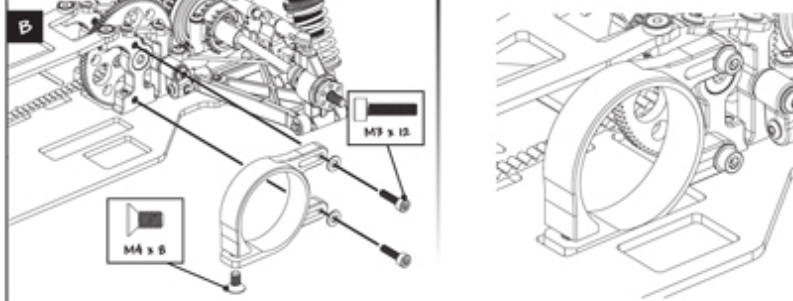

Step 46

**SERVO SAVER OPTION**

CHOOSE THE CORRECT HORN FOR YOUR SERVO.  
 SA = SANNIA/AIRTRONICS  
 FU = FUTABA  
 SH = RITEC

ROTATE 180° TO PRE-LOAD SPRING

Ball Stud Ultra Short

The Servo is NOT Included

Screw supplied with Servo

90° At Neutral

**NO SERVO SAVER**

Ball Stud Ultra Short

The Servo is NOT Included

Screw supplied with Servo

90° At Neutral

Step 47

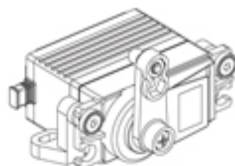
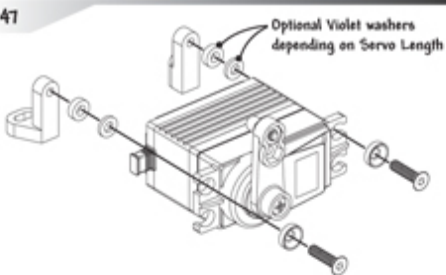

Step 48

A



Screw the grub screw fully into the socket



Screw the grub screw fully into the socket to touch the first grub screw

B



Depending on your servo and the position of the steering you may need to use the 34mm turnbuckle

Step 48

C

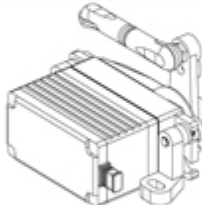
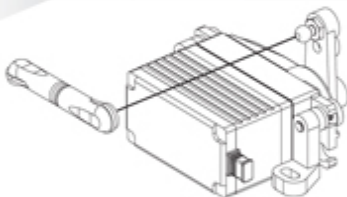

Step 49

B

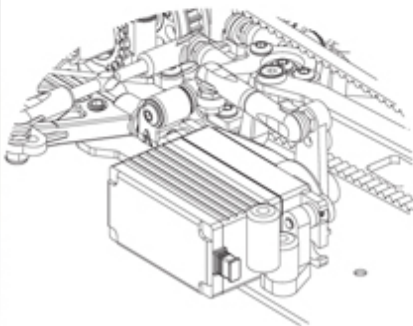
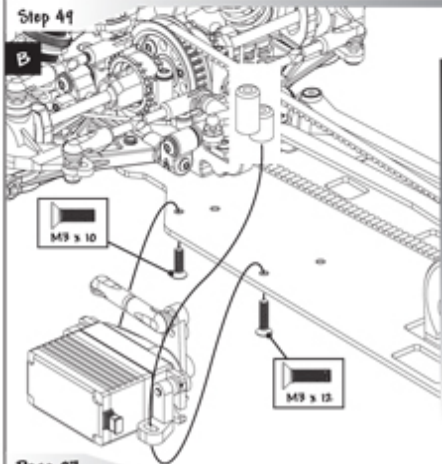

Step 41



C

Insert motor into clamp and tighten the clamp screw underneath the car  
Then adjust the gear mesh

Pinion and Grub Screw are NOT included in the kit

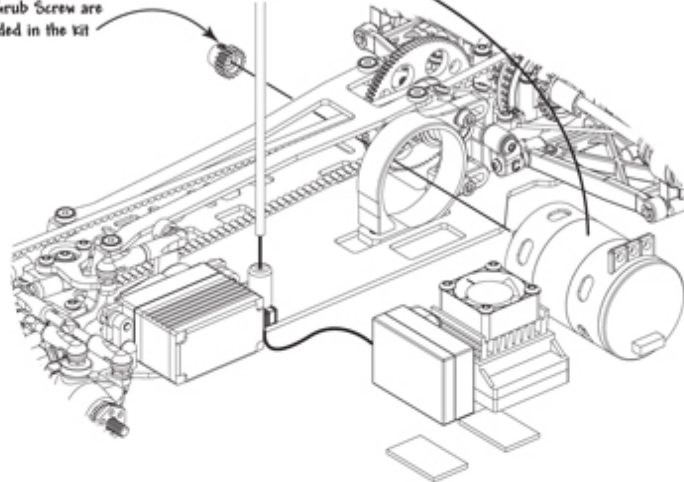

Drivetrain Option 1  
Motor Position With Spur and Pinion  
tooth sum of 104 or GREATER

Upto 14.00mm

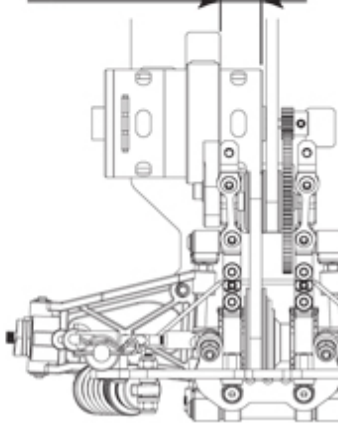

Drivetrain Option 1  
Motor Position With Spur and Pinion  
tooth sum of LESS than 104

Upto 7.00mm

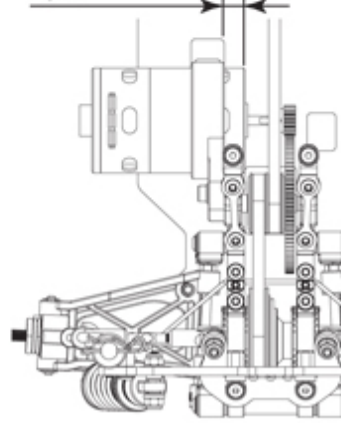

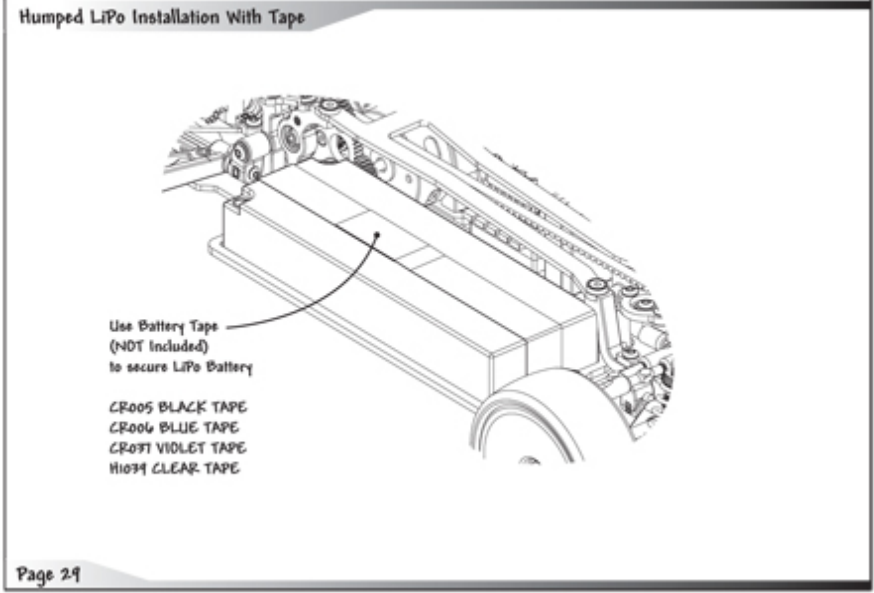
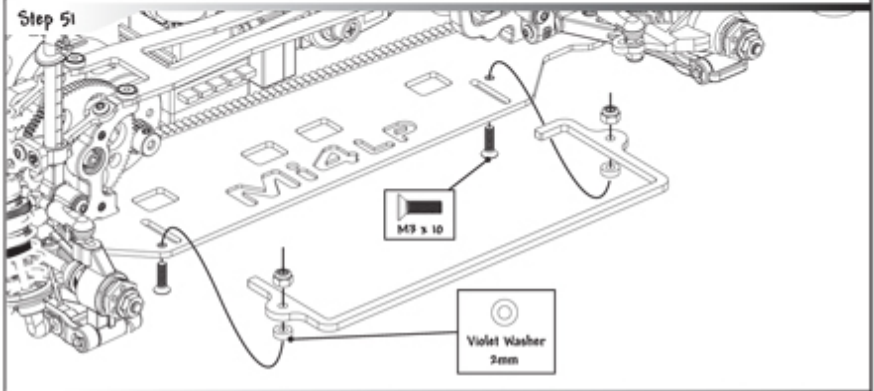
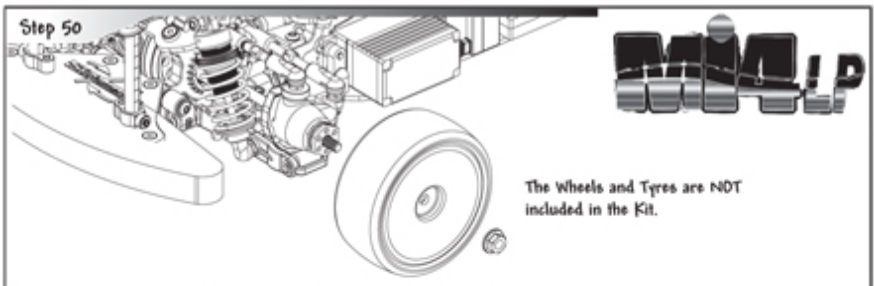

Flat Bottomed LiPo Installation With Tape and Locators

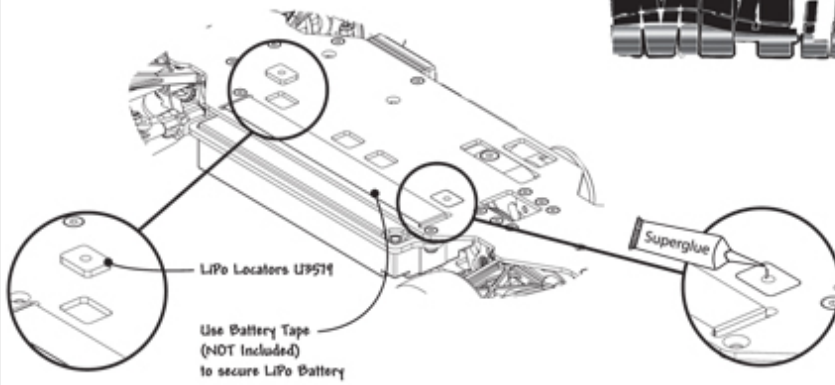

LiPo Tray Installation with Strap for LiPo's

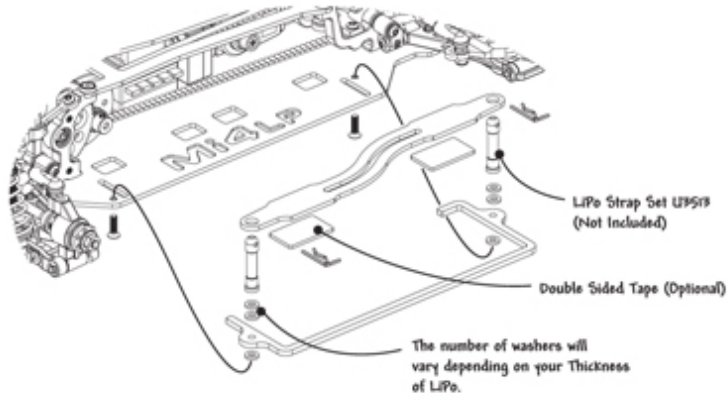

Optional One Way U3531 For Drivetrain Option 1 (see page 3)



Optional One Way U3531 For Drivetrain Option 1 (see page 3)

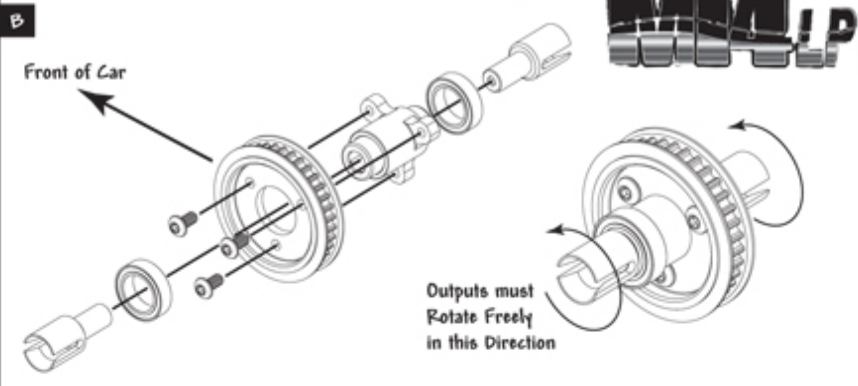

Optional One Way U3518 For Drivetrain Option 2 (see page 4)



Optional One Way U3518 For Drivetrain Option 2 (see page 4)

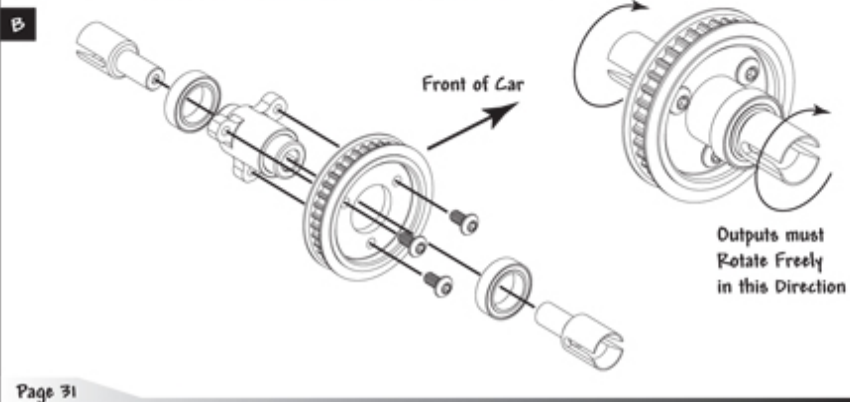



Optional Alloy Suspension Blocks U3517

A

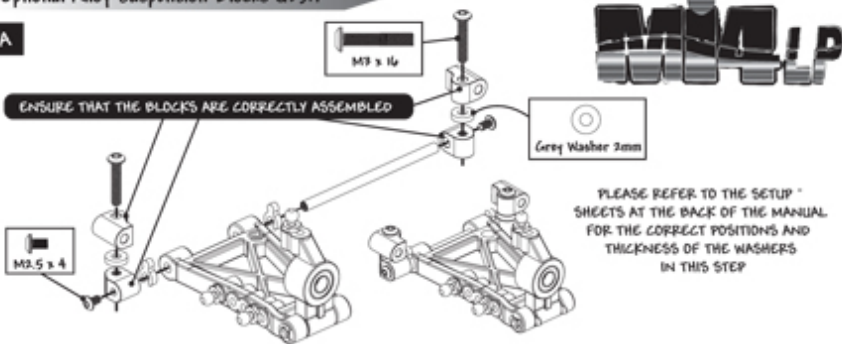

Optional Alloy Suspension Blocks U3517

B

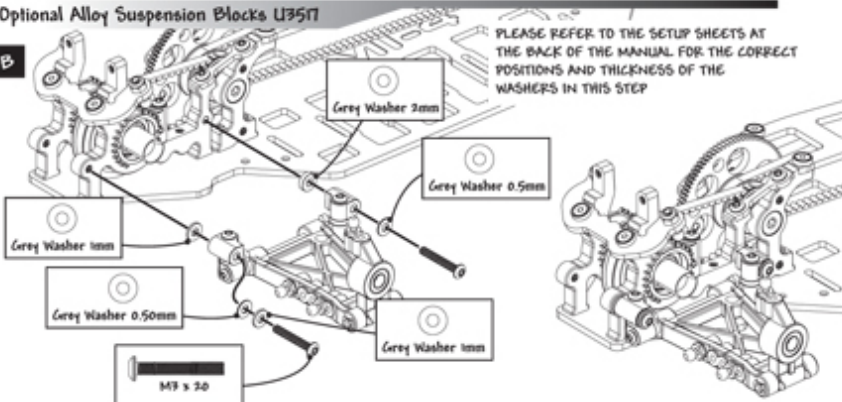

Optional Alloy Suspension Blocks U3517

C

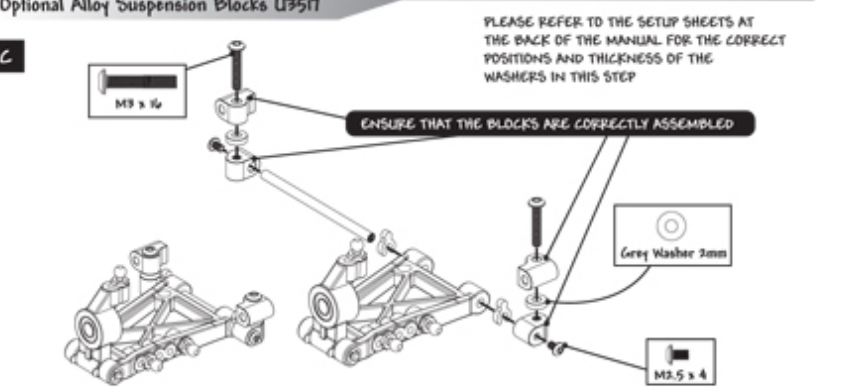

Optional Alloy Suspension Blocks U3517

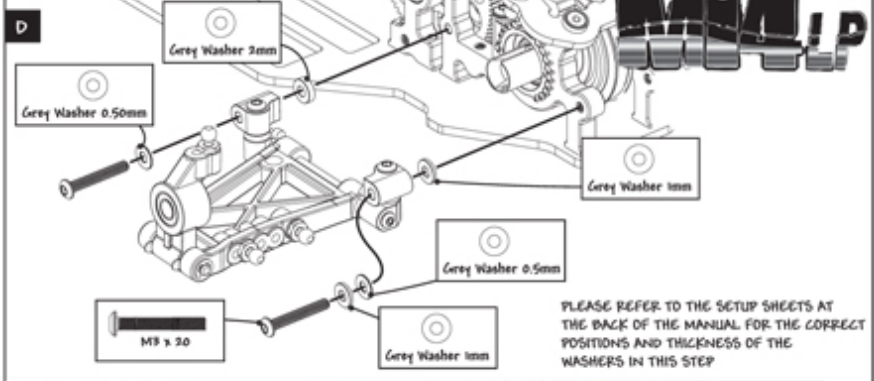

Optional Alloy Suspension Blocks U3517

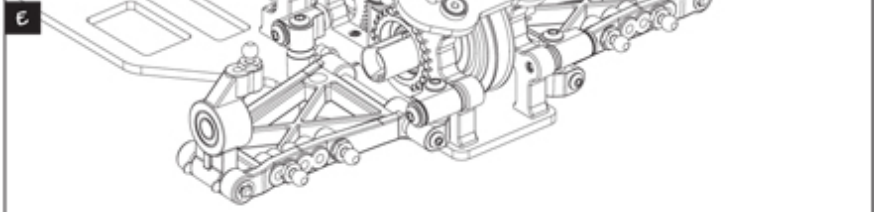

Optional Alloy Suspension Blocks U3517

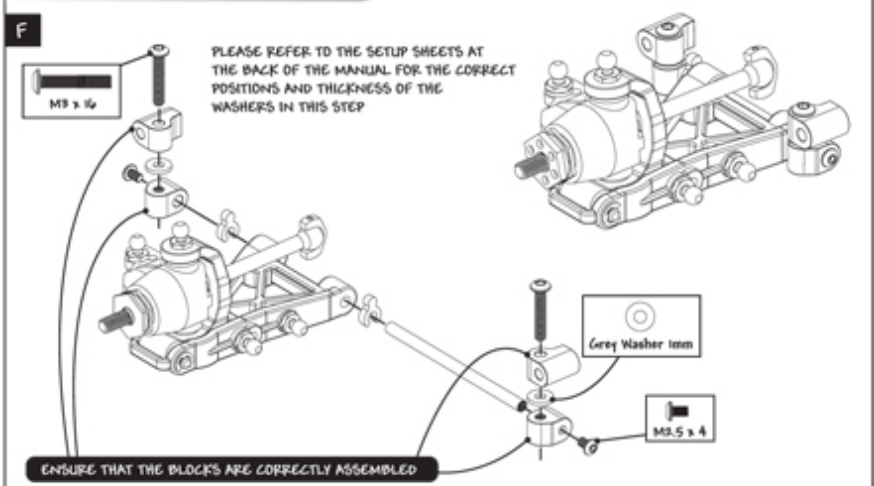

Optional Alloy Suspension Blocks U3517

G

PLEASE REFER TO THE SETUP SHEETS AT THE BACK OF THE MANUAL FOR THE CORRECT POSITIONS AND THICKNESS OF THE WASHERS IN THIS STEP

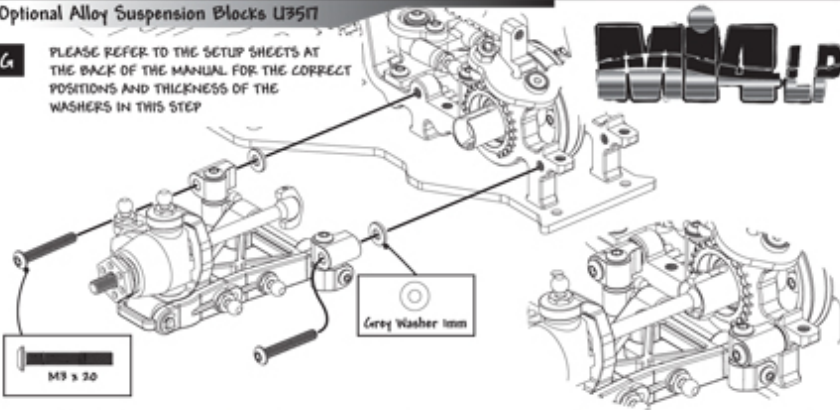

Optional Alloy Suspension Blocks U3517

H

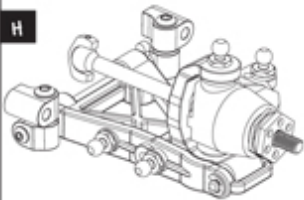

PLEASE REFER TO THE SETUP SHEETS AT THE BACK OF THE MANUAL FOR THE CORRECT POSITIONS AND THICKNESS OF THE WASHERS IN THIS STEP

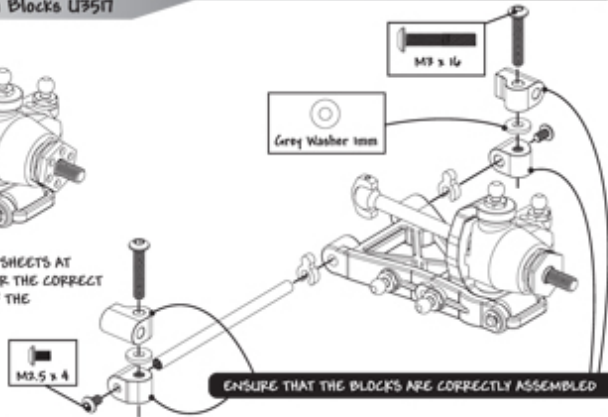

Optional Alloy Suspension Blocks U3517

I

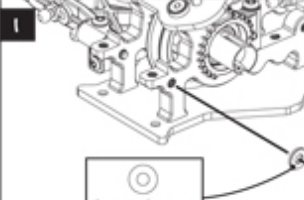

PLEASE REFER TO THE SETUP SHEETS AT THE BACK OF THE MANUAL FOR THE CORRECT POSITIONS AND THICKNESS OF THE WASHERS IN THIS STEP

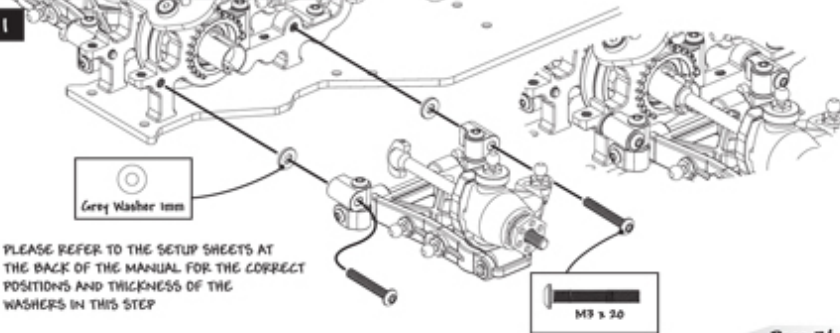

Car Balancing Jig U3582

**A** The Balancing Jig, with the aid of a pair of scales, is used to accurately and independently measure the corner weights of your car.

We use a Three point balancing system to eliminate any false readings caused by chassis tweak.

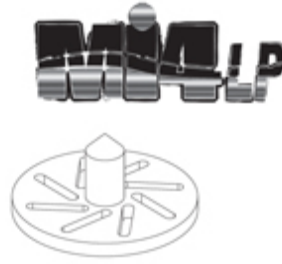

Car Balancing Jig U3582



Car Balancing Jig U3582

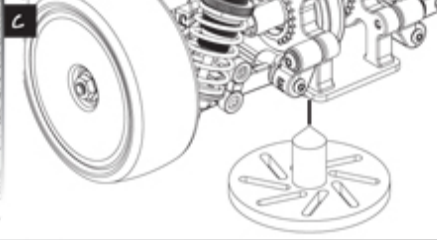

Car Balancing Jig U3582

**D**

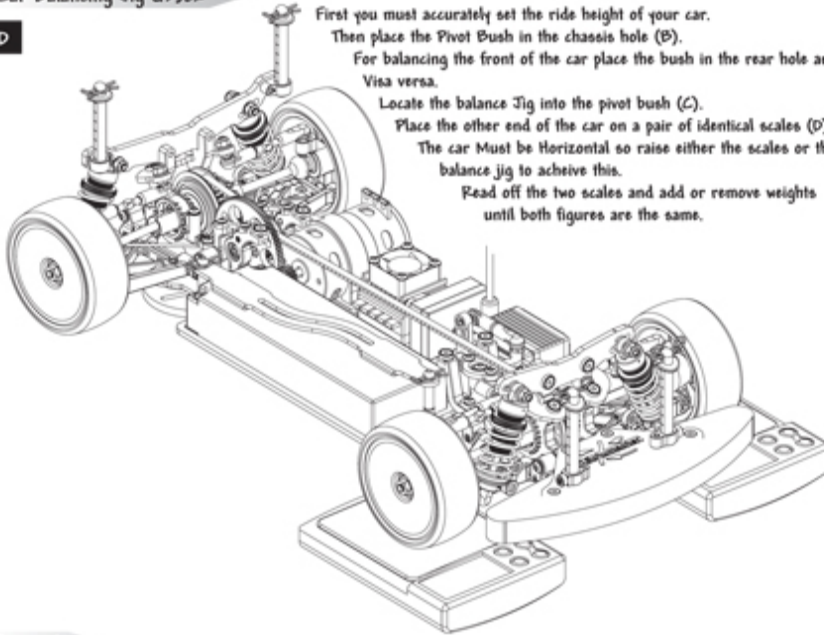

First you must accurately set the ride height of your car.  
Then place the Pivot Bush in the chassis hole (B).  
For balancing the front of the car place the bush in the rear hole and  
Visa versa.  
Locate the balance Jig into the pivot bush (C).  
Place the other end of the car on a pair of identical scales (D).  
The car Must be Horizontal so raise either the scales or the  
balance jig to acheive this.  
Read off the two scales and add or remove weights  
until both figures are the same.

## Track Settings

### Springs

The spring rate controls the suspension stiffness. Spring adjusters only change the ride height. They DO NOT alter the suspension stiffness. On slippery or bumpy tracks use soft to medium rate springs, on flat or high grip tracks run medium to hard rate springs.

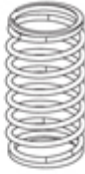

### Steering

By Adding and removing the washers under the ball joint, you alter the cars Ackerman and steering response. Adding washers will make the steering more aggressive, where less washers will make for a softer response.

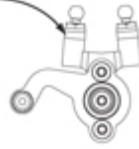

### Front Caster

The front caster can be altered by changing the yoke. The car comes with 4° caster as standard. Less caster will give a quicker steering response, but could lead to power on understeer. More caster will give the opposite, slightly slower turn in, but more power on steering.

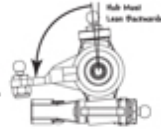

### Shock Brackets (Shock Mounting)

Vertical shock absorbers make the car react sharply to driver inputs.

A laydown shock offers a softer feel to the driver.



### Ride Height

In general always run the car as low as possible, without the chassis grounding out, as it rolls into corners.

A good starting point with rubber tyres is 5.5mm at the front and 6.0mm at the rear.

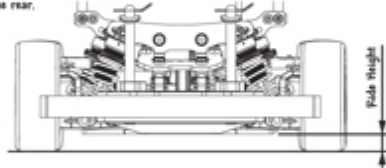

### Front and Rear Camber

With maximum negative camber the car will have high levels of grip, but there may be the possibility of sudden breakaway in corners. Reducing the camber gives a more progressive slide, but may give less grip.

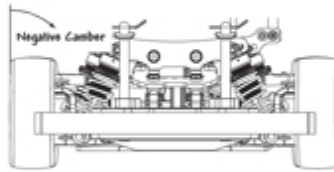

### Front Toe-in

The front toe-in is set by adjusting the steering trackrod turnbuckles.

Toe-in = A less than B  
Toe-out = A greater than B

Toe-in will give a more stable car, but will give less sharp turn in. Toe-out will give the opposite, less stability with sharper turn in to the corners.

We recommend to start at about 0° or 1° toe-out.

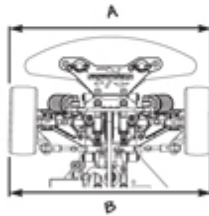

### Front and Rear Track Width

TRACK WIDTH ADJUSTMENT (in-board)

The track width of the car may be altered by adding or removing EQUAL thickness grey suspension washers between the Screw Blocks and the transmission housings. When changing the track width ensure the driveshafts are fully engaged in the Diff outputs. And the width does not exceed 190mm

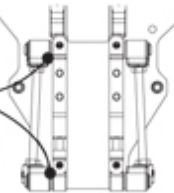

### Front and Rear Wheelbase

WHEELBASE ADJUSTMENT (in-board)

The wheelbase may be adjusted by moving the Quik clips to either the front or the back of the wishbones.

Shorter wheelbase results in a more agile car, but use longer wheelbase for a smoother less aggressive car. Also moving the wishbone forwards and backwards alters the weight distribution at either end of the car, this results in more or less traction, and more or less steering.

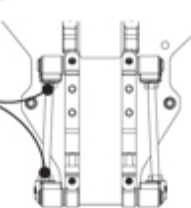

### Front and Rear Inboard Toe-in

USING OPTIONAL ALLOY PIVOT BLOCKS

More inboard toe in will improve straight ahead traction and car stability, but can reduce corner speed on fast sweepers.

The toe-in is set by adding or removing the grey suspension washers between the Screw blocks and the transmission housings, at the front or rear of the wishbones. Each 0.50mm washer will change the Toe in by Approx 0.16°

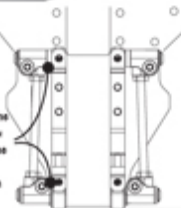

## Track Settings

### TRANS LINES



To improve the rear end grip of the car use **THINNER** trans links (more flex), but to reduce the rear end grip use **THICKER** trans links (less flex). This adjustment allows tuning the balance of the car on various tracks.



## Gear Chart 48dp

Maximum Tooth Sum = 128.....Minimum Tooth Sum = 91.....Internal Ratio = 1.8:1

14	15	16	17	18	19	20	21	22	23	24	25	26	27	28	29	30	31	32	33	34	35	36	37	38	39	40	41	42	43	44	45	46	47	48	49	50			
91	11.84	10.56	10.25	9.93	9.60	9.26	8.91	8.56	8.20	7.84	7.47	7.10	6.72	6.34	5.95	5.56	5.17	4.78	4.38	3.98	3.57	3.16	2.75	2.33	1.91	1.49	1.07	0.65	0.23	0.00	0.00	0.00	0.00	0.00	0.00	0.00	0.00	0.00	
92	11.84	10.44	9.94	9.41	8.87	8.33	7.78	7.23	6.67	6.11	5.54	4.97	4.39	3.81	3.23	2.64	2.05	1.46	0.87	0.28	0.00	0.00	0.00	0.00	0.00	0.00	0.00	0.00	0.00	0.00	0.00	0.00	0.00	0.00	0.00	0.00	0.00	0.00	0.00
93	10.49	10.30	9.94	9.50	9.05	8.59	8.12	7.64	7.15	6.65	6.14	5.62	5.09	4.55	4.00	3.44	2.87	2.29	1.71	1.12	0.53	0.00	0.00	0.00	0.00	0.00	0.00	0.00	0.00	0.00	0.00	0.00	0.00	0.00	0.00	0.00	0.00	0.00	0.00
70																																							
66																																							

## Gear Chart 44dp

Maximum Tooth Sum = 170.....Minimum Tooth Sum = 121.....Internal Ratio = 1.8:1

14	15	16	17	18	19	20	21	22	23	24	25	26	27	28	29	30	31	32	33	34	35	36	37	38	39	40	41	42	43	44	45	46	47	48	49	50			
121	11.88	10.60	10.11	9.61	9.09	8.56	8.02	7.47	6.91	6.34	5.76	5.17	4.57	3.96	3.34	2.71	2.07	1.42	0.76	0.00	0.00	0.00	0.00	0.00	0.00	0.00	0.00	0.00	0.00	0.00	0.00	0.00	0.00	0.00	0.00	0.00	0.00	0.00	
122	12.91	10.64	9.94	9.21	8.46	7.69	6.90	6.09	5.25	4.40	3.54	2.67	1.79	0.90	0.00	0.00	0.00	0.00	0.00	0.00	0.00	0.00	0.00	0.00	0.00	0.00	0.00	0.00	0.00	0.00	0.00	0.00	0.00	0.00	0.00	0.00	0.00	0.00	
124	10.80	10.34	9.77	9.19	8.59	7.97	7.34	6.69	6.03	5.36	4.67	3.97	3.26	2.54	1.81	1.07	0.32	0.00	0.00	0.00	0.00	0.00	0.00	0.00	0.00	0.00	0.00	0.00	0.00	0.00	0.00	0.00	0.00	0.00	0.00	0.00	0.00	0.00	
125	10.04	9.54	8.97	8.37	7.75	7.11	6.46	5.80	5.13	4.45	3.76	3.06	2.35	1.63	0.90	0.17	0.00	0.00	0.00	0.00	0.00	0.00	0.00	0.00	0.00	0.00	0.00	0.00	0.00	0.00	0.00	0.00	0.00	0.00	0.00	0.00	0.00	0.00	
75																																							
70																																							

## Front Inboard Pin Options

### USING OPTIONAL ALLOY PIVOT BLOCKS

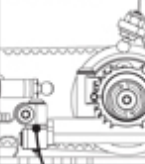

### ROLL CENTRE ADJUSTMENT

By adding or removing the Grey Suspension washers between the pivot blocks you are able to change the height of the roll centre. Generally a lower pin will give more grip, and a higher pin will reduce grip.

### KICK UP OR ANTI-DIVE

The best balance on the car is usually with a level wishbone pin, however a small amount of anti-dive can improve stability under braking.

By adding the Grey Suspension washer at the front of the wishbone you will get anti-dive. 0.5mm = 0.5°

By adding the Grey Suspension washer at the rear of the wishbone you will get kick-up. 0.5mm = 0.5°

## Rear Inboard Pin Options

### ROLL CENTRE ADJUSTMENT

By adding or removing the Grey Suspension washers between the pivot blocks you are able to change the height of the roll centre. Generally a lower pin will give more grip, and a higher pin will reduce grip.

### SQUAT OR ANTI-SQUAT

The best balance on the car is usually with a level wishbone pin, however a small amount of Anti Squat can improve on power traction.

By adding the Grey Suspension washer at the rear of the wishbone you will get Anti-Squat. 0.5mm Difference = 0.5°

By adding the Grey Suspension washer at the front of the wishbone you will get Pro-Squat. 0.5mm Difference = 0.5°

### USING OPTIONAL ALLOY PIVOT BLOCKS

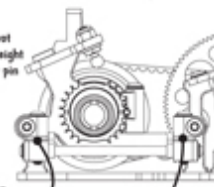

## Diff Height (High or Low)

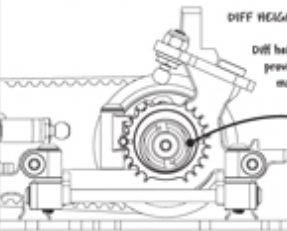

### DIFF HEIGHT

Diff height adjustment is provided so that the car may run level driveshafts at ride height with different diameter tyres.

## Front and Rear Suspension Link

### WIDTH ADJUSTMENT

The width of the inboard suspension link can be altered by Speed Secret link Brackets.

### HEIGHT ADJUSTMENT

The height of the inboard suspension link can be altered by adding or removing the violet spacer washers, between the link mount and the ball stud, or under the link mount bracket.

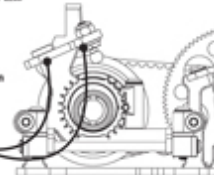

This adjustment alters the camber gain of the suspension, generally a lower ball stud (or shorter link) gives more instant cornering grip followed by a sudden breakaway whereas a higher ball (or longer link) gives smoother more progressive cornering grip.

THE NOSRAM AND GM PRODUCTS ARE AVAILABLE  
FROM SCHUMACHER IN THE UK ONLY.



**ELECTRIC - TOURING CARS**

K107 M14-LP Pro-CF - 1-10 Touring - KIT  
K109 M14-LP Pro-CF - 1-10 Touring - ASSEMBLED  
K108 M14-LP Race - S1 - 1-10 Touring - KIT  
K110 M14-LP Race - S1 - 1-10 Touring - ASSEMBLED

**CHASSIS PARTS**

U1042 Aerial Mount - Universal  
U119 Aerial Tube - Pack 4  
U2231 Servo Horns  
U2480 Body Posts & R Clips (pk 4)  
U3154 Foam Bumper - M14  
U3155 Front Bumper Mouldings - M14  
U3158 Alloy Body Post Mounts; Horizontal (pr)  
U3159 Alloy Body Post Mounts; Vertical (pr)  
U3486 CF Top Deck; 2.0 - M14 Kit  
U3487 CF Top Deck; 2.5 - M14  
U3488 CF Top Deck; 3.0 - M14  
U3513 CF LiPo Strap & Posts - M14  
U3514 CF LiPo Strap - M14  
U3521 CF Trans Link Tuning Set; 4pcs - M14  
U3562 Instruction Manual - M14-LP  
U3565 CF Chassis; 2.0 - M14-LP Kit Spec  
U3566 CF Chassis; 2.5 - M14-LP  
U3567 CF Chassis; 3.0 - M14-LP  
U3568 CF LiPo Retainer - M14-LP  
U3569 CF LiPo Battery Locator; Micro pk4  
U3571 Alloy Servo Mounts - M14-LP

**CHASSIS PARTS (RACE ONLY)**

U2154 Lite Body Post Set; 2 vert 2 horiz  
U2989 Ball Grippa Sockets - (pk 8)  
U3573 Chassis; S1 - M14-LP-Race  
U3574 LiPo Retainer S1 - M14-LP-Race  
U3575 Shock Bracket; Front S1 - M14-LP-Race  
U3576 Shock Bracket; Rear S1 - M14-LP-Race  
U3577 S1 Mounts; Strg & Upper Link - M14-LP-Race  
U3578 Top Deck; S1 - M14-LP-Race  
U3579 LiPo Locator S1 - M14-LP-Race

**SUSPENSION**

U1440 Pro Pin; grooved 1/8x25mm (pr)  
U2664 Steering Yoke Pivot Set - 2 pairs  
U2718 Pro Pin; Grooved 1/8x18mm (pr)  
U2736 Steering Yoke; 2 degree - M14 pr  
U2737 Steering Yoke; Kit Std 4 degree - M14 pr  
U2738 Steering Yoke; 6 degree - M14 pr  
U2750 Droop Screw; M5x8mm pk4  
U2882 Servo Saver Set; Light & Heavy Springs  
U2990 Front Hub Carrier - M14  
U2992 Rear Hub Carrier - M14  
U3127 Wishbones; Graphite Front - M14  
U3128 Wishbones; Graphite Rear - M14  
U3129 Alloy Block; Screw - M14 (pr)  
U3130 Alloy Block; Pivot - M14 (pr)  
U3137 Shock Mounting Post - M14 (pr)  
U3142 Pro Pivot Pin - 55mm - M14 (pr)  
U3156 Roll Bar Set; Front 1.2-1.4-1.6 - M14  
U3157 Roll Bar Set; Rear 1.2-1.4-1.6 - M14  
U3209 Tumbuckle Adjuster; Gold - 24mm (pr)  
U3210 Tumbuckle Adjuster; Gold - 35mm (pr)  
U3211 Tumbuckle Adjuster; Gold - 39mm (pr)  
U3212 Tumbuckle Adjuster; Gold - 45mm (pr)  
U3249 Wishbones; Med Flex Front - M14  
U3250 Wishbones; Medium Flex Rear - M14

U3251 Wishbones; Extra Flex Front - M14  
U3252 Wishbones; Extra Flex Rear - M14  
U3261 Ti Droop Screw - M14 pk4  
U3493 Alloy Steering Housing & Post - M14  
U3494 Suspension Pivot Blocks; set 8 - M14  
U3495 Ball Studs; Ultra Short - pk 4  
U3496 Ball Studs; Short - pk 4  
U3497 Ball Studs; Long - pk 4  
U3498 Ball Studs; X-Long - pk 4  
U3499 Roll Bar Blocks - M14 pk4  
U3500 Pro-Ball Socket; Black - pk 8  
U3501 CF Steering Arm & Mount - M14  
U3522 CF Shock Bracket; Front - M14  
U3523 CF Shock Bracket; Rear - M14  
U3526 CF Upper Link Mount; 45mm 1gr - M14  
U3527 CF Upper Link Mount; 42mm 2gr - M14  
U3528 CF Upper Link Mount; 39mm 3gr - M14  
U3530 Steering Yoke; Xtra Flex 4 degree (pr)  
U3549 Wishbones; Short Graphite Front - M14  
U3550 Wishbones; Short Graphite Rear - M14  
U3551 Wishbones; Short Med Flex Front - M14  
U3552 Wishbones; Short Med Flex Rear - M14  
U3748 Steering Yoke; Med Flex 4 degree (pr)

**SHOCK ABSORBERS**

U2993 Race Shock Body; Nickel Teflon (pr)  
U2994 Race Shock Collar; threaded adjuster (pr)  
U2995 Race Shock Piston - Trg 2 Hole (pr)  
U2996 Race Shock Piston - Trg 3 Hole (kit std) pr  
U2997 Race Shock Rod; Ti-Nitride - 30mm (pr)  
U2998 Race Shock Seal Housing; On Road (pr)  
U2999 Race Shock Seal Rebuild Pack (pr)  
U3001 Race Shocks; fully assembled pair  
U3284 Race Shock Top Cap (pr) - Black Unvented  
U613 Spring Stop & Spacer Mouldings (pr)

**SHOCK ABSORBERS (RACE ONLY)**

U1310 Shock Mouldings-Vari Click Piston (pr)  
U1557 Ultra-Short Shock Rod (pr)  
U1558 Purple Ultra-Short Shock Body (each)  
U1818 Purple Alloy Shock Seal Housing (pr)  
U2143 One Piece Shock Pistons - 4 sets of 3  
U835 Vari Shock Seal Pack (pr)

**SHOCK OIL**

G030 Pure Silicone Shock Oil - 30w  
G035 Pure Silicone Shock Oil - 35w  
G040 Pure Silicone Shock Oil - 40w  
G045 Pure Silicone Shock Oil - 45w  
G050 Pure Silicone Shock Oil - 50w  
G055 Pure Silicone Shock Oil - 55w  
G060 Pure Silicone Shock Oil - 60w  
G070 Pure Silicone Shock Oil - 70w  
G080 Pure Silicone Shock Oil - 80w  
G100 Pure Silicone Shock Oil - 100w



#### SPRINGS

U2822 Spring Tuning Set - Pro-Touring (6 prs)  
U2823 Pro-Touring Springs - White 14 lbs  
U2824 Pro-Touring Springs - Blue 16lbs  
U2825 Pro-Touring Springs - Green 18 lbs  
U2826 Pro-Touring Springs - Red 20 lbs  
U2827 Pro-Touring Springs - Yellow 23 lbs  
U2828 Pro-Touring Springs - Purple 27 lbs

#### TRANSMISSION

U1895 M3x8mm Button Screws & Washers pk4  
U1918 Spare Blades  
U2573 Pro-Diff Screw Set  
U2721 Rear Belt; Black Mod 60t x 3.6mm  
U2761 Diff Shims; 10 x 12  
U3011 Front Belt; 171t x 3.6mm  
U3012 Front Belt; Grey Stock 171t x 3.6mm  
U3013 Rear Belt; Grey Stock 60t x 3.6mm  
U3026 Pivot; Pin & Screw; Alloy CV D/Shaft  
U3123 Alloy Eccentric - M14 (pr)  
U3124 Diff Retaining Post - M14 (pr)  
U3126 CNC Pulley & Fences; 20T - M14LP  
U3138 Alloy Diff Output; Male - M14  
U3139 Alloy Diff Output; Female - M14  
U3140 Diff Washer; ProSpec - M14 (pr)  
U3141 HD Spool Output - M14  
U3160 85T 48DP CNC Spur Gear - M14LP  
U3161 87T 48DP CNC Spur Gear - M14LP  
U3162 89T 48DP CNC Spur Gear - M14LP  
U3163 114T 64DP CNC Spur Gear - M14LP  
U3165 118T 64dp CNC Spur Gear - M14LP  
U3170 Pins & Shims; Axle - M14 4pr  
U3247 70T 48DP CNC Spur Gear - M14LP  
U3248 96T 64dp CNC Spur Gear - M14LP  
U3260 Ti Shock Post - M14 pr  
U3269 90T 64DP CNC Spur Gear - M14LP  
U3270 106T 64DP CNC Spur Gear - M14LP  
U3275 Bone; 7075 Alloy Driveshaft - M14 1pc  
U3400 66T 48DP CNC Spur Gear - M14LP  
U3414 Pinion; Hard Alloy 48dp - 14T  
U3415 Pinion; Hard Alloy 48dp - 15T  
U3416 Pinion; Hard Alloy 48dp - 16T  
U3417 Pinion; Hard Alloy 48dp - 17T  
U3418 Pinion; Hard Alloy 48dp - 18T  
U3419 Pinion; Hard Alloy 48dp - 19T  
U3420 Pinion; Hard Alloy 48dp - 20T  
U3421 Pinion; Hard Alloy 48dp - 21T  
U3422 Pinion; Hard Alloy 48dp - 22T  
U3423 Pinion; Hard Alloy 48dp - 23T  
U3424 Pinion; Hard Alloy 48dp - 24T  
U3425 Pinion; Hard Alloy 48dp - 25T  
U3426 Pinion; Hard Alloy 48dp - 26T  
U3427 Pinion; Hard Alloy 48dp - 27T  
U3428 Pinion; Hard Alloy 48dp - 28T  
U3429 Pinion; Hard Alloy 48dp - 29T  
U3430 Pinion; Hard Alloy 48dp - 30T  
U3431 Pinion; Hard Alloy 48dp - 31T  
U3432 Pinion; Hard Alloy 48dp - 32T  
U3433 Pinion; Hard Alloy 48dp - 33T  
U3434 Pinion; Hard Alloy 48dp - 34T  
U3435 Pinion; Hard Alloy 48dp - 35T  
U3436 Pinion; Hard Alloy 48dp - 36T  
U3437 Pinion; Hard Alloy 48dp - 37T  
U3438 Pinion; Hard Alloy 48dp - 38T  
U3502 Alloy Diff Mount; Rear - M14  
U3504 Alloy Diff Mount; Front - M14  
U3505 Alloy Motor Clamp - M14  
U3507 Diff; Pro-Spec Assembly - M14LP  
U3508 CNC Diff Pulley & Fences; 36T - M14LP  
U3509 Spool; Complete Assembly - M14LP  
U3510 CNC Spool Pulley only - M14LP

U3511 Driveshaft HD - M14 pair  
U3518 One way Complete (Option 2 Transmission) - M14LP  
U3519 One way Pulley - M14LP  
U3531 One way Complete (Option 1 Transmission) - M14LP  
U3560 74T 48DP CNC Spur Gear M14LP  
U3563 Layshaft Set - M14-LP  
U3564 Alloy Layshaft Mount - M14LP

#### TRANSMISSION (RACE ONLY)

U2152 Wheel Hex; pin axle - SST (pk 4)  
U2693 Axle - CV Joint (pr)  
U2694 Cylinder; Screw & Pin - CV Joint (pr)  
U3580 Driveshaft Assy; Plastic - Blade Type - M14-LP Race pr  
U3581 Driveshaft Bone; Plastic with Blade - M14-LP Race pr

#### BEARINGS & BALLS

G200 ZX1 - Microlube  
H1031 Bearing Blaster Aerosol 500ml  
U1301 Silicone Diff Lube - Pot  
U1411 Ball Bearing - 4 x 8 x 3 Non Fl. (pr)  
U1439 Ball Bearing - 5 x 9 x 3 Non Fl. (pr)  
U1954 Pro - Thrust Bearing  
U1957 Moly Axle Grease - Pot  
U2148 Ball Bearing - 5 x 10 x 4 Shielded (pr)  
U2189 Wheel Bearings 8pcs 10x5x4 Shim Set  
U2459 Diff Balls; T/C 2.5mm pk12  
U2574 Ball Bearing - 5 x 9 x 2.5 (pr)  
U2862 Ceramic Bearing - 5x10x4 Shielded (pr)  
U3016 Ball Bearing - 10x15x4 (pr)  
U3017 Ceramic Bearing - 10x15x4 (pr)  
U3019 Ceramic Nitride Diff Balls 2.5mm (pk12)  
U3136 Ball Bearing - 5 x 8 x 2.5 (pr)  
U3386 Ceramic Bearing - 4x8x3 (pr)  
U3520 Ceramic Bearing set - M14

#### BEARINGS & BALLS (RACE ONLY)

U2542 Diff Balls; 2.5mm Chrome Steel (pk 12)  
U730 Thrust Bearing

#### SPEED PACKS

CR024 CORE RC - Serrated M4 Steel Wheel Nut pk4  
CR035 CORE RC - Serrated Alloy M4 Nuts; Blue pk 4  
CR036 CORE RC - Serrated Alloy M4 Nuts; Purple pk 4  
CR061 Small Body Clip 1/10 - Silver (8)  
CR062 Small Body Clip 1/10 - Gold (8)  
CR063 Small Body Clip 1/10 - Fluorescent Yellow (8)  
CR064 Small Body Clip 1/10 - Fluorescent Green (8)  
CR065 Small Body Clip 1/10 - Fluorescent Red (8)  
CR066 Small Body Clip 1/10 - Metallic Green (8)  
CR067 Small Body Clip 1/10 - Metallic Red (8)  
CR069 Small Body Clip 1/10 - Metallic Purple (8)  
CR071 Big Body Clip 1/10 - Silver (8)  
CR072 Big Body Clip 1/10 - Gold (8)  
CR073 Big Body Clip 1/10 - Fluorescent Yellow (8)  
CR074 Big Body Clip 1/10 - Fluorescent Green (8)  
CR075 Big Body Clip 1/10 - Fluorescent Red (8)  
CR076 Big Body Clip 1/10 - Metallic Green (8)  
CR077 Big Body Clip 1/10 - Metallic Red (8)  
CR078 Big Body Clip 1/10 - Metallic Blue (8)  
CR079 Big Body Clip 1/10 - Metallic Purple (8)  
CR081 Extra Long Body Clip 1/10 - Silver (6)  
CR082 Extra Long Body Clip 1/10 - Gold (6)  
CR083 Extra Long Body Clip 1/10 - Fluorescent Yellow (6)  
CR084 Extra Long Body Clip 1/10 - Fluorescent Green (6)  
CR085 Extra Long Body Clip 1/10 - Fluorescent Red (6)



SPEED PACKS

CR086 Extra Long Body Clip 1/10 - Metallic Green (6)  
 CR087 Extra Long Body Clip 1/10 - Metallic Red (6)  
 CR088 Extra Long Body Clip 1/10 - Metallic Blue (6)  
 CR089 Extra Long Body Clip 1/10 - Metallic Purple (6)  
 U1544 SPEED PACK - Short M3; Cap Hd  
 U1547 SPEED PACK - M3 Nuts  
 U1548 SPEED PACK - M3 Washers  
 U1550 SPEED PACK - Socket Wrenches (pk3)  
 U1551 SPEED PACK - E Clips 2x8pcs  
 U1552 SPEED PACK - R Clips  
 U1606 SPEED PACK - Servo Tape  
 U1633 SPEED PACK - Small Pins (pk)  
 U1960 SPEED PACK - O Rings; Various  
 U2128 SPEED PACK - Grub-Set Screws M3 M4  
 U2760 SPEED PACK - M3 Button Hd; 4 to 20  
 U2858 Alloy M3x6 Spacer Set; 0.5; 1.2; 3mm - 16pcs  
 U2988 M3 Csk Washers - Purple Alloy (pk10)  
 U3002 Wheel Spacer Washers (pk10)  
 U3021 SPEED PACK - M3x6 Csk Allen Hi-T  
 U3022 SPEED PACK - M3x8 Csk Allen Hi-T  
 U3023 SPEED PACK - M3x10 Csk Allen Hi-T  
 U3024 SPEED PACK - M3x12 Csk Allen Hi-T  
 U3131 Alloy Spacers M3x7mm 0.5; 1; 2mm (pk18)  
 U3168 SPEED PACK - M2.5 Screws pk 10  
 U3524 SPEED PACK-M4x8 Csk HI Tensile (4)  
 U3572 SPEED PACK - M3x14 Grub Srew pk4

SPEED PACKS (RACE ONLY)

U2184 SPEED PACK - DiscSprings+DrivePins

SPEED SECRET - OPTION PARTS

CR011 CORE Ti Screws - M3x8 Button Head pk4  
 CR013 CORE Ti Screws - M3x16 Button Head pk4  
 CR017 CORE Ti Screws - M3x12 Csk Head pk4  
 CR018 CORE Ti Ball Studs - Ultra Short pk4  
 CR019 CORE Ti Ball Studs - Short pk4  
 CR043 CORE RC - Silver X-Weights 16pcs  
 CR058 CORE RC - Black X-Weights 16pcs  
 CR110 Alloy Servo Arm; Futaba Purple  
 CR111 Alloy Servo Arm; KO/Sanwa Purple  
 CR112 Alloy Servo Arm; Futaba Blue  
 CR113 Alloy Servo Arm; KO/Sanwa Blue  
 H1026 Ride Height Gauge; Purple Alloy; 0-10mm  
 H1027 Droop Gauge Set; Purple Alloy - Touring  
 S5008 Schumacher BANNER 6x3ft  
 TNM24641 CVD Rebuild Kit; TIR - M4  
 TNM28643 CVD; TIR Rear - M4 pr  
 TNM28645 CVD; TIR Front - M4 pr  
 TNM3564 TIR Spool Kit; Std Bone - M4 pr  
 TNM35642 TIR Spool Kit; Stealth Bone - M4 pr  
 TNM3964 TIR Spool Outputs; Plastic pr  
 TNM3998 TIR Spool Sleeves pr  
 TNM8565F TIR Titanium Screw Set M4  
 U1572 Titanium Turnbuckle; purple - 39mm (pr)  
 U1576 Titanium Pivot Pin; purple - 25mm (pr)  
 U1905 Titanium Turnbuckle; purple - 35mm (pr)  
 U2053 Titanium Turnbuckle; purple - 25mm (pr)  
 U2075 Camber & Ride Height Gauges - C/C  
 U2096 Aerial Mount; Purple Chrome - Universal  
 U2100 Set Up Wheels; Camber&Toe In-SS  
 U2135 M4 Nyloc Wheel Nut - Purple Alloy (pk4)  
 U2187 M3 Nyloc Nut - Purple Alloy (pk8)  
 U2251 Kwik Klip; 1/8x1.0 & 2.0mm  
 U2298 Schumacher Pit Dude Car Stand  
 U2566 Titanium Turnbuckle - 45mm (pr)  
 U2719 Titanium Pivot Pin; purple - 18mm pr  
 U2741 Alloy Rear Hub Carriers; 1deg - M4  
 U2810 M4 Nyloc Wheel Nut - Red Alloy (pk4)  
 U2811 M4 Nyloc Wheel Nut - Blue Alloy (pk4)  
 U2812 M4 Nyloc Wheel Nut - Black Alloy (pk4)



U2813 M4 Nyloc Wheel Nut - Gold Alloy (pk4)  
 U2844 Hub & One Ways; (Option 2 Transmission) - M4LP  
 U2845 Output; Heavy Duty One Way - M12 1pc  
 U3132 Kwik Clips 0.25 & 0.5mm (pk8)  
 U3143 Titanium Pivot Pin Set - M4 (8pcs)  
 U3169 Titanium Pro Pivot Pin - 55mm (pr)  
 U3221 Alloy Wheel Hex; Slim Solid - M3 (pr)  
 U3514 CF Lipo Strap - M4  
 U3516 Ti Turnbuckle Set - M4 7pcs  
 U3517 Alloy Block Susp Half Set - M4  
 U3518 One Way; Complete (Option 2 Transmission) - M4LP  
 U3519 CNC One Way Pulley - M4LP  
 U3525 Alloy Wheel Hex - M4 (pr)  
 U3531 One Way; Complete (Option 1 Transmission) M4LP  
 U3532 Hub & One Ways; (Option 1 Transmission) M4LP  
 U3570 Alloy Wheel Hex; Slim+O ring - M4-LP (pr)  
 U3582 Precision Balance Pivot Set

TEAM CLOTHING

G331L T Blue - Large  
 G331M T Blue - Medium  
 G331S T Blue - Small Man  
 G331XL T Blue - X-Large  
 G331XXL T Blue - XX-Large  
 G333L Polo - Large  
 G333M Polo - Medium  
 G333S Polo - Small Man  
 G333XL Polo X Large  
 G333XXL Polo - XX-Large  
 G333XXX Polo - XXX-Large  
 G334 Cap - Black; Medium 58cm  
 G335 Cap - Black; Large 62cm  
 G336L Sweat - Large  
 G336M Sweat - Medium  
 G336S Sweat - Small  
 G336XL Sweat - X-Large  
 G336XXL Sweat - XX-Large

ELECTRONICS

CR116 CORE Servo; Low Profile 8.4Kg Ti Gears 2x88 0.11secs  
 CR117 Alloy Servo Arm; Futaba Black  
 CR118 Alloy Servo Arm; KO/Sanwa Black  
 GB37 Mini Temp Gun - 420F 230C  
 GB48 Tyne Warmers 1/10 Tig 7.2-12v  
 GM6458 Power Supply 5-15v 0-15Amp  
 GM6459 Power Supply 5-15v 0-20Amp  
 GM6460 Power Supply 12v 25 Amp  
 GM7952 Servo; Digital 806 MG-BB 0.08s 19.9Kg  
 GM7953 Servo; Digital 807 MG-BB 0.06s 15.3Kg  
 GM7954 Servo; Digital 808 MG-BB 0.04s 8.8Kg  
 GM91539.M Power Cap 470uF 16v Anti Glitch  
 GM94000 XG-6i 2.4G Sport Wheel Radio Tx-Rx  
 GM94001 XG-6i 2.4G Race Wheel Radio Tx-Rx  
 GM94010.10 XG-6i 2.4G Micro Rx  
 GM968.50 GM Wet Protect - Aerosol  
 NR97027 Cosmo 4 channel sports receiver 27 Mhz  
 NR97270 Gemini 3 channel receiver 27 Mhz  
 NR97400 Gemini 3 channel receiver 40 Mhz



#### CHARGERS

CR027 Power Supply;UDC 20 - 6A UK Plug UDC20  
CR028 Power Supply Cable;USA  
CR029 Power Supply Cable;Europe  
CR031 UDC Charger Connector Set  
CR056 Balance Charge Lead;JST to 2mm Male 7.4v  
CR114 UDC 30 Balance Adaptor Set JST-XH to JST-EH 2-6S  
CR135 Temperature Probe - UDC 30  
GB66 i-Charger 1068 - 10A Ch, 1A Dis All types  
GB67 P350 Power Supply; 23 Amps 15volt  
GM3075.GB25 BSI Conv Plug; EU2-UK3 2.5A  
GM6464 Ultramat 14 Mains/12v Charger  
NR91361 Gravity Stickpack Discharger  
NR93140 Power Supply 13.8V / 10A  
NR93150 Power Supply 13.8V / 14A  
GM6443 Ultra Duo Plus 40 Charge System  
GM6460 Power Supply 12v 25 Amp

#### SPEEDCONTROLS (BRUSHED MOTORS)

NR90830 Razor Evolution  
NR93000 Force Mini Reverse  
NR93010 Hawk Reverse  
NR93060 Hawk Power Reverse  
NR93250 Magnum Reverse  
NR93370 Magnum Power Reverse  
NR93471 International Power

#### BRUSHLESS MOTORS

GM97268.1 GM Rotor; 12.4mm EFRA Stock Spec  
GM97279 GM Pro 9T Delta Wind BL Motor  
GM97286 GM Pro 6T Delta Wind BL Motor  
GM97286.3 GM Sintered Rotor; 12.5mm  
GM97286.4 GM Sensor Lead 180mm  
GM97287 GM Pro 7T Delta Wind  
GM97288 GM Pro 8T Delta Wind BL Motor  
GM97290 GM Pro Stock 10.5T - Star Wind  
GM97294 GM Pro Stock 13.5T - Star Wind  
GM97296 GM Pro 6.5T - Star Wind  
NR90250 Storm Evo. Micro 370 BL Modified  
NR90510 Dragon BL Sport Modified 9.5T  
NR90520 Dragon BL Sport Modified 10.5T  
NR90530 Dragon BL Sport Modified 13.5T  
NR90540 Dragon BL Sport Modified 15.5T  
NR90647 PURE Evolution BL - 9.5t  
NR90652 PURE Evolution BL - 8.5t  
NR90662 PURE Evolution BL - 7.5t  
NR90672 PURE Evolution BL - 6.5t  
NR90682 PURE Evolution BL - 5.5t  
NR90687 PURE Evolution BL - 5.0t  
NR90692 PURE Evolution BL - 4.5t  
NR90702 PURE Evolution BL - 4.0t  
NR90712 PURE Evolution BL - 3.5t  
NR90722 PURE Evolution BL - 3.0t  
NR91831 PURE Evo StockSpec 10.5t  
NR91841 PURE Evo StockSpec 13.5t  
SP13810SV3 Speed Passion V3.0 Comp BL Motor; 10.5T  
SP13813SV3 Speed Passion V3.0 Comp BL Motor; 13.5T  
SP13817SV3 Speed Passion V3.0 Comp BL Motor; 17.5T  
SP13825 Speed Passion CV2.0 Comp BL Motor; 2.5T  
SP13835 Speed Passion CV2.0 Comp BL Motor; 3.5T  
SP13835V3 Speed Passion V3.0 Comp BL Motor; 3.5T  
SP13840V3 Speed Passion V3.0 Comp BL Motor; 4.0T

SP13845V3 Speed Passion V3.0 Comp BL Motor; 4.5T  
SP13855V3 Speed Passion V3.0 Comp BL Motor; 5.5T  
SP13865V3 Speed Passion V3.0 Comp BL Motor; 6.5T  
SP13875V3 Speed Passion V3.0 Comp BL Motor; 7.5T  
SP13885V3 Speed Passion V3.0 Comp BL Motor; 8.5T

#### BRUSHLESS ACCESSORIES

CR133 Core Sensor Lead; 80mm  
CR134 Core Sensor Lead; 180mm  
GM2894.15 GM Lead; Genius ESC to Rtx  
GM2894.4 GM Sensor Lead; 10cm  
GM2894.8 GM Sensor Lead; 20cm  
GM2894GM Fan 30x30mm  
GM7168.6 GM Genius USB Programming Set  
NR90607 Storm BL - Ceramic Ball Bearing R2  
NR90608 Storm BL - Ceramic Ball Bearing R166  
NR90610 Storm BL - Comp Sintered Rotor  
NR90611 Storm BL - Sintered Rotor 12.5mm  
NR90612 Storm BL - Sintered Rotor 13mm  
NR90613 Storm BL - Sintered Rotor 12.3mm  
NR90616 Storm Evo Xtreme cooling frontcover  
NR90617 Storm Evo Xtreme cool fr cover, thin  
NR90618 Storm Evo Xtreme cooling backplate  
NR90619 Storm Evo BL Small parts set  
NR90630 PURE MR104 ABCEC BB (pr)  
NR90631 PURE MR104 Ceramic BB (pr)  
NR90632 PURE Small Parts Set  
NR90633 PURE Sensor Assembly  
NR90634 PURE Aluminium Front Housing  
NR90635 PURE Evo Light Alloy Front Hsg  
NR90636 PURE Evo Alloy End Cover  
NR90640 PURE Sintered Rotor - 12.0mm  
NR90641 PURE Sintered Rotor - 12.5mm  
NR90642 PURE Sintered Rotor - 13.0mm  
NR92505 Powerwire Set Matrix  
NR92506 Matrix Evo 3.3mm Powerwire Set  
NR92510 Sensorwire for BL 200mm - std.  
NR92511 Cooling Fan; Low Profile  
NR92520 Sensorwire for BL 100mm - short  
NR925307 NOSRAM Sensor Wire HighFlex 70mm  
NR925310 NOSRAM Sensor Wire HighFlex 100mm  
NR925315 NOSRAM Sensor Wire HighFlex 150mm  
NR925320 NOSRAM Sensor Wire HighFlex 200mm  
NR92590 Xtreme Cooling Fan  
NR92600 Brushless Ultimate Accessory Kit  
NR92820 Ultimate Accessory Set  
NR92825 Replacement Wire Set Razor  
NR93830 Razor Evo Ultimate Accessory Set  
SP13835ER1 SP Rotor 3.5T; Euro R Hi Power 12.5mm  
SP13835ER2 SP Rotor 3.5T; Euro 5 Hi Speed & Runtime 12mm  
SP13845ER1 SP Rotor 4.5T; Euro RS Power Band 13mm  
SP162801 SP - Sensor Cable 180mm  
SP162802 SP - Sensor Cable 90mm  
SP162810 SP - HiPower Connector; 3pcs set  
SP162820 SP - HiPower Connector; 3pcs set  
SP1EB01 SP Endbell; Fixed Timing V3.0



#### BRUSHLESS ACCESSORIES

SPAMSSC1.5M SP - Super Capacitor 1.5 Farads 7.4 Volt rated  
SPAMSSC3M SP - Super Capacitor 3 Farads 6 Volt rated  
SPBA01 SP Brushless Analyser - ESC & Motors  
SPCBB183238 SP - Ceramic Motor Bearing  
SPLIPOAS01 SP - Connector; 7.2v Female - Golden Batteries  
SPRA13835 SP Rotor 3.5T; Standard 13.5mm  
SPRA13845 SP Rotor 4.5T; Standard 12.5mm  
SPRB13835 SP Rotor 3.5T; Hi RPM 13mm  
SPRB13845 SP Rotor 4.5T; Hi RPM 12mm

#### BRUSHLESS ESC & MOTOR COMBO

NR90581 BL Combo Evil/Dragon 15.5T  
NR90582 BL Combo Evil/Dragon 13.5T  
NR90583 BL Combo Evil/Dragon 10.5T  
NR90584 BL Combo Evil/Dragon 9.5T  
NR90760 BL Combo Matrix Power + PURE 8.5  
NR90761 BL Combo Matrix Power + PURE 7.5  
NR90762 BL Combo Matrix Power + PURE 6.5  
NR90763 BL Combo Matrix Power + PURE 5.5  
NR90764 BL Combo Matrix Power + PURE 4.5  
NR90765 BL Combo Matrix Power + PURE 4.0  
NR90766 BL Combo Matrix Power + PURE 3.5  
NR90767 BL Combo Matrix Power + PURE 3.0  
NR90768 BL Combo Matrix Power + PURE 5.0  
NR90779 BL Combo PEARL Evo + PURE 9.5T  
NR90783 BL Combo Matrix Evo/Storm 10.5T  
NR90784 BL Combo Matrix Evo/Storm 9.5T  
SPCOM105 SP Combo - Pro-Stock 10.5T + LFF ESC  
SPCOM135 SP Combo - Stock 13.5T + LFF ESC  
SPCOM65 SP Combo - Modified 6.5T + LFF ESC

#### BRUSHLESS SPEEDCONTROLS

GM7164 GM Genius 90 BL ESC 90 Amp  
GM7168 GM Genius 120 BL ESC 120 Amp  
NR90100 Matrix Brushless Reverse  
NR90150 Matrix Power Brushless Reverse  
NR90400 Evil Brushless Reverse  
NR90450 Evil Brushless Power Reverse  
NR90710 Matrix Evolution Spec/Racing BL  
NR90900 PEARL Evolution BL Speedo  
NR90950 PEARL Evolution ISTC BL Speedo  
SPEX138802 SP Exige 2 ESC - 4600KV 7.5T 7.4v Limit  
SPEXT98802B Speed Passion GT V2.0 ESC - Blue  
SPEXT98802LPB Speed Passion LFF V2.0 ESC - Blue  
SPEXT98802LFF Speed Passion LFF V2.0 ESC - Carbon Look  
SPEXT98802LPS Speed Passion LFF V2.0 ESC - Silver  
SPEXT98802PRO Speed Passion GT V2.0 ESC - Carbon Look  
SPEXT98802S Speed Passion GT V2.0 ESC - Silver

#### BATTERIES

CR004 CORE RC - 5000mAh 7.4v LiPo  
CR034 CORE RC - 3250mAh 7.4v LiPo  
CR119 Heatsink 1.5mm dia Black - 20pcs  
CR120 Heatsink 2.0mm dia Black - 20pcs  
CR121 Heatsink 3.0mm dia Black - 20pcs  
CR122 Heatsink 4.0mm dia Black - 20pcs  
CR123 Heatsink 5.0mm dia Black - 20pcs  
CR124 Heatsink 6.0mm dia Black - 20pcs  
CR125 Heatsink 6.0mm dia Red - 20pcs  
CR126 Heatsink 6.0mm dia Blue - 20pcs  
CR127 Heatsink 8.0mm dia Black - 12pcs  
CR128 Heatsink 10.0mm dia Black - 12pcs  
CR129 Heatsink 12.0mm dia Black - 12pcs  
CR130 Heatsink 15.0mm dia Black - 12pcs

GM98987 LiPo V-MAXX 35C 5000/7.4V Stick 175 Amp Cont  
GM98988 LiPo V-MAXX 35C 4200/7.4V Saddle  
GM98994 LiPo V-MAXX 30C 4200/7.4V Saddle  
NR9500 LiPo RX Regulator 6V / 5A  
NR95010 Heavy Duty BEC 6V/10A LiPo RX Regulator  
NR95805 NOSRAM LiPo Hardcase balancing adapter  
NR95810 NOSRAM VTEC silver battery bars  
NR99100 Sport Pack 1600  
NR99102 Sport Pack 1800  
NR99105 Sport Pack 2200  
NR99110 Power Pack 3000 NiMH  
NR99113 Power Pack 3300 NiMH  
NR99116 Power Pack 3600 NiMH  
NR99118 Power Pack 4000 NiMH  
NR99120 Power Pack 4200 NiMH  
NR99124 Power Pack 4600 NiMH  
NR99130 VTEC AAA-1000UC Micro NiMH  
NR99140 Micro RX-Pack 700mAh - Hump  
NR99150 Micro RX-Pack 1100mAh - Hump  
NR99155 Micro RX-Pack 1100mAh - Straight  
NR99161 P-Max VTEC 1600 RX-Pack Hump  
NR99166 P-Max VTEC 1600 RX-Pack Straight  
NR99170 VTEC AA-2700UC Mignon NiMH  
NR99610 VTEC P-max 1600 micro paxx hump 7.2V Race  
NR99630 VTEC P-max 1600 micro paxx stick 7.2V Race  
NR99903 VTEC LiPo 351P 480 - 11.1V / 25C  
NR99913 VTEC LiPo 351P 850 - 11.1V / 25C  
NR99933 VTEC LiPo 351P 1600 - 11.1V / 25C  
NR99962 VTEC LiPo 251P 1800 - 7.4V / 25C  
NR99963 LiPo 1800 X-treme Race 7.4V 28C - Hard Case  
NR99968 VTEC LiPo 252P 5300 - 7.4V / 25C  
NR99969 VTEC LiPo 5300 Xtreme Race - 7.4V / 28C - Hard Case  
NR99971 NOSRAM LiPo 5300 X-treme Hardcase - 40C - 7.4V BRCA EFRA  
NR99972 VTEC LiPo Rx - Pack AAA-Hump - 7.4V  
NR99973 VTEC LiPo Rx - Pack 2/3 A straight 2200 - 7.4V  
NR99974 VTEC LiPo Rx - Pack 2/3 A hump 2300 - 7.4V  
NR99980 VTEC LiPo 252P 8000 - 7.4V / 25C  
NR99981 VTEC LiPo Tx-Pack Futaba/Sanwa 3000 11.1V  
NR99984 VTEC LiPo Tx-Pack KO 2700 11.1V  
SLR38035 SP LiPo Hardcase - 3800mAh 7.4v 30C  
SLR4025H SP LiPo Hardcase - 4000mAh 7.4v 25C  
SLR423HS SP LiPo Saddle Pack - 4200mAh 7.4v 30C  
SLR5303H SP LiPo Hardcase - 5300mAh 7.4v 30C

#### ACCESSORIES

CR001 CORE RC Motor & Battery Case  
CR005 CORE RC Battery Tape - Black  
CR006 CORE RC Battery Tape - Blue  
CR007 CORE RC Silicone Wire 12g - Red/Black 2x50cm  
CR008 CORE RC RED Connector with 2x4mm Tubes  
CR009 CORE RC RED Connector with 2x4mm Males  
CR033 CORE RC - Safe Charge Pouch 18x22cm  
CR037 CORE RC - Battery Tape - Purple  
CR050 CORE RC Silicone Wire 12g - Red 1 Metre  
CR051 CORE RC Silicone Wire 12g - Black 1 Metre  
CR052 CORE RC Silicone Wire 12g - Blue 1 Metre  
CR053 CORE RC Silicone Wire 12g - Red 50 Metre Reel  
CR054 CORE RC Silicone Wire 12g - Black 50 Metre Reel



#### ACCESSORIES

CR055 CORE RC Silicone Wire 12g - Blue 50 Metre Reel  
CR059 CORE RC - Safe Charge Pouch 23x30cm  
CR115 CORE RC Silicone Wire 12g - Red/Black/Blue 3x50cm  
G794 Battery Bars - pk5  
G795 Female Connector Tubes (pk 10)  
G796 Male Connector Plugs (pk 2)  
GM8375 Battery Warmer Pads 40degC 1.2v 3Amp  
H1039 Battery Tape - Natural 50m x 17mm  
H1046 T Connector; Red 2 Way - Male & Female  
H1047 T Connector; Black 2 Way - Male & Female  
H1048 T Connector; Red Sockets - pk4  
H1049 T Connector; Black Sockets - pk4  
H1054 Polarised Plug+Socket; 3.5mm - Pair  
SEL3000B SP Lipo Extension Balancer

#### TOOLS

AT1142 ATS Set Up Gauges - 1/10th Touring  
CR044 CORE RC - Curved Body Scissors  
CR045 CORE RC - Straight Body Scissors  
CR100 Shock Shaft Pliers - Purple  
CR101 Shock Shaft Pliers - Black  
CR102 Magnetic Parts Tray - Purple  
CR103 Magnetic Parts Tray - Black  
ED190024 Arm Reamer 3.175 (1/8) x 120mm  
H1032 Alloy Camber Gauge - 1/10th  
H1055 GTR5 Lube & Clean Aerosol 400ml  
NR95120 Ultimate Cleaner Spray  
NR95280 Ultimate Activator  
NR96221 Ultimate Glue  
U2789 Schumacher Hex Driver - 1.5mm  
U2790 Schumacher Hex Driver - 2.0mm  
U2791 Schumacher Hex Driver - 2.5mm  
U2792 Schumacher Hex Driver - 3.0mm  
U2795 Schumacher M3 Nut Driver  
U2796 Schumacher M4 Nut Driver  
U2818 Schumacher Body Reamer

#### 1/10 TOURING WHEELS

NR95070 VTEC Truepin Rim 24m  
NR95075 NOSRAM VTEC Wheelsticker Racing 10 spoke  
NR95076 NOSRAM VTEC Wheelsticker Multi spoke  
U2500 Rev-Lite; 24mm - White (Pk4)  
U2501 Rev-Lite; 24mm InchUp - White (Pk4)  
U2777 Rev-Lite; Flex 24mm - White (Pk4)  
U2799 Rev-Lite Stiff; 24mm - White (Pk4)

#### 1/10 TOURING TYRES & INSERTS

NR95031 VTEC CPX, Pre-Glued Carpet (4 pcs.)  
NR95032 VTEC 27X, Pre-Glued Asphalt (4 pcs.)  
NR95034 VTEC 30X, Pre-Glued Asphalt (4 pcs.)  
NR95035 VTEC 33X, Pre-Glued Asphalt (4 pcs.)  
NR95055 VTEC Rain Dunlop D20 Radial D20  
NR96010 Traction additive carpet  
NR96020 Traction additive asphalt  
U6623 SST Mini Pins 24/25 - Blue (pr)  
U6624 SST Mini Pins 24/25 - Yellow (pr)  
U6626 SST Foam Tyre Insert - 24/25 Soft (pr)  
U6627 SST Foam Tyre Insert - 24/25 Hard (pr)  
U6628 SST Foam Tyre Insert - 24/25 Comp (pr)  
U6629 SST Rally 24/25 - Yellow (pr)  
U6630 SST Rally 24/25 - White (pr)  
U6634 SST Foam Tyre Insert - 20 Soft (pr)  
U6635 SST Foam Tyre Insert - 20 Hard (pr)  
U6670 SST Mini Pins 20 - Blue (pr)  
U6671 SST Mini Pins 20 - Yellow (pr)  
U6672 SST Belted Slick 25 - White (pr)  
U6690 SST Carpet Dragon 24/25mm (pr)  
U6695 Moulded LP Insert Orange X-Soft (pr)  
U6696 SST Moulded LP Insert Green Med (pr)  
U6699 SST LP24 Foam Insert Med Blk (pr)

U6700 SST LP24 Foam Insert Soft Gy (pr)  
U6714 Moulded CP Insert Aqua - Soft (pr)  
U6716 SST Mini Pins 24/25 - Green (pr)  
U6717 SST Mini Pins 20 - Green (pr)

#### SOREX - TOURING CAR TYRES

XCO-20R Sorex Competition Tyre - 20R  
XCO-24R Sorex Competition Tyre - 24R  
XCO-28R Sorex Competition Tyre - 28R  
XCO-32R Sorex Competition Tyre - 32R  
XCO-36R Sorex Competition Tyre - 36R  
XCO-40R Sorex Competition Tyre - 40R  
XG-24BM Sorex Glued 24R+Med B+RevLite24 pk4  
XG-28BM Sorex Glued 28R+Med B+RevLite24 pk4  
XG-28JB Sorex Glued 28R+JB+RevLite24 pk4  
XG-32BM Sorex Glued 32R+Med B+RevLite24 pk4  
XG-32CM Sorex Glued 32R+Med C+RevLite24 pk4 BRCA  
XG-36BM Sorex Glued 36R+Med B+RevLite24 pk4  
XG-36CM Sorex Glued 36R+Med C+RevLite24 pk4  
XG-36EU Sorex Glued 36R+Med; Euro 2008 pk4  
XG-WET Shimizu D01J Wet Pre-Glued; Euro 2008 pk4  
XMA-24F Sorex Moulded Insert - A Firm pr  
XMA-24M Sorex Moulded Insert - A Med pr  
XMB-24F Sorex Moulded Insert - B Firm pr  
XMB-24M Sorex Moulded Insert - B Med pr  
XMC-24M Sorex Moulded Insert - C Med pr

#### NOSRAM VTEC FOAMS

NR95012 VTEC Foam Tires 1/10 26mm front 35"  
NR95013 VTEC Foam Tires 1/10 26mm front 37"  
NR95014 VTEC Foam Tires 1/10 26mm front 40"  
NR95015 VTEC Foam Tires 1/10 26mm front 42"  
NR95016 VTEC Foam Tires 1/10 26mm front 45"  
NR95022 VTEC Foam Tires 1/10 30mm rear 35"  
NR95023 VTEC Foam Tires 1/10 30mm rear 37"  
NR95024 VTEC Foam Tires 1/10 30mm rear 40"  
NR95025 VTEC Foam Tires 1/10 30mm rear 42"  
NR95026 VTEC Foam Tires 1/10 30mm rear 45"

#### BODYSHELLS & DECALS

EC13810B5I East Coast Rear Body Supports  
EC13810W1A East Coast Side Body Supports  
EC13810W1B East Coast Body Stiffeners Spcs  
EC16283121 East Coast - Body; iS250 190mm  
EC16283122 East Coast - Body; Euro-R 190mm  
EC16283123 East Coast - Body; 320si 190mm  
EC16283126 East Coast - Body; Speed 6 190mm  
EC16283129 East Coast - Body; Evo9x 190mm  
EC16283212 East Coast - Body; Euro-R 200mm  
EC162832D6 East Coast - Body; 350Z 190mm  
EC162832D8 East Coast - Body; RX7 190mm  
EC162832D9 East Coast - Body; S15 190mm  
EC168M609 East Coast Body; 2009 M-Speed 6 - 190mm  
EC168M609L ECLight Body; 2009 M-Speed 6 - 190mm  
EC388268 East Coast - Half Paint; Blue; Speed 6 190mm  
EC388268R East Coast - Half Paint; Red; Speed 6 190mm  
U3478 Decal Sheet - Schumacher & Racing-Cars.Com (pk3)  
U3561 Decal Sheet - M4-LP (pk3)

# CORE-RC .COM



Following on from the hugely successful UDC20 this is a rapid charger with high performance microprocessor and specialized operating software for multifunctional operation.

Operating voltage range: DC 11v - 18v  
 AC to DC adaptor (DC 11v-18v/5A)  
 Circuit Power: Max charge power 50W  
 Charge current range: 0.1-5A  
 Discharge current range: 0.1-1A  
 Current drain for balancing Li-po: 300mAh/cell  
 NiCad/NiMH battery cell count: 1-15cells  
 Li-ion/Polymer cell count: 1-4 series  
 PD battery voltage: 2v-20v  
 Weight: 245g  
 Dimensions: 133.2x80.1x39mm  
 Lead Acid: 2v - 20v

- Internal Independent Lithium Battery Balancer
- Balancing individual cells battery discharging
- Adaptable to various types of lithium battery
- The UDC30 is adaptable to various types of Lithium batteries, including LiPo, Li-ion and the new LiFe battery.
- Fast and Storage mode of lithium battery
- Large range of safety features to prevent overcharge of battery.
- Huge range of leads included.
- Cool blue backlit display.
- Separate 240/12v Power supply available (CR105)

CR104  
 UDC30 Universal  
 Balance Charger

CR105  
 Power Supply  
 UDC 30 - UK Plug



CR005 - Battery Strapping Tape - Black  
 CR006 - Battery Strapping Tape - Blue  
 CR007 - Battery Strapping Tape - Purple



CR089 - Core Safe Charge Pouch Small 18x37cm  
 CR091 - Core Safe Charge Pouch Large 23x30cm



CR007 - CORE RC Sili Wire 12g Red/Blk  
 CR050 - CORE RC Sili Wire 12g-1m Red  
 CR051 - CORE RC Sili Wire 12g-1m Black  
 CR052 - CORE RC Sili Wire 12g-1m Blue



CR100 - Shock Shaft Pliers - Purple  
 CR101 - Shock Shaft Pliers - Black



Core Servo:  
 Low Profile 8.4kg  
 Titanium Metal Gear  
 2 x Ball Bearings  
 0.11secs/10deg at 4.0v  
 Great servo for competition touring cars.  
 Weighs only 75 grams.

CR116 - CORE Servo Low Pro Digital



CR102 - Magnetic Parts Tray - Purple  
 CR103 - Magnetic Parts Tray - Black