

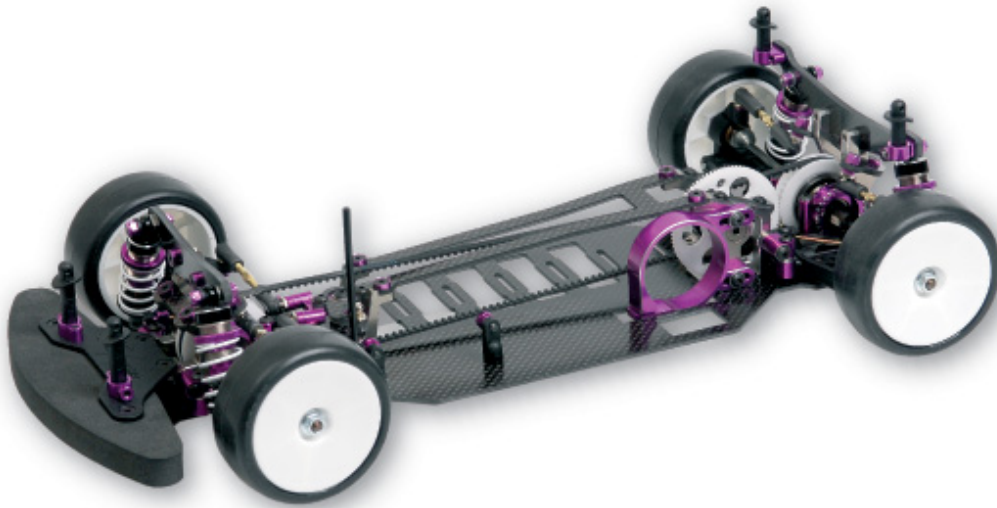

# Instruction Manual v.1.0



Schumacher Racing  
73 Tenter Road  
Moulton Park  
Northampton  
NN3 6AX  
ENGLAND



Schumacher USA Inc  
6302 Benjamin Road  
Suite 404  
Tampa  
Florida 33634  
U.S.A

S179

## Transmitter, receiver and servo

(Including AA cells for TX)



## Electronic Speed Control



SPEXT9802B SP GT - PRO B/L ESC V3.0 Blue  
 SPEXT9802PRD SP GT - PRO B/L ESC V3.0 Carbon  
 SPEXT9802LPD SP GT - LPF B/L ESC V 3.0 Blue 5.5T  
 SPEXT9802LPF SP GT - LPF B/L ESC V3.0 Carbon 5.5T

## Battery Pack



G107 - Ener-G 4600 - XVS Team x 5  
 G106 - Ener-G 4600 - XVS Team x 4



CR004 - CORE 5000mAh 7.4v LiPo 25C  
 CR004 - CORE 3350mAh 7.4v LiPo  
 SLR5309H Speed Power - 5300mAh 7.4v 30C

## Battery Charger



CR024 UDC30 Balance Charger - NiMH + LiPo  
 CR104 - UDC30 Universal Charger - NiMH, LiPo + LiFe

## Motor

SP19845 Speed Passion CV3.0 Comp BL Motor; 3.5T  
 SP19839 Speed Passion CV3.0 Comp BL Motor; 3.5T  
 SP19840 Speed Passion CV3.0 Comp BL Motor; 4.0T  
 SP19845 Speed Passion CV3.0 Comp BL Motor; 4.5T  
 SP19855 Speed Passion CV3.0 Comp BL Motor; 5.5T  
 SP19865 Speed Passion CV3.0 Comp BL Motor; 6.5T  
 SP19875 Speed Passion CV3.0 Comp BL Motor; 7.5T  
 SP19885 Speed Passion CV3.0 Comp BL Motor; 8.5T  
 SP19895 SP Ultra Stack BL Motor 10.5T  
 SP19895 SP Ultra Stack BL Motor 13.5T  
 SP19895 SP Ultra Stack BL Motor 15.5T

## Bodyshell & Paint



## Wheels & Tyres



See  
[www.racing-cars.com](http://www.racing-cars.com)  
 for full  
 listings.

## Tools

H1010 With Precision  
 Circclip Pliers



Curved Body Scissors  
 CR044  
 Designed for cutting out  
 polycarbonate bodies.



L19107 - Solder



CA450  
 20g CS Cyano  
 (Super Glue)  
 Thin, ideal for tyres.



## Pinion Gear

L3414 - HT Pinion, Hard Alloy 45dp  
 L3415 - 15T Pinion, Hard Alloy 48dp  
 L3416 - 16T Pinion, Hard Alloy 48dp  
 L3417 - 17T Pinion, Hard Alloy 48dp  
 L3418 - 18T Pinion, Hard Alloy 48dp  
 L3419 - HT Pinion, Hard Alloy 45dp  
 L3420 - 20T Pinion, Hard Alloy 48dp  
 L3421 - 21T Pinion, Hard Alloy 48dp  
 L3422 - 22T Pinion, Hard Alloy 48dp  
 L3423 - 23T Pinion, Hard Alloy 48dp  
 L3424 - 24T Pinion, Hard Alloy 48dp  
 L3425 - 25T Pinion, Hard Alloy 48dp  
 L3426 - 26T Pinion, Hard Alloy 48dp  
 L3427 - 27T Pinion, Hard Alloy 48dp  
 L3428 - 28T Pinion, Hard Alloy 48dp  
 L3429 - 29T Pinion, Hard Alloy 48dp  
 L3430 - 30T Pinion, Hard Alloy 48dp  
 L3431 - 31T Pinion, Hard Alloy 48dp  
 L3432 - 32T Pinion, Hard Alloy 48dp  
 64dp Hard Alloy Pinion's also available see  
[www.racing-cars.com](http://www.racing-cars.com)

## IMPORTANT SAFETY NOTES

- This product is not suitable for children under the age of 14, without the direct supervision of an adult.
- Select an area for assembly that is away from the reach of small children. The parts in this kit are small and can be swallowed by children causing choking and possible internal injuries.
- Exercise care when using hand tools and sharp instruments during assembly.
- Carefully read all manufacturers warnings and cautions for any additional parts used in the construction.
- In line with our policy of continuous development the exact details of the Kit may vary.

Before you begin building your Mi4 please refer to the set-up sheets at the back of the manual. It may be necessary to build the car differently according to the set-up required.

## Tools and Additional Items required

Step 1

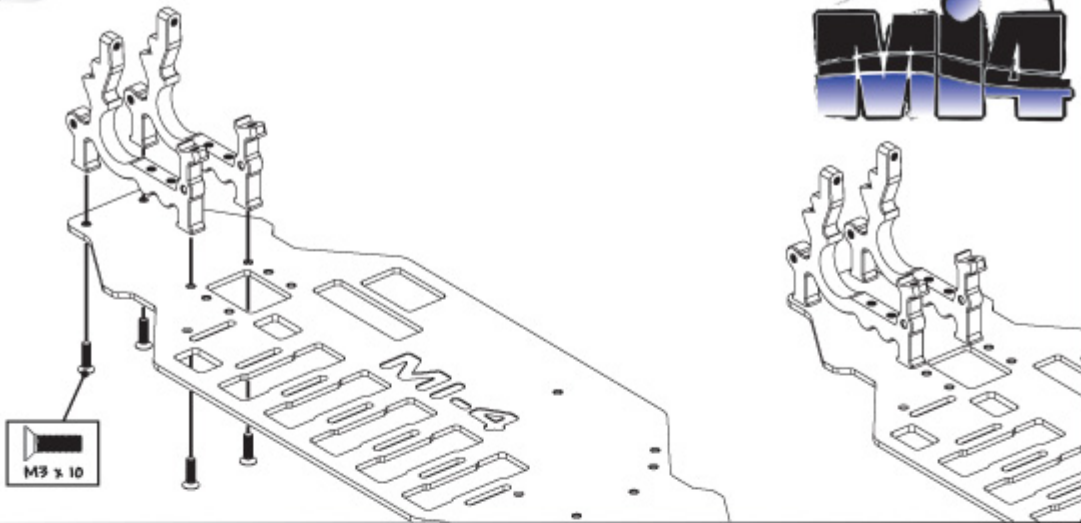

Step 2

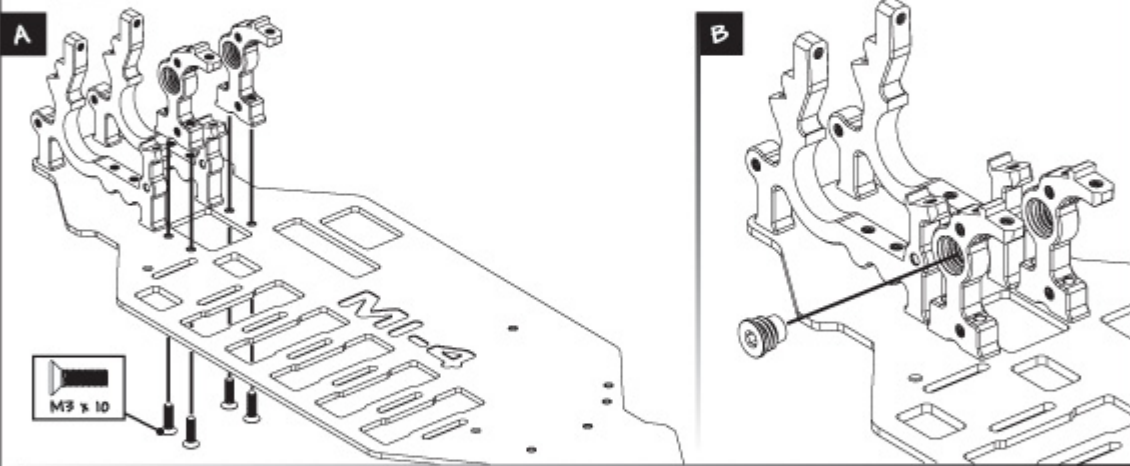

Step 3

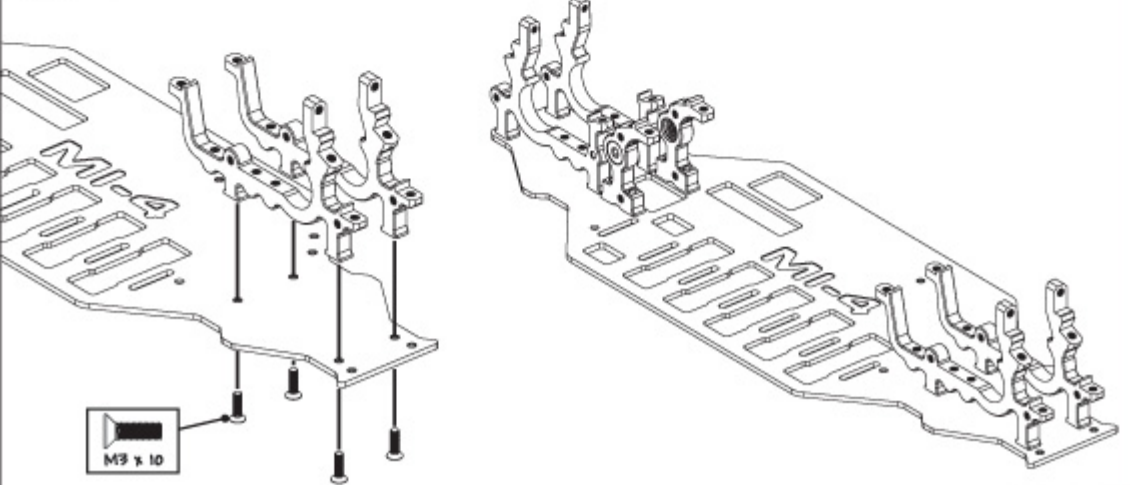

Step 4

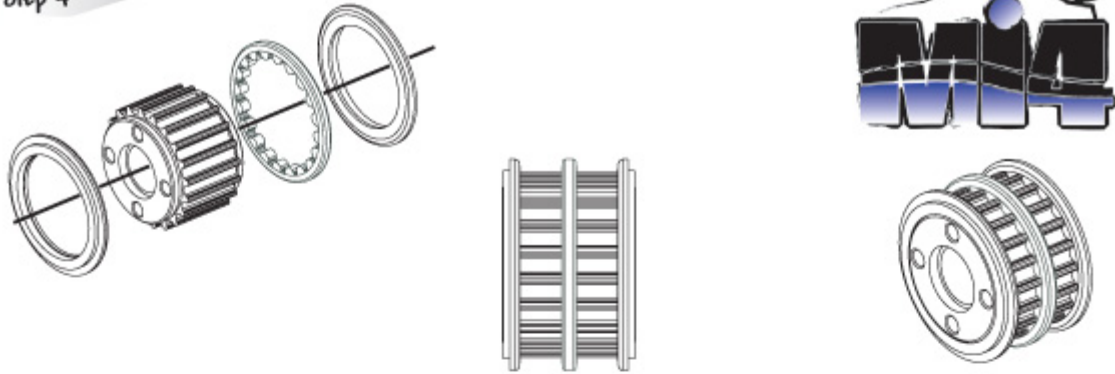

Step 5

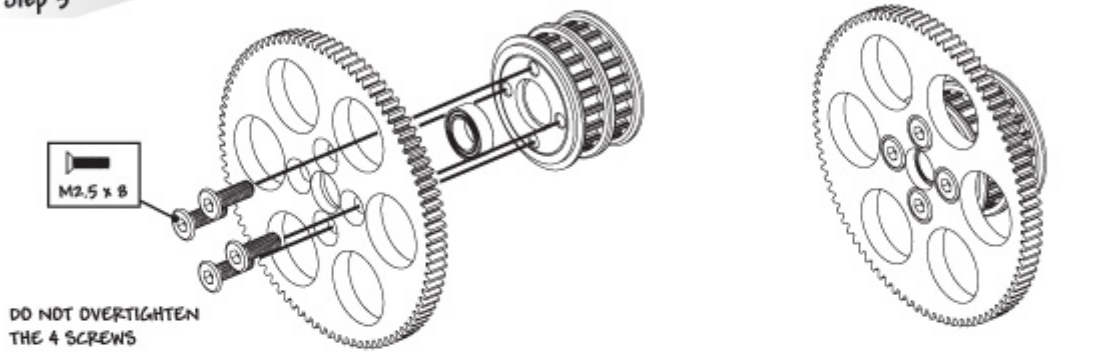

Step 6

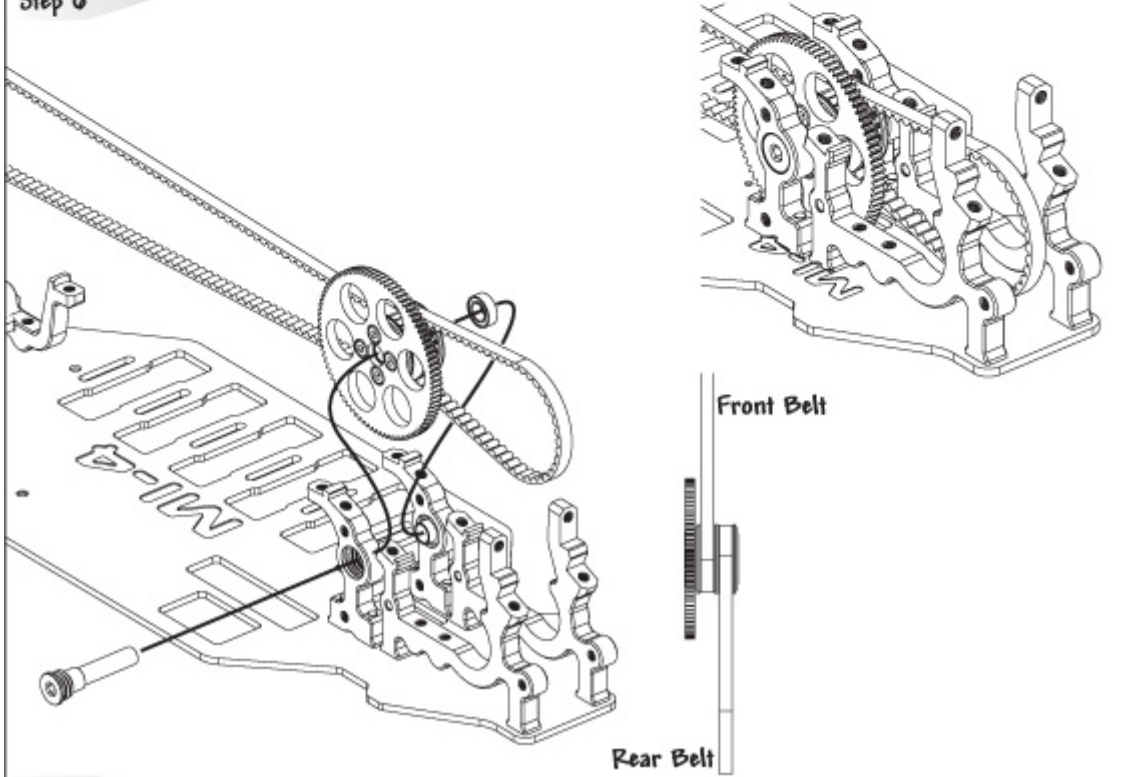



Step 7

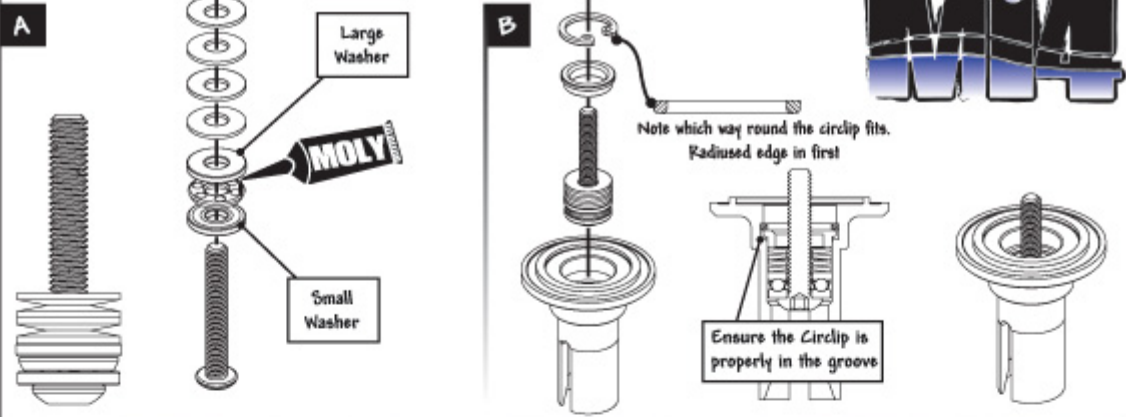

Step 8

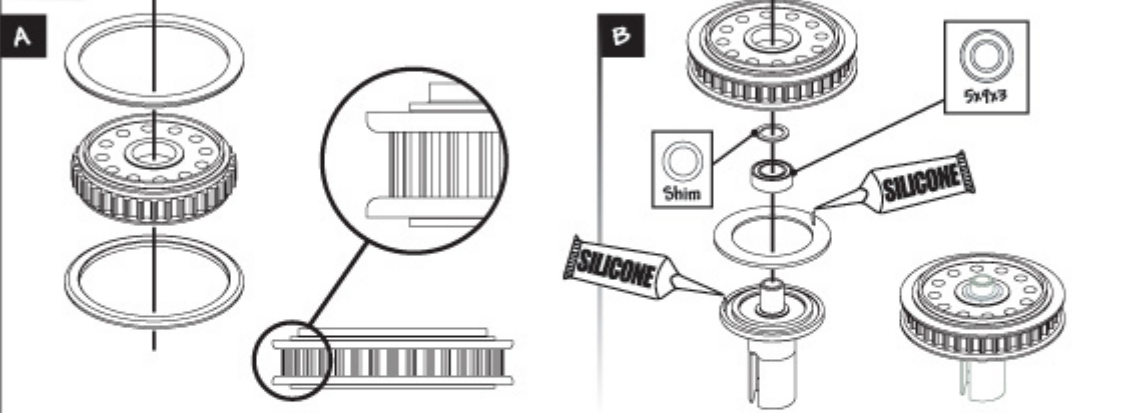

Step 9

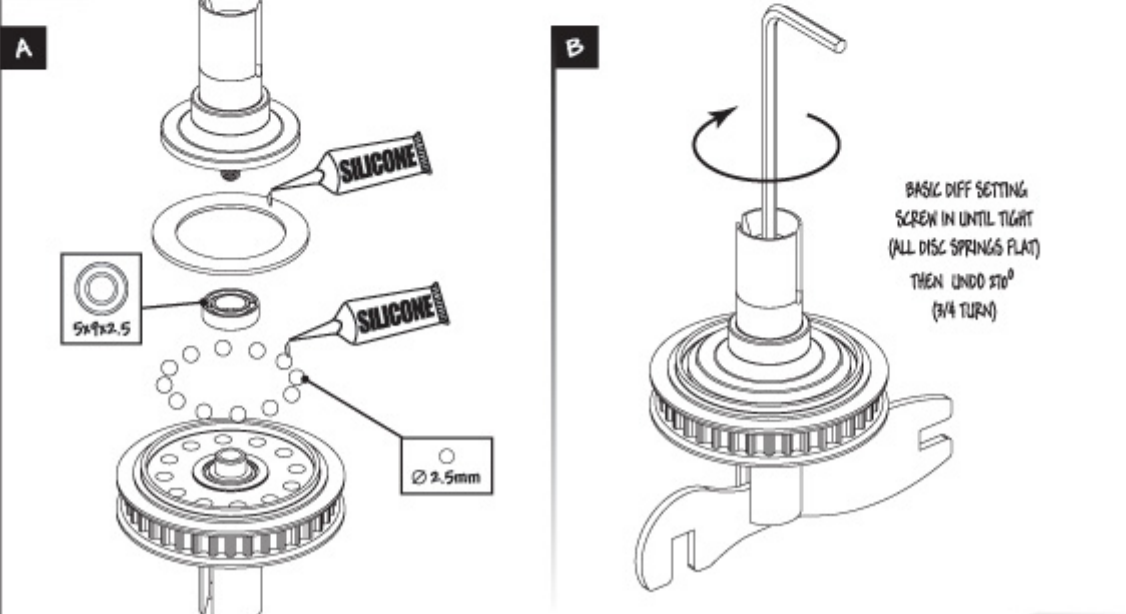

Step 9

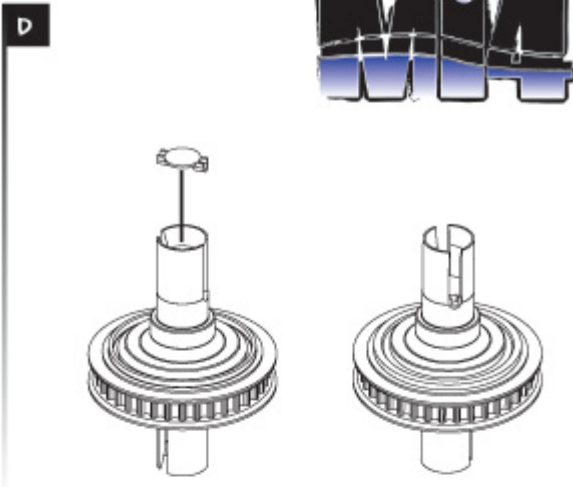
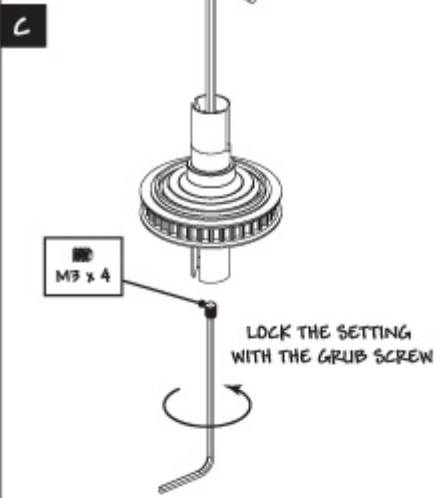

Step 10

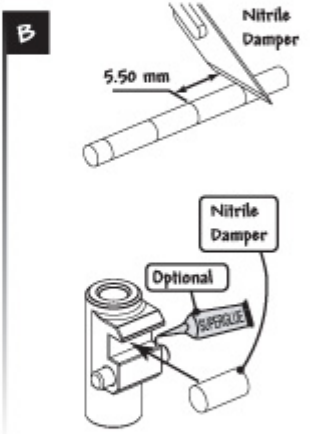
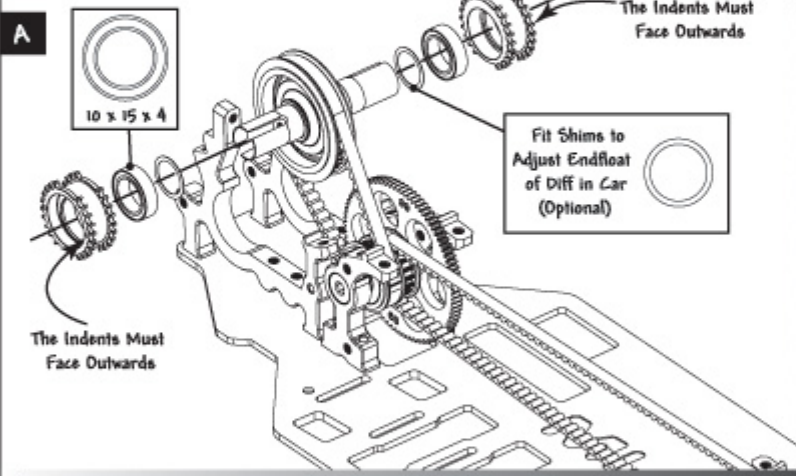

Step 10

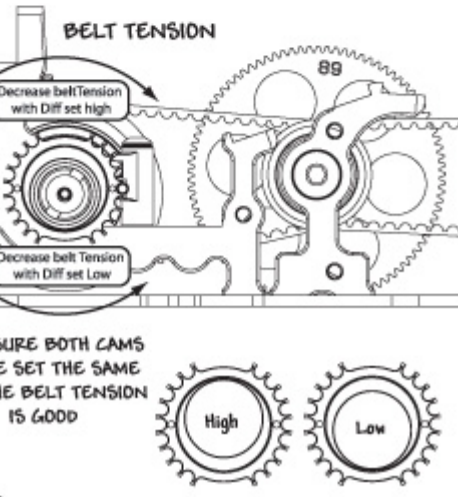
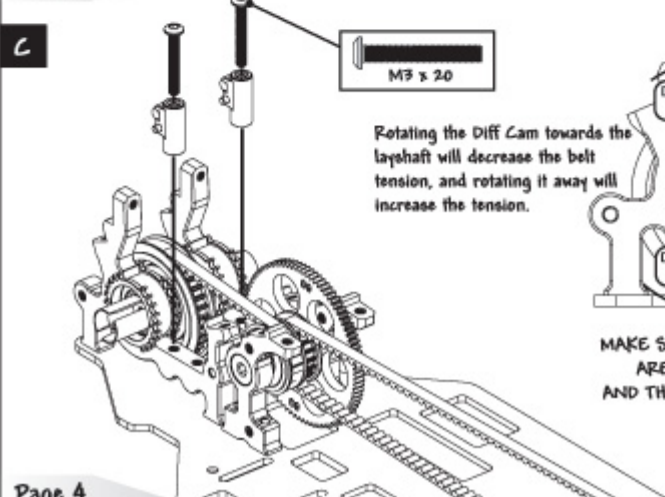

Step 11

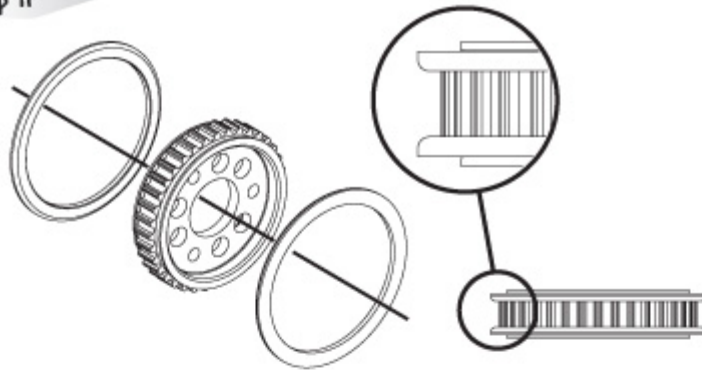

Step 12

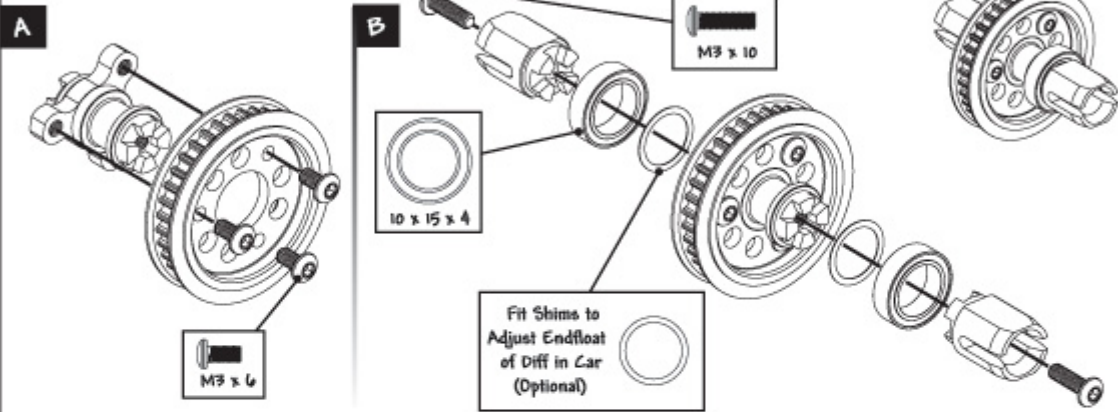

Step 13

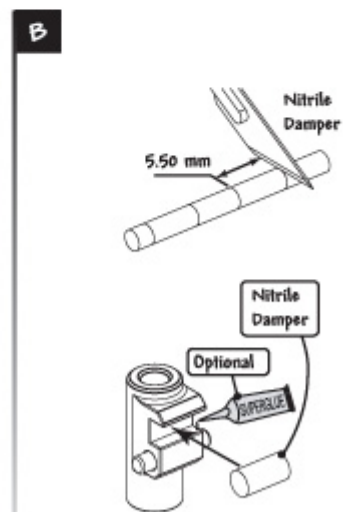
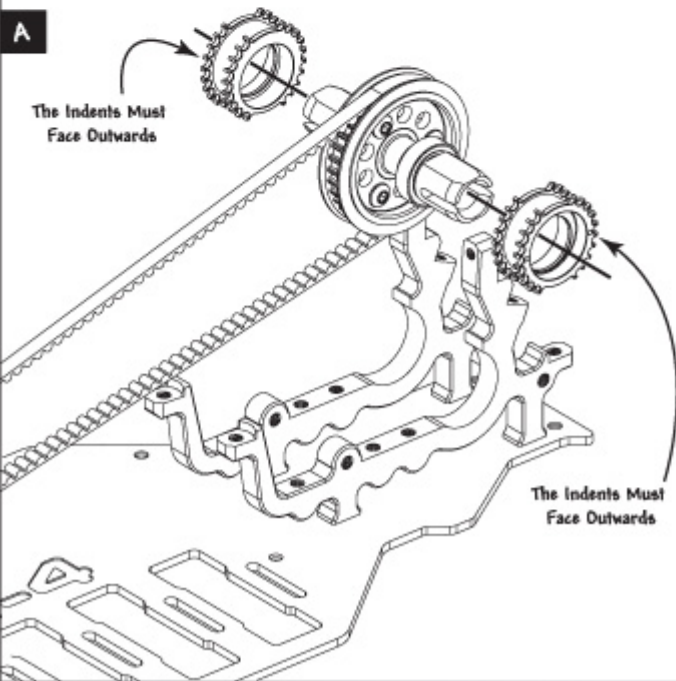

Step 13

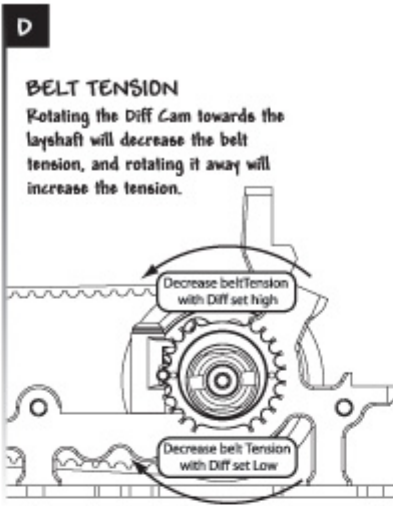
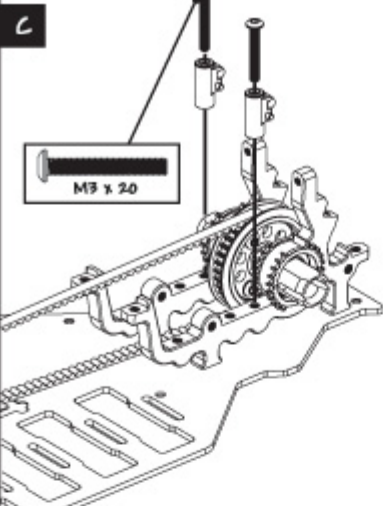

MAKE SURE BOTH CAMS ARE SET THE SAME AND THE BELT TENSION IS GOOD

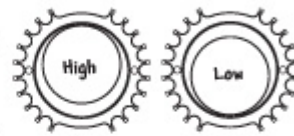

Step 14

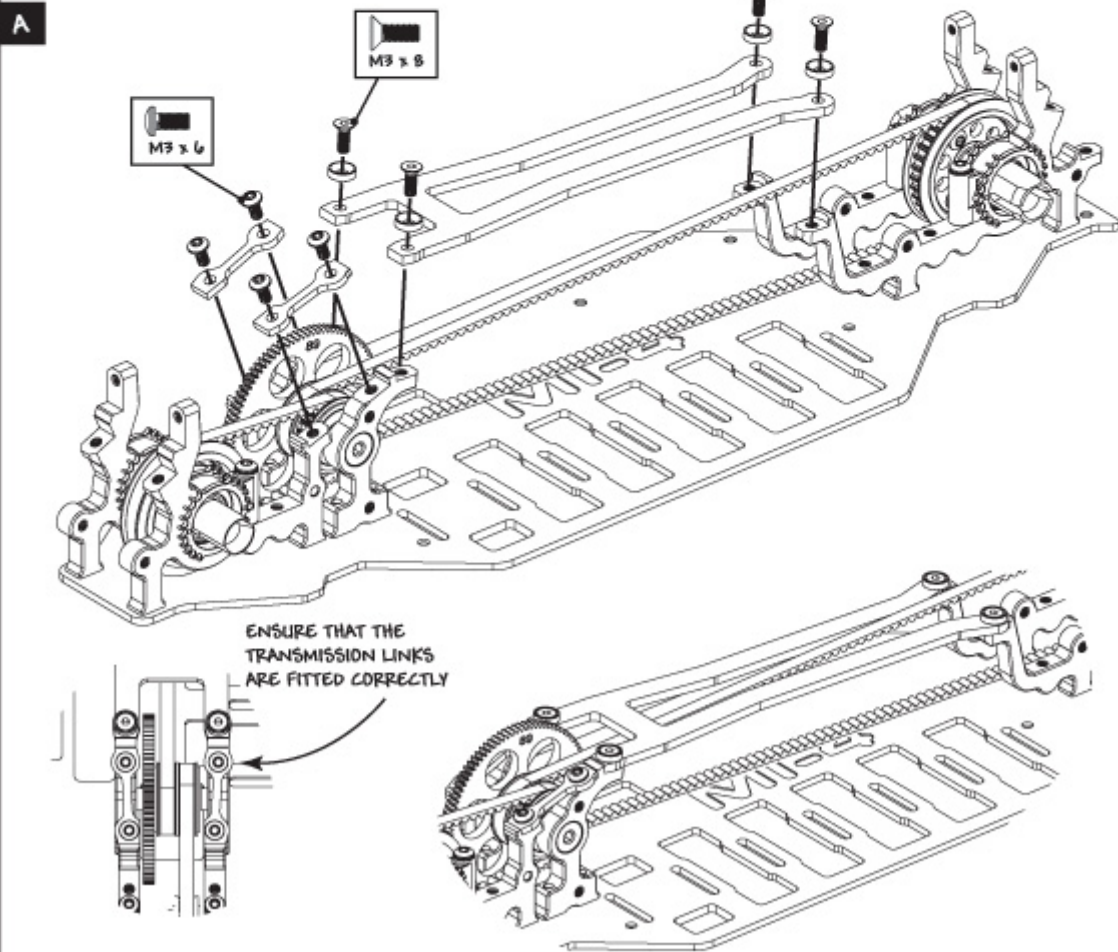



Step 15

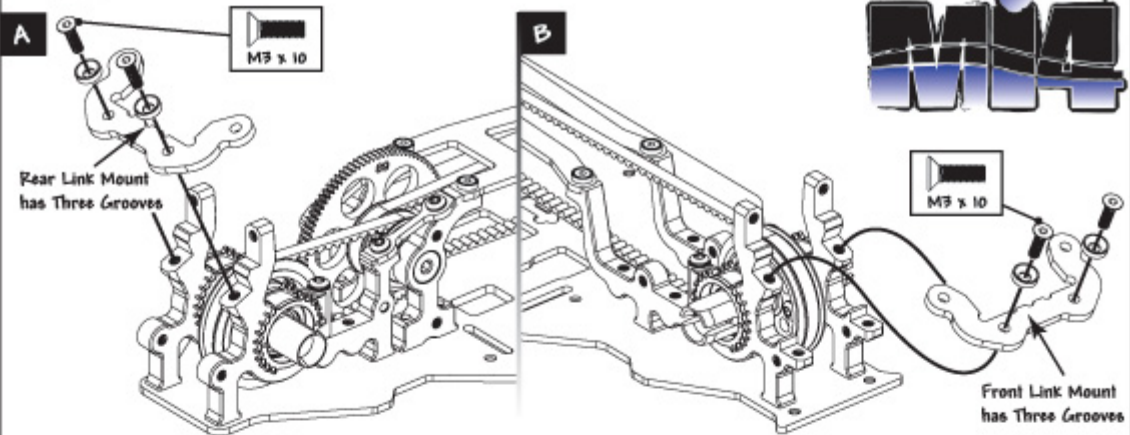

Step 16

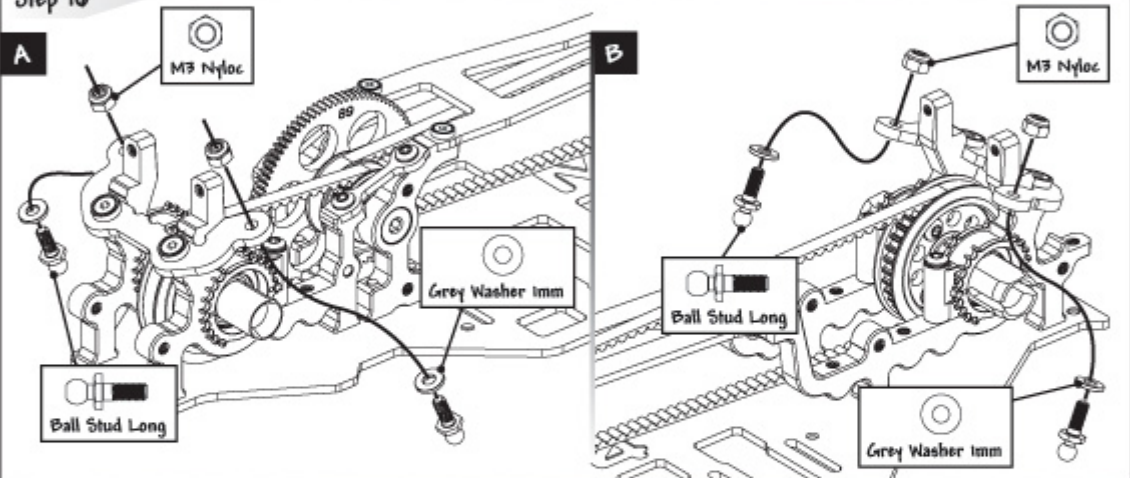

Step 17

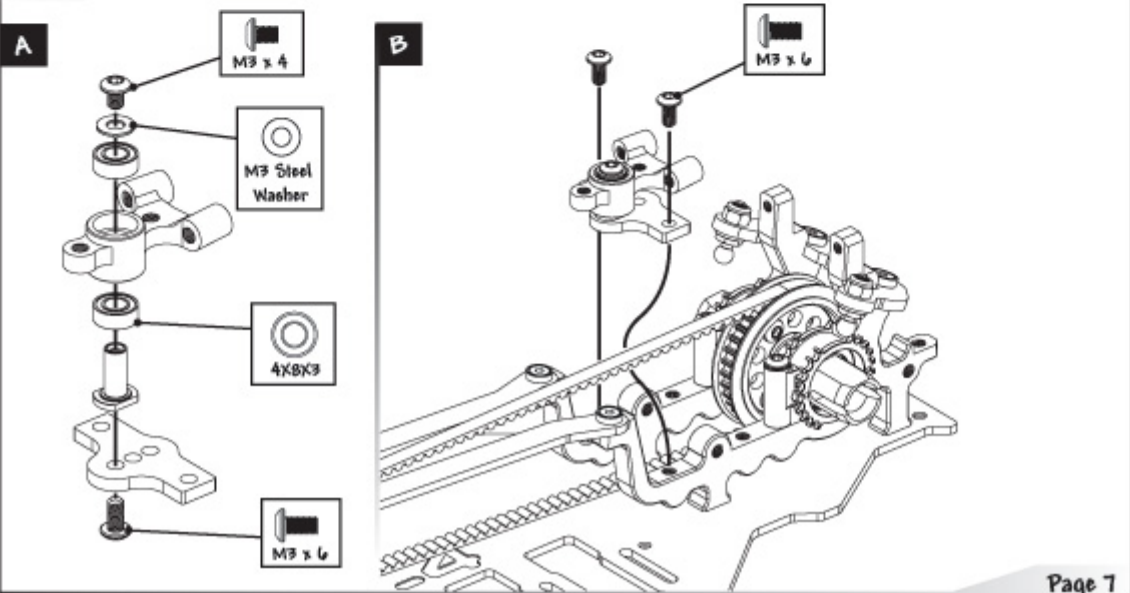

Step 18

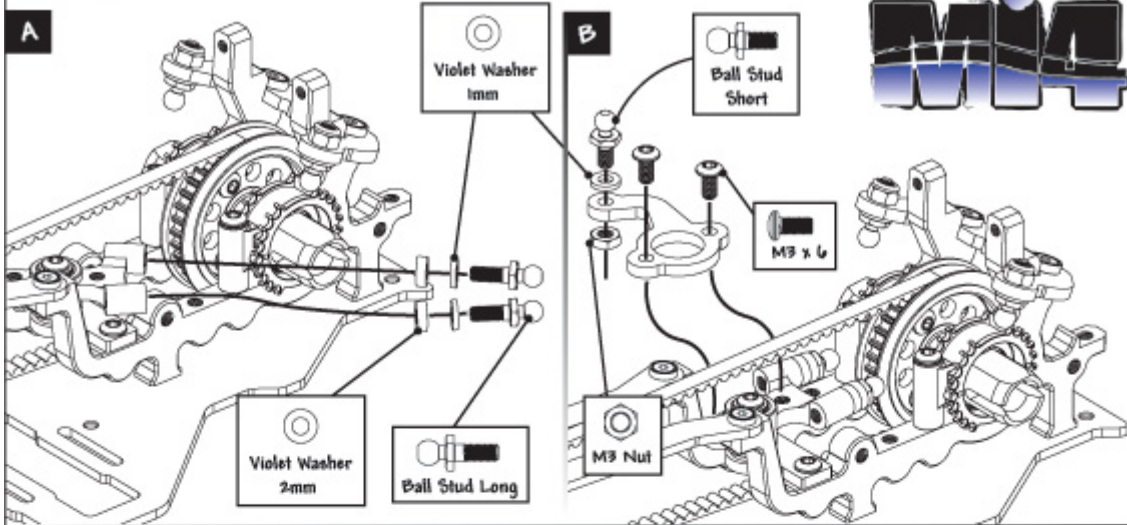

Step 19

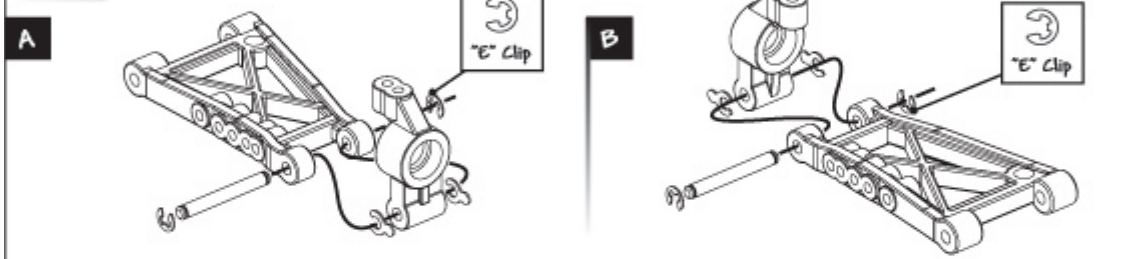

Step 20

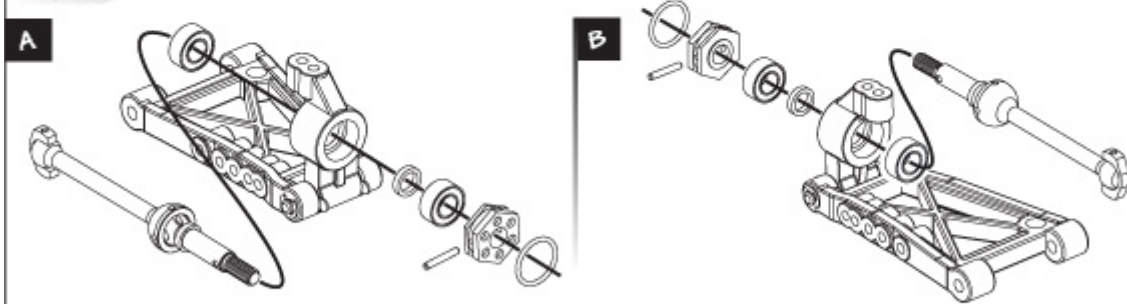

Step 21

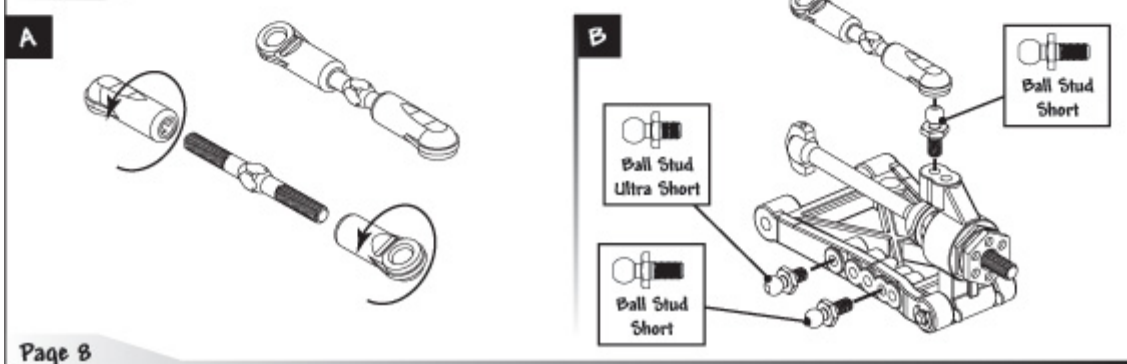

Step 21

C



D

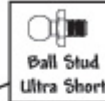
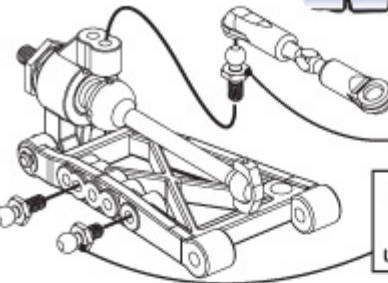
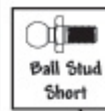

Step 22

A

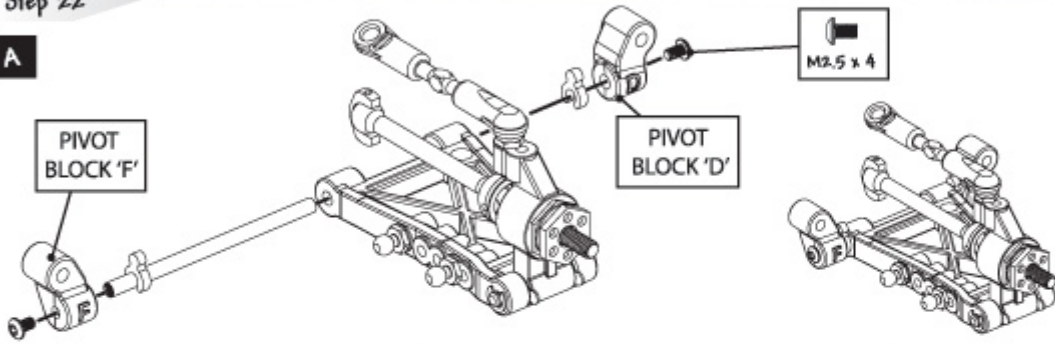

Step 22

B

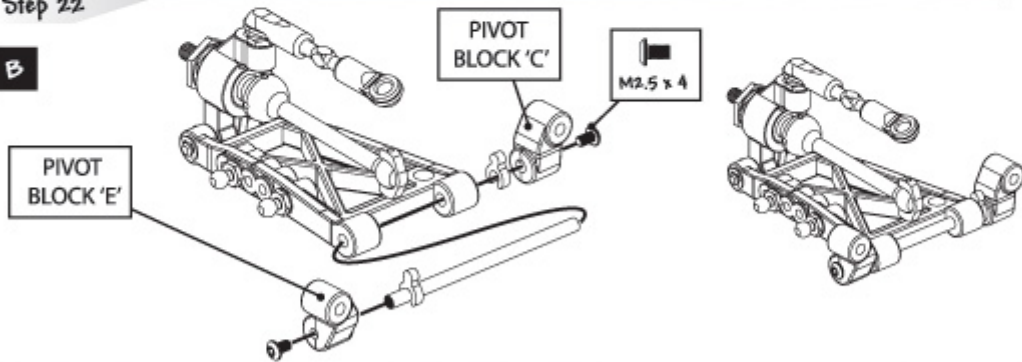

Step 23

A

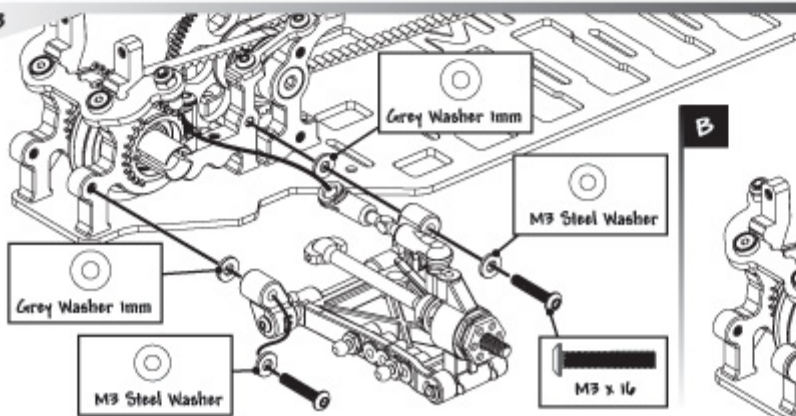

B

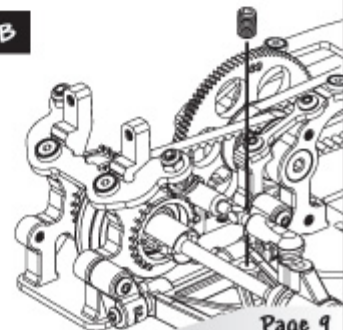



Step 23

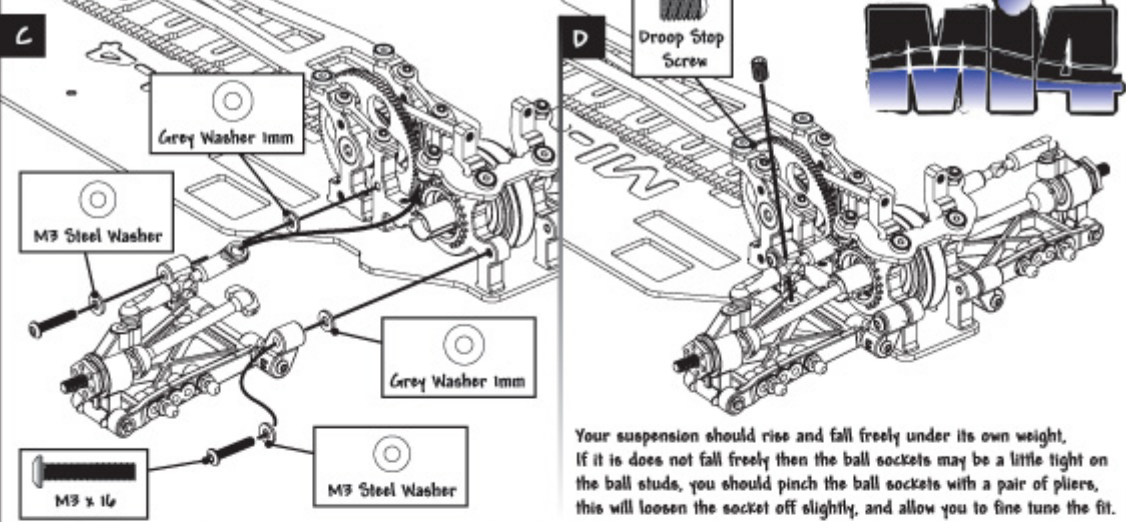

Your suspension should rise and fall freely under its own weight. If it does not fall freely then the ball sockets may be a little tight on the ball studs, you should pinch the ball sockets with a pair of pliers, this will loosen the socket off slightly, and allow you to fine tune the fit.

Step 24

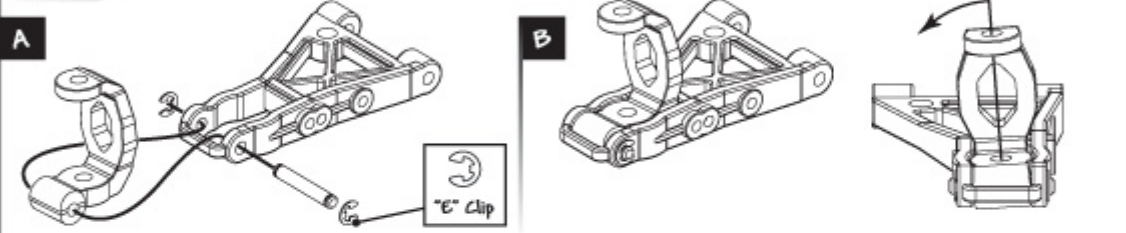

Step 24

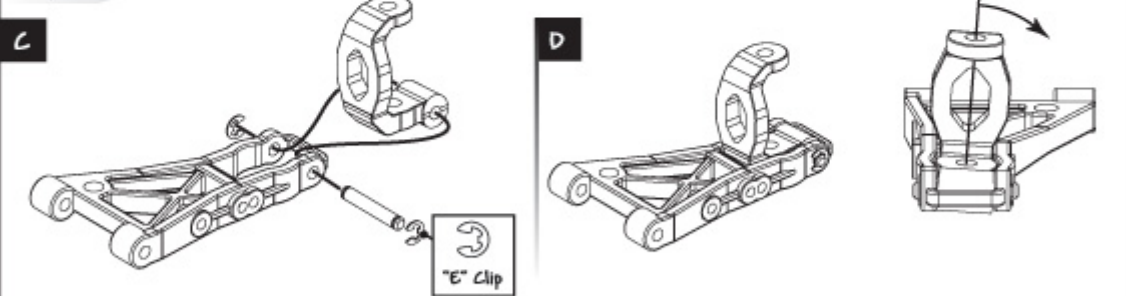

Step 25

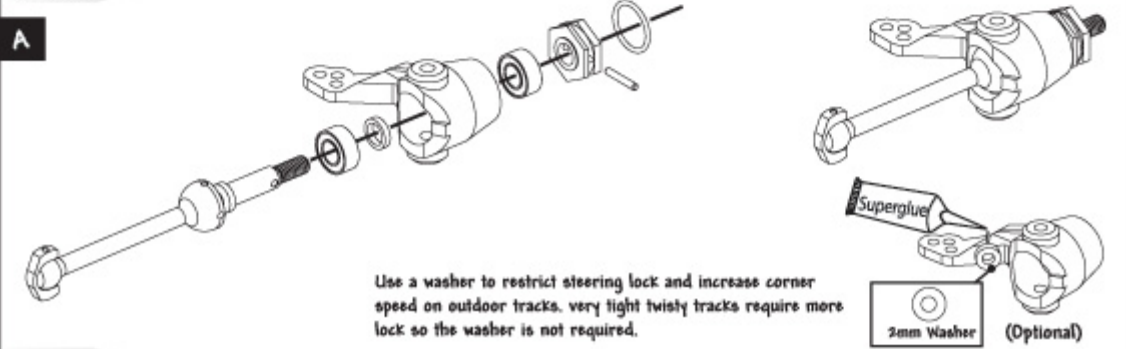

Use a washer to restrict steering lock and increase corner speed on outdoor tracks. very tight twisty tracks require more lock so the washer is not required.



Step 25

B

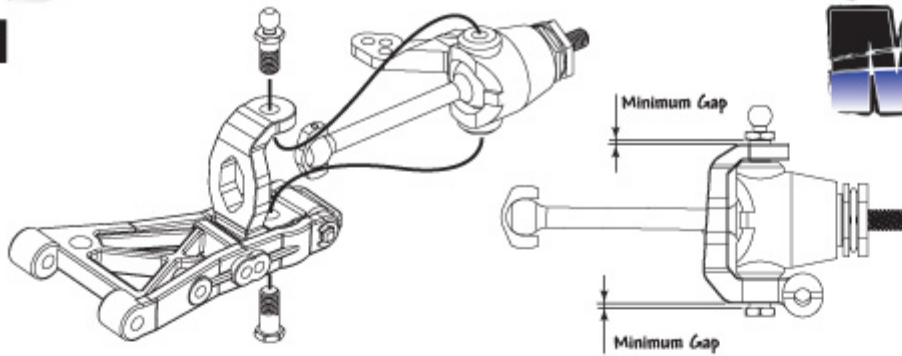

Step 26

A

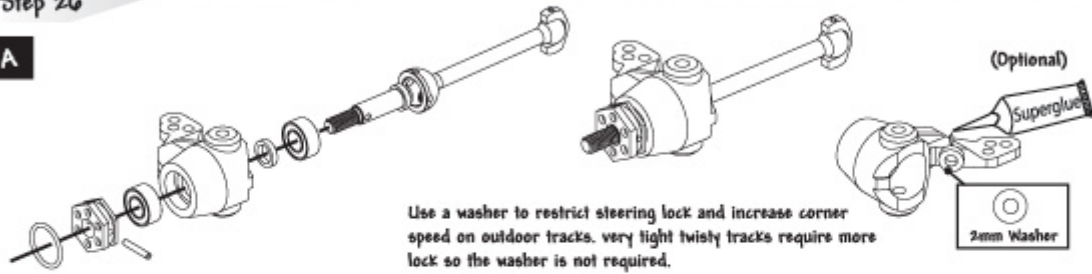

Use a washer to restrict steering lock and increase corner speed on outdoor tracks. very tight twisty tracks require more lock so the washer is not required.

Step 26

B

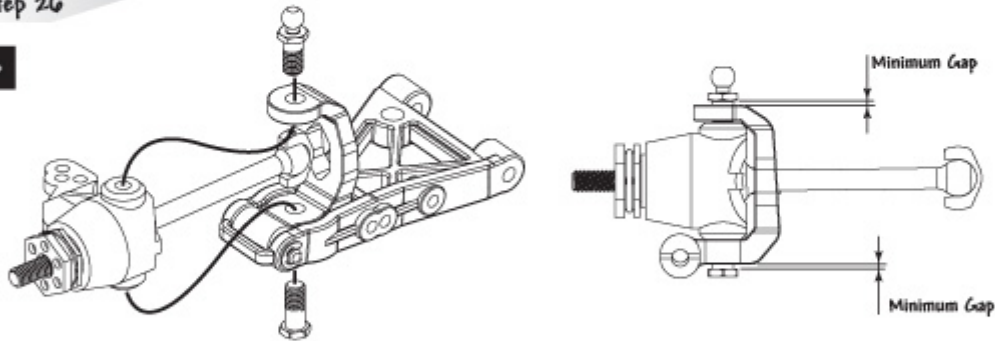

Step 27

A

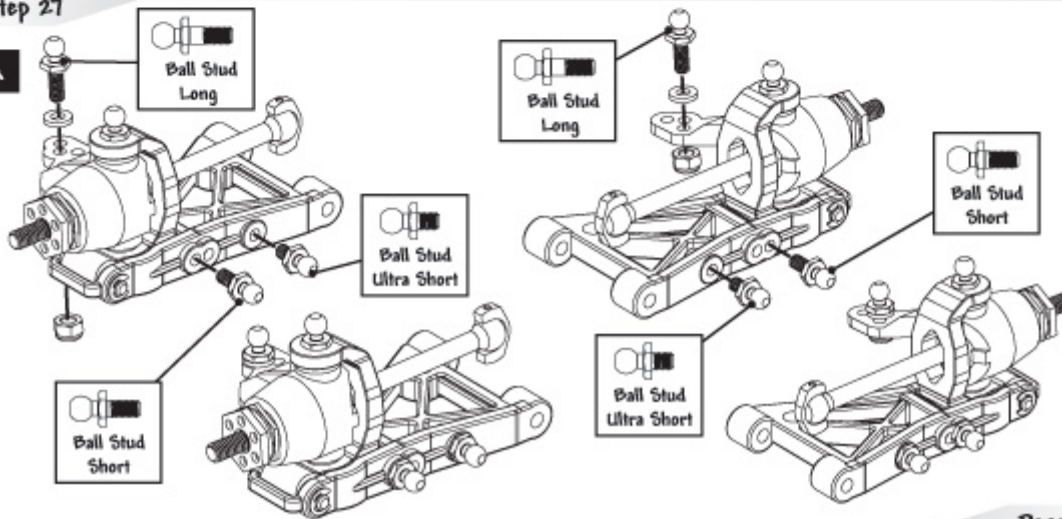

Step 28

A

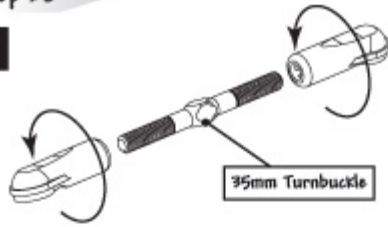

Step 28

B

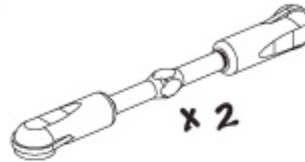
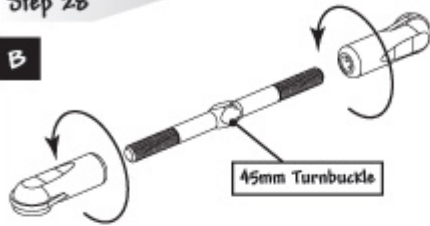

Step 28

C

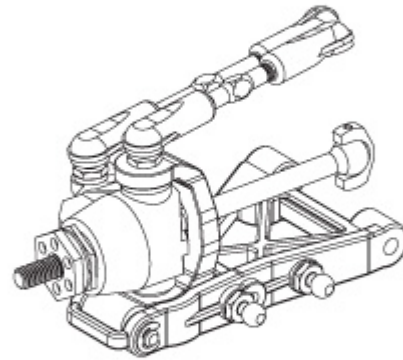
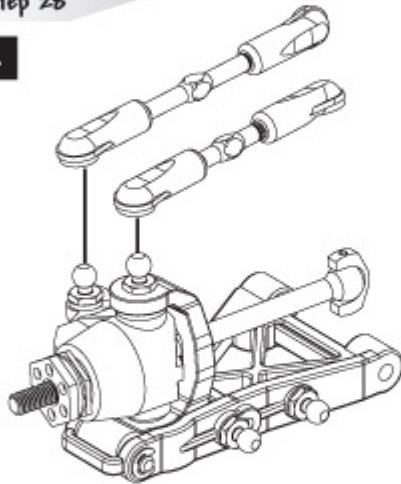

Step 28

d

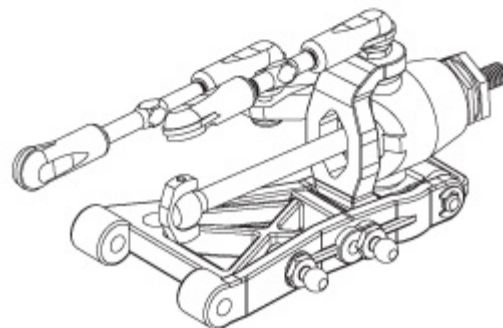
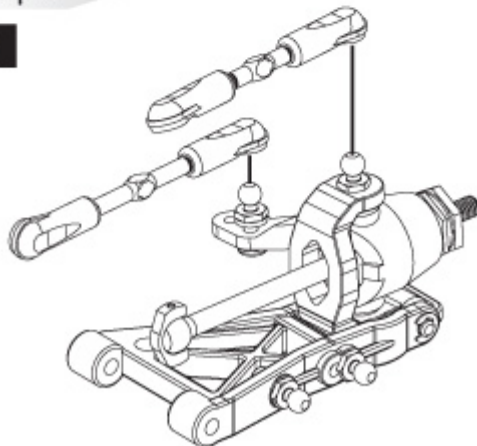

Page 12

Step 29

A

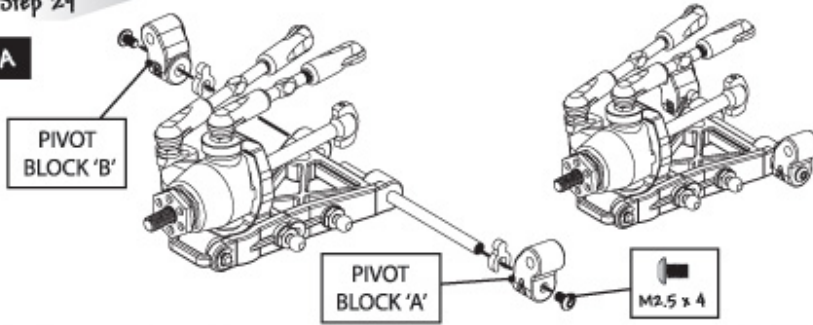

Step 29

B

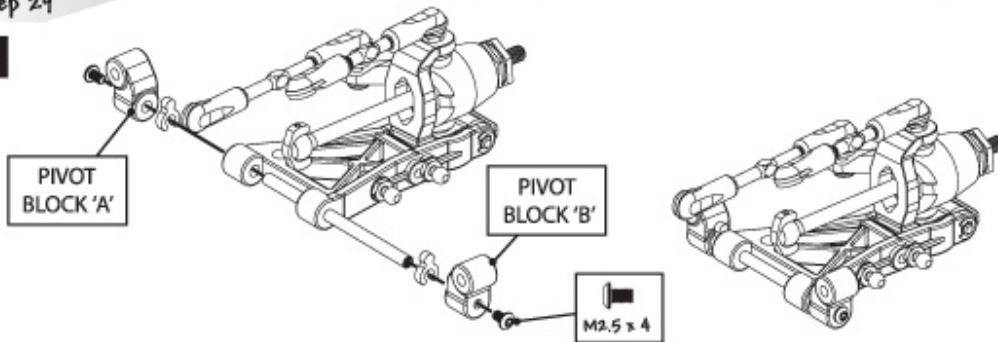

Step 30

A

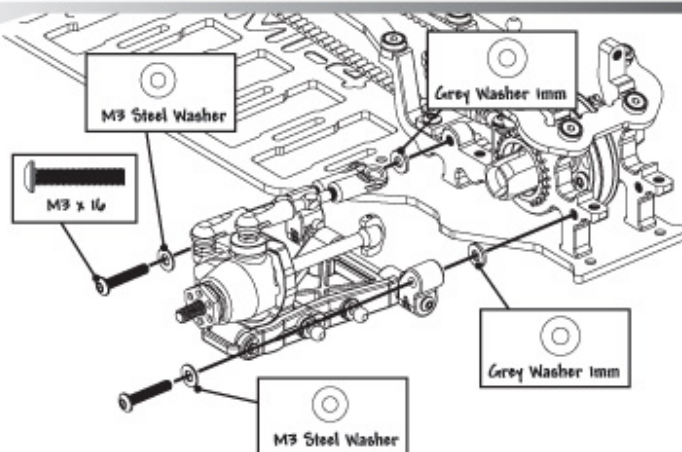

Step 30

B

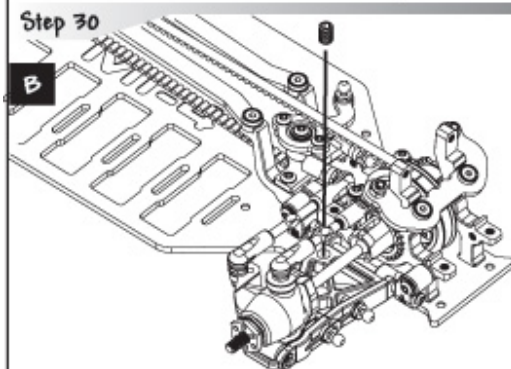

Your suspension should rise and fall freely under its own weight. If it does not fall freely then the ball sockets may be a little tight on the ball studs, you should pinch the ball sockets with a pair of pliers, this will loosen the socket off slightly, and allow you to fine tune the fit.

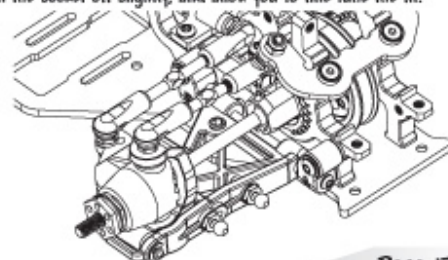

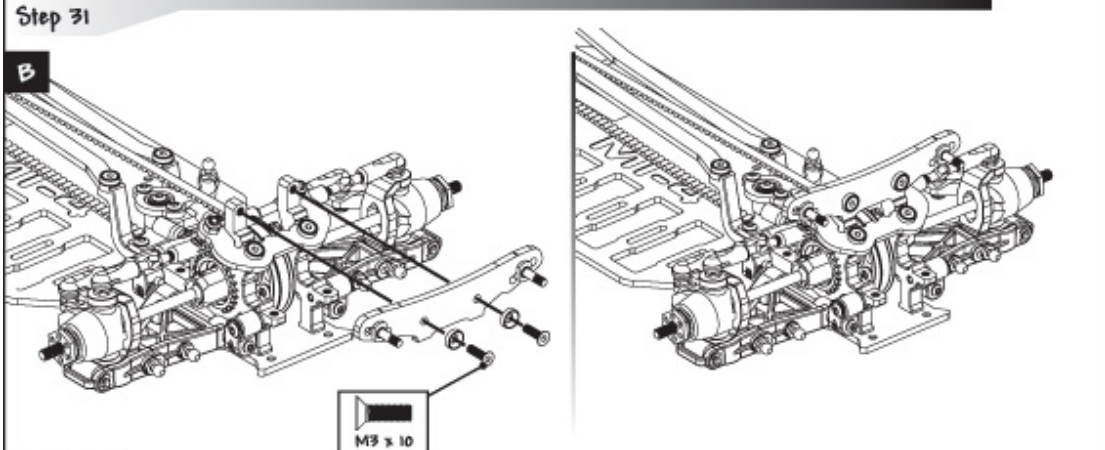
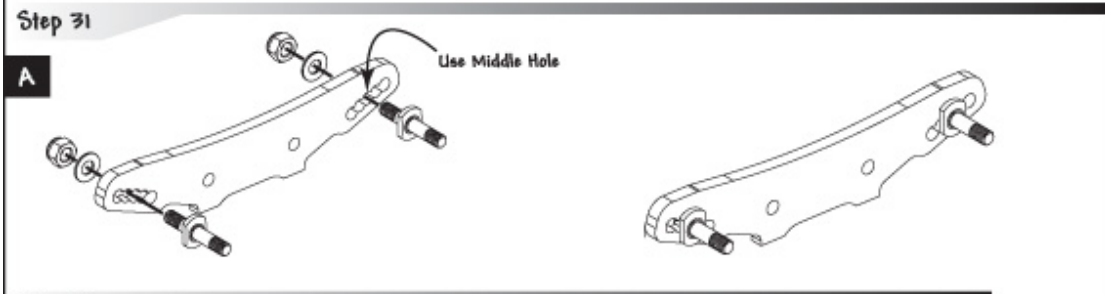
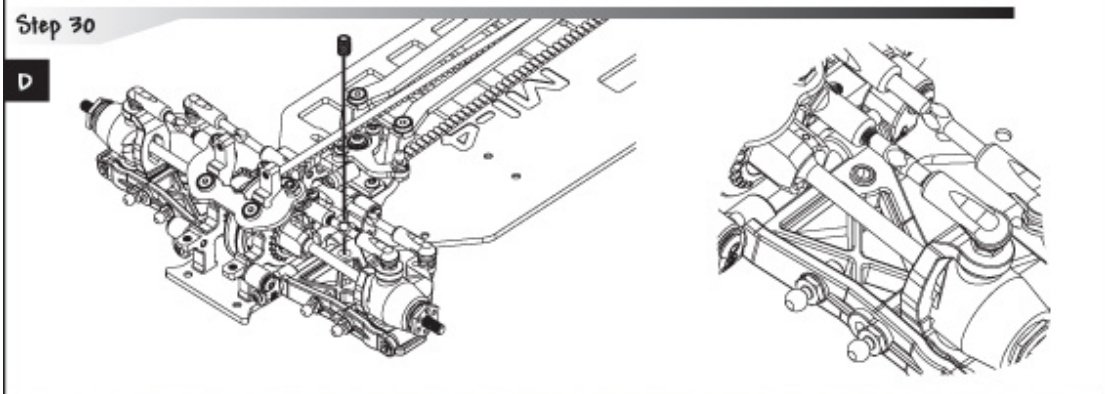
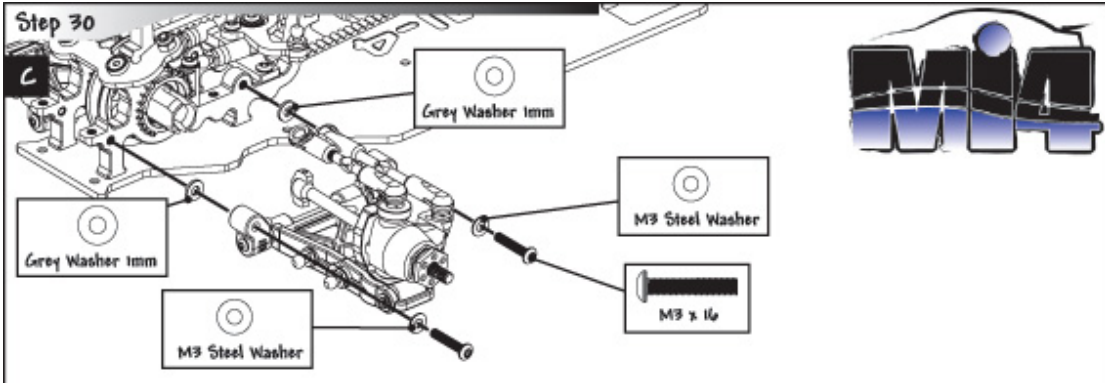



Step 32

A

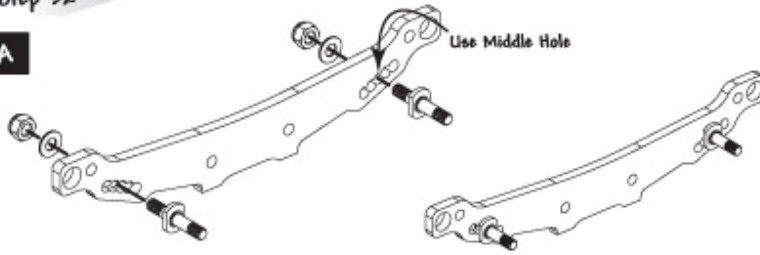

Step 32

B

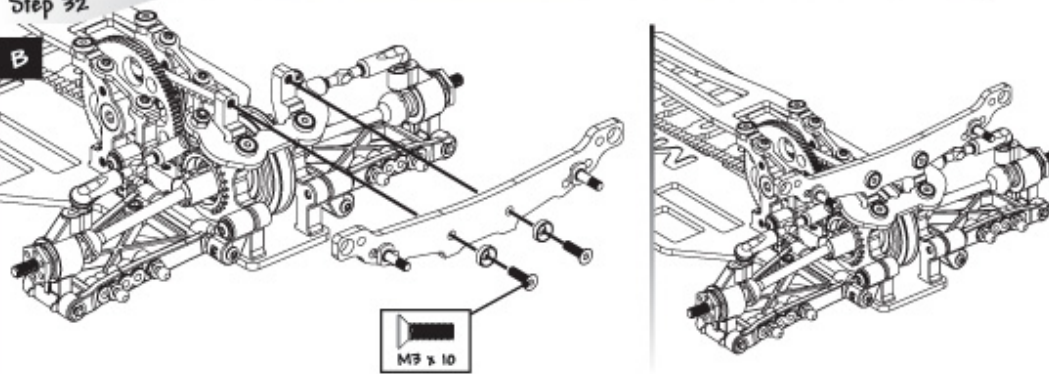

Step 33

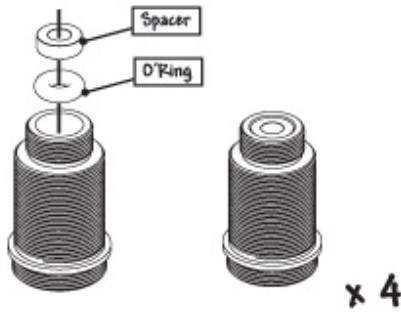

Step 34

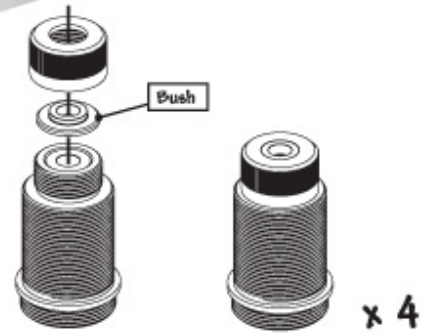

Step 35

A

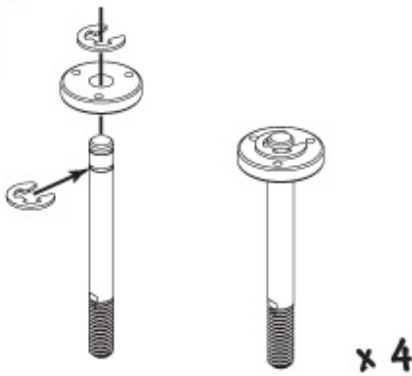

B

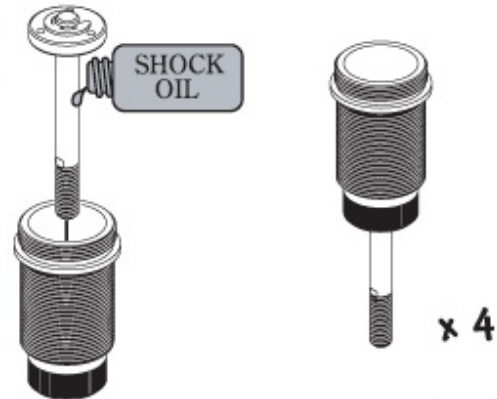

Step 36

A

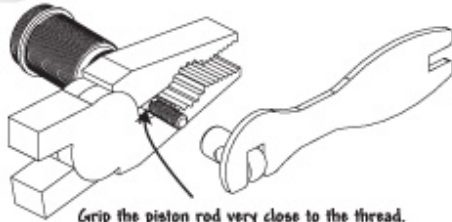

Grip the piston rod very close to the thread.  
BE CAREFUL NOT TO DAMAGE  
THE POLISHED SHOCK ROD.

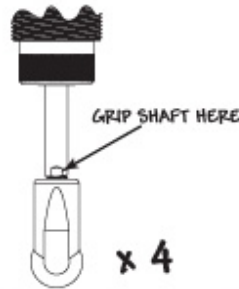

Step 36

B



Fill Slowly With Shock Oil  
until Domed. Move Piston  
Up and Down Slowly  
and Allow all Air  
Bubbles to Rise  
and disappear.

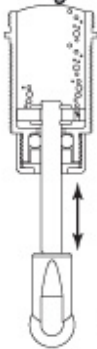

C



D

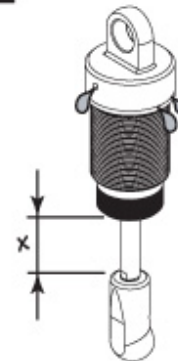

Adjust this distance (X) to suit the amount  
of rebound you want

Step 37

A

Lubricate the Threads  
with a SMALL amount  
of shock oil

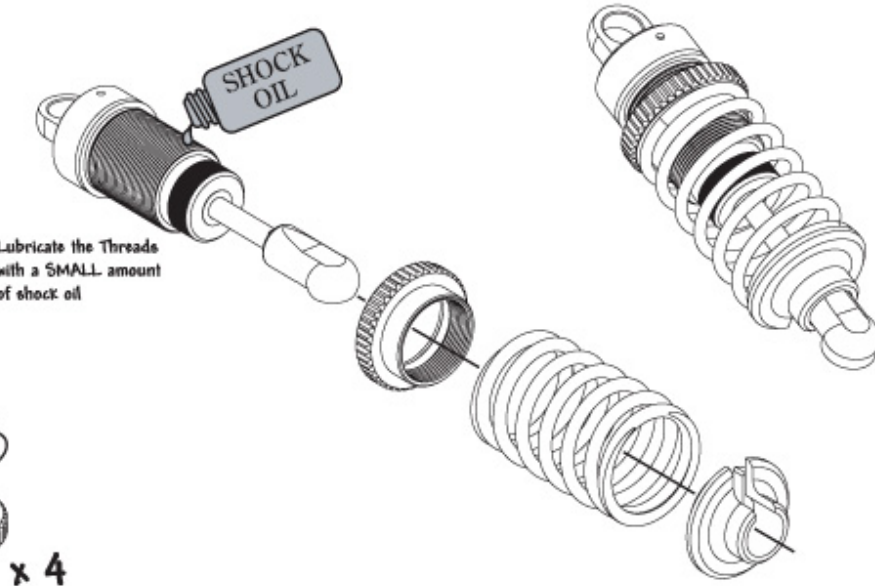

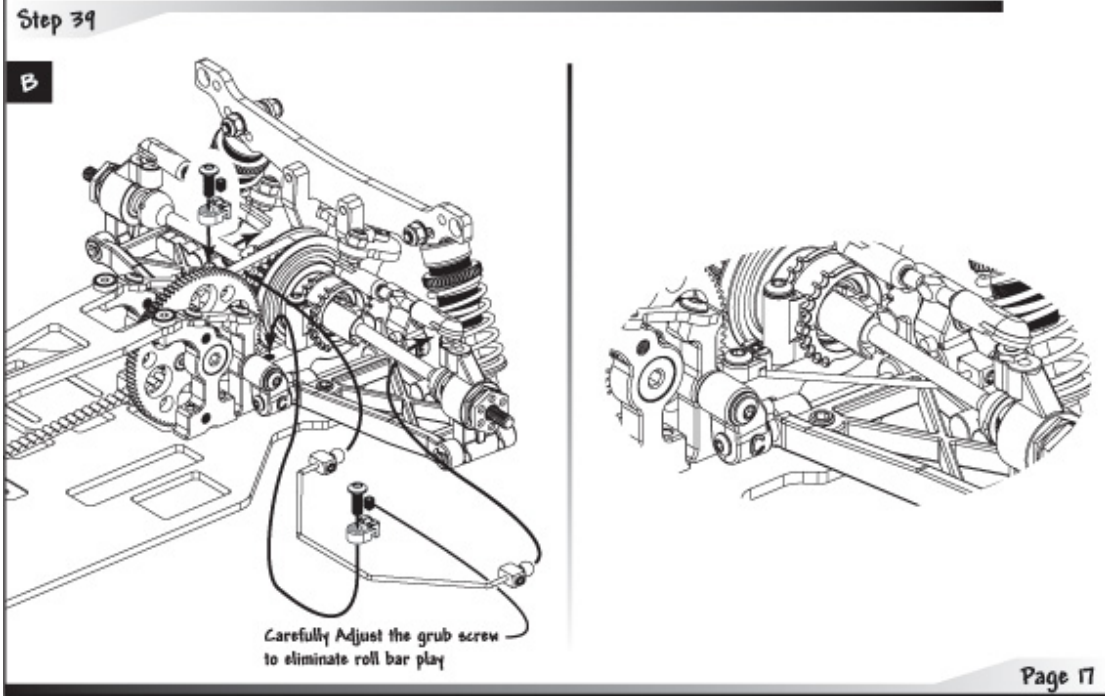
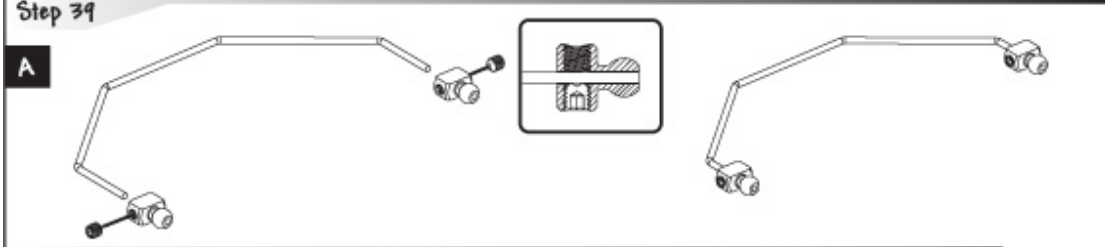
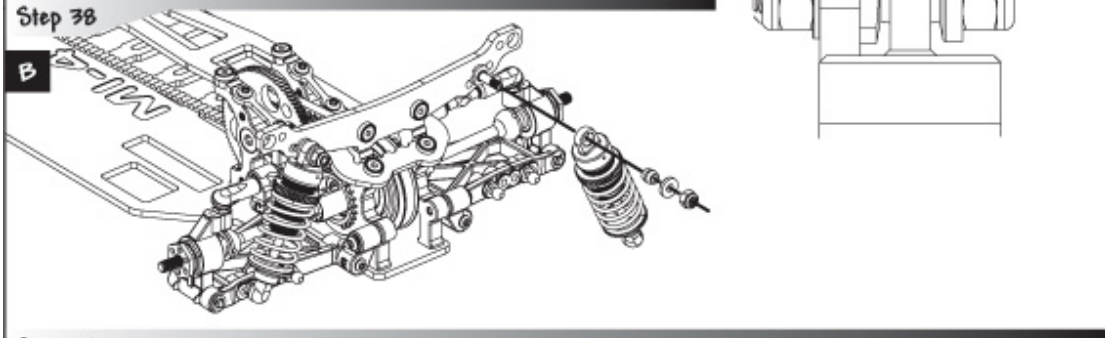
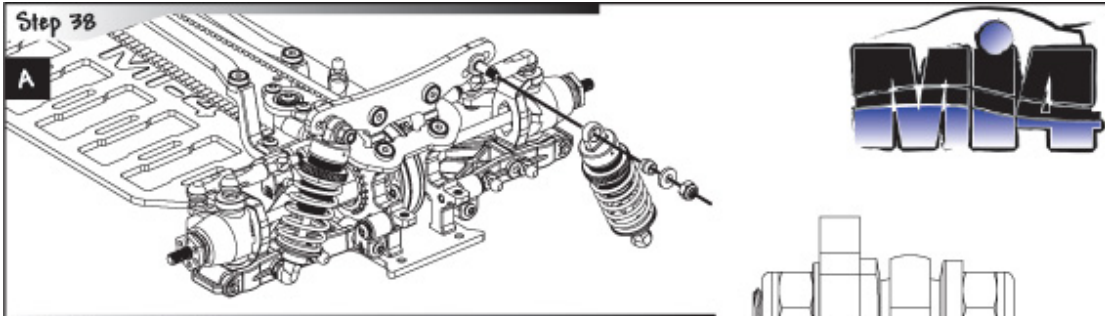

Step 39

C

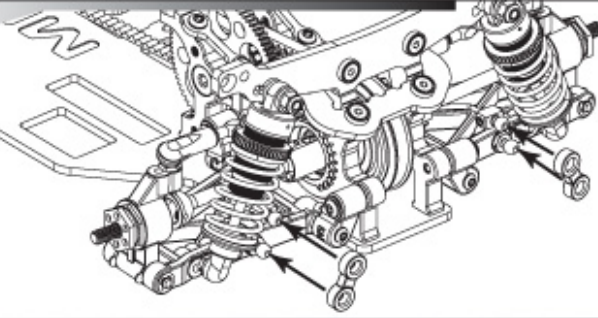

Step 40

A

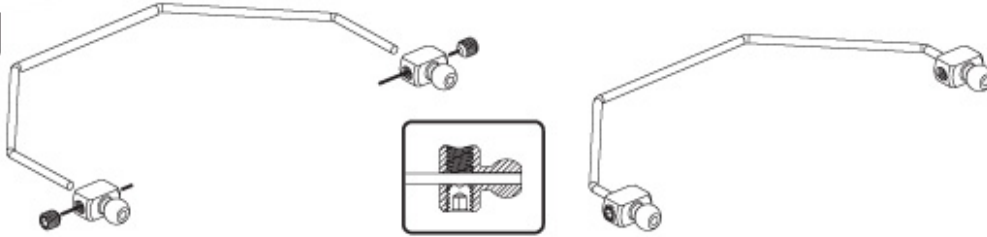

Step 40

B

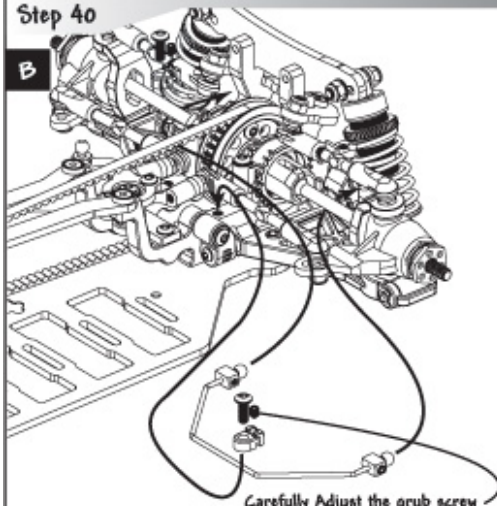

Carefully Adjust the grub screw  
to eliminate roll bar play

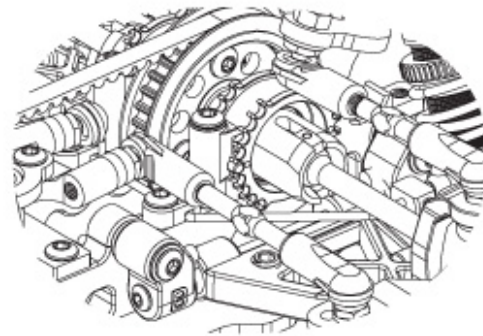

Step 40

C

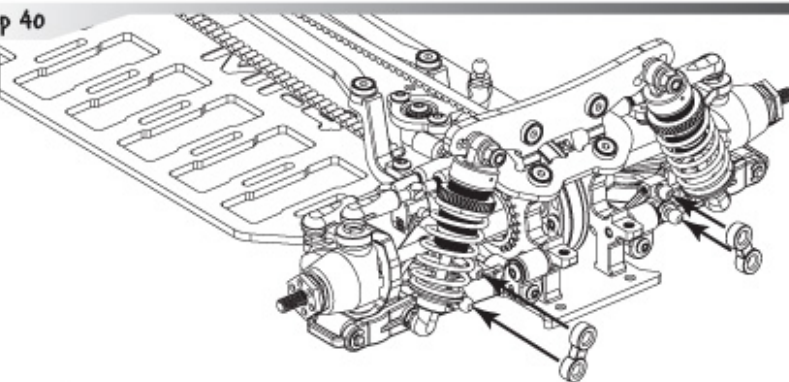

Page 18



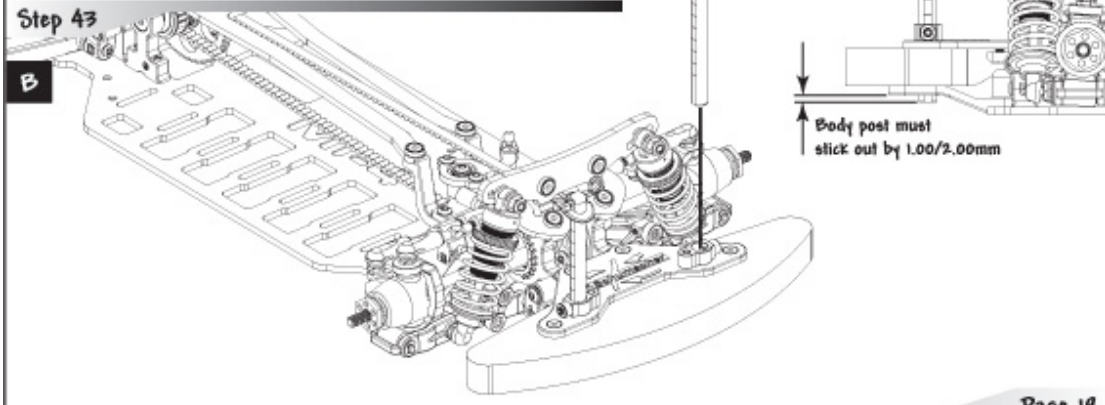
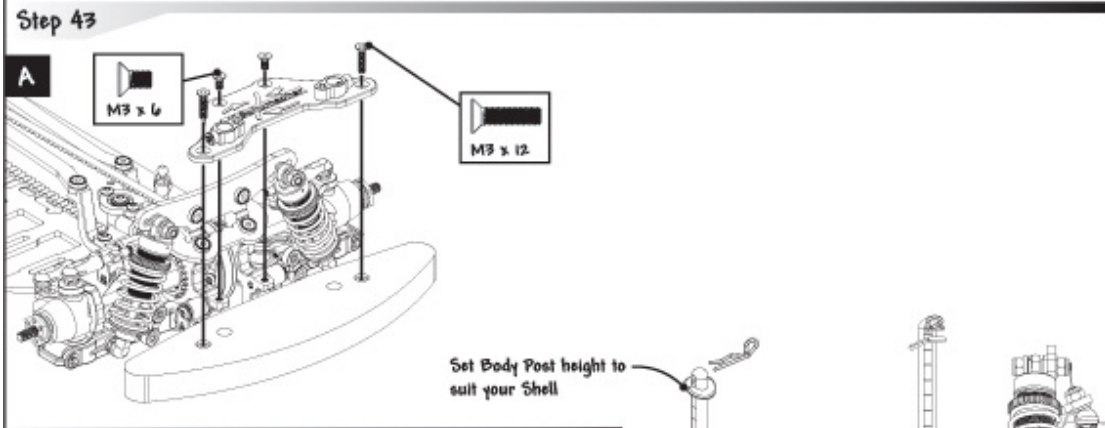
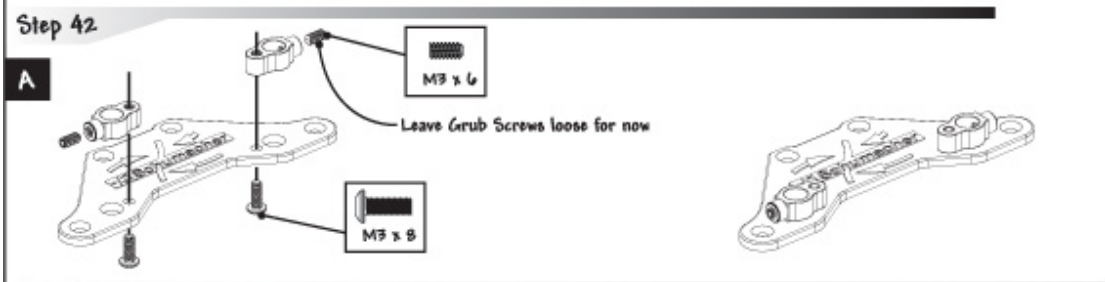
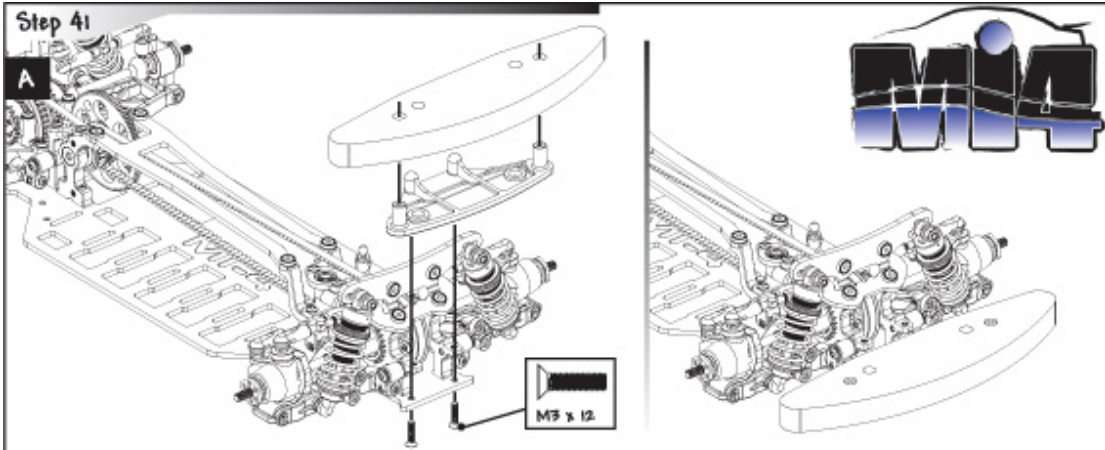

Step 44

A

Set Body Post height to suit your Shell

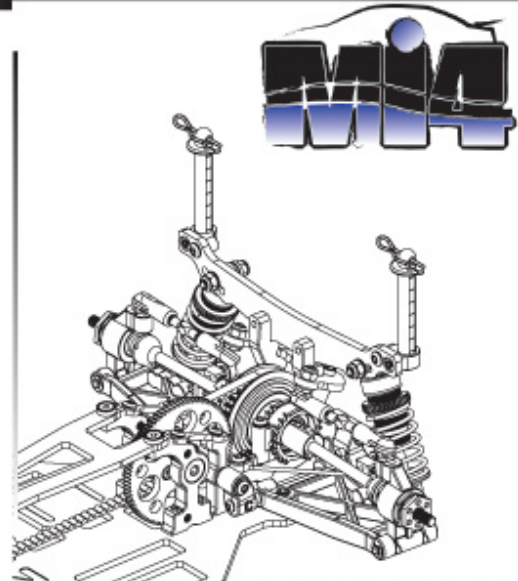
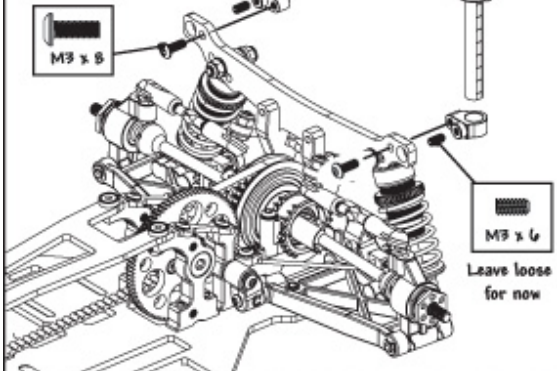

Step 45

A

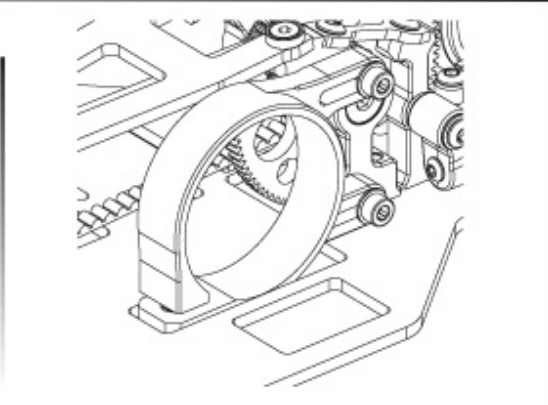
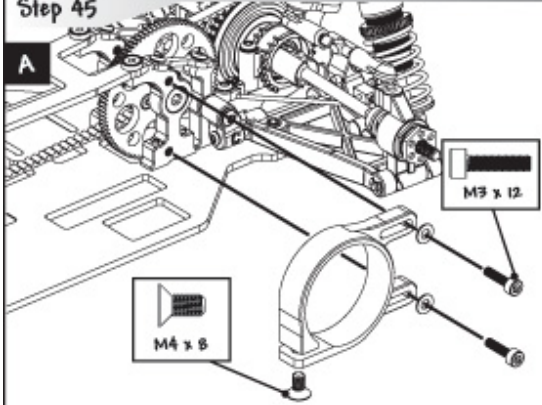

Step 46

SERVO SAVER OPTION

CHOOSE THE CORRECT HORN FOR YOUR SERVO.  
SA = SANWA/AIRTRONICS  
FU = FUTABA  
SH = HITEC

NO SERVO SAVER

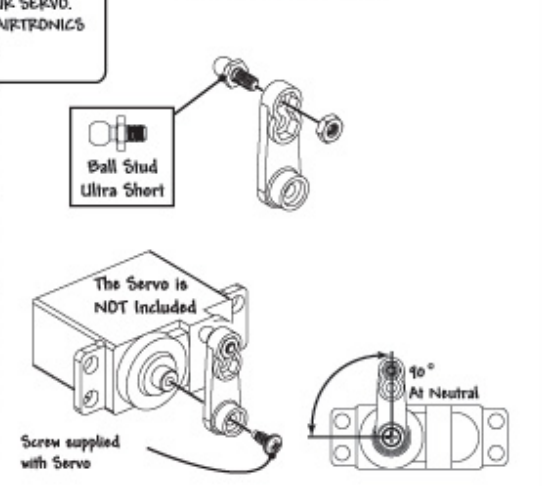
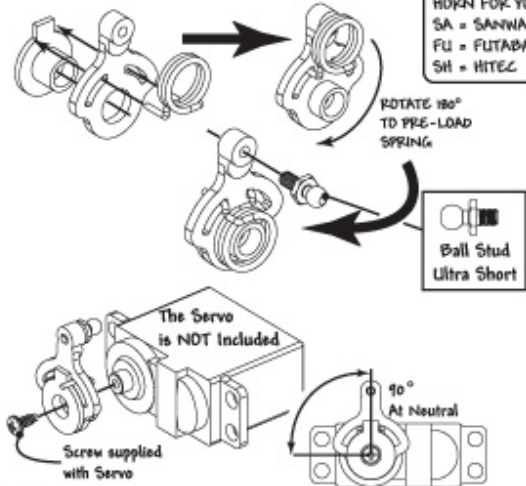

Step 47

A

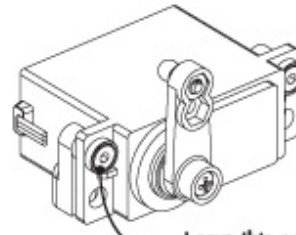
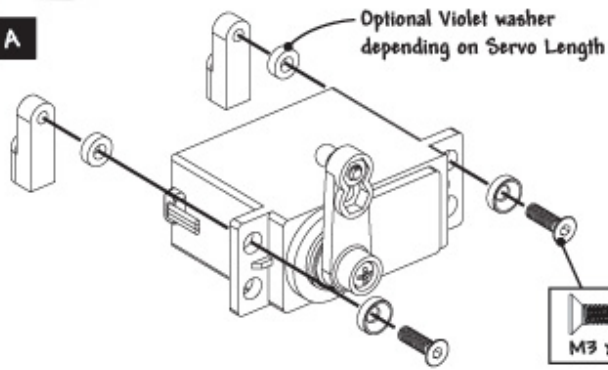

Leave this screw loose for now.

Step 47

OPTIONAL SERVO MOUNTING

B

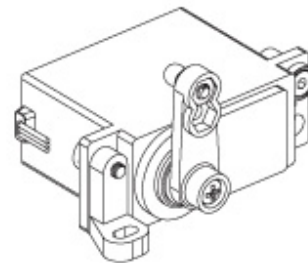
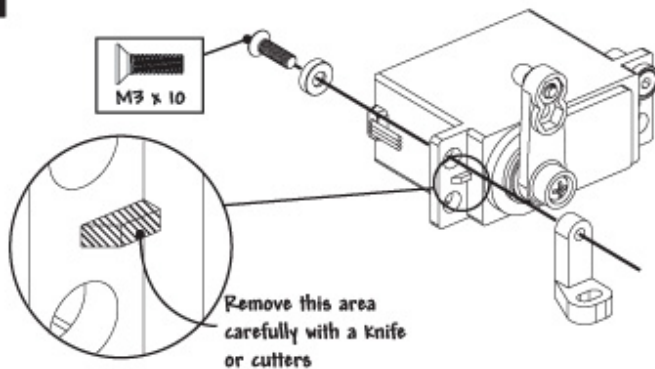

Step 48

A



B

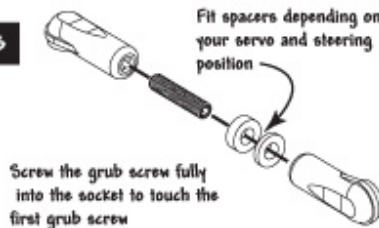

C



Step 48

C

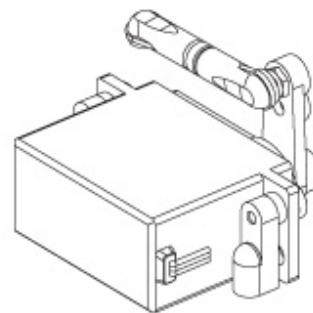
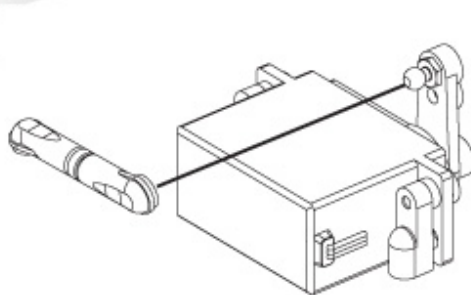



Step 49

A

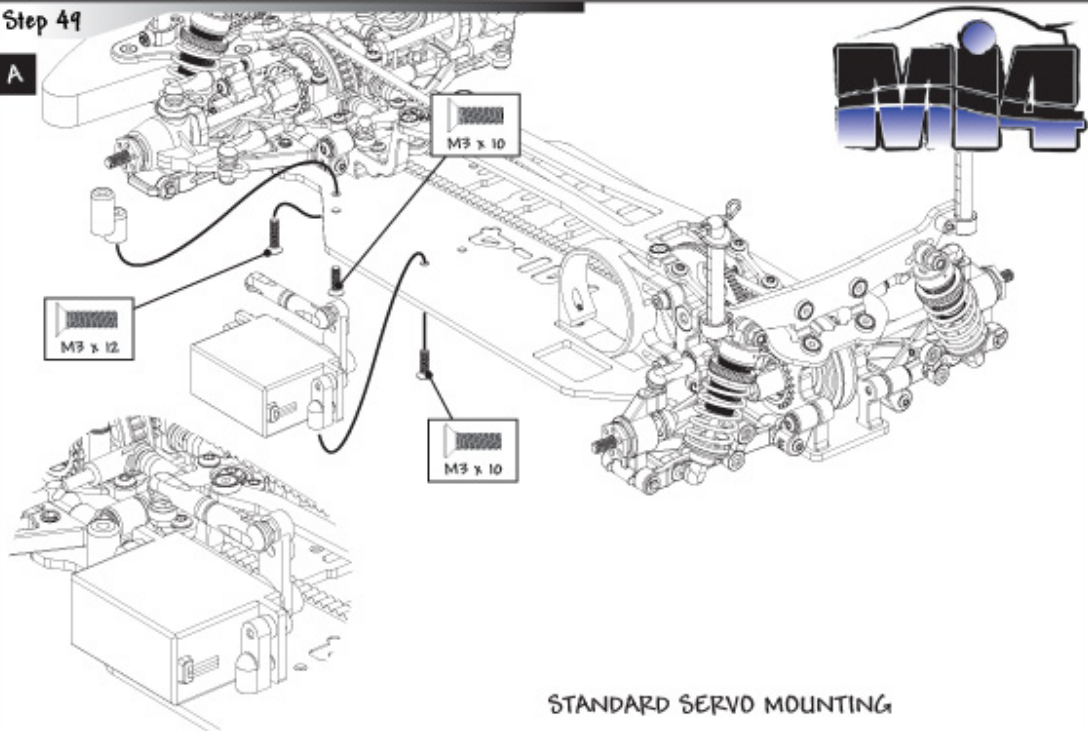

Step 49

B

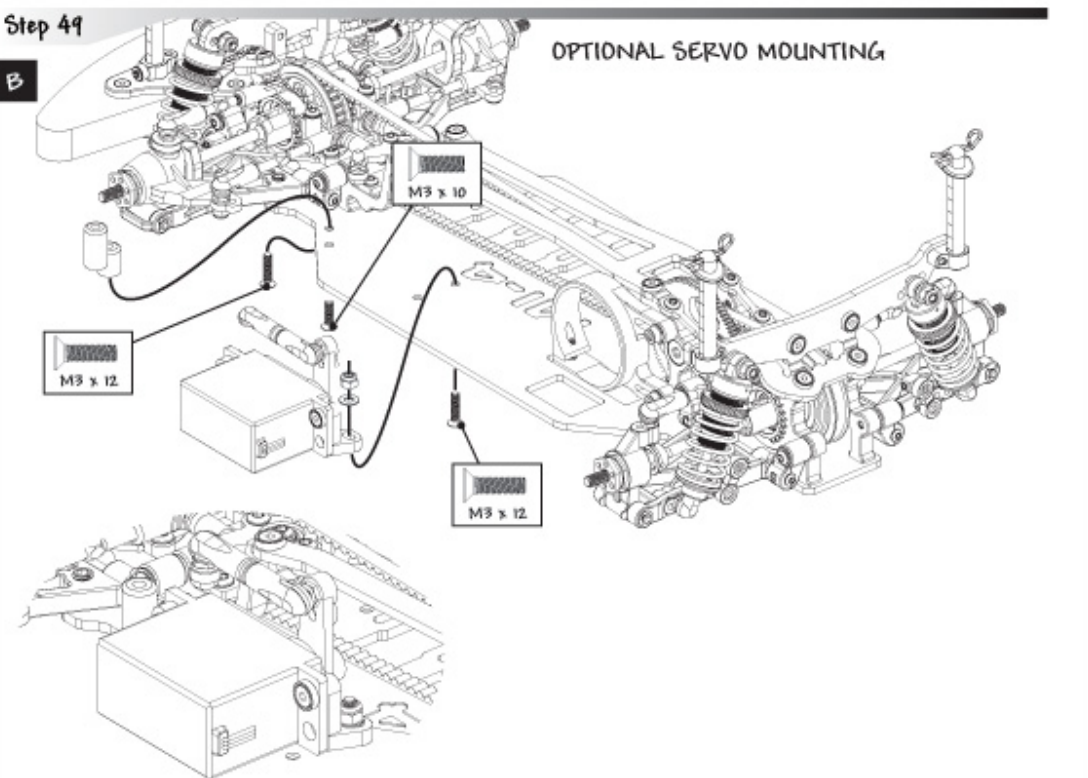

Page 22

Step 49

C

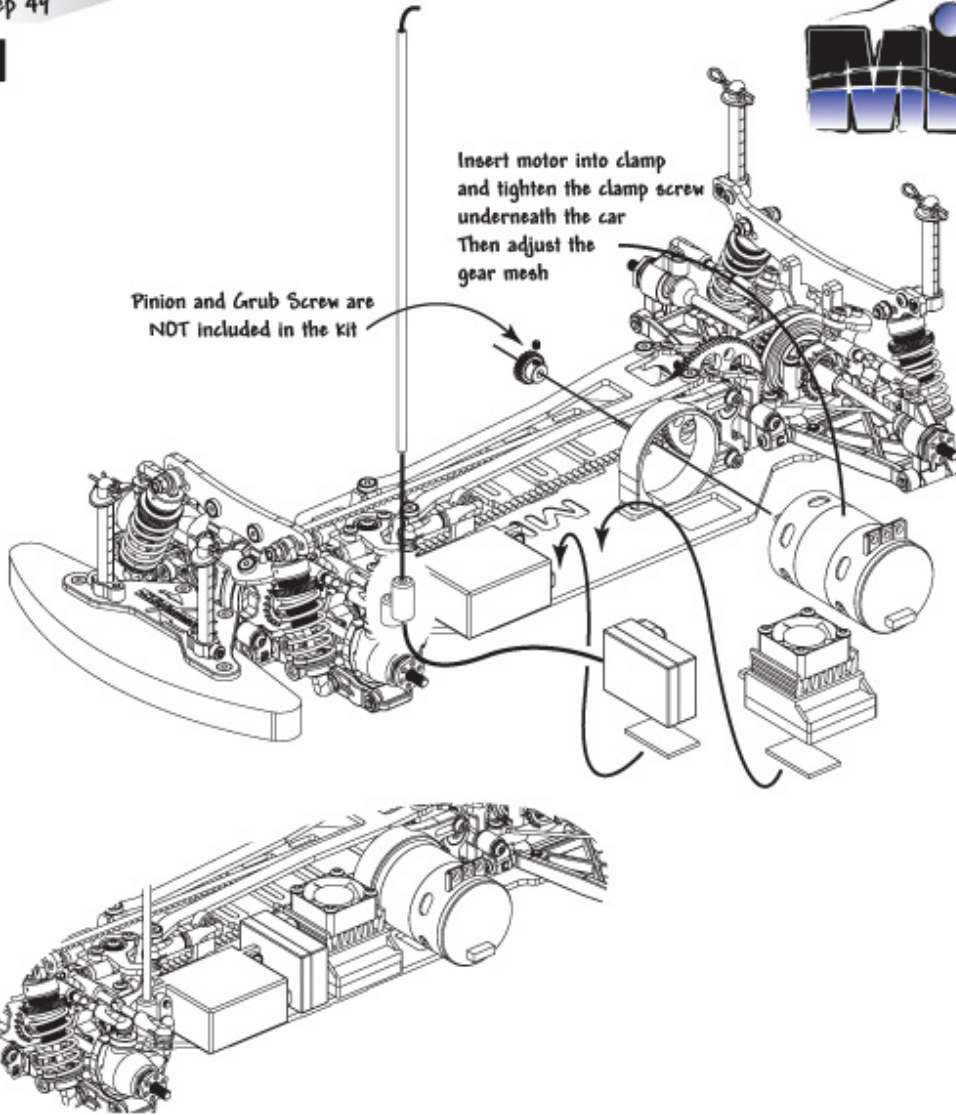

Step 50

A

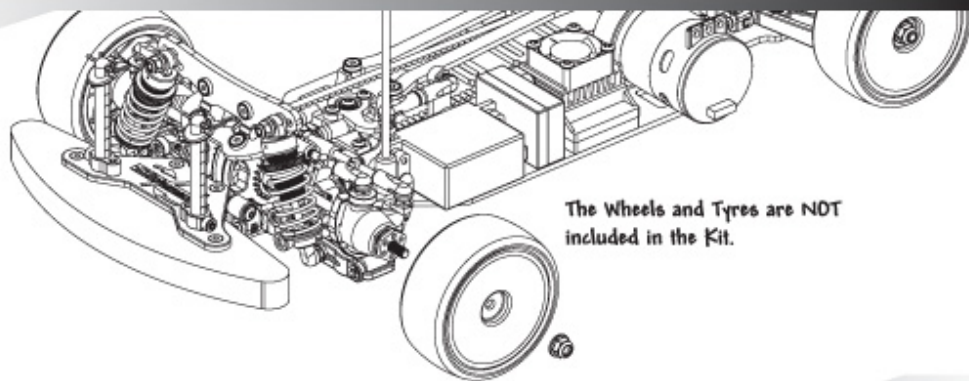

Optional One Way U3518



A

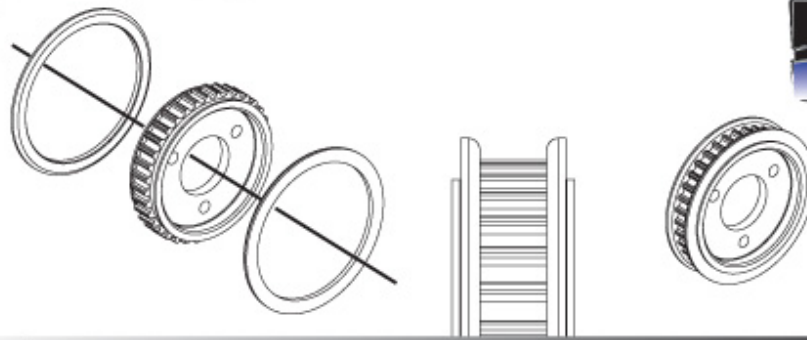

Optional One Way U3518

B

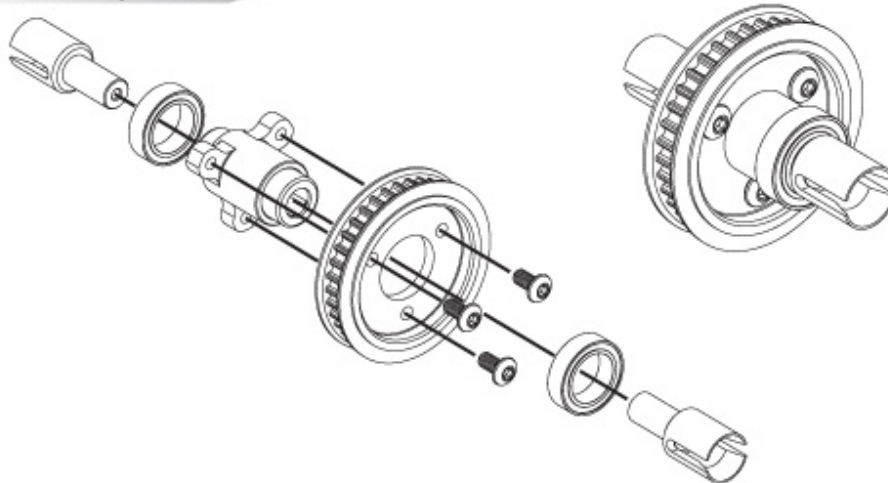

Optional Alloy Suspension Blocks U3517

A

PLEASE REFER TO THE SETUP SHEETS AT THE BACK OF THE MANUAL FOR THE CORRECT POSITIONS AND THICKNESS OF THE WASHERS IN THIS STEP

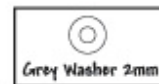

ENSURE THAT THE BLOCKS ARE CORRECTLY ASSEMBLED

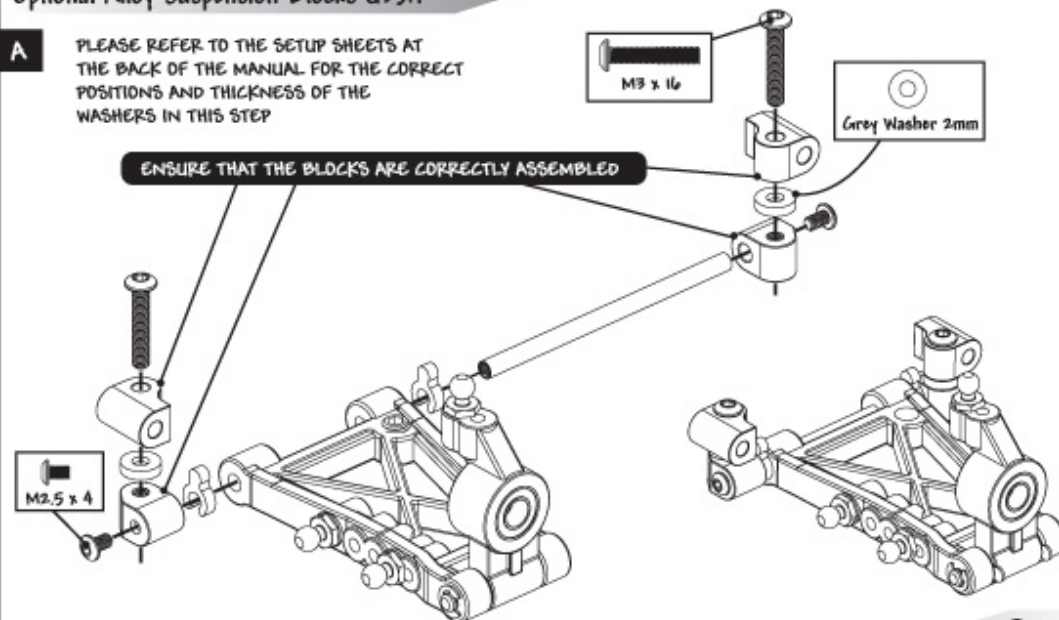



Optional One Way U3518



A

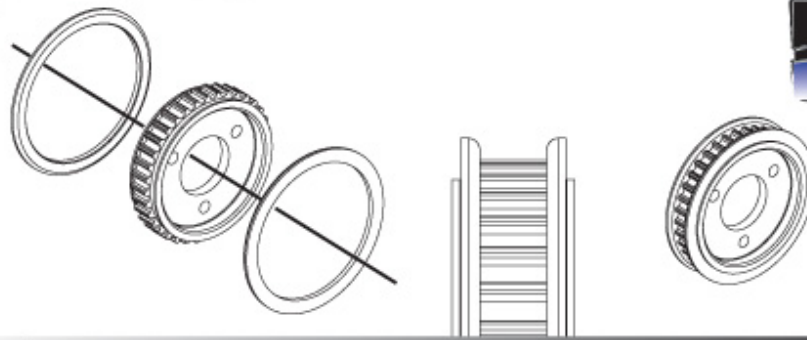

Optional One Way U3518

B

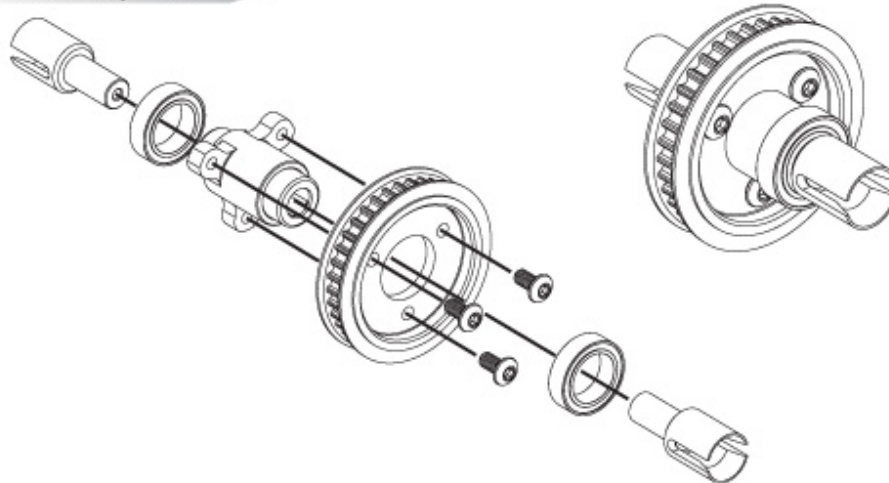

Optional Alloy Suspension Blocks U3517

A

PLEASE REFER TO THE SETUP SHEETS AT THE BACK OF THE MANUAL FOR THE CORRECT POSITIONS AND THICKNESS OF THE WASHERS IN THIS STEP

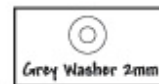

ENSURE THAT THE BLOCKS ARE CORRECTLY ASSEMBLED

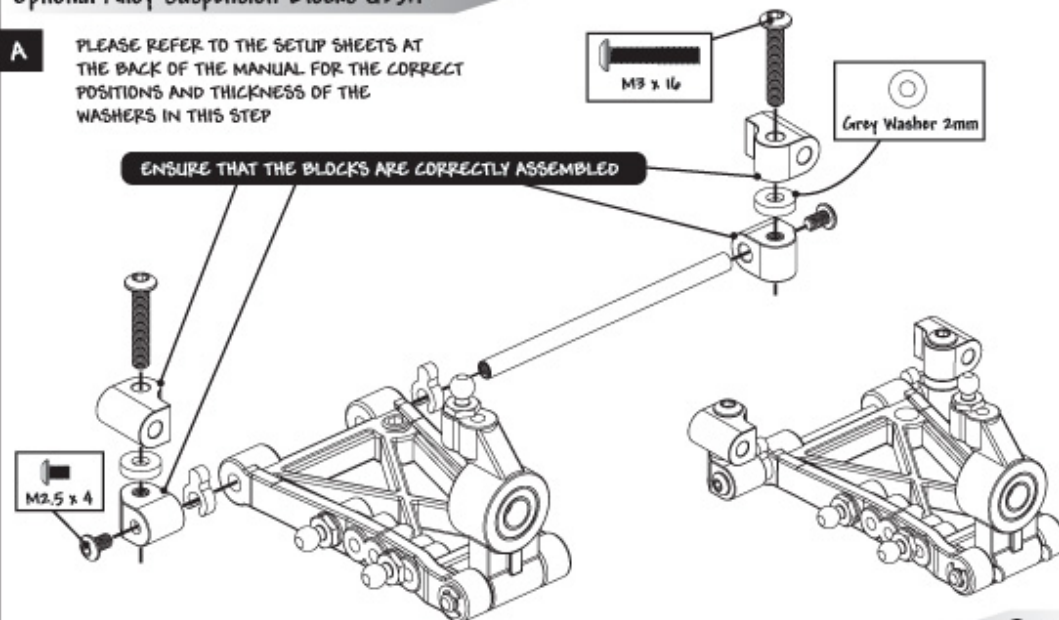

Optional Alloy Suspension Blocks U3517

B

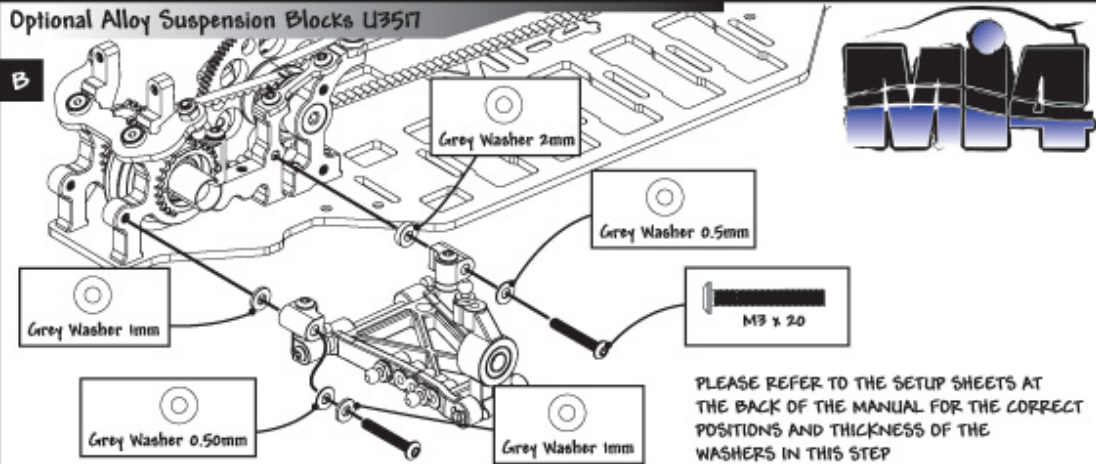

Optional Alloy Suspension Blocks U3517

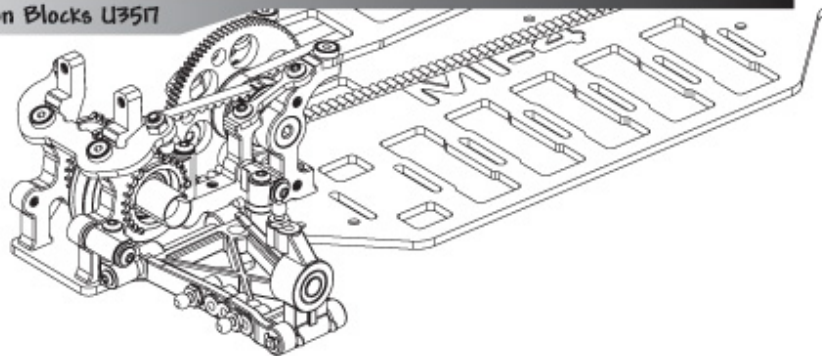

Optional Alloy Suspension Blocks U3517

C

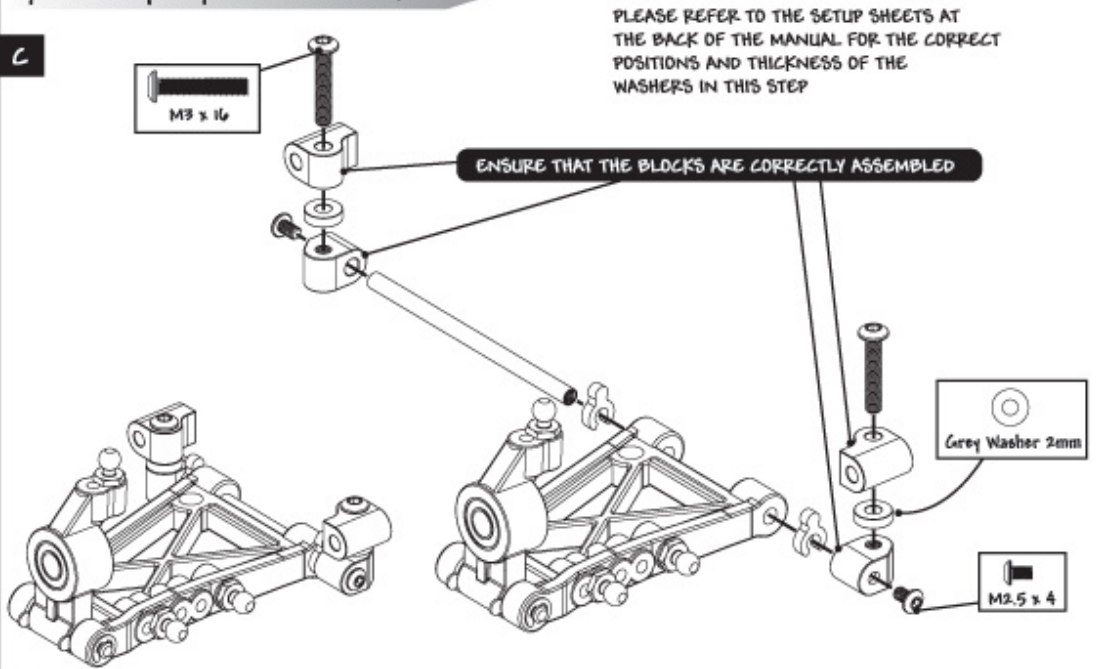

Optional Alloy Suspension Blocks U3517

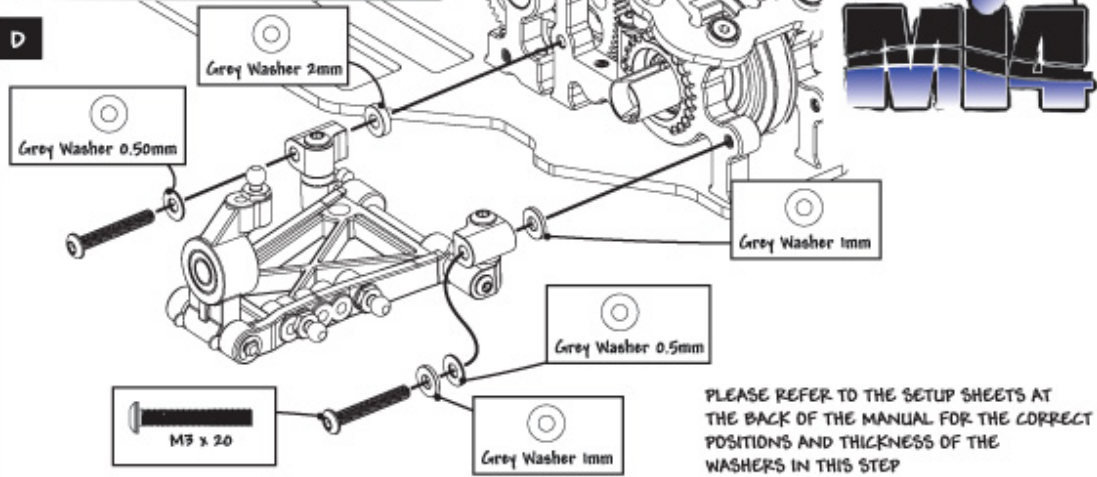

Optional Alloy Suspension Blocks U3517

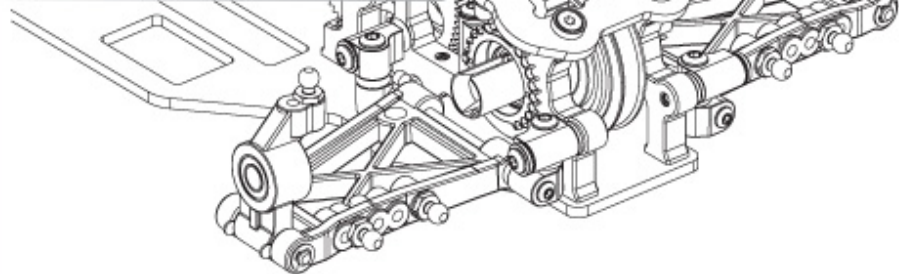

Optional Alloy Suspension Blocks U3517

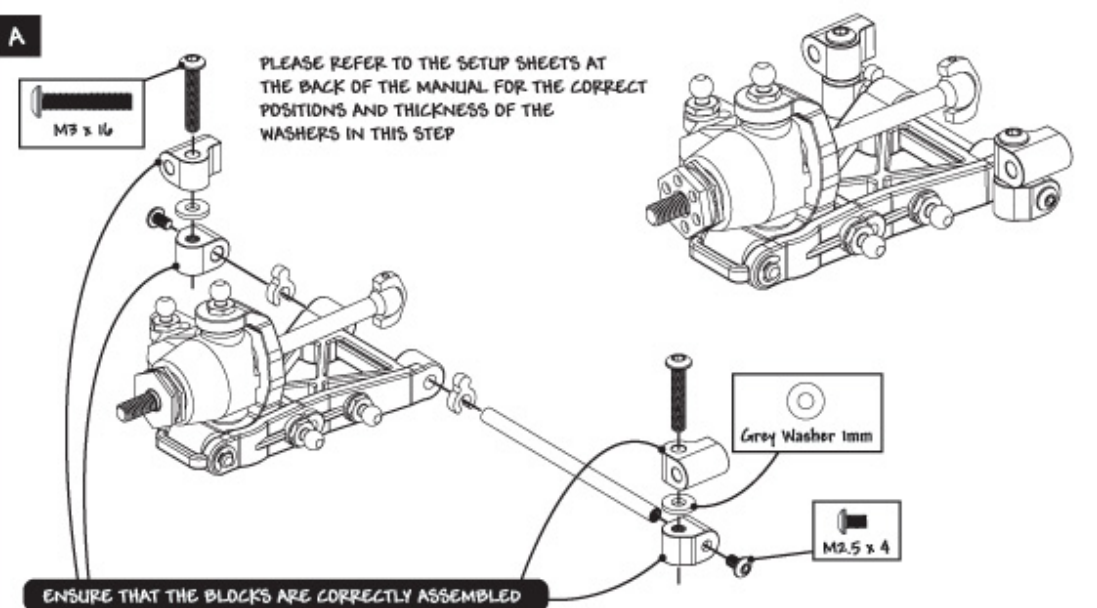



### Optional Alloy Suspension Blocks U3517



**B** PLEASE REFER TO THE SETUP SHEETS AT THE BACK OF THE MANUAL FOR THE CORRECT POSITIONS AND THICKNESS OF THE WASHERS IN THIS STEP

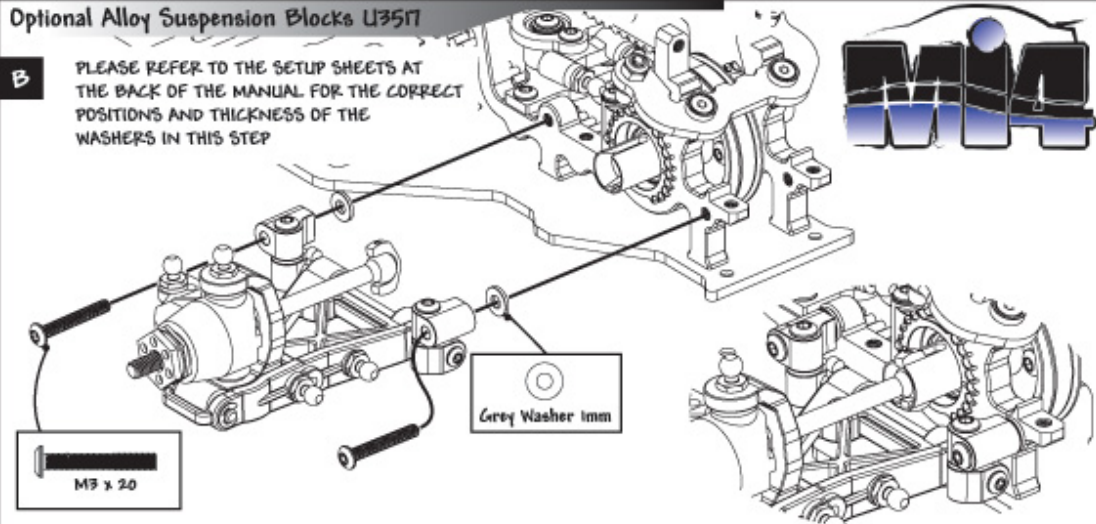

### Optional Alloy Suspension Blocks U3517

**C** PLEASE REFER TO THE SETUP SHEETS AT THE BACK OF THE MANUAL FOR THE CORRECT POSITIONS AND THICKNESS OF THE WASHERS IN THIS STEP

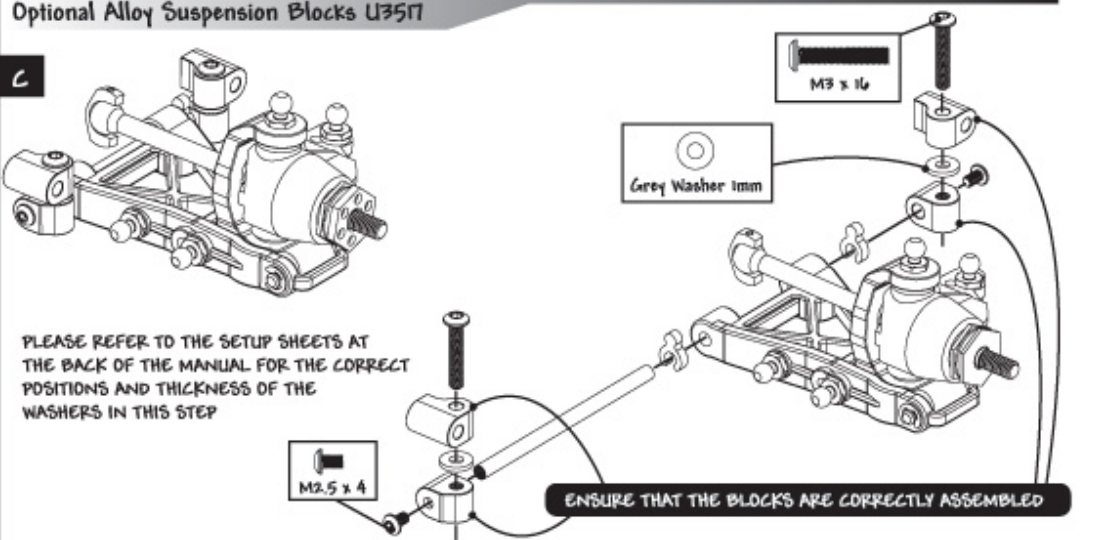

### Optional Alloy Suspension Blocks U3517

**D** PLEASE REFER TO THE SETUP SHEETS AT THE BACK OF THE MANUAL FOR THE CORRECT POSITIONS AND THICKNESS OF THE WASHERS IN THIS STEP

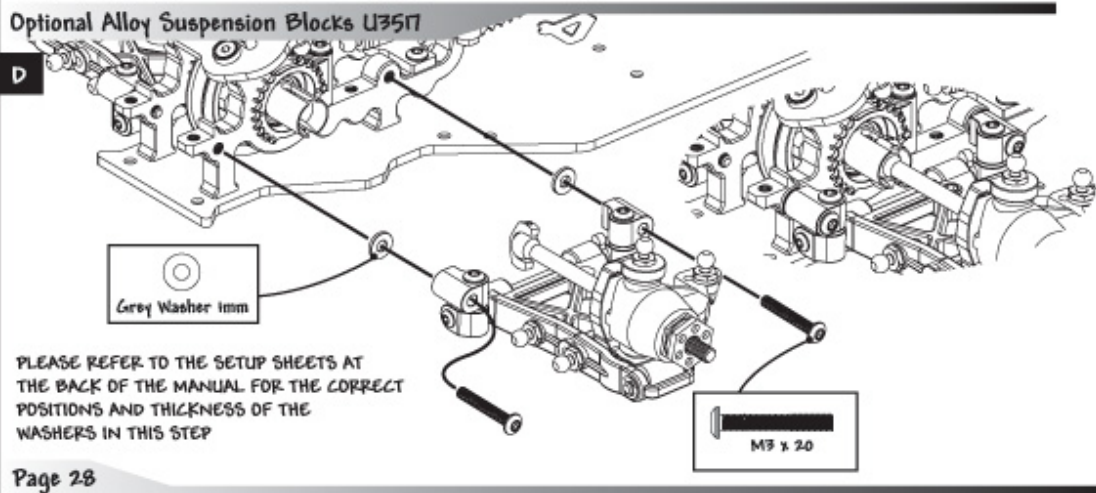

Optional Battery Strap and Posts U3513

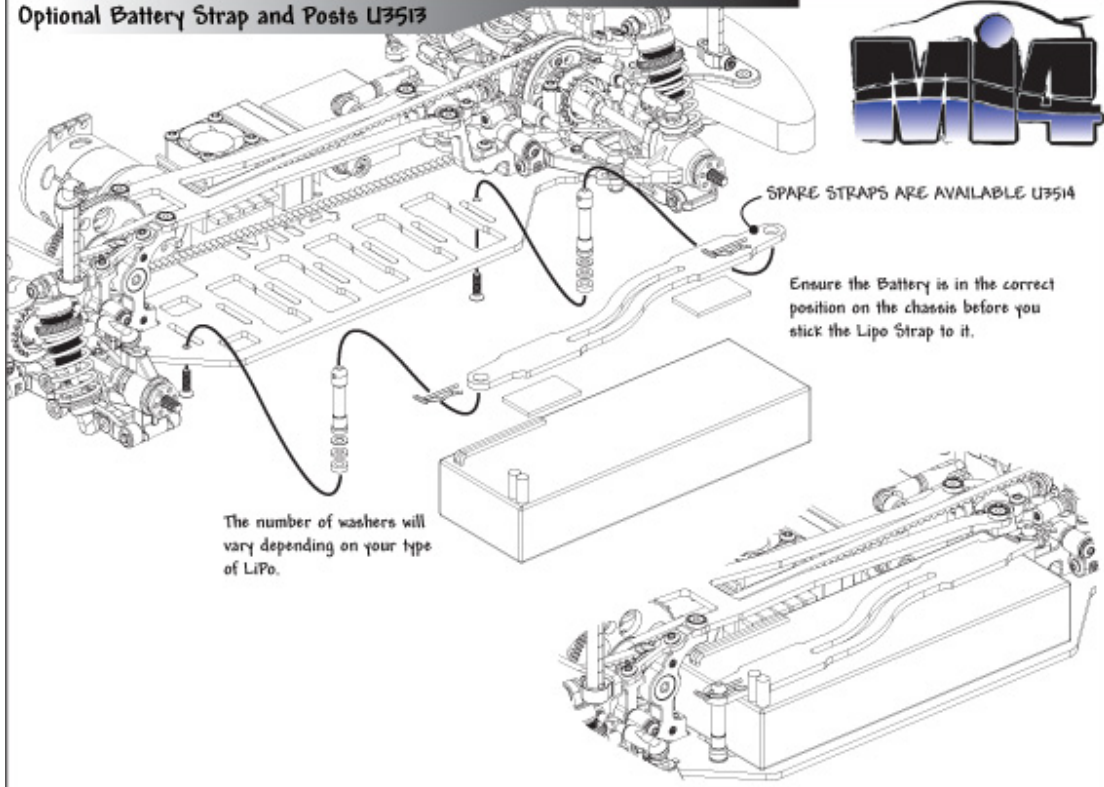

SPARE STRAPS ARE AVAILABLE U3514

Ensure the Battery is in the correct position on the chassis before you stick the Lipo Strap to it.

The number of washers will vary depending on your type of LiPo.

Optional Battery Strap and Posts U3513 + LiPo Retainer U3516

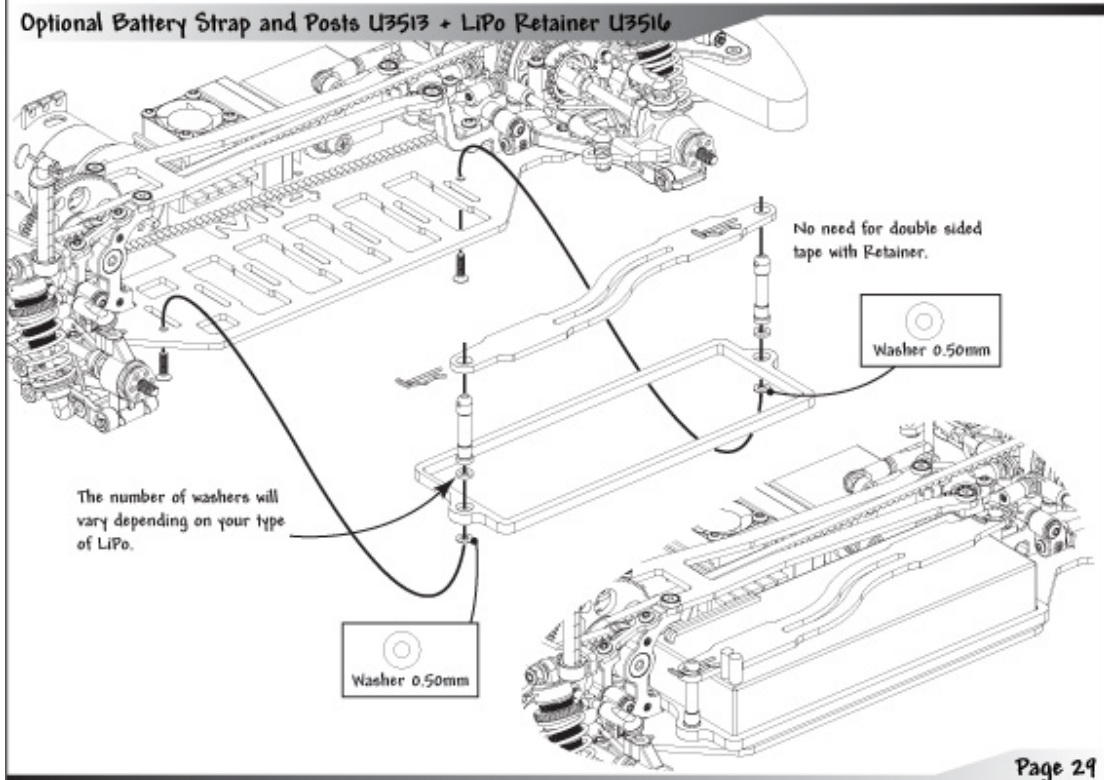

No need for double sided tape with Retainer.

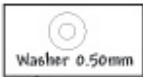

The number of washers will vary depending on your type of LiPo.



## Track Settings



### Springs

The spring rate controls the suspension stiffness. Spring adjusters only change the ride height. They DO NOT alter the suspension stiffness. On slippery or bumpy tracks use soft to medium rate springs, on flat or high grip tracks run medium to hard rate springs.



### Steering

By Adding and removing the washers under the ball joint, you alter the cars Ackerman and steering response. Adding washers will make the steering more aggressive, where less washers will make for a softer response.

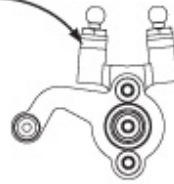

### Front Caster

The front caster can be altered by changing the yoke. The car comes with 4° caster as standard. Less caster will give a quicker steering response, but could lead to power on understeer. More caster will give the opposite, slightly slower turn in, but more power on steering.

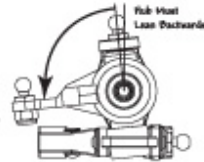

### Shock Brackets (Shock Mounting)

Vertical shock absorbers make the car react sharply to driver inputs.

A laydown shock offers a softer feel to the driver.



### Ride Height

In general always run the car as low as possible, without the chassis grounding out, as it rolls into corners.

A good starting point with rubber tyres is 5.5mm at the front and 6.0mm at the rear.

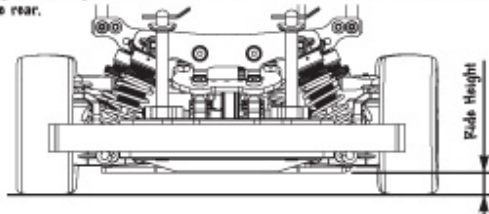

### Front and Rear Camber

With maximum negative camber the car will have high levels of grip, but there may be the possibility of sudden breakaway in corners. Reducing the camber gives a more progressive slide, but may give less grip.

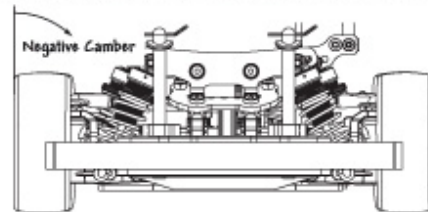

### Front Toe-in

The front toe-in is set by adjusting the steering trackrod turnbuckles.

Toe-in = A less than B  
Toe-out = A greater than B

Toe-in will give a more stable car, but will give less sharp turn in. Toe-out will give the opposite, less stability with sharper turn in to the corners.

We recommend to start at about 0° or 1° toe-out.

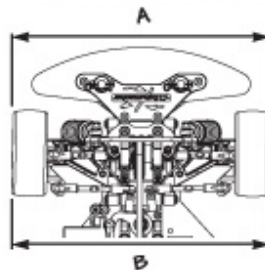

### Front and Rear Track Width

TRACK WIDTH ADJUSTMENT (in-board)

The track width of the car may be altered by adding or removing EQUAL thickness grey suspension washers between the Screw blocks and the transmission housings. When changing the track width ensure the driveshafts are fully engaged in the Diff outputs. And the width does not exceed 190mm

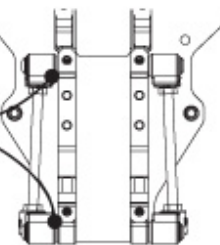

### Front and Rear Wheelbase

WHEELBASE ADJUSTMENT (in-board)

The wheelbase may be adjusted by moving the Qwik Clips to either the front or the back of the wishbones.

Shorter wheelbase results in a more agile car, but use longer wheelbase for a smoother less aggressive car. Also moving the wishbone forwards and backwards alters the weight distribution at either end of the car, this results in more or less traction, and more or less steering.

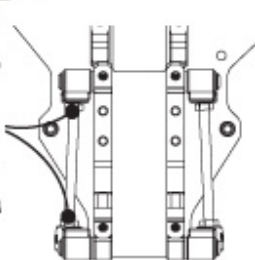

### Front and Rear Inboard Toe-in

USING OPTIONAL ALLOY PIVOT BLOCKS

More inboard toe in will improve straight ahead traction and car stability, but can reduce corner speed on fast sweepers.

The toe-in is set by adding or removing the grey suspension washers between the Screw blocks and the transmission housings, at the front or rear of the wishbones. Each 0.50mm washer will change the Toe in by Approx 0.60°

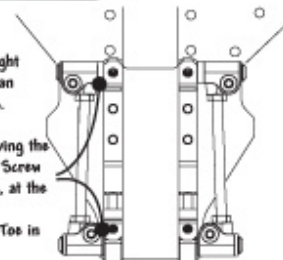



## Track Settings

### TRANS LINKS



To improve the rear end grip of the car use **THINNER** trans links (more flex), but to reduce the rear end grip use **THICKER** trans links (less flex). This adjustment allows tuning the balance of the car on various tracks.



## Gear Chart 48dp

Maximum Tooth Sum = 128.....Minimum Tooth Sum = 91.....Internal Ratio = 1.8:1

	14	15	16	17	18	19	20	21	22	23	24	25	26	27	28	29	30	31	32	33	34	35	36	37	38	39
84	11.44	10.68	10.01	9.42	8.90	8.43	8.01	7.63	7.28	6.97	6.68	6.41	6.16	5.93	5.72	5.52	5.34	5.17	5.01	4.85	4.71	4.58	4.45	4.33	4.22	4.11
87	11.11	10.44	9.79	9.21	8.70	8.24	7.83	7.46	7.12	6.81	6.53	6.26	6.02	5.80	5.59	5.40	5.23	5.05	4.89	4.75	4.61	4.47	4.35	4.23	4.12	4.02
85	10.79	10.20	9.56	9.00	8.50	8.05	7.65	7.29	6.95	6.65	6.38	6.12	5.88	5.67	5.46	5.28	5.10	4.94	4.78	4.64	4.50	4.37	4.25	4.14	4.03	3.93
70								6.00	5.79	5.60	5.45	5.04	4.95	4.67	4.50	4.34	4.20	4.06	3.94	3.82	3.71	3.60	3.50	3.41	3.32	3.23
66												4.75	4.57	4.40	4.24	4.10	3.96	3.83	3.71	3.60	3.49	3.39	3.30	3.21	3.13	3.05

## Gear Chart 64dp

Maximum Tooth Sum = 170.....Minimum Tooth Sum = 121.....Internal Ratio = 1.8:1

	19	20	21	22	23	24	25	26	27	28	29	30	31	32	33	34	35	36	37	38	39	40	41	42	43	44	45	46	47	48	49	50
118	11.18	10.62	10.11	9.65	9.23	8.85	8.50	8.17	7.87	7.59	7.32	7.08	6.85	6.64	6.44	6.25	6.07	5.90	5.74	5.59	5.45	5.31	5.18	5.06	4.94	4.83	4.72	4.62	4.52	4.43	4.33	4.25
116	10.91	10.44	9.94	9.49	9.08	8.70	8.35	8.03	7.73	7.46	7.20	6.96	6.74	6.53	6.34	6.14	5.97	5.80	5.64	5.49	5.35	5.22	5.09	4.97	4.86	4.75	4.64	4.54	4.44	4.35	4.26	4.18
114	10.80	10.26	9.77	9.33	8.92	8.55	8.21	7.91	7.60	7.33	7.08	6.84	6.62	6.41	6.22	6.04	5.86	5.70	5.55	5.40	5.26	5.13	5.00	4.89	4.77	4.66	4.56	4.46	4.37	4.28	4.19	4.10
106	10.04	9.54	9.09	8.67	8.30	7.95	7.63	7.34	7.07	6.81	6.58	6.36	6.15	5.96	5.78	5.61	5.45	5.30	5.16	5.02	4.89	4.77	4.65	4.54	4.44	4.34	4.24	4.15	4.06	3.98	3.91	3.82
96									6.17	5.96	5.76	5.57	5.40	5.24	5.08	4.94	4.80	4.67	4.55	4.43	4.32	4.21	4.11	4.02	3.93	3.84	3.76	3.68	3.60	3.53	3.46	
90												5.23	5.06	4.91	4.76	4.63	4.50	4.38	4.26	4.15	4.05	3.95	3.86	3.77	3.68	3.60	3.52	3.45	3.38	3.31	3.24	

## Front Inboard Pin Options

USING OPTIONAL ALLOY PIVOT BLOCKS

### ROLL CENTRE ADJUSTMENT

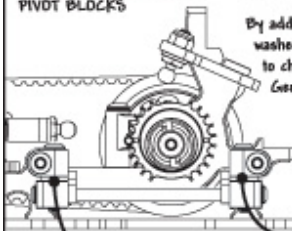

By adding or removing the Grey Suspension washers between the pivot blocks you are able to change the height of the roll centre. Generally a lower pin will give more grip, and a higher pin will reduce grip.

### KICK UP OR ANTI-DIVE

The best balance on the car is usually with a level wishbone pin, however a small amount of anti-dive can improve stability under braking

By adding the Grey Suspension washer at the front of the wishbone you will get anti-dive. 0.5mm = 0.5°

By adding the Grey Suspension washer at the rear of the wishbone you will get Kick-up. 0.5mm = 0.5°

## Rear inboard Pin Options

USING OPTIONAL ALLOY PIVOT BLOCKS

### ROLL CENTRE ADJUSTMENT

By adding or removing the Grey Suspension washers between the pivot blocks you are able to change the height of the roll centre. Generally a lower pin will give more grip, and a higher pin will reduce grip.

### SQUAT OR ANTI-SQUAT

The best balance on the car is usually with a level wishbone pin, however a small amount of Anti-Squat can improve on power traction.

By adding the Grey Suspension washer at the rear of the wishbone you will get Anti-Squat. 0.5mm Difference = 0.5°

By adding the Grey Suspension washer at the front of the wishbone you will get Pro-Squat. 0.5mm Difference = 0.5°

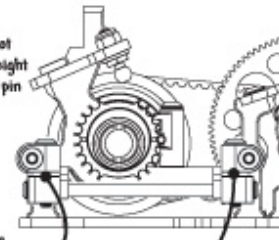

## Diff Height (High or Low)

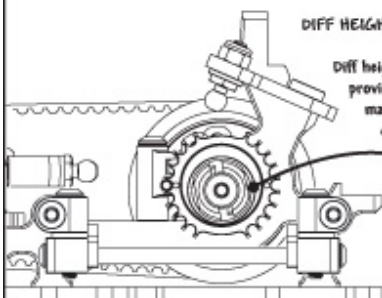

### DIFF HEIGHT

Diff height adjustment is provided so that the car may run level driveshafts at ride height with different diameter tyres.

## Front and Rear Suspension Link

### WIDTH ADJUSTMENT

The width of the inboard suspension link can be altered by Speed Secret link Brackets

### HEIGHT ADJUSTMENT

The height of the inboard suspension link can be altered by adding or removing the violet spacer washers, between the link mount and the ball stud, or under the link mount bracket.

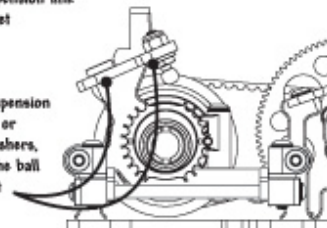

This adjustment alters the camber gain of the suspension, generally a lower ball stud (or shorter link) gives more instant cornering grip followed by a sudden breakaway, whereas a higher ball (or longer link) gives smoother more progressive cornering grip.

### CHASSIS PARTS

U1042	Aerial Mount - Universal
U1119	Aerial Tube - Pack 4
U2231	Servo Horns
U2480	Body Posts & R. Clips (pk 4)
U3154	Foam Bumper - Mi-4
U3155	Front Bumper Mouldings - Mi-4
U3158	Alloy Body Post Mounts; Horizontal (pr)
U3159	Alloy Body Post Mounts; Vertical (pr)
U3271	CF LiPo Battery Locator (pr)
U3483	CF Chassis; 2.0 - Mi-4
U3484	CF Chassis; 2.5 - Mi-4 Kit
U3485	CF Chassis; 3.0 - Mi-4
U3486	CF Top Deck; 2.0 - Mi-4 Kit
U3487	CF Top Deck; 2.5 - Mi-4
U3488	CF Top Deck; 3.0 - Mi-4
U3489	Servo Mounts - Mi-4 (pr)
U3490	Alloy Servo Mounts
U3491	Instruction Manual - Mi-4
U3521	Trans Link Tuning Set; 4prs - Mi-4

### BODYSHELLS & DECALS

EC16283121	East Coast - Body; is250 190mm
EC16283122	East Coast - Body; Euro-R 190mm
EC16283123	East Coast - Body; 320si 190mm
EC16283124	East Coast - Body; Speed & 190mm
EC16283125	East Coast - Body; Evo9s 190mm
EC16283126	East Coast - Body; Euro-R 200mm
EC162832D6	East Coast - Body; 350Z 190mm
EC162832D8	East Coast - Body; RXT 190mm
EC162832D9	East Coast - Body; S15 190mm
EC38824B	East Coast - Half Paint; Blue; Speed & 190mm
EC38824R	East Coast - Half Paint; Red; Speed & 190mm
U3478	Decal Sheet - Schumacher & Racing-Cars.Com (pk3)
U3492	Decal Sheet - Mi-4 (pk3)

### SUSPENSION

U1440	Pro Pin; grooved 1/8x25mm (pr)
U2464	Steering Yoke Pivot Set - 2 pairs
U2718	Pro Pin; Grooved 1/8x18mm (pr)
U2736	Steering Yoke; 2 degree - Mi-4 pr
U2737	Steering Yoke; Kit Std 4 degree - Mi-4 pr
U2738	Steering Yoke; 6 degree - Mi-4 pr
U2750	Droop Screw; M5x8mm pk4
U2990	Front Hub Carrier - Mi-4
U2992	Rear Hub Carrier - Mi-4
U3127	Wishbones; Graphite Front - Mi-4
U3128	Wishbones; Graphite Rear - Mi-4
U3137	Shock Mounting Post - Mi-4 (pr)
U3142	Pro Pivot Pin 55mm - Mi-4 (pr)
U3156	Roll Bar Set; Front 1.2-1.4-1.6 - Mi-4
U3157	Roll Bar Set; Rear 1.2-1.4-1.6 - Mi-4
U3209	Turnbuckle Adjuster; Gold - 24mm (pr)
U3210	Turnbuckle Adjuster; Gold - 35mm (pr)
U3212	Turnbuckle Adjuster; Gold - 45mm (pr)
U3249	Wishbones; Med Flex Front - Mi-4
U3250	Wishbones; Medium Flex Rear - Mi-4
U3251	Wishbones; Extra Flex Front - Mi-4
U3252	Wishbones; Extra Flex Rear - Mi-4
U3493	Alloy Steering Housing & Post - Mi-4
U3494	Suspension Pivot Blocks; set B - Mi-4
U3495	Ball Studs; Ultra Short - pk 4
U3496	Ball Studs; Short - pk 4
U3497	Ball Studs; Long - pk 4
U3498	Ball Studs; X-Long - pk 4
U3499	Roll Bar Blocks - Mi-4 pk4
U3500	Pro-Ball Socket; Black - pk 8
U3501	CF Steering Arm & Mount - Mi-4
U3522	CF Shock Bracket; Front - Mi-4
U3523	CF Shock Bracket; Rear - Mi-4
U3526	CF Upper Link Mount; 45mm 1gr - Mi-4
U3527	CF Upper Link Mount; 42mm 2gr - Mi-4
U3528	CF Upper Link Mount; 37mm 3gr - Mi-4
U3748	Steering Yoke; Med Flex 4 degree (pr)

### SPRINGS

U2822	Spring Tuning Set - Pro-Touring (6 pro)
U2823	Pro-Touring Springs - White 14 lbs
U2824	Pro-Touring Springs - Blue 16lbs
U2825	Pro-Touring Springs - Green 18 lbs
U2826	Pro-Touring Springs - Red 20 lbs
U2827	Pro-Touring Springs - Yellow 23 lbs
U2828	Pro-Touring Springs - Violet 27 lbs

### ELECTRIC - TOURING CARS

K093	Mi-4 Pro-CF - 1-10 Touring - KIT
K094	Mi-4 Pro-CF - 1-10 Touring - Assembled



### SHOCK ABSORBERS

U2993	Race Shock Body; Nickel Teflon (pr)
U2994	Race Shock Collar; threaded adjuster (pr)
U2995	Race Shock Piston - Trg 2 Hole (pr)
U2996	Race Shock Piston - Trg 3 Hole (kit std) pr
U2997	Race Shock Rod; Ti-Nitride - 30mm (pr)
U2998	Race Shock Seal Housing; On Road (pr)
U2999	Race Shock Seal Rebuild Pack (pr)
U3001	Race Shocks; fully assembled pair
U3284	Race Shock Top Cap (pr) - Black Unvented
U613	Spring Stop & Spacer Mouldings (pr)

### SHOCK OIL

G030	Pure Silicone Shock Oil - 30w
G035	Pure Silicone Shock Oil - 35w
G040	Pure Silicone Shock Oil - 40w
G045	Pure Silicone Shock Oil - 45w
G050	Pure Silicone Shock Oil - 50w
G055	Pure Silicone Shock Oil - 55w
G060	Pure Silicone Shock Oil - 60w
G070	Pure Silicone Shock Oil - 70w
G080	Pure Silicone Shock Oil - 80w
G100	Pure Silicone Shock Oil - 100w

### TRANSMISSION

U1895	M3x8mm Button Screws & Washers pk4
U2573	Pro-Diff Screw Set
U2721	Rear Belt; Black Mod 601 x 3.6mm
U2761	Diff Shims; 10 x 12
U3011	Front Belt; 111 x 3.6mm
U3012	Front Belt; Grey Stock 111 x 3.6mm
U3013	Rear Belt; Grey Stock 601 x 3.6mm
U3026	Pivot; Pin & Screw; Alloy CV D/Shaft
U3123	Alloy Eccentric - Mi-4 (pr)
U3124	Diff Retaining Post - Mi-4 (pr)
U3126	CNC Pulley & Fence; 20T - Mi-4
U3138	Alloy Diff Output; Male - Mi-4
U3139	Alloy Diff Output; Female - Mi-4
U3140	Diff Washer; ProSpec - Mi-4 (pr)
U3141	HD Spool Output - Mi-4
U3160	85T 48DP CNC Spur Gear - Mi-4
U3161	81T 48DP CNC Spur Gear - Mi-4
U3162	84T 48DP CNC Spur Gear - Mi-4
U3163	114T 64DP CNC Spur Gear - Mi-4
U3164	116T 64DP CNC Spur Gear - Mi-4
U3165	118T 64DP CNC Spur Gear - Mi-4
U3170	Pins & Shims; Axle - Mi-4 4pr
U3247	70T 48DP CNC Spur Gear - Mi-4
U3248	96T 64DP CNC Spur Gear - Mi-4
U3249	Ti Shock Post - Mi-4 pr
U3260	90T 64DP CNC Spur Gear - Mi-4
U3270	106T 64DP CNC Spur Gear - Mi-4
U3275	Bone; 1075 Alloy Driveshaft - Mi-4 1pc
U3400	66T 48DP CNC Spur Gear - Mi-4
U3502	Alloy Diff Mount; Rear - Mi-4
U3503	Alloy Layshaft Mount - Mi-4
U3504	Alloy Diff Mount; Front - Mi-4
U3505	Alloy Motor Clamp - Mi-4
U3506	Layshaft & Spacer - Mi-4
U3507	Diff; Pro-Spec Assembly - Mi-4
U3508	CNC Diff Pulley & Fence; 36T - Mi-4
U3509	Spool; Complete Assembly - Mi-4
U3510	CNC Spool Pulley only - Mi-4
U3511	Driveshaft HD - Mi-4 pair
U3512	Blades; Black pk 8



**BEARINGS & BALLS**

G200 ZX1 - Microlube  
 H1031 Bearing Blaster Aerosol 500ml  
 U1901 Silicone Diff Lube - Pot  
 U1411 Ball Bearing - 4 x 8 x 3 Non Fl. (pr)  
 U1431 Ball Bearing - 5 x 9 x 3 Non Fl. (pr)  
 U1954 Pro - Thrust Bearing  
 U1951 Moly Asle Grease - Pot  
 U2148 Ball Bearing - 5 x 10 x 4 Shielded (pr)  
 U2181 Wheel Bearings 8pcs 10x5x4+Shim Set  
 U2451 Diff Balls; T/C 2.5mm pk12  
 U2514 Ball Bearing - 5 x 9 x 2.5 (pr)  
 U2842 Ceramic Bearing - 5x10x4 Shielded (pr)  
 U3016 Ball Bearing - 10x15x4 (pr)  
 U3017 Ceramic Bearing - 10x15x4 (pr)  
 U3019 Ceramic Nitride Diff Balls 2.5mm (pk12)  
 U3196 Ball Bearing - 5 x 8 x 2.5 (pr)  
 U3986 Ceramic Bearing - 4x8x3 (pr)  
 U3920 Ceramic Bearing set - Mi-4

**SPEED PACKS**

CR024 CORE RC - Serrated M4 Steel Wheel Nut pk4  
 CR095 CORE RC - Serrated Alloy M4 Nuts; Blue pk 4  
 CR096 CORE RC - Serrated Alloy M4 Nuts; Purple pk 4  
 CR061 Small Body Clip 1/10 - Silver (8)  
 CR062 Small Body Clip 1/10 - Gold (8)  
 CR063 Small Body Clip 1/10 - Fluorescent Yellow (8)  
 CR064 Small Body Clip 1/10 - Fluorescent Green (8)  
 CR065 Small Body Clip 1/10 - Fluorescent Red (8)  
 CR066 Small Body Clip 1/10 - Metallic Green (8)  
 CR067 Small Body Clip 1/10 - Metallic Red (8)  
 CR068 Small Body Clip 1/10 - Metallic Purple (8)  
 CR071 Big Body Clip 1/10 - Silver (8)  
 CR072 Big Body Clip 1/10 - Gold (8)  
 CR073 Big Body Clip 1/10 - Fluorescent Yellow (8)  
 CR074 Big Body Clip 1/10 - Fluorescent Green (8)  
 CR075 Big Body Clip 1/10 - Fluorescent Red (8)  
 CR076 Big Body Clip 1/10 - Metallic Green (8)  
 CR077 Big Body Clip 1/10 - Metallic Red (8)  
 CR078 Big Body Clip 1/10 - Metallic Blue (8)  
 CR079 Big Body Clip 1/10 - Metallic Purple (8)  
 CR081 Extra Long Body Clip 1/10 - Silver (4)  
 CR082 Extra Long Body Clip 1/10 - Gold (4)  
 CR083 Extra Long Body Clip 1/10 - Fluorescent Yellow (4)  
 CR084 Extra Long Body Clip 1/10 - Fluorescent Green (4)  
 CR085 Extra Long Body Clip 1/10 - Fluorescent Red (4)  
 CR086 Extra Long Body Clip 1/10 - Metallic Green (4)  
 CR087 Extra Long Body Clip 1/10 - Metallic Red (4)  
 CR088 Extra Long Body Clip 1/10 - Metallic Blue (4)  
 CR089 Extra Long Body Clip 1/10 - Metallic Purple (4)  
 U1541 SPEED PACK - M3 Nuts  
 U1548 SPEED PACK - M3 Washers  
 U1550 SPEED PACK - Socket Wrenches (pk3)  
 U1551 SPEED PACK - E Clips 2x8pcs  
 U1552 SPEED PACK - R Clips  
 U1606 SPEED PACK - Servo Tape  
 U1633 SPEED PACK - Small Pins (pk)  
 U1960 SPEED PACK - O Rings; Various  
 U2128 SPEED PACK - Grub-Set Screws M3 M4  
 U2160 SPEED PACK - M3 Button Hd; 4 to 20  
 U2858 Alloy M3x6 Spacer Set; 0.5;1;2;3mm - 14pcs  
 U2988 M3 Csk Washers - Purple Alloy (pk10)  
 U3002 Wheel Spacer Washers (pk10)  
 U3021 SPEED PACK - M3x6 Csk Allen Hi-T  
 U3022 SPEED PACK - M3x8 Csk Allen Hi-T  
 U3023 SPEED PACK - M3x10 Csk Allen Hi-T  
 U3024 SPEED PACK - M3x12 Csk Allen Hi-T  
 U3131 Alloy Spacers M3x1mm 0.5;1;2mm (pk18)  
 U3168 SPEED PACK - M2.5 Screws pk 10  
 U3924 SPEED PACK-M4x8 Csk Hi Tensile (4)

**ELECTRONICS**

G8871 Mini Temp Gun - 420F 230C  
 G848 Tyre Warmers 1/10 Trg 7.2-12v  
 GM1458 Power Supply 5-15v 0-15Amp  
 GM1459 Power Supply 5-15v 0-20Amp  
 GM1460 Power Supply 12v 25 Amp  
 GM1452 Servo; Digital 80u MGA-BB 0.08s 19.9Kg  
 GM1453 Servo; Digital 80T MGA-BB 0.06s 15.3Kg  
 GM1454 Servo; Digital 80B MGA-BB 0.04s 8.8Kg  
 GM1453EM Power Cap 470uF 16v Anti Clitch  
 GM144000 XG-Li 2.4G Sport Wheel Radio Tx-Rx  
 GM144001 XG-Li 2.4G Race Wheel Radio Tx-Rx  
 GM144010 XG-Li 2.4G Micro Rx

**SPEED SECRET - OPTION PARTS**

CR010 CORE Ti Screws - Mi-4 Set 67 pcs  
 CR011 CORE Ti Screws - M3x8 Button Head pk4  
 CR012 CORE Ti Screws - M3x10 Button Head pk4  
 CR013 CORE Ti Screws - M3x16 Button Head pk4  
 CR014 CORE Ti Screws - M3x20 Button Head pk4  
 CR015 CORE Ti Screws - M3x8 Csk Head pk4  
 CR016 CORE Ti Screws - M3x10 Csk Head pk4  
 CR017 CORE Ti Screws - M3x12 Csk Head pk4  
 CR018 CORE Ti Ball Studs - Ultra Short pk4  
 CR019 CORE Ti Ball Studs - Short pk4  
 CR020 CORE Ti Ball Studs - Long pk4  
 CR049 CORE RC - Silver X-Weights 16pcs  
 CR058 CORE RC - Black X-Weights 16pcs  
 CR109 CORE Ti Ball Stud Set - M4 20pcs  
 CR110 Alloy Servo Arm; Futaba Purple  
 CR111 Alloy Servo Arm; KO/Sanwa Purple  
 CR112 Alloy Servo Arm; Futaba Blue  
 CR113 Alloy Servo Arm; KO/Sanwa Blue  
 H1026 Ride Height Gauge; Purple Alloy; 0-10mm  
 H1027 Droop Gauge Set; Purple Alloy - Touring  
 S500B Schumacher BANNER 6x3ft  
 U1572 Titanium Turnbuckle; purple - 39mm (pr)  
 U1576 Titanium Pivot Pin; purple - 25mm (pr)  
 U1905 Titanium Turnbuckle; purple - 35mm (pr)  
 U2053 Titanium Turnbuckle; purple - 25mm (pr)  
 U2075 Camber & Ride Height Gauges - C/C  
 U2096 Aerial Mount; Purple Chrome - Universal  
 U2100 Set Up Wheels; Camber&Toe In-SST  
 U2195 M4 Nyloc Wheel Nut - Purple Alloy (pk4)  
 U2187 M3 Nyloc Nut - Purple Alloy (pk8)  
 U2251 Kwik Clip; 1/8x1.0 & 2.0mm  
 U2298 Schumacher Pit Dude Car Stand  
 U2566 Titanium Turnbuckle - 45mm (pr)  
 U2719 Titanium Pivot Pin; purple - 18mm pr  
 U2741 Alloy Rear Hub Carriers; 1deg - Mi-4  
 U2810 M4 Nyloc Wheel Nut - Red Alloy (pk4)  
 U2811 M4 Nyloc Wheel Nut - Blue Alloy (pk4)  
 U2812 M4 Nyloc Wheel Nut - Black Alloy (pk4)  
 U2813 M4 Nyloc Wheel Nut - Gold Alloy (pk4)  
 U2844 Hub & One Way; Heavy Duty - Mi-2  
 U2845 Output; Heavy Duty One Way - Mi-2 1pc  
 U3132 Kwik Clips 0.25 & 0.5mm (pk8)  
 U3143 Titanium Pivot Pin Set - Mi-4 (8pcs)  
 U3167 Titanium Pro Pivot Pin - 55mm (pr)  
 U3221 Alloy Wheel Hex; Slim Solid - Mi-3 (pr)  
 U3513 CF LiPo Strap & Posts - Mi-4  
 U3514 CF LiPo Strap - Mi-4  
 U3515 LiPo Retainer - Mi-4  
 U3516 Ti Turnbuckle Set - Mi-4  
 U3517 Alloy Block Susp Half Set - Mi-4  
 U3518 One Way; Complete Assembly - Mi-4  
 U3519 CNC One Way Pulley - Mi-4  
 U3525 Alloy Wheel Hex - Mi-4 (pr)



#### CHARGERS

CR025 UDC10 Universal Charger - NiMH + LiPo  
CR026 UDC20 Universal Balance Charger - NiMH+LiPo  
CR027 Power Supply; UDC 2.0 - 6A UK Plug  
CR028 Power Supply Cable; USA  
CR029 Power Supply Cable; Europe  
CR091 UDC Charger Connector Set  
CR096 Balance Charge Lead; JST to 2mm Male 7.4v  
GM444 Ultramat 14 Mains/12v Charger  
SLC1005A SP Multi-Charge - Orange  
SLC2015A SP Multi-Charge - Pink  
SLC3025A SP Multi-Charge - Blue  
SLC4035A SP Multi-Charge - Yellow

#### SPEEDCONTROLS

GMT164 GM Genius 10 BL ESC 10 Amp  
GMT168 GM Genius 120 BL-ESC 120 Amp  
SPEXT98802B Speed Passion GT V2.0 ESC - Blue  
SPEXT98802LPB Speed Passion LPF V2.0 ESC - Blue  
SPEXT98802LPF Speed Passion LPF V2.0 ESC - Carbon Look  
SPEXT98802PRD Speed Passion GT V2.0 ESC - Carbon Look

#### BRUSHLESS MOTORS

GMT1286 GM Pro 6T Delta Wind BL Motor  
GMT1287 GM Pro 1T Delta Wind  
GMT1290 GM Pro Stock 10.5T - Star Wind  
GMT1294 GM Pro Stock 13.5T - Star Wind  
GMT1296 GM Pro 6.5T - Star Wind  
SP13825 Speed Passion CV2.0 Comp BL Motor; 2.5T  
SP13835 Speed Passion CV2.0 Comp BL Motor; 3.5T  
SP13840 Speed Passion CV2.0 Comp BL Motor; 4.0T  
SP13845 Speed Passion CV2.0 Comp BL Motor; 4.5T  
SP13855 Speed Passion CV2.0 Comp BL Motor; 5.5T  
SP13865 Speed Passion CV2.0 Comp BL Motor; 6.5T  
SP1405 SP Ultra Stock BL Motor 10.5T BRCA RDAR  
SP1435 SP Ultra Stock BL Motor 13.5T RDAR  
SP1475 SP Ultra Stock BL Motor 17.5T RDAR  
SP1475 Speed Passion CV2.0 Comp BL Motor; 7.5T  
SP1485 Speed Passion CV2.0 Comp BL Motor; 8.5T

#### BRUSHLESS ACCESSORIES

SP1385CR1 SP Rotor 3.5T; Euro R Hi Power 12.5mm  
SP1385CR2 SP Rotor 3.5T; Euro S Hi Speed & Runtime 12mm  
SP13845CR1 SP Rotor 4.5T; Euro RS Power Band 19mm  
SP162801 SP - Sensor Cable 180mm  
SP162802 SP - Sensor Cable 90mm  
SP162810 SP - HiPower Connector; 3pcs set  
SPAM55C15M SP - Super Capacitor 1.5 Farads 7.4 Volt rated  
SPAM55C3M SP - Super Capacitor 3 Farads 6 Volt rated  
SPBA01 SP Brushless Analyser - ESC & Motors  
SPCB0183238 SP - Ceramic Motor Bearing  
SPLPDA501 SP - Connector; 7.3v Female - Golden Batteries  
SPRA13835 SP Rotor 3.5T; Standard 13.5mm  
SPRA13845 SP Rotor 4.5T; Standard 13.5mm  
SPRB13835 SP Rotor 3.5T; Hi RPM 19mm  
SPRB13845 SP Rotor 4.5T; Hi RPM 12mm  
SPSPBA01 Brushless Analyser - ESC & Motors

#### BRUSHLESS ESC & MOTOR COMBO

SPCOM105 SP Combo - Pro-Stock 10.5T + LPF ESC  
SPCOM135 SP Combo - Stock 13.5T + LPF ESC  
SPCOM65 SP Combo - Modified 6.5T + LPF ESC

#### BATTERIES

CR004 CORE RC - 5000mAh 7.4v LiPo  
CR034 CORE RC - 3250mAh 7.4v LiPo  
GT67 Ener-G 4600 - XVS Team x5 Selected  
GM19898T LiPo V-MAXX 35C 5000/7.4V Stick 175 Amp Cont  
GM19899A LiPo V-MAXX 30C 4200/7.4V Saddle  
SLR38035 SP LiPo Hardcase - 3800mAh 14.8v 30C  
SLR4025H SP LiPo Hardcase - 4000mAh 7.4v 25C  
SLR423HS SP LiPo Saddle Pack - 4200mAh 7.4v 30C  
SLR5309H SP LiPo Hardcase - 5300mAh 7.4v 30C

#### 1/10 TOURING WHEELS

U2500 Rev-Lite; 24mm - White (Pk4)  
U2501 Rev-Lite; 24mm InchUp - White (Pk4)  
U2771 Rev-Lite; Flex 24mm - White (Pk4)  
U2799 Rev-Lite Stiff; 24mm - White (Pk4)



#### 1/10 TOURING TYRES & INSERTS

U6623 SST Mini Pins 24/25 - Blue (pr)  
U6624 SST Mini Pins 24/25 - Yellow (pr)  
U6626 SST Foam Tyre Insert - 24/25 Soft (pr)  
U6627 SST Foam Tyre Insert - 24/25 Hard (pr)  
U6628 SST Foam Tyre Insert - 24/25 Comp (pr)  
U6629 SST Rally 24/25 - Yellow (pr)  
U6630 SST Rally 24/25 - White (pr)  
U6634 SST Foam Tyre Insert - 20 Soft (pr)  
U6635 SST Foam Tyre Insert - 20 Hard (pr)  
U6670 SST Mini Pins 20 - Blue (pr)  
U6671 SST Mini Pins 20 - Yellow (pr)  
U6672 SST Belted Slick 25 - White (pr)  
U6690 SST Carpet Dragon 24/25mm (pr)  
U6695 Moulded LP Insert Orange X-Soft (pr)  
U6696 SST Moulded LP Insert Green Med (pr)  
U6699 SST LP2A Foam Insert; Med Blk (pr)  
U6700 SST LP2A Foam Insert; Soft Gr (pr)  
U6714 Moulded CP Insert Aqua - Soft (pr)  
U6716 SST Mini Pins 24/25 - Green (pr)  
U6717 SST Mini Pins 20 - Green (pr)

#### SOREX - TOURING CAR TYRES

XCD-20R Sorex Competition Tyre - 20R  
XCD-24R Sorex Competition Tyre - 24R  
XCD-28R Sorex Competition Tyre - 28R  
XCD-32R Sorex Competition Tyre - 32R  
XCD-36R Sorex Competition Tyre - 36R  
XCD-40R Sorex Competition Tyre - 40R  
XG-24BM Sorex Glued 24R+Med B+Revlite24 pk4  
XG-28BM Sorex Glued 28R+Med B+Revlite24 pk4  
XG-28JB Sorex Glued 28R+JB+Revlite24 pk4  
XG-32BM Sorex Glued 32R+Med B+Revlite24 pk4  
XG-32CM Sorex Glued 32R+Med C+Revlite24 pk4 BRCA  
XG-36BM Sorex Glued 36R+Med B+Revlite24 pk4  
XG-36CM Sorex Glued 36R+Med C+Revlite24 pk4  
XG-36EU Sorex Glued 36R+C Med; Euro 2008 pk4  
XG-WET Shimizu DOT Wet Pre-Glued; Euro 2008 pk4  
XMA-24F Sorex Moulded Insert - A Firm pr  
XMA-24M Sorex Moulded Insert - A Med pr  
XMB-24F Sorex Moulded Insert - B Firm pr  
XMB-24M Sorex Moulded Insert - B Med pr  
XMC-24F Sorex Moulded Insert - C Firm pr  
XMC-24M Sorex Moulded Insert - C Med pr

**PINIONS 48dp**

U3414 Pinion; Hard Alloy 48dp - 14T  
 U3415 Pinion; Hard Alloy 48dp - 15T  
 U3416 Pinion; Hard Alloy 48dp - 16T  
 U3417 Pinion; Hard Alloy 48dp - 17T  
 U3418 Pinion; Hard Alloy 48dp - 18T  
 U3419 Pinion; Hard Alloy 48dp - 19T  
 U3420 Pinion; Hard Alloy 48dp - 20T  
 U3421 Pinion; Hard Alloy 48dp - 21T  
 U3422 Pinion; Hard Alloy 48dp - 22T  
 U3423 Pinion; Hard Alloy 48dp - 23T  
 U3424 Pinion; Hard Alloy 48dp - 24T  
 U3425 Pinion; Hard Alloy 48dp - 25T  
 U3426 Pinion; Hard Alloy 48dp - 26T  
 U3427 Pinion; Hard Alloy 48dp - 27T  
 U3428 Pinion; Hard Alloy 48dp - 28T  
 U3429 Pinion; Hard Alloy 48dp - 29T  
 U3430 Pinion; Hard Alloy 48dp - 30T  
 U3431 Pinion; Hard Alloy 48dp - 31T  
 U3432 Pinion; Hard Alloy 48dp - 32T  
 U3433 Pinion; Hard Alloy 48dp - 33T  
 U3434 Pinion; Hard Alloy 48dp - 34T  
 U3435 Pinion; Hard Alloy 48dp - 35T  
 U3436 Pinion; Hard Alloy 48dp - 36T  
 U3437 Pinion; Hard Alloy 48dp - 37T  
 U3438 Pinion; Hard Alloy 48dp - 38T

**PINIONS 64dp**

U3619 Pinion; Hard Alloy 64dp - 19T  
 U3620 Pinion; Hard Alloy 64dp - 20T  
 U3621 Pinion; Hard Alloy 64dp - 21T  
 U3622 Pinion; Hard Alloy 64dp - 22T  
 U3623 Pinion; Hard Alloy 64dp - 23T  
 U3624 Pinion; Hard Alloy 64dp - 24T  
 U3625 Pinion; Hard Alloy 64dp - 25T  
 U3626 Pinion; Hard Alloy 64dp - 26T  
 U3627 Pinion; Hard Alloy 64dp - 27T  
 U3628 Pinion; Hard Alloy 64dp - 28T  
 U3629 Pinion; Hard Alloy 64dp - 29T  
 U3630 Pinion; Hard Alloy 64dp - 30T  
 U3631 Pinion; Hard Alloy 64dp - 31T  
 U3632 Pinion; Hard Alloy 64dp - 32T  
 U3633 Pinion; Hard Alloy 64dp - 33T  
 U3634 Pinion; Hard Alloy 64dp - 34T  
 U3635 Pinion; Hard Alloy 64dp - 35T  
 U3636 Pinion; Hard Alloy 64dp - 36T  
 U3637 Pinion; Hard Alloy 64dp - 37T  
 U3638 Pinion; Hard Alloy 64dp - 38T  
 U3639 Pinion; Hard Alloy 64dp - 39T  
 U3640 Pinion; Hard Alloy 64dp - 40T  
 U3641 Pinion; Hard Alloy 64dp - 41T  
 U3642 Pinion; Hard Alloy 64dp - 42T  
 U3644 Pinion; Hard Alloy 64dp - 44T  
 U3646 Pinion; Hard Alloy 64dp - 46T  
 U3648 Pinion; Hard Alloy 64dp - 48T

**TOOLS**

AT1142 ATS Set Up Gauges - 1/10th Touring  
 CR044 CORE RC - Curved Body Scissors  
 CR045 CORE RC - Straight Body Scissors  
 CR100 Shock Shaft Pliers - Purple  
 CR101 Shock Shaft Pliers - Black  
 CR102 Magnetic Parts Tray - Purple  
 CR103 Magnetic Parts Tray - Black  
 ED190024 Arm Reamer 3.175 (1/8) x 120mm  
 H1032 Alloy Camber Gauge - 1/10th  
 H1055 GT85 Lube & Clean Aerosol 400ml  
 U2789 Schumacher Hex Driver - 1.5mm  
 U2790 Schumacher Hex Driver - 2.0mm  
 U2791 Schumacher Hex Driver - 2.5mm  
 U2792 Schumacher Hex Driver - 3.0mm  
 U2795 Schumacher M3 Nut Driver  
 U2796 Schumacher M4 Nut Driver  
 U2818 Schumacher Body Reamer

**TEAM CLOTHING**

G331L T Blue - Large  
 G331M T Blue - Medium  
 G331S T Blue - Small Man  
 G331XL T Blue - X-Large  
 G331XXL T Blue - XX-Large  
 G333L Polo - Large  
 G333M Polo - Medium  
 G333S Polo - Small Man  
 G333XL Polo X Large  
 G333XXL Polo - XX-Large  
 G334 Cap - Black; Medium 58cm  
 G335 Cap - Black; Large 62cm  
 G336L Sweat - Large  
 G336M Sweat - Medium  
 G336S Sweat - Small  
 G336XL Sweat - X-Large  
 G336XXL Sweat - XX-Large

**ACCESSORIES**

CR001 CORE RC Motor & Battery Case  
 CR005 CORE RC Battery Tape - Black  
 CR006 CORE RC Battery Tape - Blue  
 CR007 CORE RC Silicone Wire 12g - Red/Black 2x50cm  
 CR008 CORE RC RED Connector with 2x4mm Tubes  
 CR009 CORE RC RED Connector with 2x4mm Males  
 CR022 CORE RC - Digital Pocket Scale 500gram  
 CR033 CORE RC - Safe Charge Pouch 18x22cm  
 CR037 CORE RC - Battery Tape - Purple  
 CR050 CORE RC Silicone Wire 12g - Red 1 Metre  
 CR051 CORE RC Silicone Wire 12g - Black 1 Metre  
 CR052 CORE RC Silicone Wire 12g - Blue 1 Metre  
 CR053 CORE RC Silicone Wire 12g - Red 50 Metre Reel  
 CR054 CORE RC Silicone Wire 12g - Black 50 Metre Reel  
 CR055 CORE RC Silicone Wire 12g - Blue 50 Metre Reel  
 CR059 CORE RC - Safe Charge Pouch 23x30cm  
 G193 Silicone Wire - 2x50cm Red/Black  
 G194 Battery Bars - pk5  
 G195 Female Connector Tubes (pk 10)  
 G196 Male Connector Plugs (pk 2)  
 GMB375 Battery Warmer Pads 40degC 12v 3Amp  
 H1039 Battery Tape - Natural 50m x 17mm  
 H1046 T Connector; Red 2 Way - Male & Female  
 H1047 T Connector; Black 2 Way - Male & Female  
 H1048 T Connector; Red Sockets - pk4  
 H1049 T Connector; Black Sockets - pk4  
 H1054 Polarised Plug+Socket; 3.5mm - Pair  
 SEL3000B 5P LiPo Extension Balancer

U3746 Steering Yoke Med Flex 4 deg

U3450 Purple Alloy Servo Mounts

Silicone shock oil

- G030 - 30 weight (thin)
- G035 - 35 weight
- G040 - 40 weight
- G045 - 45 weight
- G050 - 50 weight
- G055 - 55 weight
- G060 - 60 weight
- G070 - 70 weight
- G080 - 80 weight
- G100 - 100 weight
- G130 - 130 weight (thick)

# MIA

Speed Secrets & Options

U2803 Spring Tuning Set - Pro-Touring (6 pcs)  
 U3750 Pull Bar Set, Front L3-L4-L6 - M4  
 U3757 Pull Bar Set, Rear L3-L4-L6 - M4

U3937 Wishbones, Graphite Front - M4  
 U3938 Wishbones, Graphite Rear - M4  
 U3941 Wishbones, Med Flex Front - M4 (x1)  
 U3950 Wishbones, Med Flex Rear - M4 (x1)  
 U3951 Wishbones, Extra Flex Front - M4  
 U3952 Wishbones, Extra Flex Rear - M4

More flex = more traction but less response.

Waha Precision Cardip Pliers for diff maintenance.  
 CR044 Curved Body Scissors  
 CR10034 Arm Reamer 3.075mm (1/8")  
 For perfect pin fits.

U3485 - Carbon Fibre Chassis - Stiff 3.0mm - M4  
 U3486 - Carbon Fibre Top Deck - 2.5mm - M4  
 U3487 - Carbon Fibre Top Deck - 3.0 mm - M4

3 mm thicker chassis, and 2.5mm & 3mm top deck are designed for carpet racing on foam tyres. Increased rigidity for higher traction conditions.

U3958 CF LiPo Strap & Pests - M4  
 U3954 CF LiPo Straps - M4 4x3  
 U3955 LiPo Pests - M4

U3786 Hex Driver - 1.5mm  
 U3790 Hex Driver - 3.00mm  
 U3791 Hex Driver - 3.5mm  
 U3795 M3 Nut Driver  
 U3796 M4 Nut Driver  
 U3818 Body Reamer

U3938 Heavy Duty Front One Way Assy - M4  
 U3907 Diff - Fully Assembled Ceramic - M4

A one way allows sharper turn in but more unstable braking. Popular on large tracks where traction is high.  
 A front diff is recommended for foam tyres on carpet.

CR401 CORE-Ti Ball Stud Set - M4 30pcs

CA450 30g CS Cyano (Super Glue)  
 Thin, ideal for tyres.

U3930 Ceramic Bearing set - M4

U3936 Ti Turnbuckle Set - M4  
 U3937 Alloy Block Susp Half Set - M4

U3943 Titanium Pivot Pin Set - M4 (8pcs)

U3911 Alloy Wheel Hex Slim - M4

H1016 Wide Height Gauge - Purple Alloy  
 H1027 Drop Gauge Set - Purple Alloy

H1092 Alloy Camber Gauge - 1-10th